

1 RoHS Compliance

REV	SYM	Revision Record	Appr.	Date
V0	KLS01011	New Version Release	Song	2024-11-26
V1.0		Process Improvement	Song	2026-01-20

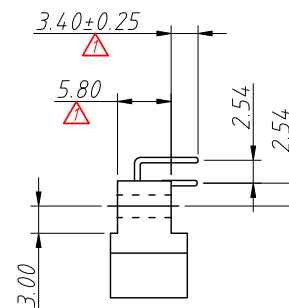
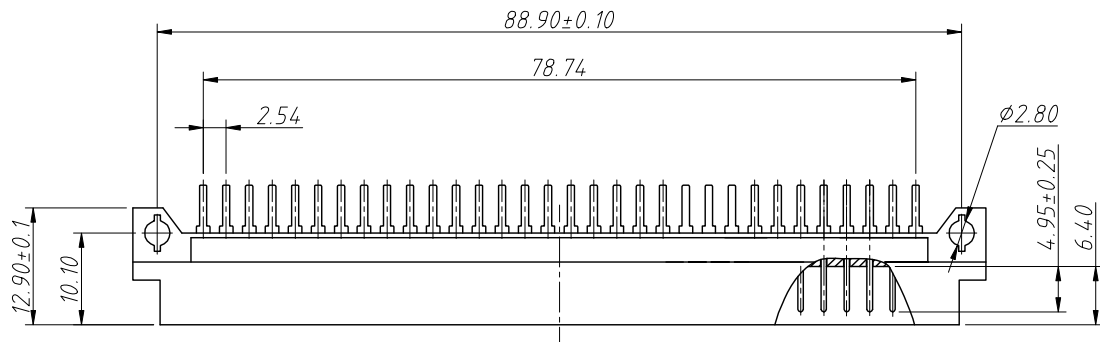

Material:

Housing:PBT+30%G.F UL 94 V-0

Contacts:Copper Alloy,G/F Gold Plated

Electrical:

Current Rating:2 Amps

Contact Resistance:20 mΩ initial

Insulation Resistance:1000 MΩ min @ 500 V DC

Dielectric Withstanding Voltage:1000 V AC/minute

Operating temperature:-55°C ~ +125°C

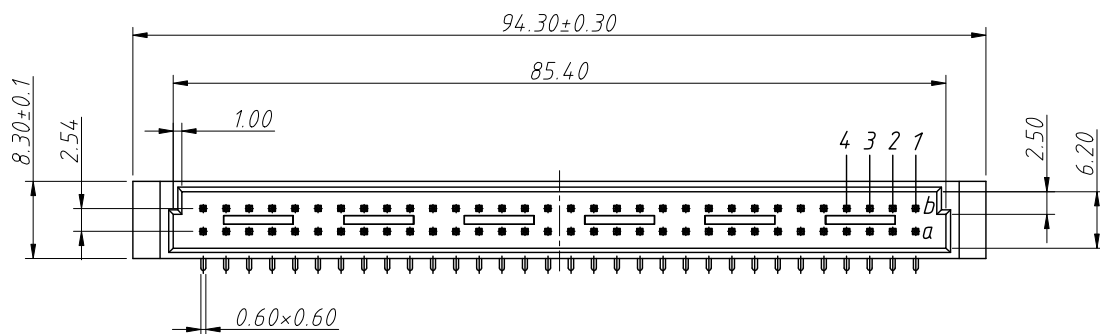

Order Information

L-KLS1-D2-xxxx-M R

RoHS

D2=2X32Pin

2row Long Type

Part NO.:2264

2132, 2232, 2116

M-Male

R-Right Angle Pin

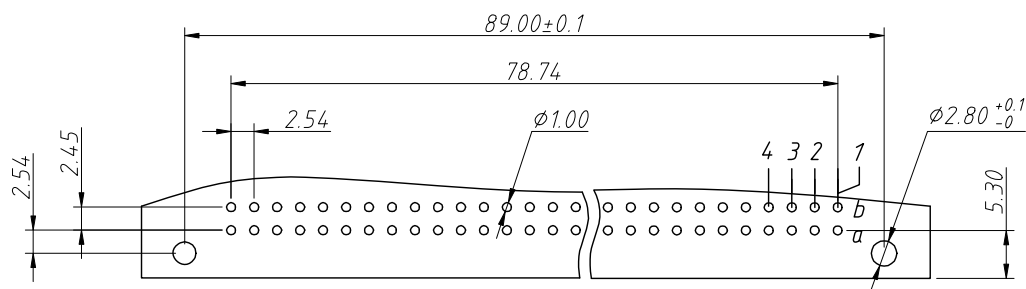

Recommended PCB Layout  
Tolerance:±0.05mm

Pitch	Position	Rows with Contact	Contact Arrange	Part Number
2.54mm	64	a b		2264
	32	a -		2132
5.08mm	32	a b		2232
	16	a -		2116

ANGLE TOLERANCE	PROJECTION	Description:		
±3°		DIN4 1612 Connector, 2x32 Pin 2 Row, Male, Right Angle Pin		
GENERAL TOLERANCE	UNITS	mm	KLS P/N:	L-KLS1-D2-xxxx-MR
.x ±0.30	SHEET SIZE	A4		
.xx ±0.20	Draw:	Song	2024-11-26	
.xxx ±0.10	Check:	Daniel	2024-11-26	

NingBo KLS ELECTRONIC CO.,L TD.

RoHS Compliance

REV	SYM	Revision Record	Appr.	Date
V0	KLS01011	New Version Release	Song	2026-06-03

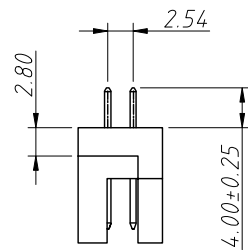
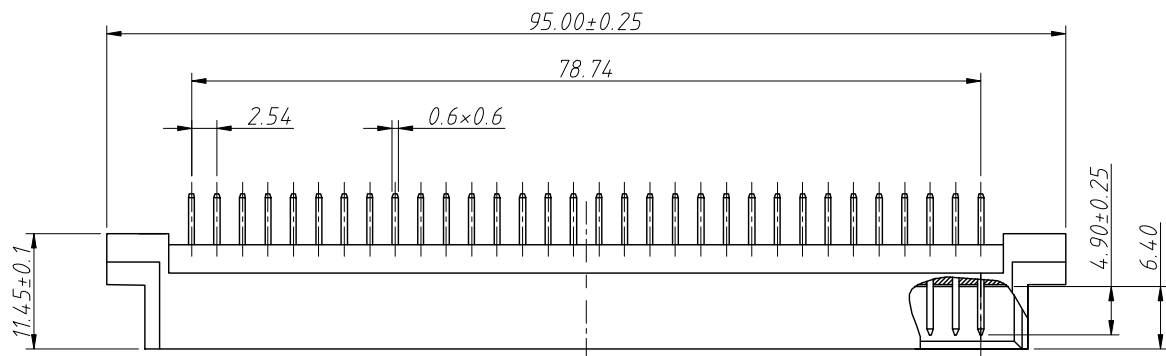

Material:  
 Housing:PBT+30%G.F UL 94V-0  
 Contacts:Copper Alloy,G/F Gold Plated

Electrical:  
 Current Rating:2 Amps  
 Contact Resistance:20 mΩ initial  
 Insulation Resistance:1000 MΩ min @ 500 V DC  
 Dielectric Withstanding Voltage:1000 V AC/minute  
 Operating temperature:-55°C ~ +125°C

Order Information

L-KLS1-D2- xxxx-M S

RoHS  
 SERISE NO.  
 Part NO.:2264  
 2132, 2232, 2116  
 M-Male  
 S-Straight pin

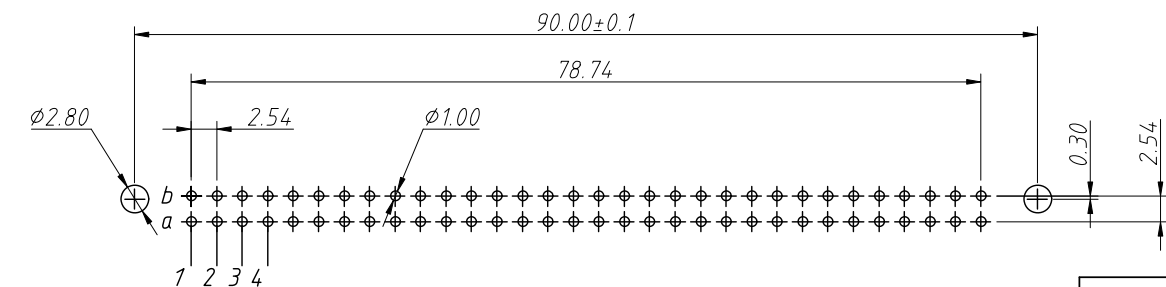
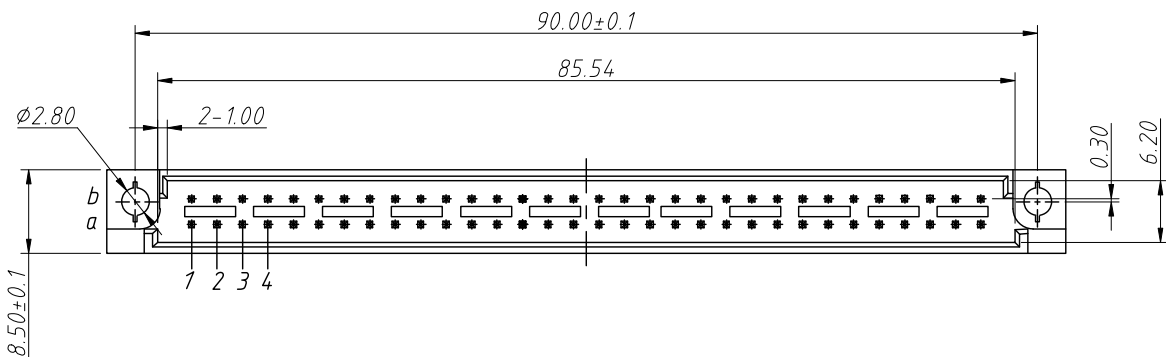

Recommended PCB Layout  
 Tolerance:±0.05mm

Pitch	Position	Rows with Contact	Contact Arrange	Part Number
2.54mm	64	a b		2264
	32	a -		2132
5.08mm	32	a b		2232
	16	a -		2116

ANGLE TOLERANCE	PROJECTION	Description:	DIN41612 Connector, 2x32Pin Two Row, Male, Straight pin
±3°			
GENERAL TOLERANCE	UNITS	mm	KLS P/N:
.x ±0.30	SHEET SIZE	A4	L-KLS1-D2-xxxx-MS
.xx ±0.20	Draw:	Song	2026-06-03
.xxx ±0.10	Check:	Daniel	2026-06-03



NingBo KLS ELECTRONIC CO.,L TD.

1 RoHS Compliance

REV	SYM	Revision Record	Appr.	Date
V0	KLS01011	New Version Release	Song	2026-06-03

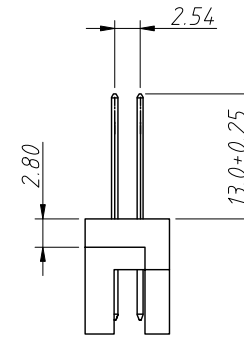
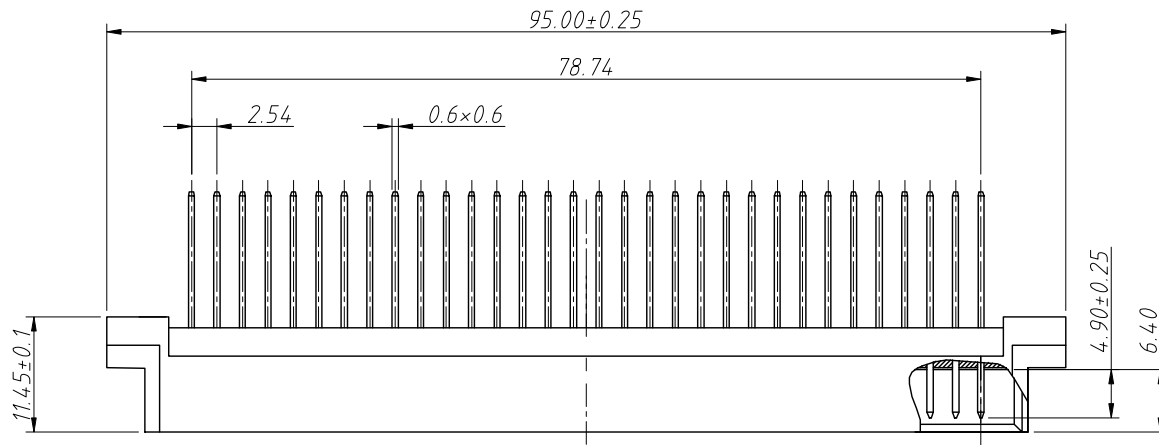

Material:  
 Housing:PBT+30%G.F UL94V-0  
 Contacts:Copper Alloy,G/F Gold Plated

Electrical:  
 Current Rating:2 Amps  
 Contact Resistance:20 mΩ initial  
 Insulation Resistance:1000 MΩ min @ 500 V DC  
 Dielectric Withstanding Voltage:1000 V AC/minute  
 Operating temperature:-55°C ~ +125°C

Order Information

L-KLS1-D2- xxxx-M W1

RoHS  
 SERISE NO.  
 Part NO.:2264  
 2132, 2232, 2116  
 M-Male  
 W1-13mm Straight pin

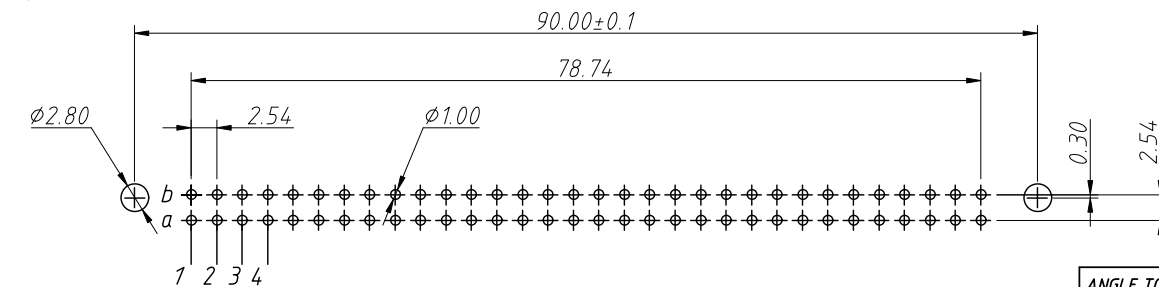
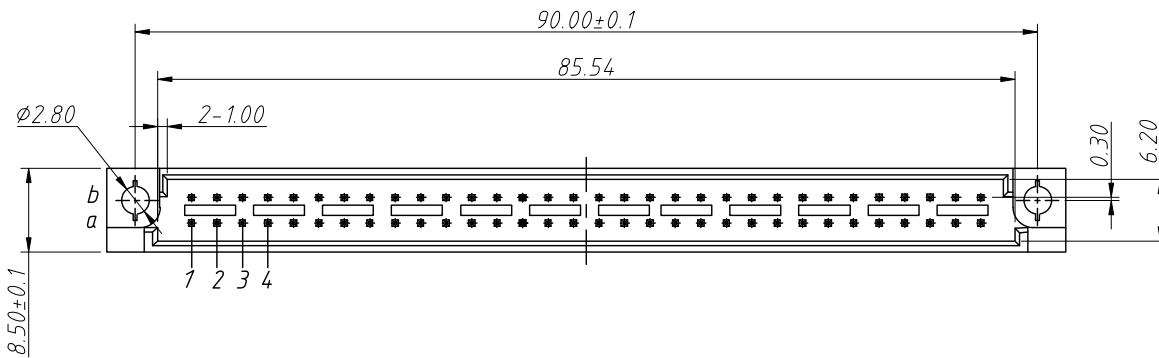

Recommended PCB Layout  
 Tolerance:±0.05mm

Pitch	Position	Rows with Contact	Contact Arrange	Part Number
2.54mm	64	a b		2264
	32	a -		2132
5.08mm	32	a b		2232
	16	a -		2116

ANGLE TOLERANCE	PROJECTION	Description:	DIN41612 Connector, 2x32Pin
±3°			Two Row, Male, Straight pin
GENERAL TOLERANCE	UNITS	mm	KLS P/N:
.x ±0.30	SHEET SIZE	A4	L-KLS1-D2-xxxx-MW1
.xx ±0.20	Draw:	Song	2026-06-03
.xxx ±0.10	Check:	Daniel	2026-06-03



NingBo KLS ELECTRONIC CO.,L TD.

1 RoHS Compliance

REV	SYM	Revision Record	Appr.	Date
V0	KLS01011	New Version Release	Song	2026-06-03

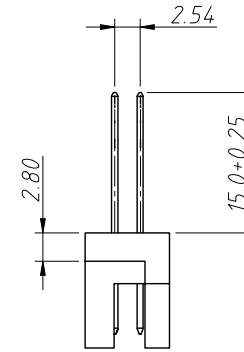
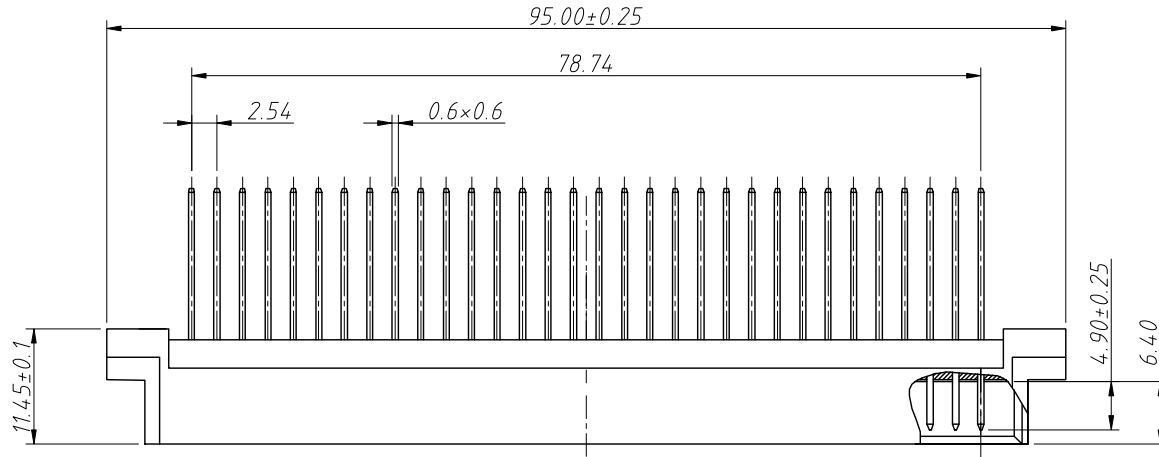

Material:  
 Housing:PBT+30%G.F UL94V-0  
 Contacts:Copper Alloy,G/F Gold Plated

Electrical:  
 Current Rating:2 Amps  
 Contact Resistance:20 mΩ initial  
 Insulation Resistance:1000 MΩ min @ 500 V DC  
 Dielectric Withstanding Voltage:1000 V AC/minute  
 Operating temperature:-55°C ~ +125°C

Order Information

L-KLS1-D2- xxxx-M W2

RoHS  
 SERISE NO.  
 Part NO.:2264  
 2132, 2232, 2116  
 M-Male  
 W2-15mm Straight pin

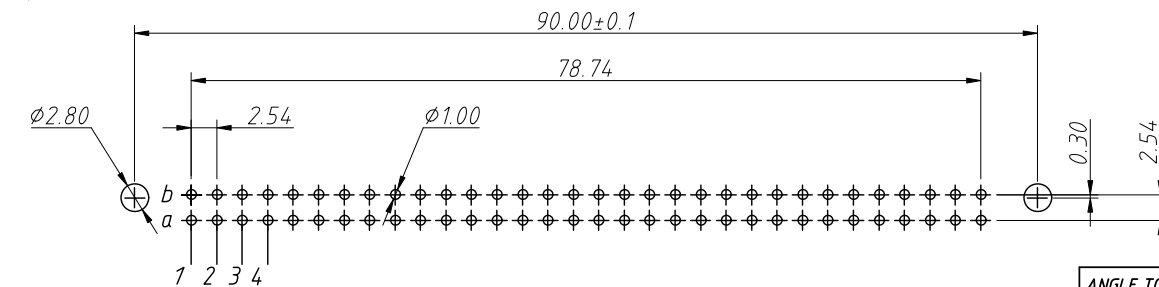
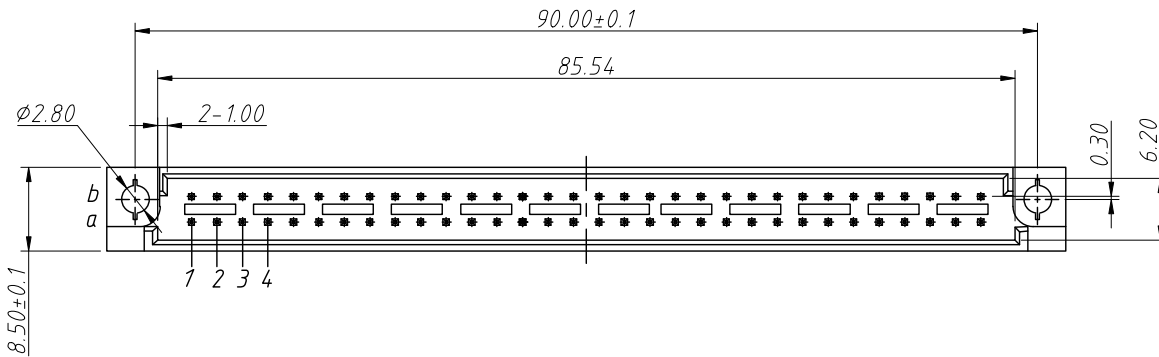

Recommended PCB Layout  
 Tolerance:±0.05mm

Pitch	Position	Rows with Contact	Contact Arrange	Part Number
2.54mm	64	a b		2264
	32	a -		2132
5.08mm	32	a b		2232
	16	a -		2116

ANGLE TOLERANCE	PROJECTION	Description:	DIN41612 Connector, 2x32Pin
±3°			Two Row, Male, Straight pin
GENERAL TOLERANCE	UNITS	mm	KLS P/N:
.x ±0.30	SHEET SIZE	A4	L-KLS1-D2-xxxx-MW2
.xx ±0.20	Draw:	Song	2026-06-03
.xxx ±0.10	Check:	Daniel	2026-06-03



NingBo KLS ELECTRONIC CO.,L TD.

1 RoHS Compliance

REV	SYM	Revision Record	Appr.	Date
V0	KLS01011	New Version Release	Song	2026-06-03

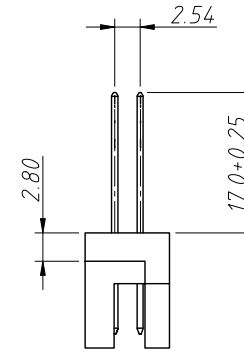
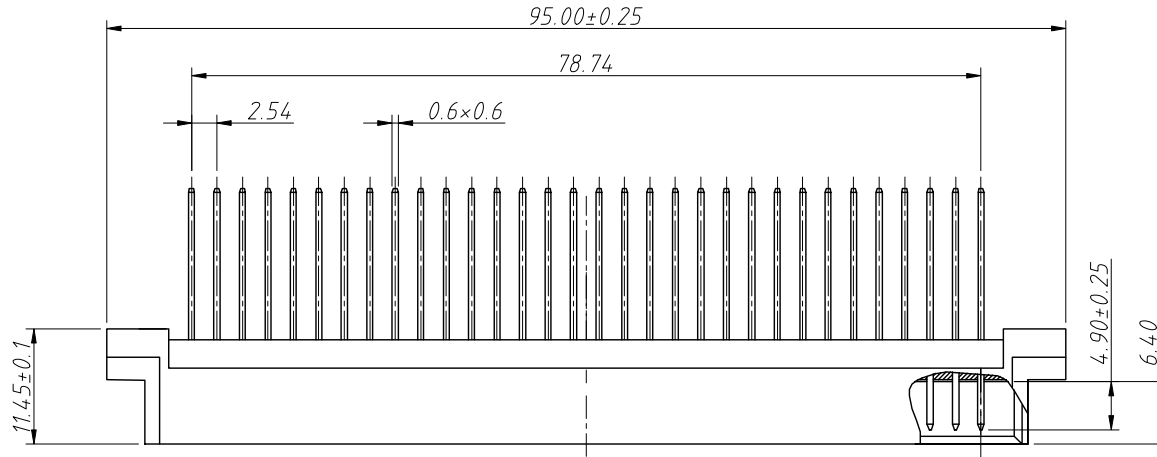

Material:  
 Housing:PBT+30%G.F UL 94V-0  
 Contacts:Copper Alloy,G/F Gold Plated

Electrical:  
 Current Rating:2 Amps  
 Contact Resistance:20 mΩ initial  
 Insulation Resistance:1000 MΩ min @ 500 V DC  
 Dielectric Withstanding Voltage:1000 V AC/minute  
 Operating temperature:-55°C ~ +125°C

Order Information

L-KLS1-D2- xxxx-M W3

RoHS  
 SERISE NO.  
 Part NO.:2264  
 2132, 2232, 2116  
 M-Male  
 W3-17mm Straight pin

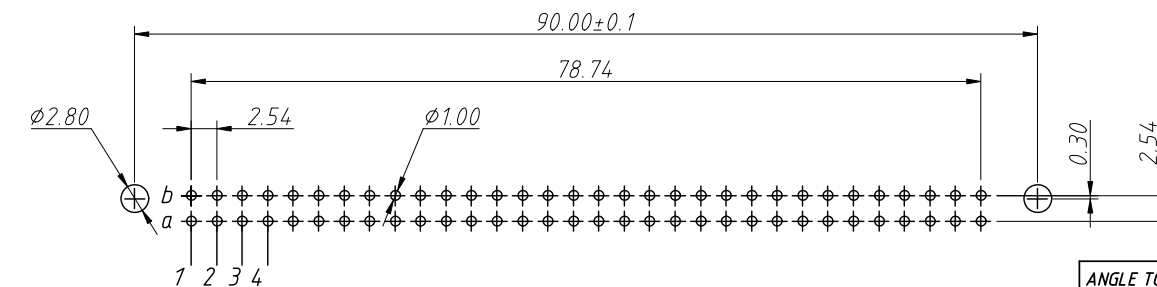
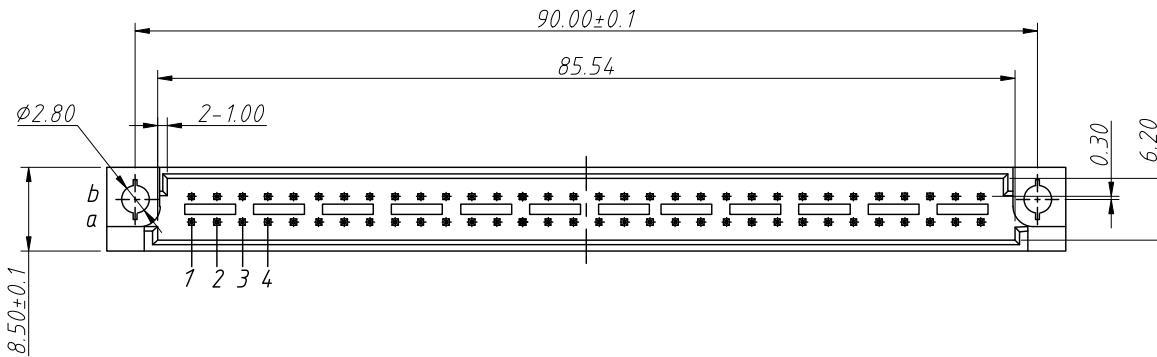

Recommended PCB Layout  
 Tolerance:±0.05mm

Pitch	Position	Rows with Contact	Contact Arrange	Part Number
2.54mm	64	a b		2264
	32	a -		2132
5.08mm	32	a b		2232
	16	a -		2116

ANGLE TOLERANCE	PROJECTION	Description:	DIN41612 Connector, 2x32Pin
±3°			Two Row, Male, Straight pin
GENERAL TOLERANCE	UNITS	mm	KLS P/N:
.x ±0.30	SHEET SIZE	A4	L-KLS1-D2-xxxx-MW3
.xx ±0.20	Draw:	Song	2026-06-03
.xxx ±0.10	Check:	Daniel	2026-06-03



NingBo KLS ELECTRONIC CO.,L TD.

1 RoHS Compliance

REV	SYM	Revision Record	Appr.	Date
V0	KLS01011	New Version Release	Song	2025-09-17

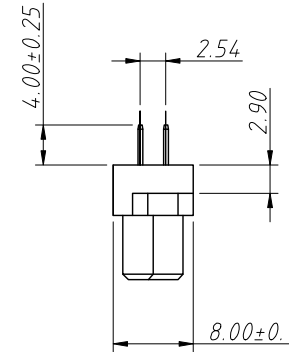
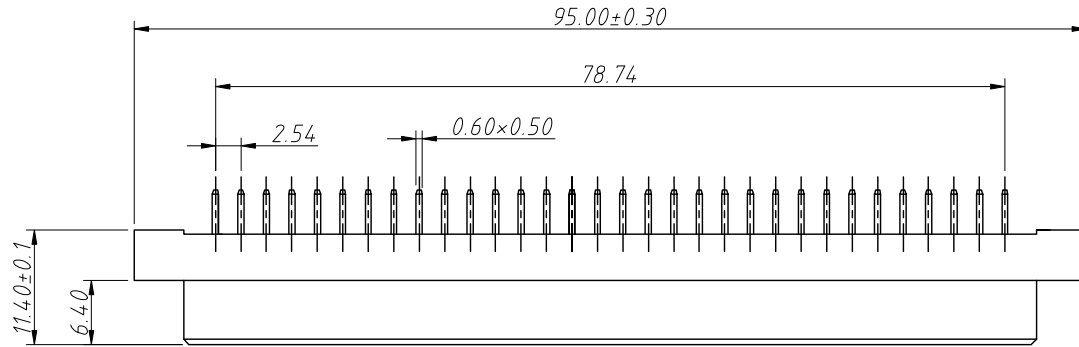

Material:  
 Housing: PBT+30%G.F UL 94V-0  
 Contacts: Copper Alloy, GF Gold Plated

Electrical:  
 Current Rating: 2 Amps  
 Contact Resistance: 20 mΩ initial  
 Insulation Resistance: 1000 MΩ min @ 500 V DC  
 Dielectric Withstanding Voltage: 1000 V AC/minute  
 Operating temperature: -55°C To +125°C

Order Information

L-KLS1-D2-xxxx-F S

RoHS   
 SERISE NO. \_\_\_\_\_  
 Part Number: 2264.  
 2132.2232.2116  
 F-Female \_\_\_\_\_  
 S-Straight Pin \_\_\_\_\_

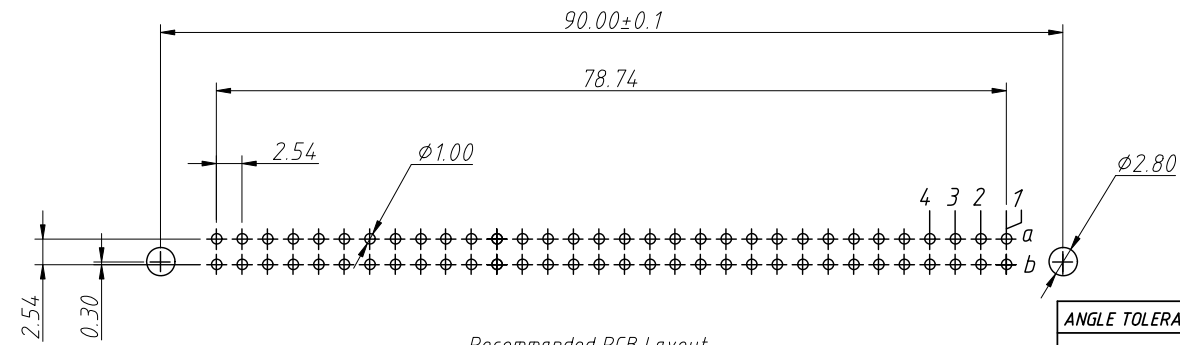
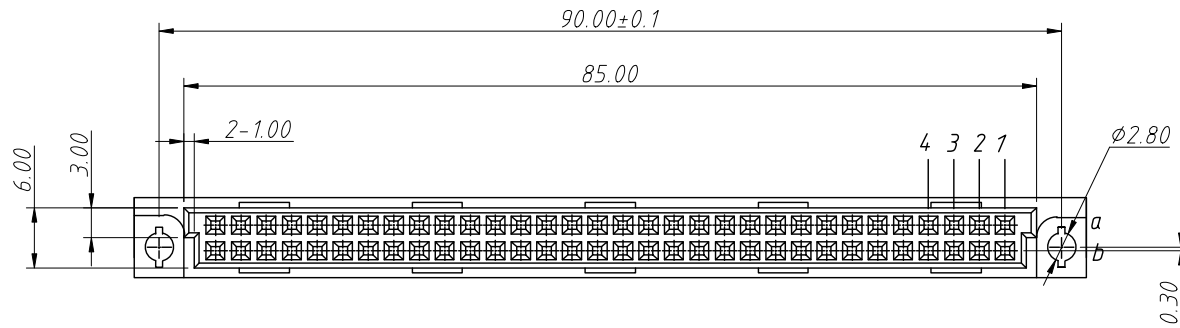

Recommended PCB Layout  
 Tolerance: ±0.05mm

Pitch	Position	Rows with Contact	Contact Arrange	Part Number
2.54mm	64	a b		2264
	32	a-		2132
5.08mm	32	a b		2232
	16	a-		2116

ANGLE TOLERANCE	PROJECTION	Description:	DIN41612 Connector, 2x32Pin
±3°			2 Row, Female, Straight Pin
GENERAL TOLERANCE	UNITS	mm	KLS P/N:
.x ±0.30	SHEET SIZE	A4	L-KLS1-D2-xxxx-FS
.xx ±0.20	Draw:	Song	2025-09-17
.xxx ±0.10	Check:	Daniel	2025-09-17



NingBo KLS ELECTRONIC CO.,L TD.

1 RoHS Compliance

REV	SYM	Revision Record	Appr.	Date
V0	KLS01011	New Version Release	Song	2026-06-02

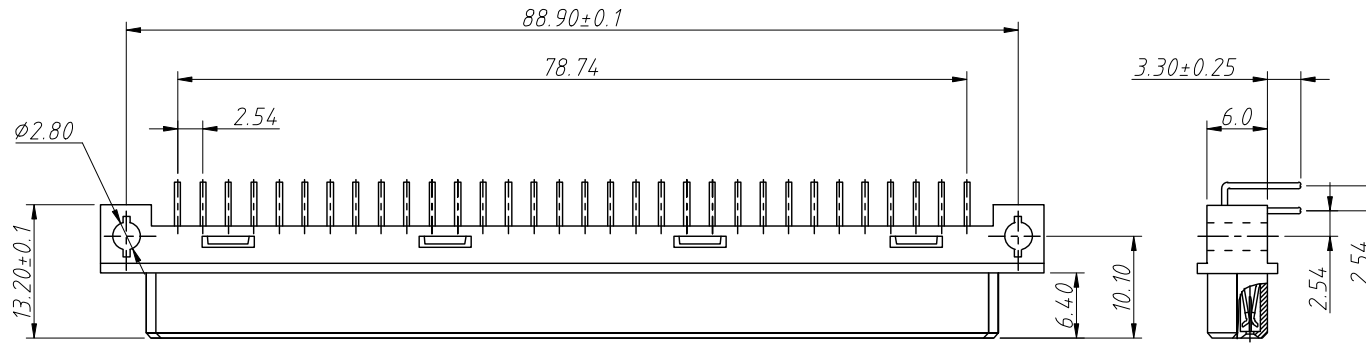

Material:  
Housing:PBT+30%G.F UL 94V-0  
Contacts:Copper Alloy,G/F Gold Plated

Electrical:  
Current Rating:2 Amps  
Contact Resistance:20 mΩ initial  
Insulation Resistance:1000 MΩ min @ 500 V DC  
Dielectric Withstanding Voltage:1000 V AC/minute  
Operating temperature:-55°C ~ +125°C

Order Information

L-KLS1-D2- xxxx- FR

RoHS  
SERISE NO.  
Part NO.:2264  
2132, 2232, 2116  
F-Female  
R-Right angle pin

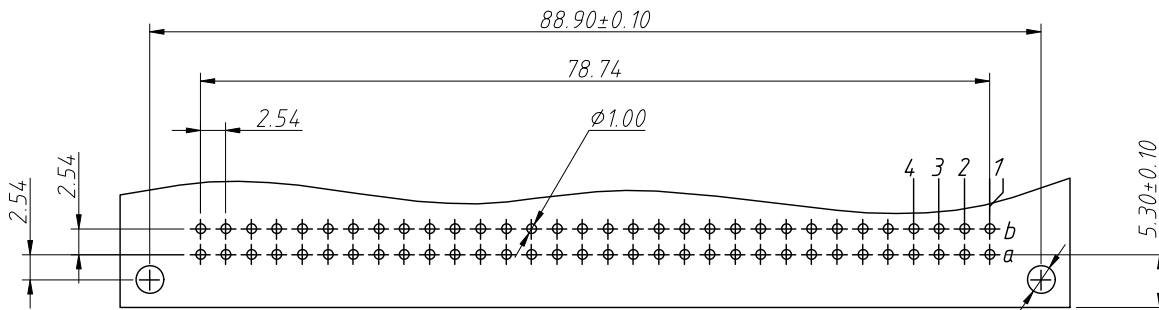
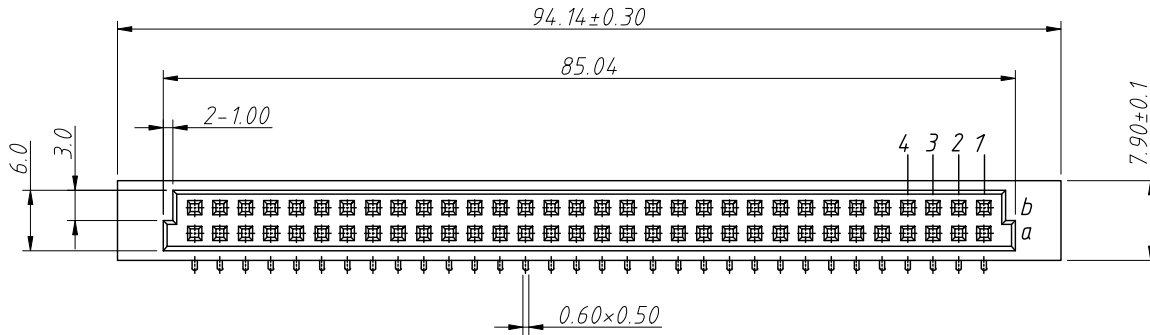

Recommended PCB Layout  
Tolerance:±0.05mm

2.80<sup>+0.10</sup><sub>-0.00</sub>

Pitch	Position	Rows with Contact	Contact Arrange	Part Number
2.54mm	64	a b		2264
	32	a -		2132
5.08mm	32	a b		2232
	16	a -		2116

ANGLE TOLERANCE	PROJECTION	Description: DIN4 1612 Connector, 2x32Pin Two Row, Female, Right angle pin		
±3°				
GENERAL TOLERANCE	UNITS	mm	KLS P/N:	L-KLS1-D2-xxxx-FR
.x ±0.30	SHEET SIZE	A4		
.xx ±0.20	Draw:	Song	2026-06-02	NingBo KLS ELECTRONIC CO.,L TD.
.xxx ±0.10	Check:	Daniel	2026-06-02	

RoHS Compliance

REV	SYM	Revision Record	Appr.	Date
V0	KLS01011	New Version Release	Song	2026-04-09

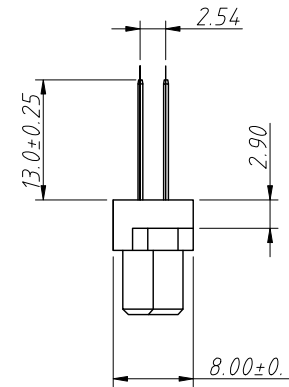
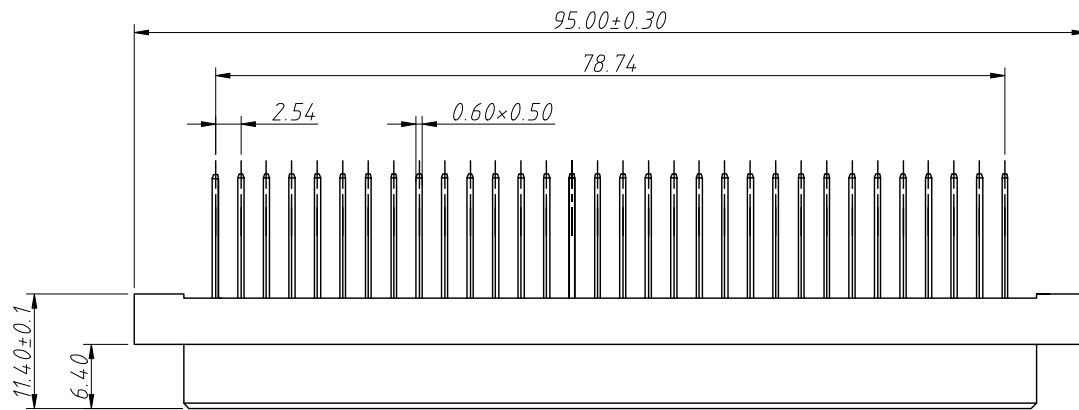

Material:

Housing: PBT+30%G.F UL94V-0

Contacts: Copper Alloy, GF Gold Plated

Electrical:

Current Rating: 2 Amps

Contact Resistance: 20 mΩ initial

Insulation Resistance: 1000 MΩ min @ 500 V DC

Dielectric Withstanding Voltage: 1000 V AC/minute

Operating temperature: -55°C To +125°C

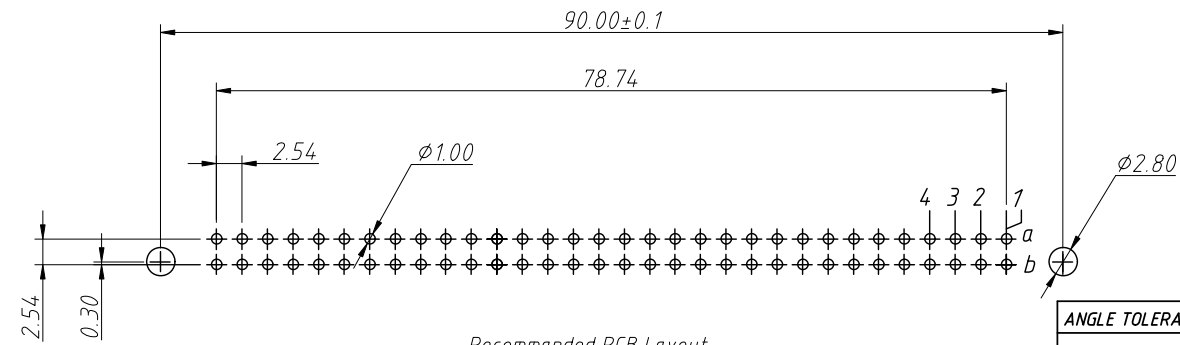
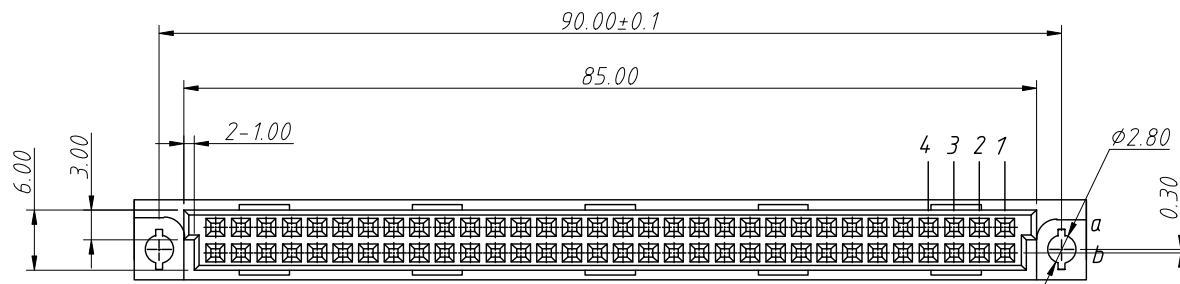

Recommended PCB Layout  
Tolerance: ±0.05mm

Order Information

L-KLS1-D2-xxxx- F W1

RoHS

SERISE NO.

Part Number: 2264.

2132.2232.2116

F-Female

W1-13mm Straight pin

Pitch	Position	Rows with Contact	Contact Arrange	Part Number
2.54mm	64	a b		2264
	32	a-		2132
5.08mm	32	a b		2232
	16	a-		2116

ANGLE TOLERANCE	PROJECTION	Description:	DIN41612 Connector, 2x32Pin
±3°			2 Row, Female, Straight Pin
GENERAL TOLERANCE	UNITS	mm	KLS P/N:
.x ±0.30	SHEET SIZE	A4	L-KLS1-D2-xxxx-FW1
.xx ±0.20	Draw:	Song	2026-04-09
.xxx ±0.10	Check:	Daniel	2026-04-09



NingBo KLS ELECTRONIC CO.,L TD.

RoHS Compliance

REV	SYM	Revision Record	Appr.	Date
V0	KLS01011	New Version Release	Song	2026-06-02

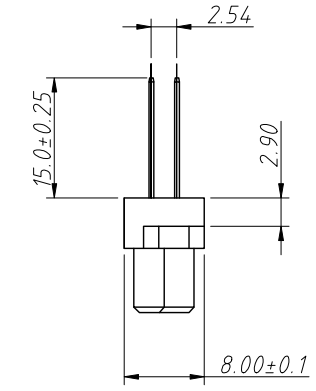
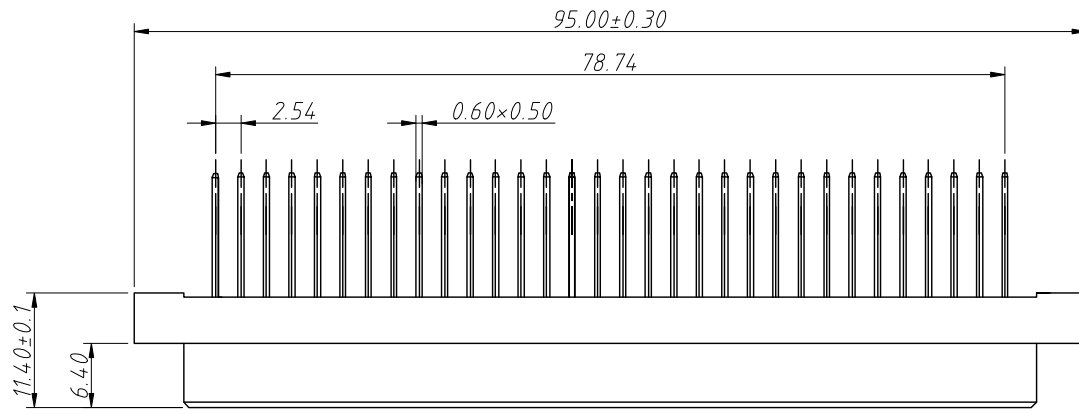

Material:

Housing: PBT+30%G.F UL 94V-0

Contacts: Copper Alloy, GF Gold Plated

Electrical:

Current Rating: 2 Amps

Contact Resistance: 20 mΩ initial

Insulation Resistance: 1000 MΩ min @ 500 V DC

Dielectric Withstanding Voltage: 1000 V AC/minute

Operating temperature: -55°C To +125°C

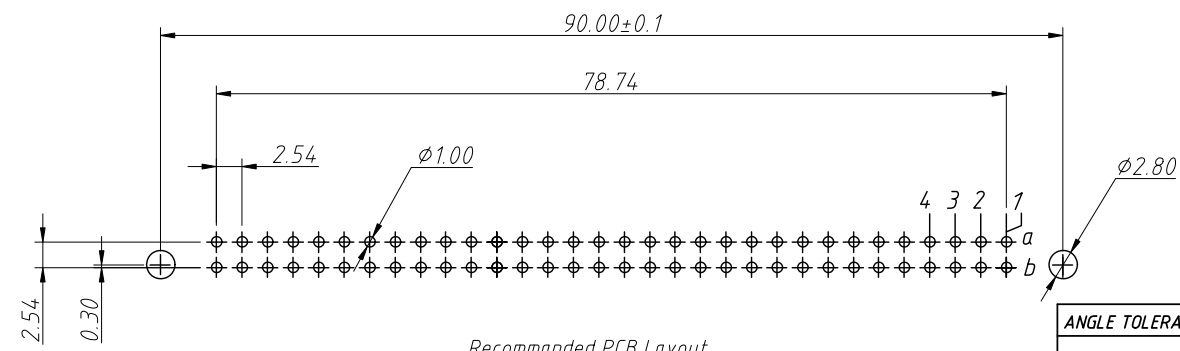
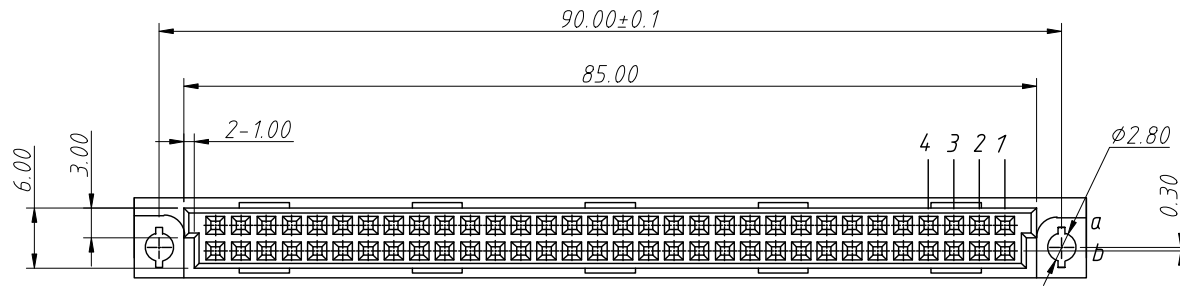

Recommended PCB Layout  
Tolerance: ±0.05mm

Order Information

L-KLS1-D2-2264-F W2

RoHS

SERISE NO.

Part Number: 2264.

2132.2232.2116

F-Female

W2-15mm Straight pin

Pitch	Position	Rows with Contact	Contact Arrange	Part Number
2.54mm	64	a b		2264
	32	a-		2132
5.08mm	32	a b		2232
	16	a-		2116

ANGLE TOLERANCE	PROJECTION	Description:	DIN41612 Connector, 2x32Pin
±3°			2 Row, Female, Straight Pin
GENERAL TOLERANCE	UNITS	mm	KLS P/N:
.x ±0.30	SHEET SIZE	A4	L-KLS1-D2-xxxx-FW2
.xx ±0.20	Draw:	Song	2026-06-02
.xxx ±0.10	Check:	Daniel	2026-06-02



NingBo KLS ELECTRONIC CO.,L TD.

1 RoHS Compliance

REV	SYM	Revision Record	Appr.	Date
V0	KLS01011	New Version Release	Song	2026-06-02

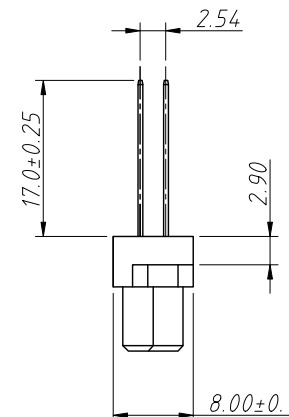
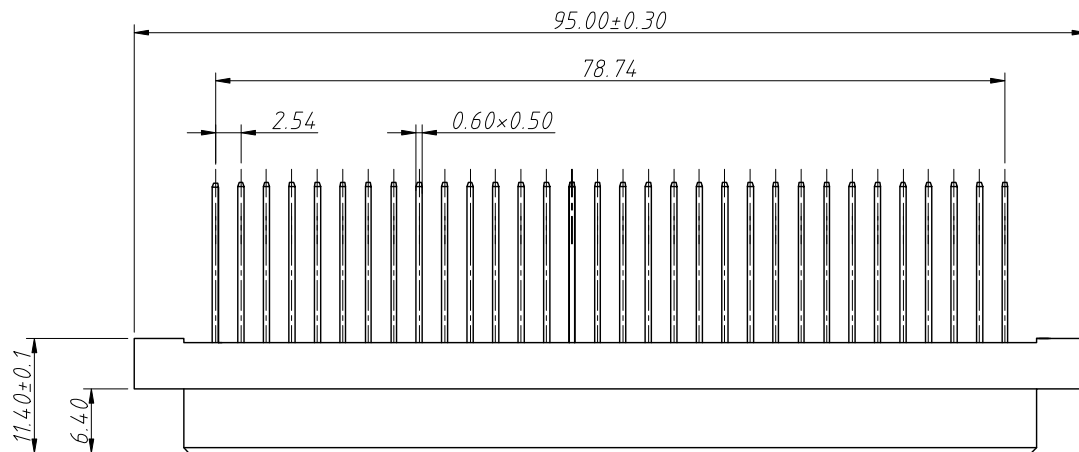

Material:  
 Housing:PBT+30%G.F UL 94 V-0  
 Contacts:Copper Alloy,GF Gold Plated

Electrical:  
 Current Rating:2 Amps  
 Contact Resistance:20 mΩ initial  
 Insulation Resistance:1000 MΩ min @ 500 V DC  
 Dielectric Withstanding Voltage:1000 V AC/minute  
 Operating temperature:-55°C To +125°C

Order Information

L-KLS1-D2-2264-F W3

RoHS  
 SERISE NO.  
 Part Number:2264.  
 2132.2232.2116  
 F-Female  
 W3-17mm Straight pin

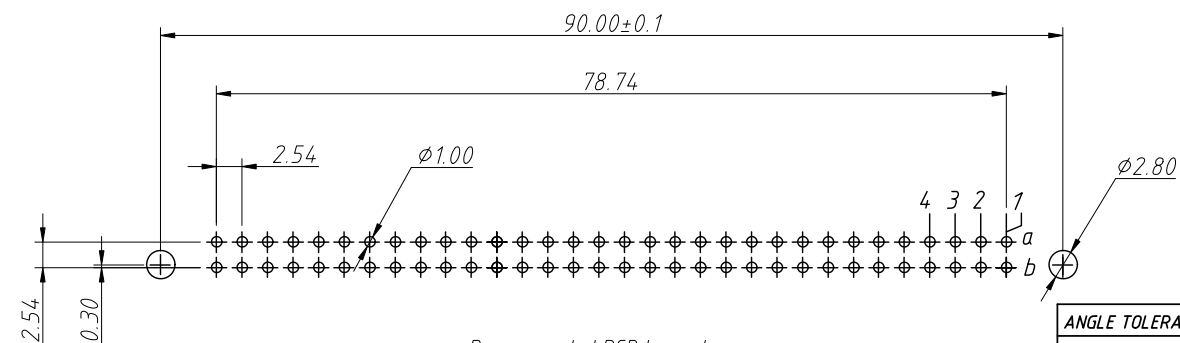
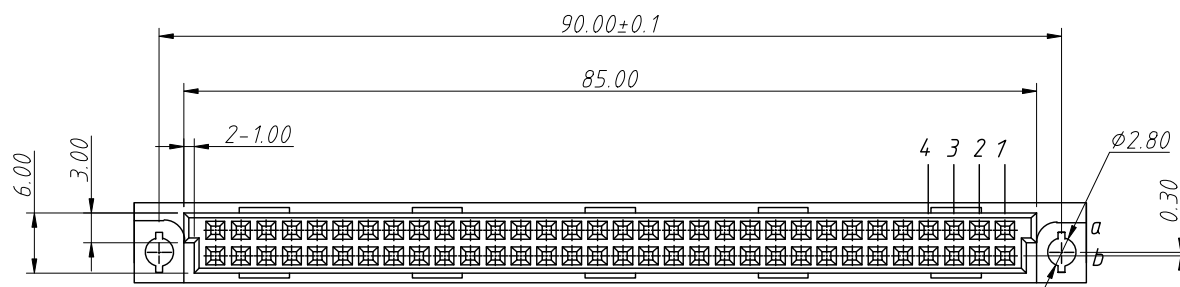

Recommended PCB Layout  
 Tolerance:±0.05mm

Pitch	Position	Rows with Contact	Contact Arrange	Part Number
2.54mm	64	a b		2264
	32	a-		2132
5.08mm	32	a b		2232
	16	a-		2116

ANGLE TOLERANCE	PROJECTION	Description:	DIN41612 Connector, 2x32Pin
±3°			2 Row, Female, Straight Pin
GENERAL TOLERANCE	UNITS	mm	KLS P/N:
.x ±0.30	SHEET SIZE	A4	L-KLS1-D2-xxxx-FW3
.xx ±0.20	Draw:	Song	2026-06-02
.xxx ±0.10	Check:	Daniel	2026-06-02



NingBo KLS ELECTRONIC CO.,L TD.