

1 RoHS Compliance

REV	SYM	Revision Record	Appr.	Date
V0	KLS01011	New Version Release	Song	2026-06-09

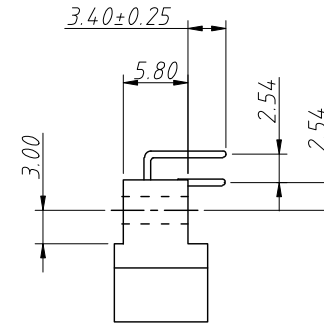
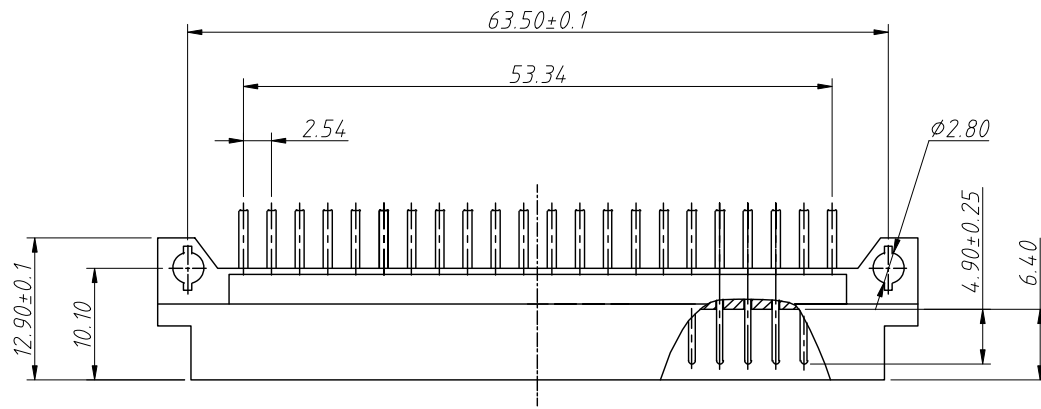

Material:
Housing:PBT+30%G.F UL94V-0
Contacts:Copper Alloy,G/F Gold Plated

Electrical:
Current Rating:2 Amps
Contact Resistance:20 mΩ initial
Insulation Resistance:1000 MΩ min @ 500 V DC
Dielectric Withstanding Voltage:1000 V AC/minute
Operating temperature:-55°C ~ +125°C

Order Information

L-KLS1-D2Y- xxxx-M R

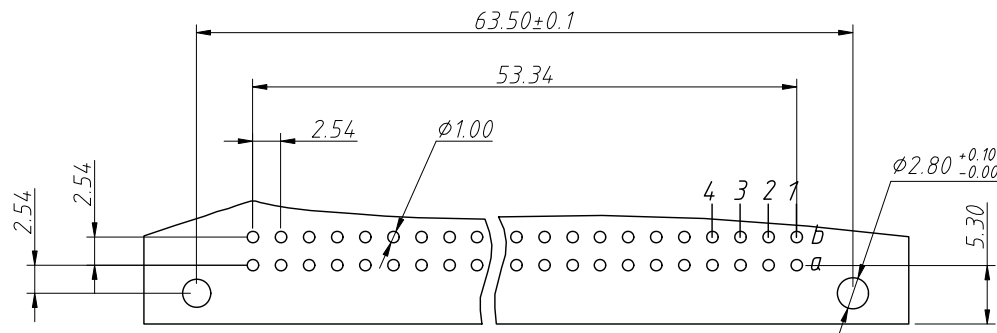
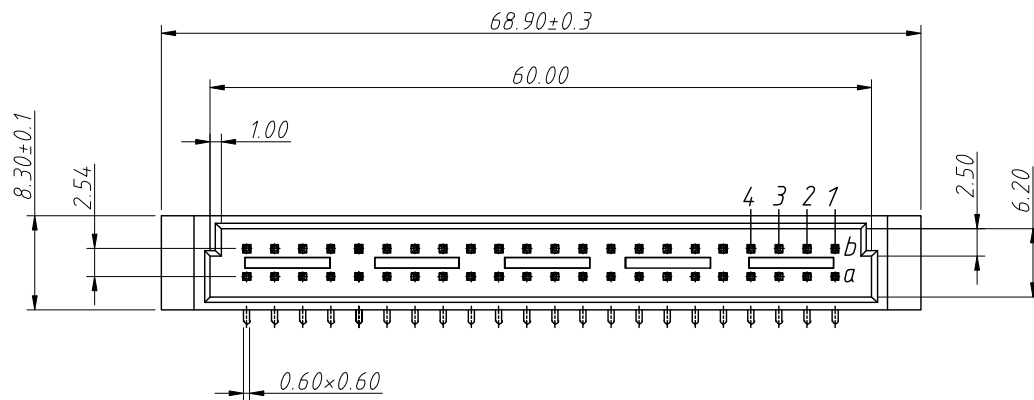
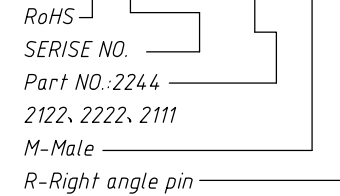

Recommended PCB Layout
Tolerance:±0.05mm

Pitch	Position	Rows with Contact	Contact Arrange	Part Number
2.54mm	44	a b		2244
	22	a -		2122
5.08mm	22	a b		2222
	11	a -		2111

ANGLE TOLERANCE	PROJECTION	Description:	DIN41612 Connector, 2x22Pin Two Row, Male, Right angle pin	
±3°			L-KLS1-D2Y-xxxx-MR	
GENERAL TOLERANCE	UNITS	mm	KLS P/N:	
.x ±0.30	SHEET SIZE	A4		
.xx ±0.20	Draw:	Song	2026-06-09	NingBo KLS ELECTRONIC CO.,L TD.
.xxx ±0.10	Check:	Daniel	2026-06-09	

1 RoHS Compliance

REV	SYM	Revision Record	Appr.	Date
V0	KLS01011	New Version Release	Song	2026-06-08

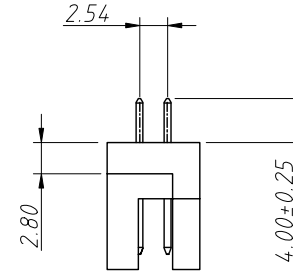
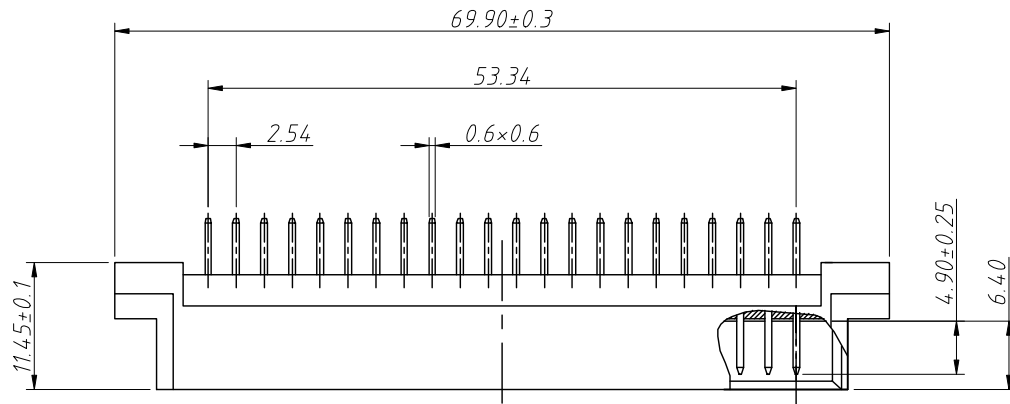

Material:
 Housing:PBT+30%G.F UL94V-0
 Contacts:Copper Alloy,G/F Gold Plated

Electrical:
 Current Rating:2 Amps
 Contact Resistance:20 mΩ initial
 Insulation Resistance:1000 MΩ min @ 500 V DC
 Dielectric Withstanding Voltage:1000 V AC/minute
 Operating temperature:-55°C ~ +125°C

Order Information

L-KLS1-D2Y- xxxx-M S

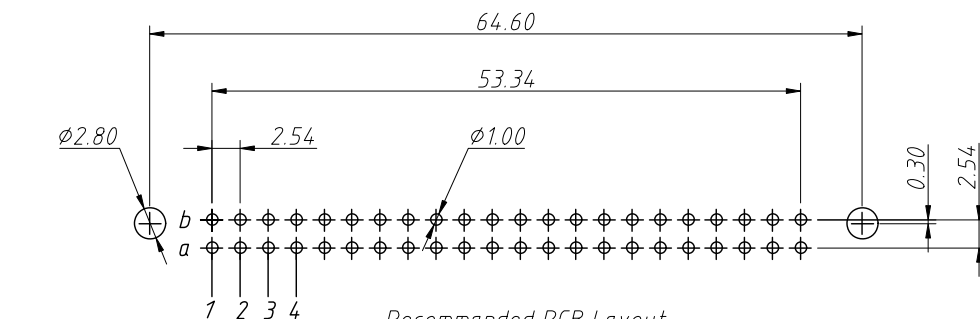
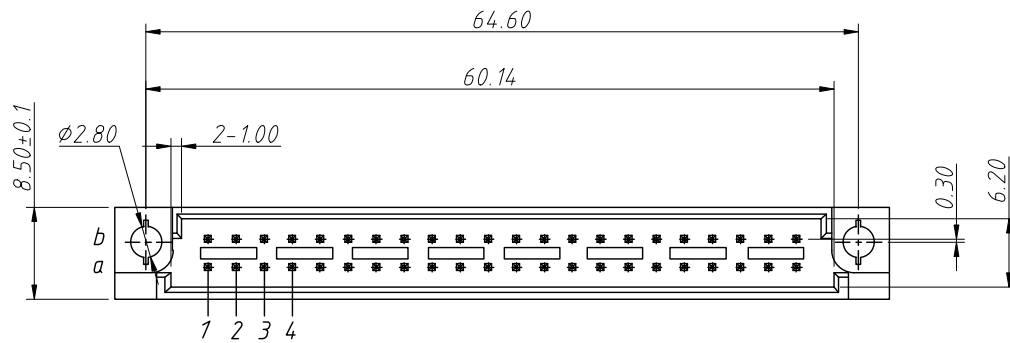
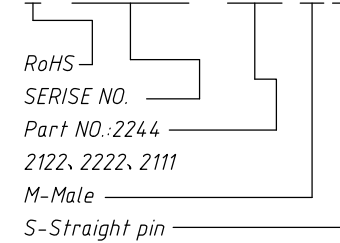

Recommended PCB Layout
 Tolerance:±0.05mm

Pitch	Position	Rows with Contact	Contact Arrange	Part Number
2.54mm	44	a b		2244
	22	a -		2122
5.08mm	22	a b		2222
	11	a -		2111

ANGLE TOLERANCE	PROJECTION	Description:	DIN41612 Connector, 2x22Pin Two Row, Male, Straight pin
±3°			
GENERAL TOLERANCE	UNITS	mm	KLS P/N: L-KLS1-D2Y-xxxx-MS
.x ±0.30	SHEET SIZE	A4	
.xx ±0.20	Draw:	Song	2026-06-08
.xxx ±0.10	Check:	Daniel	2026-06-08



NingBo KLS ELECTRONIC CO.,L TD.

1 RoHS Compliance

REV	SYM	Revision Record	Appr.	Date
V0	KLS01011	New Version Release	Song	2026-06-08

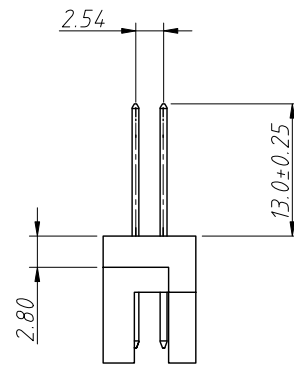
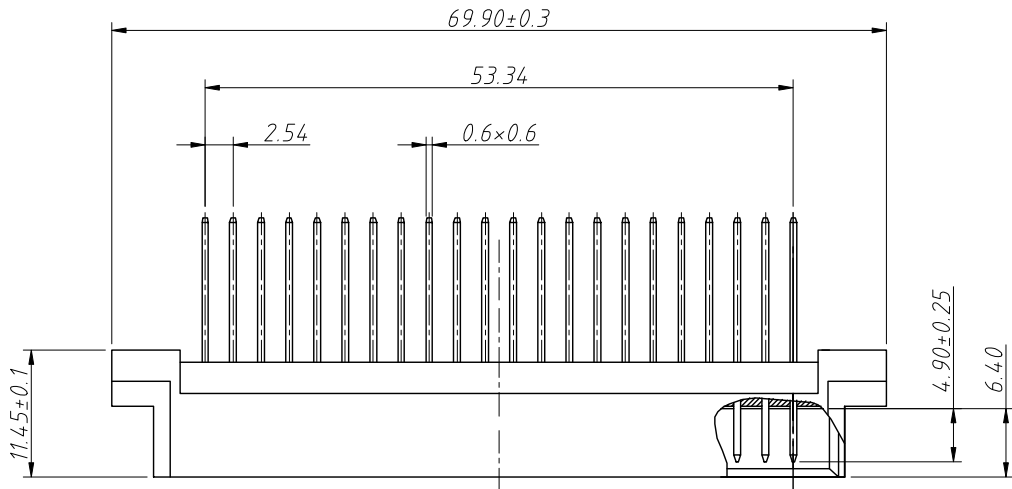

Material:
 Housing:PBT+30%G.F UL94V-0
 Contacts:Copper Alloy,G/F Gold Plated

Electrical:
 Current Rating:2 Amps
 Contact Resistance:20 mΩ initial
 Insulation Resistance:1000 MΩ min @ 500 V DC
 Dielectric Withstanding Voltage:1000 V AC/minute
 Operating temperature:-55°C ~ +125°C

Order Information
 L-KLS1-D2Y-xxxx-M W1

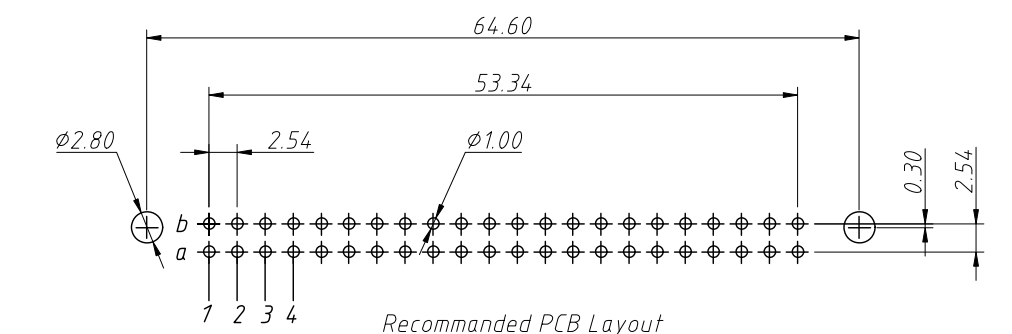
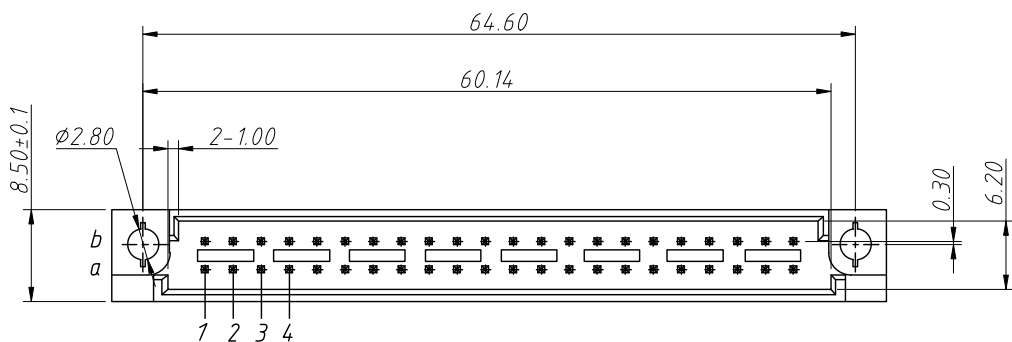
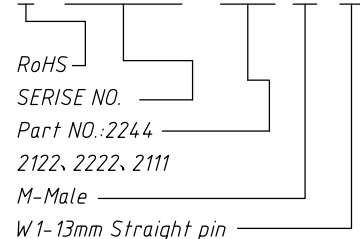

Recommended PCB Layout
 Tolerance:±0.05mm

Pitch	Position	Rows with Contact	Contact Arrange	Part Number
2.54mm	44	a b		2244
	22	a -		2122
5.08mm	22	a b		2222
	11	a -		2111

ANGLE TOLERANCE	PROJECTION	Description: DIN41612 Connector, 2x22Pin Two Row, Male, Straight pin		
±3°				
GENERAL TOLERANCE	UNITS	mm	KLS P/N:	L-KLS1-D2Y-xxxx-MW1
.x ±0.30	SHEET SIZE	A4		
.xx ±0.20	Draw:	Song	2026-06-08	NingBo KLS ELECTRONIC CO.,L TD.
.xxx ±0.10	Check:	Daniel	2026-06-08	

1 RoHS Compliance

REV	SYM	Revision Record	Appr.	Date
V0	KLS01011	New Version Release	Song	2026-06-08

Material:
 Housing:PBT+30%G.F UL94V-0
 Contacts:Copper Alloy,G/F Gold Plated

Electrical:
 Current Rating:2 Amps
 Contact Resistance:20 mΩ initial
 Insulation Resistance:1000 MΩ min @ 500 V DC
 Dielectric Withstanding Voltage:1000 V AC/minute
 Operating temperature:-55°C ~ +125°C

Order Information

L-KLS1-D2Y- xxxx-F R

RoHS
 SERISE NO.
 Part NO.:2244
 2122, 2222, 2111
 F-Female
 R-Right angle pin

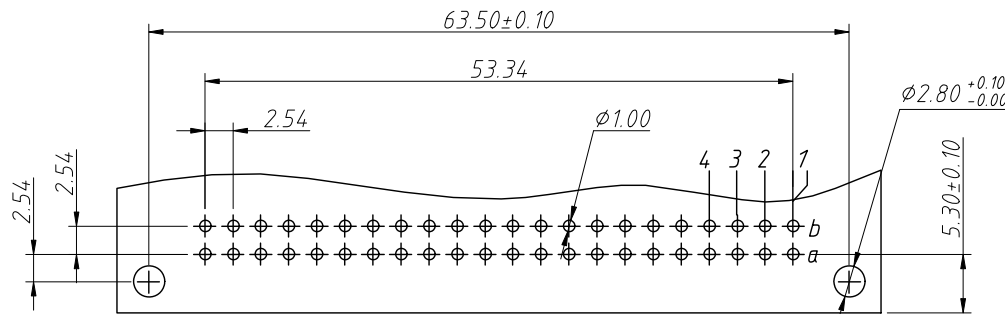
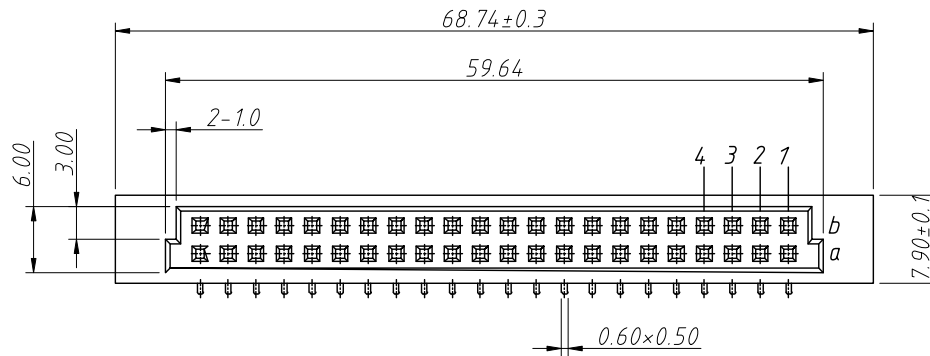
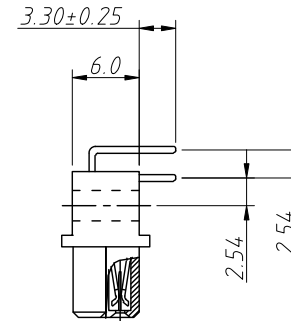
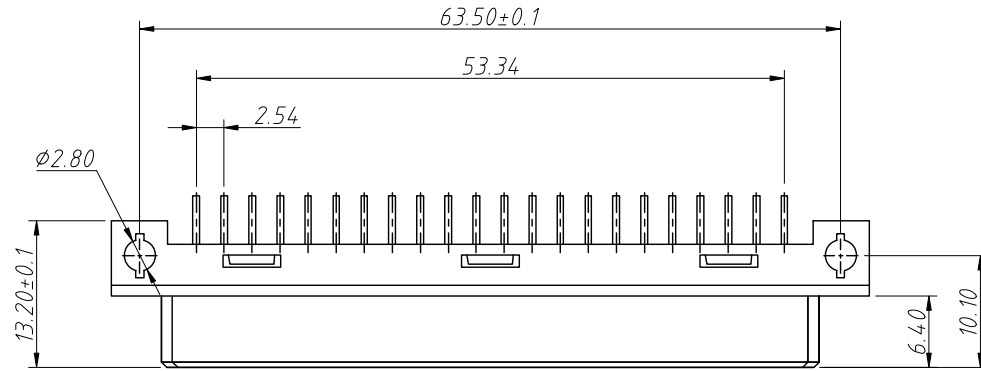

Recommended PCB Layout
 Tolerance:±0.05mm

Pitch	Position	Rows with Contact	Contact Arrange	Part Number
2.54mm	44	a b		2244
	22	a -		2122
5.08mm	22	a b		2222
	11	a -		2111

ANGLE TOLERANCE	PROJECTION	Description:	DIN41612 Connector, 2x22Pin	
±3°			Two Row, Female, Right angle pin	
GENERAL TOLERANCE	UNITS	mm	KLS P/N:	L-KLS1-D2Y-xxxx-FR
.x ±0.30	SHEET SIZE	A4		
.xx ±0.20	Draw:	Song	2026-06-08	NingBo KLS ELECTRONIC CO.,L TD.
.xxx ±0.10	Check:	Daniel	2026-06-08	

RoHS Compliance

REV	SYM	Revision Record	Appr.	Date
V0	KLS01011	New Version Release	Song	2026-06-08

Material:

Housing: PBT+30%G.F UL94V-0

Contacts: Copper Alloy, G/F Gold Plated

Electrical:

Current Rating: 2 Amps

Contact Resistance: 20 mΩ initial

Insulation Resistance: 1000 MΩ min @ 500 V DC

Dielectric Withstanding Voltage: 1000 V AC/minute

Operating temperature: -55°C ~ +125°C

Order Information

L-KLS1-D2Y- xxxx-F S

RoHS

SERISE NO.

Part NO.: 2244

2122, 2222, 2111

F-Female

S-Straight pin

Pitch	Position	Rows with Contact	Contact Arrange	Part Number
2.54mm	44	a b		2244
	22	a -		2122
5.08mm	22	a b		2222
	11	a -		2111

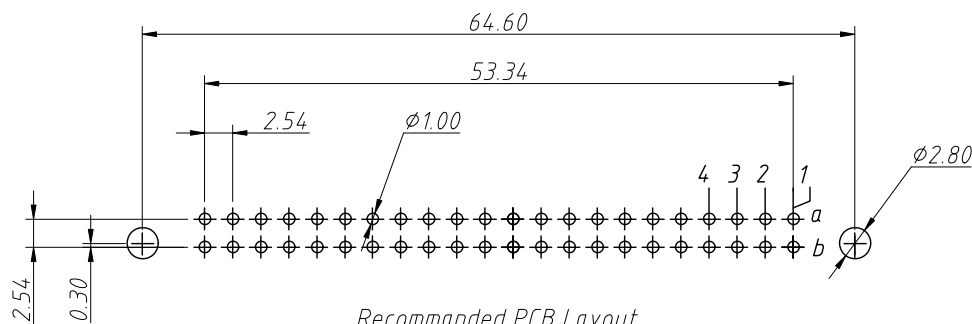
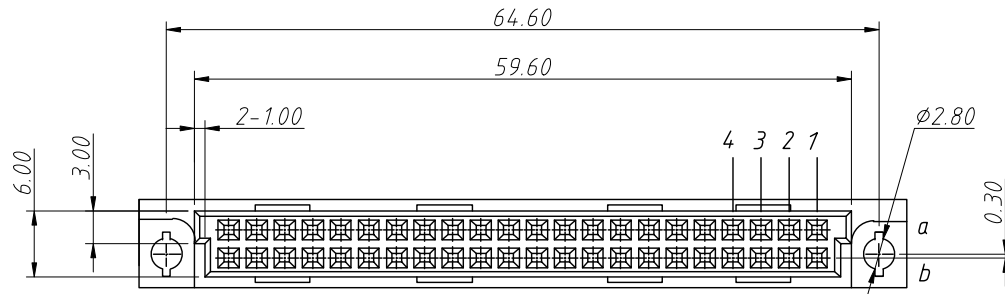
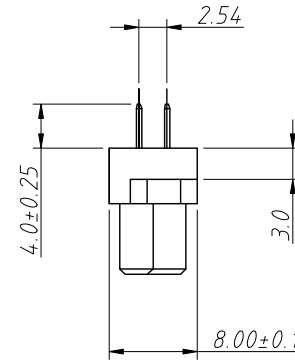
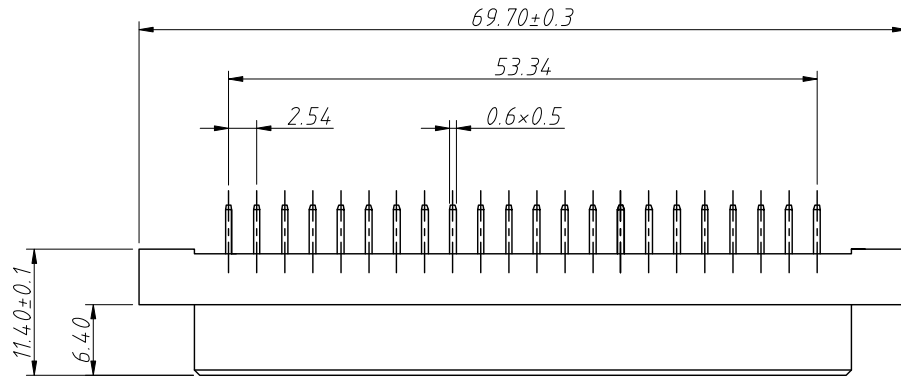

Recommended PCB Layout
Tolerance: ±0.05mm

ANGLE TOLERANCE	PROJECTION	Description:	DIN41612 Connector, 2x22Pin
±3°			Two Row, Female, Straight pin
GENERAL TOLERANCE	UNITS	mm	KLS P/N:
.x ±0.30	SHEET SIZE	A4	L-KLS1-D2Y-xxxx-FS
.xx ±0.20	Draw:	Song	2026-06-08
.xxx ±0.10	Check:	Daniel	2026-06-08



NingBo KLS ELECTRONIC CO., L TD.

1 RoHS Compliance

REV	SYM	Revision Record	Appr.	Date
V0	KLS01011	New Version Release	Song	2026-06-09

Material:
 Housing:PBT+30%G.F UL94V-0
 Contacts:Copper Alloy,G/F Gold Plated

Electrical:
 Current Rating:2 Amps
 Contact Resistance:20 mΩ initial
 Insulation Resistance:1000 MΩ min @ 500 V DC
 Dielectric Withstanding Voltage:1000 V AC/minute
 Operating temperature:-55°C ~ +125°C

Order Information

L-KLS1-D2Y- xxxx-F W1

RoHS
 SERISE NO.
 Part NO.:2244
 2122, 2222, 2111
 F-Female
 W1-13mm Straight pin

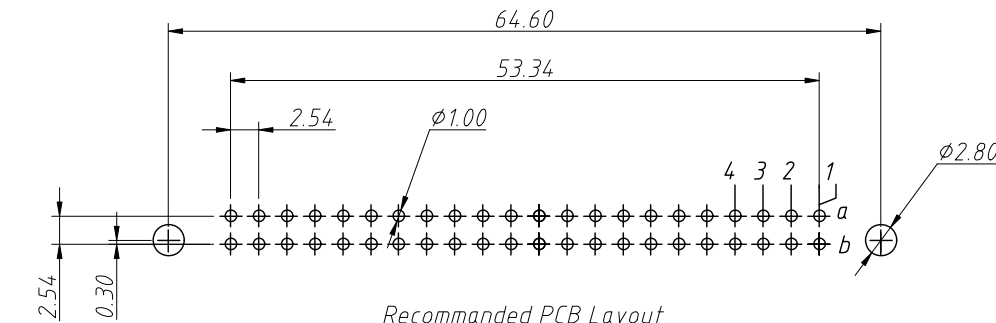
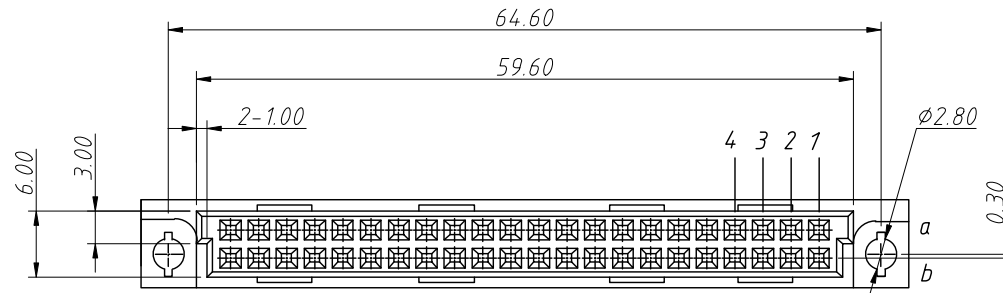
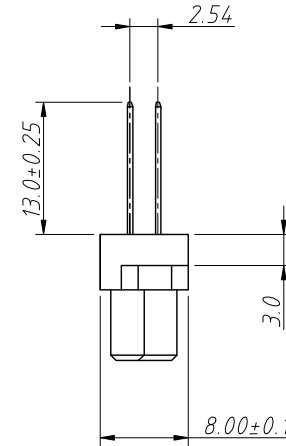
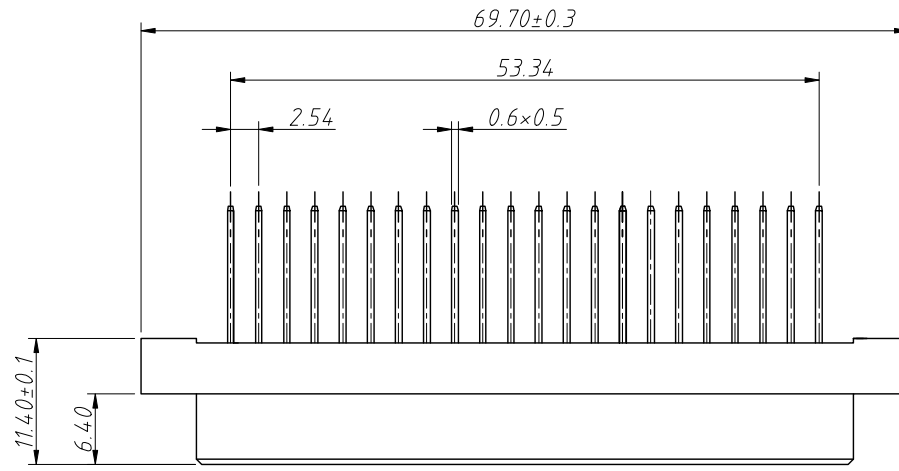

Recommended PCB Layout
 Tolerance:±0.05mm

Pitch	Position	Rows with Contact	Contact Arrange	Part Number
2.54mm	44	a b	4 3 2 1 	2244
	22	a -	4 3 2 1 	2122
5.08mm	22	a b	4 3 2 1 	2222
	11	a -	4 3 2 1 	2111

ANGLE TOLERANCE	PROJECTION	Description:	DIN41612 Connector, 2x22Pin Two Row, Female, Straight pin
±3°			
GENERAL TOLERANCE	UNITS	mm	KLS P/N: L-KLS1-D2Y-xxxx-FW1
.x ±0.30	SHEET SIZE	A4	
.xx ±0.20	Draw:	Song	2026-06-09
.xxx ±0.10	Check:	Daniel	2026-06-09



NingBo KLS ELECTRONIC CO.,L TD.