

# Product Specification

Number: L-KLS7-LPB-M16-02D-R

Name: LED pushbutton switches

Customer: \_\_\_\_\_

Date: 2025-08-14

Customer Signature:



**NINGBO KLS ELECTRONIC CO; LTD**

**Tel : 0086-574-86828566**

**Fax : 0086-574-86824882**

**ADD : NO. 8-1, RONGXIA RD. XIAPU SHANQIAN  
INDUSTRIAL ZONE BEILUN NINGBO ZHEJIANG.**

Compi	Check	Review	Approva
Jenny	Jack.C		

Part name	LED pushbutton switches	Date	2025-08-14
Part number	L-KLS7-LPB-M16-02D-R	Edition	V1
Department		Page	2 / 3

1. Electrical parameters	3A 250VAC	3A 125/250VAC
--------------------------	-----------	---------------

## 2. Certification situation

3. Operating temperature range  $-25^{\circ}\text{C} \sim 55^{\circ}\text{C}$

4. Product outline drawing      See attached page.

5. Performance: Protection level: IP65 IK08 Self-compound With lamp Lamp bead life: 40000h

	Item	Test conditions			Specifications		
Mechanical performance	Operating stroke	Apply force in the switch operation direction until the switch locks.			1.8±0.5mm		
	Action force	Load the switch slowly in the vertical direction.			3～5N		
	Mechanical life	Under the condition of no load, at the speed of 30 times per minute			The number of operation cycles reaches 100,000 times.		
	Weldability	Solder temperature 230 ± 5    Immersion time 3±0.5S.			The tin-stained area is more than 90% of the impregnation range.		
	Welding heat resistance	Solder temperature 260 ± 5    Immersion time 5±1S.			Electrical and mechanical properties are normal.		
Electrical performance	Contact resistance		6V.DC			≤50m Ω	
	Insulation resistance		500V.DC    Duration 1min			≥2M Ω	
	Standard requirements		IEC61058			UL61058	
			Test conditions	Requirement	Test conditions	Requirement	
	Voltage withstand test	Micro-disconnection	500Vac/50Hz, Duration 1min	No flashover Non-breakdown	1000Vac/50Hz,Duration 1min	No flashover Non-breakdown	
		Basic insulation	1500Vac/50Hz, Duration 1min		1000Vac/50Hz, Duration 1min		
	Durability test	Overload test	3.45A/cos Φ 0.95 288Vac, 15 times/minute, 100 times in total.	Normal function	4.5A/250VAC, 6-10 times/minute, 50 times in total.	Normal function	
		Durability test	3A/cos Φ 0.95 250Vac, 15 times/minute, 9900 times in total.		3A/250VAC, 6-10 times/minute, 10000 times in total.		
	Temperature rise test		3A, continuously electrify for 1h until the temperature rise is stable, and the specification of the connecting wire is 0.5-0.75mm <sup>2</sup>	Terminal temperature rise ≤55K	3A, continuously electrify for 1h until the temperature rise is stable, and the specification of the connecting wire is 18AWG.	Terminal temperature rise ≤55K	

Remarks: avoid humidity and store in high temperature environment!

Part name	LED pushbutton switches	Date	2025-08-14
Part number	L-KLS7-LPB-M16-02D-R	Edition	V1
Department		Page	3 / 3

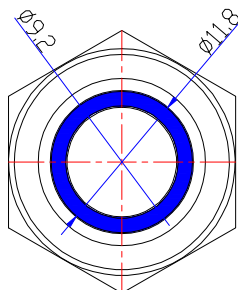
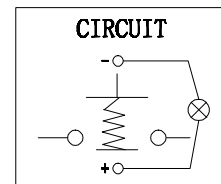
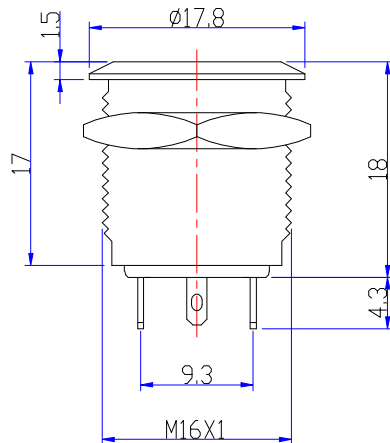
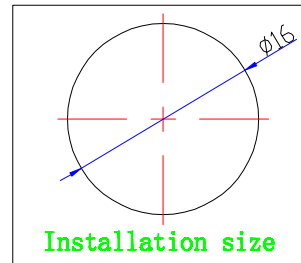
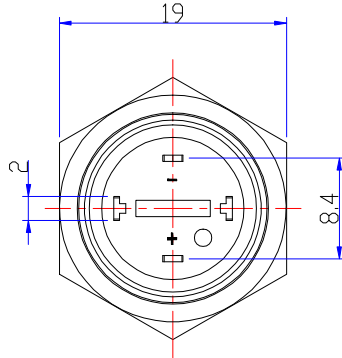

#### Material:

- 1.Shell:Stainless Steel / H59, Nickel Plating
- 2.Base: PA66
- 3.Button:Stainless Steel
- 4.Contact:Silver Alloy
- 5.Terminal:H62,Nickel Plating

#### Electrical:

Lamp voltage: 1.8V (external resistor)  
 Operating Temperature: -25℃ ~ 55℃  
 Rated current、Voltage: 3A 125/250V AC  
 Contact resistance:  $\leq 50\text{m}\Omega$   
 Insulation resistance:  $\geq 2\text{M}\Omega$   
 The intensity of operations: 3~5N  
 Switch operation stroke:  $1.8 \pm 0.5\text{mm}$   
 Mechanical life: 100,000 times  
 LED lifespan: 40,000h  
 IP protection grade: IP65 IK08