

1 RoHS Compliance

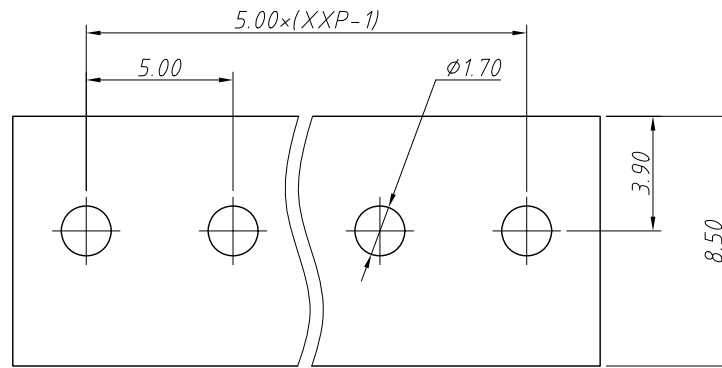
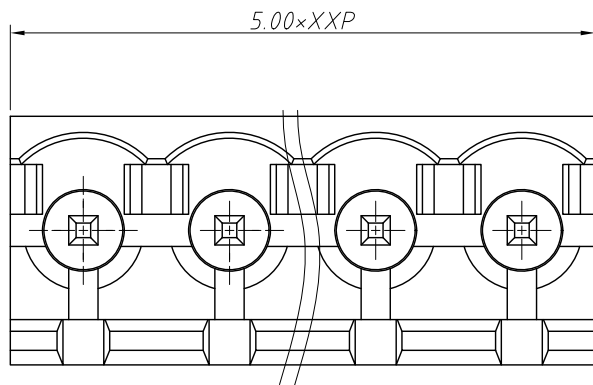
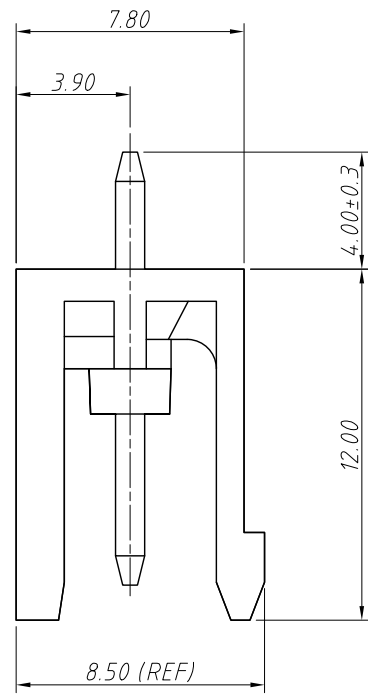
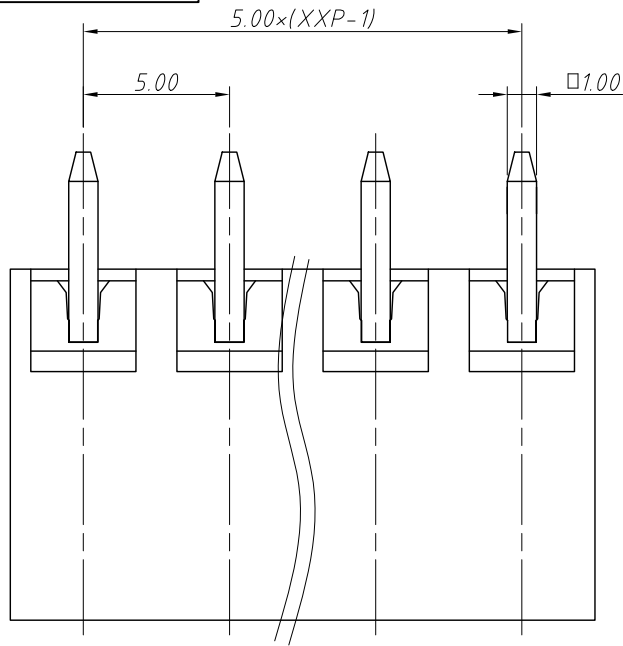

Recommended PCB Layout

6		7		8	
REV	SYM	Revision Record		Appr.	Date
V0	KLS02006	New Version Release		WuHao	2024-11-04
Electrical Characteristics		UL	IEC		
Rated Voltage		300V	250V		
Rated Current		15A	15A		
Withstand Voltage		1600V/1 min	4.0 KV		

Material and other:
 Housing:PA66, UL 94 V-0
 Pin Header:Copper Alloy,Sn Plated
 Operating Temperature:-40°C ~ +105°C
 Soldering Temperature:+260°C For 5 Sec

Order Information
 L-KLS2-EDV-5.00-XXP-X

RoHS
 Terminal Block
 Pitch:5.00mm
 No.:Of (02 ~ 24) Pin
 Color:

1=Gray 2=Blue 3=Black
 4=Green 5=Orange 6=Red
 7=Transp 8=Yellow 9=White

ANGLE TOLERANCE	PROJECTION	Description:			
±3°		Pitch 5.00mm Terminal Block			
GENERAL TOLERANCE	UNITS	mm	KLS P/N:		
0 ~ 30	±0.50	SHEET SIZE	A4		
30 ~ 60	±0.75	Draw:	WuHao	2024-11-04	
60 ~ 90	±1.00	Check:	Daniel	2024-11-04	
NingBo KLS ELECTRONIC CO.,L TD.					

1
RoHS Compliance

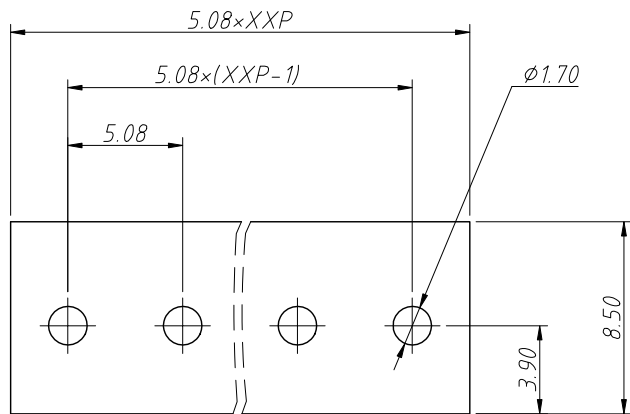

Recommended PCB Layout

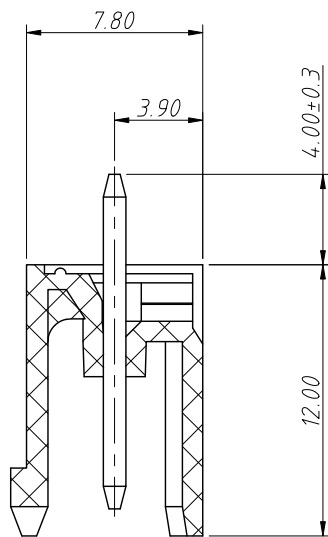

SECTION: A-A

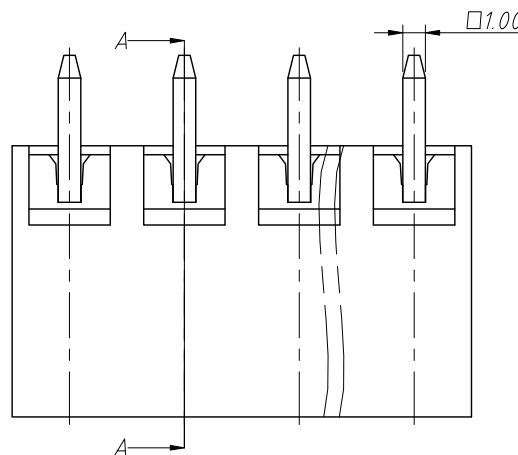
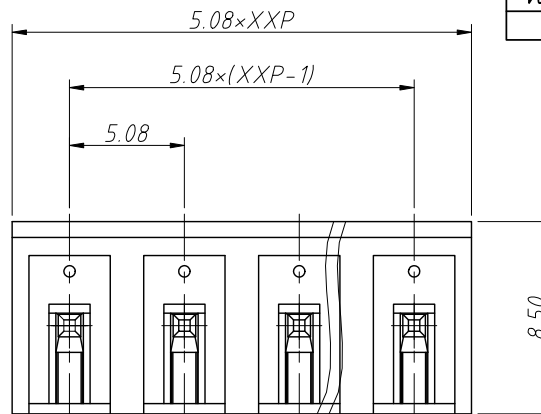

REV	SYM	Revision Record	Appr.	Date
V0	KLS02006	New Version Release	WuHao	2024-09-24

Electrical Characteristics	UL	IEC
Rated Voltage	300V	450V
Rated Current	15A	17.5A
Withstand Voltage	AC2000V/1min	---

Material and other:

Housing:PA66, UL94 V-0

Pin Header:Brass, Tin Plated

Contact resistance:20m Ω

Insulation resistance:500M Ω /DC500V

Temp. Range:-40°C ~ +105°C

MAX Soldering:+250°C, for 5 Sec

Order Information

L-KLS2-EDV-5.08-XXP-X

RoHS

Terminal Block

Pitch:5.08mm

No.:Of (02~24) Pin

Color:

1=Gray 2=Blue 3=Black

4=Green 5=Orange 6=Red

7=Transp 8=Yellow 9=White

ANGLE TOLERANCE	PROJECTION	Description:
$\pm 3^\circ$		Pitch 5.08mm Pluggable Terminal Block,Socket
GENERAL TOLERANCE	UNITS	mm
0~30	± 0.50	
30~60	± 0.75	
60~90	± 1.00	
SHEET SIZE	A4	
Draw:	WuHao	2024-09-24
Check:	Daniel	2024-09-24
KLS ELECTRONIC		NingBo KLS ELECTRONIC CO.,LTD.