

1
RoHS Compliance

6		7		8	
REV	SYM	Revision Record		Appr.	Date
V0	KLS07031	New Version Release		WuHao	2024-12-12

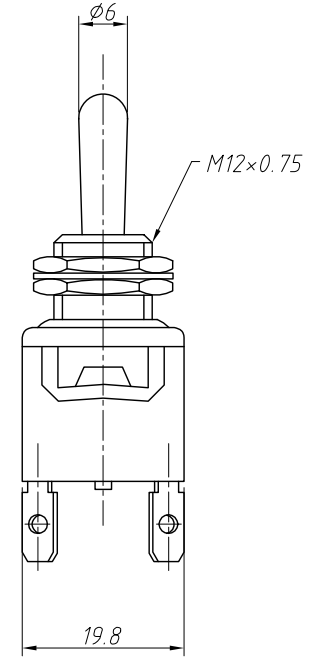

Electric:
Rating:10A 250V AC
20A 125V AC
Contact Resistance:50 mΩ Max
Insulation Resistance:DC 500V 1000MΩ Min
Dielectric Strength:AC 1500V,1 Minute
Operating Temperature:-20°C ~ + 65°C
Electrical Life:10000 Cycles
Color:Black

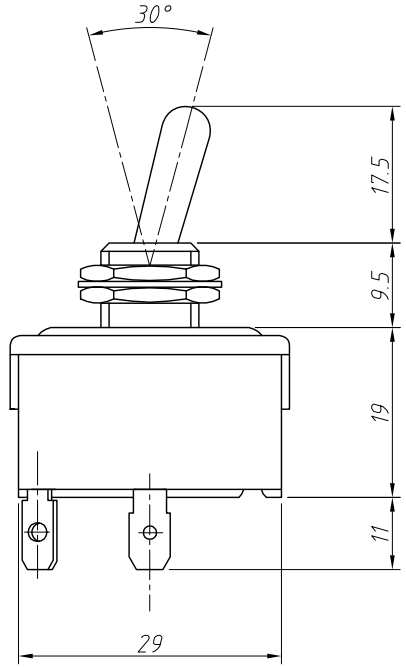
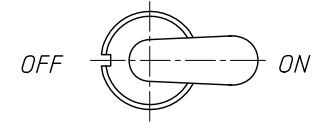
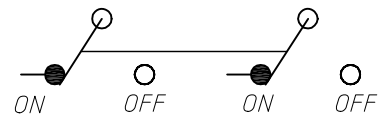
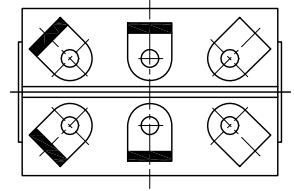

Circuit Diagram

ANGLE TOLERANCE	PROJECTION	Description:			
±3°		Toggle switch			
GENERAL TOLERANCE	UNITS	mm	KLS P/N:		
.x ±0.30	SHEET SIZE	A4	L-KLS7-PTS-2301		
.xx ±0.20	Draw:	WuHao	2024-12-12	NingBo KLS ELECTRONIC CO.,LTD.	
.xxx ±0.10	Check:	Daniel	2024-12-12		