

Slide Switch Series

KLS7-SS03-12D02 (1P2T) Slide Switch Series

SPECIFICATIONS

- Rating: 0.3A 50VDC
- Contact Resistance: 50MΩ max
- Insulation Resistance: 500VDC 100MΩ Min
- Dielectric Strength: 100V AC 1 Minute
- Operating Force: 100gf~800gf
- Electrical Life : 10,000 cycles

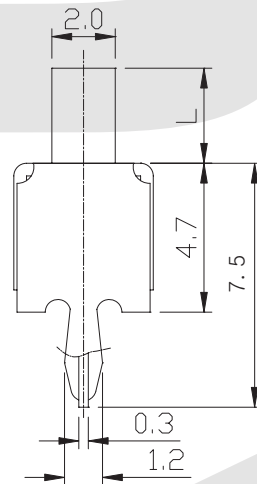
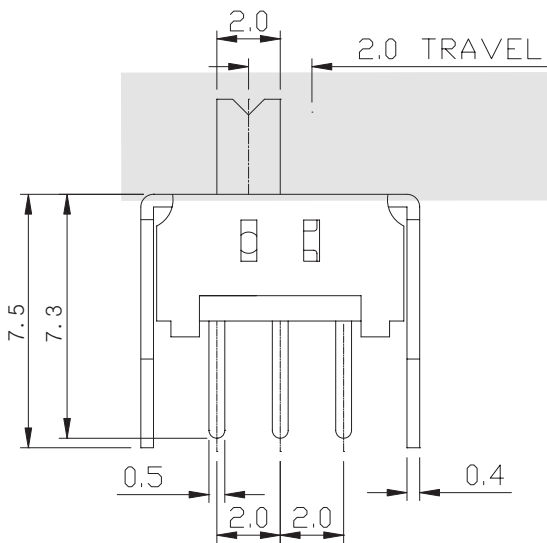
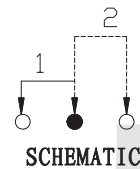
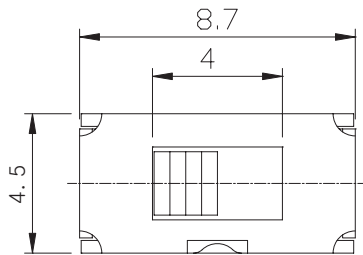

ORDER INFORMATION

KLS7-SS03 - 1 2 D 02 - X X - X

- Part Number
- Slide Switch Type
- Pole
- Throw
- Operating Force
- Knobe Height

Travelling					
C	D	E	F	G	H
1.5	2.0	2.5	3.0	3.5	4.0
I	J	K	L	N	P
4.5	5.0	5.5	6.0	7.0	8.0

Sequential No.

Knob Type					
RG	G	TG	VG	EG	CG

1 RoHS Compliance

6		7		8	
REV	SYM	Revision Record		Appr.	Date
V0	KLS07088	New Version Release		WuHao	2025-02-19

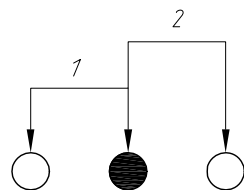
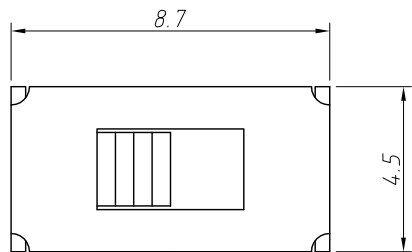

SCHMATIC

Notes:
 Material:
 Knob: POM Black
 Terminal: Brass Strip, Ag Plated
 Shell: Cold Rolled Steel Strip, Ni Plated
 Code Chip: Phosphorus Copper Strip, Ag Plated
 Base: Insulation Board, Natural
 Spring: Phosphorus Copper Strip, Natural

2. Electric:
 Rated: DC50V 0.3A
 Contact Resistance: 100 mΩ Max.
 Insulator Resistance: 100 MΩ Min
 Withstand Voltage: AC 500V
 Force: 250±100gf
 Life: 10000 Times
 Hand Welding: 350 ± 10°C

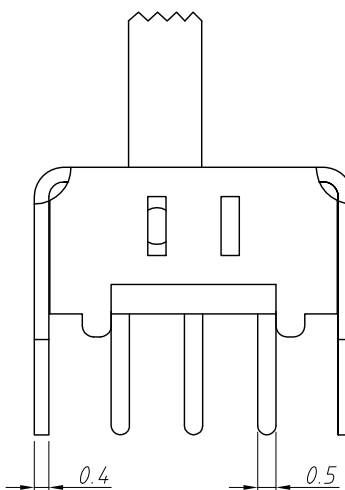
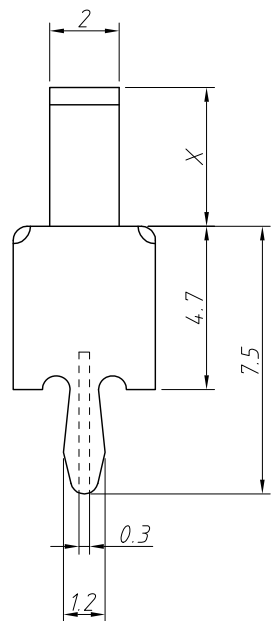
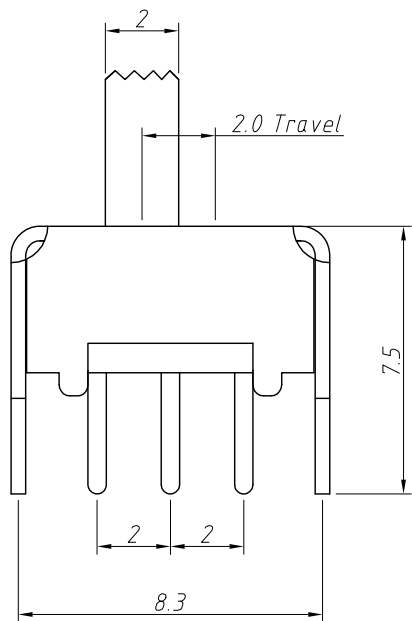

Order Information:

L-KLS7-SS03-1 2 D 02-EG 05

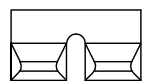
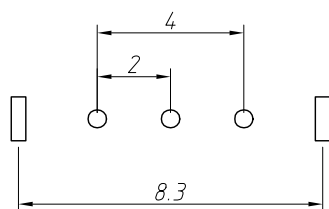
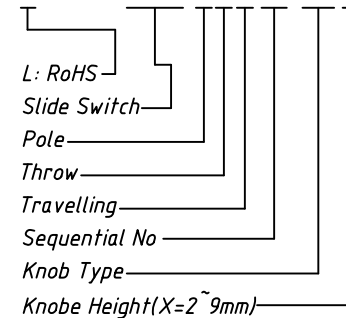

Code Chip

ANGLE TOLERANCE	PROJECTION	Description:			
±3°		Slide Switch			
GENERAL TOLERANCE	UNITS	mm	KLS P/N:		
.x ±0.30	SHEET SIZE	A4	L-KLS7-SS03-12D02-EGX		
.xx ±0.20	Draw:	WuHao	2025-02-19		
.xxx ±0.10	Check:	Daniel	2025-02-19		