

RoHS Compliance

REV	SYM	Revision Record	Appr.	Date
V0	KLS01025	New Version Release	Jenny	2025-02-15

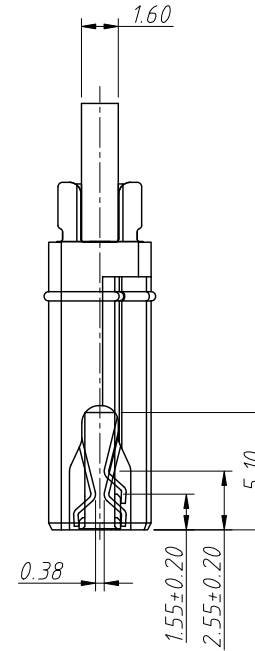
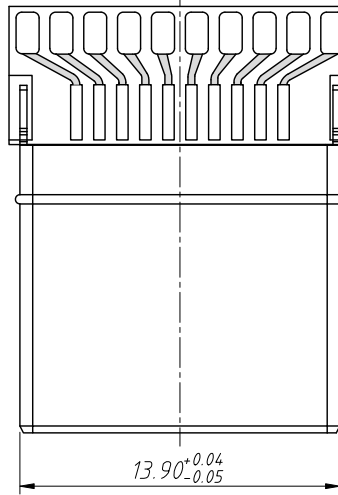
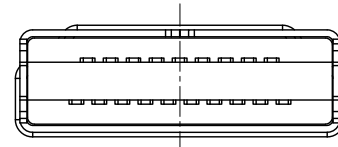
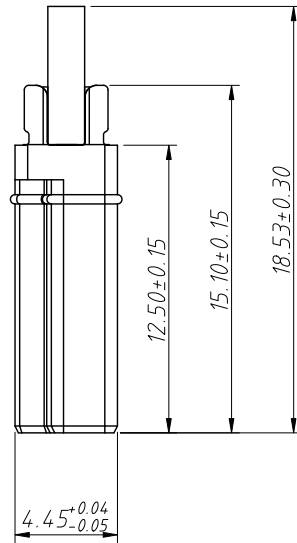
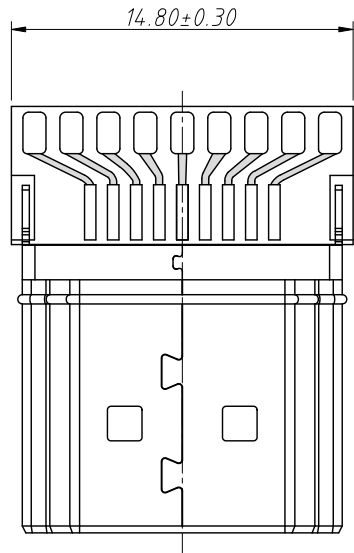

Material:
 Housing:LCP,Black,UL 94 V-0
 Back Insert Housing:LCP,Black,UL 94 V-0
 Terminal:C5191,1u"Gold Plated
 Shell:H65-H SPCC,Nickel plating

Electric:
 Current Rating:0.5 A Max
 Voltage Rating:40V AC Max
 Contact Resistance:10mΩ Max Mated
 Insulation Resistance:100MΩ Min
 Dielectric Withstanding Voltage:
 AC 500V Min (For 1 Minute)
 Operation Temperature Range:
 -25°C ~ 85°C

Mechanical:
 Insertion Force:4.5KGF Maxmun
 Withdrawal Force:1.0KGF Minimum;
 4.0KGF Maxmum

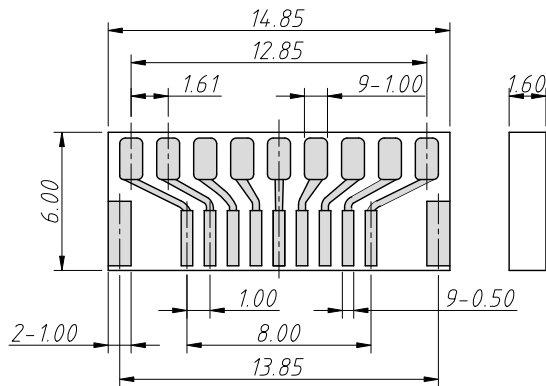
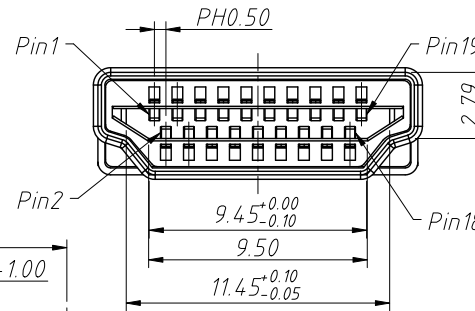

Recommended PCB Layout

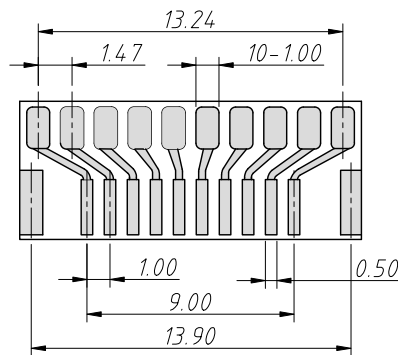

ANGLE TOLERANCE	PROJECTION	Description:		
±2°		Micro HDMI Male Connector		
GENERAL TOLERANCE		L-KLS1-L-006-G		
.x ±0.55	UNITS	mm	KLS P/N:	
.x ±0.35	SHEET SIZE	A4		
.xx ±0.25	Draw:	Jenny	2025-02-15	NingBo KLS ELECTRONIC CO.,L TD.
.xxx ±0.15	Check:	Daniel	2025-02-15	

1 RoHS Compliance

REV	SYM	Revision Record	Appr.	Date
V0	KLS01025	New Version Release	WuHao	2025-02-07

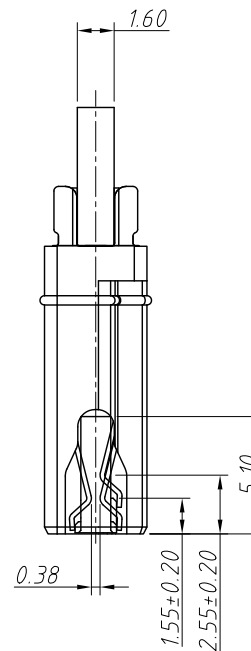
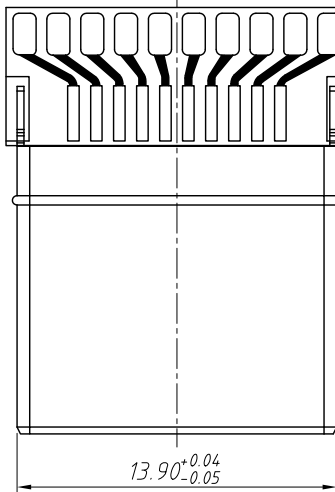
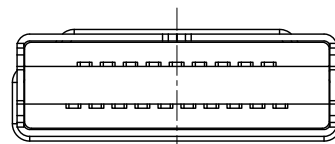
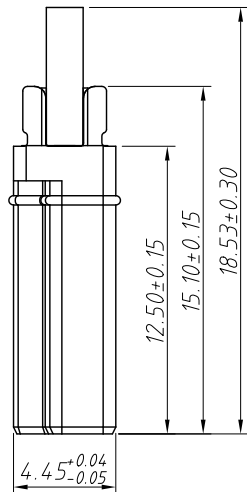
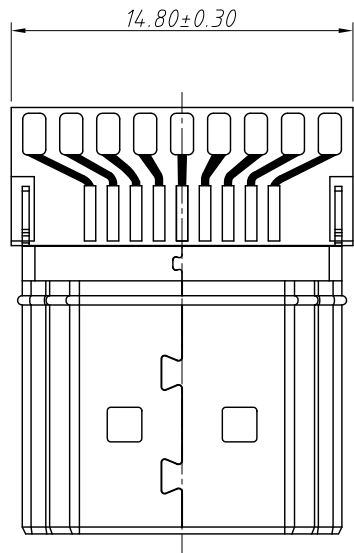

Material:
 Housing: LCP, Black, UL 94 V-0
 Contact: C5191
 Contact Area: Gold Plated Over
 50u" Ni Min
 Soldered Area: 100u" Mist Tin Plated
 Over 50u" Ni Min
 Shell: SPCC, Gold Plated Over G/F,
 Plated Over 50u" Ni Min

Electric:
 Current Rating: 0.5 A Max
 Voltage Rating: 40V AC Max
 Contact Resistance: 10mΩ Max Mated
 Insulation Resistance: 100MΩ Min
 Dielectric Withstanding Voltage:
 AC 500V Min (For 1 Minute)
 Operation Temperature Range:
 -25°C ~ 85°C

Mechanical:
 Insertion Force: 4.5KGF Maxmun
 Withdrawal Force: 1.0KGF Minimum;
 4.0KGF Maxmun

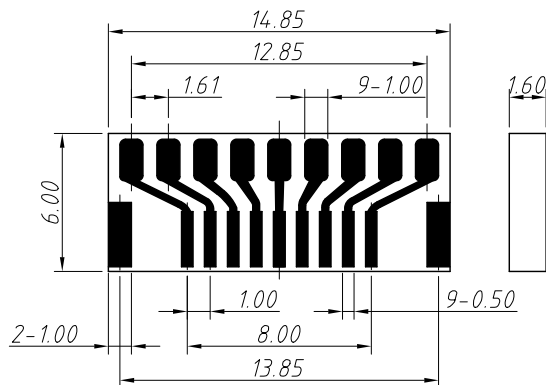
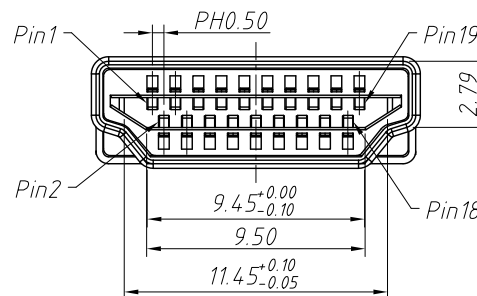

Recommended PCB Layout

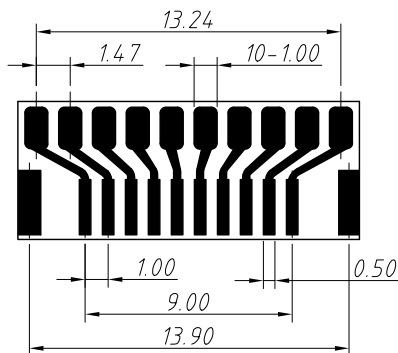

ANGLE TOLERANCE	PROJECTION	Description:	Micro HDMI D male, PCB Board Wire Solder Type
±2°			
GENERAL TOLERANCE	UNITS	mm	L-KLS1-L-006-N
.x ±0.55	SHEET SIZE	A4	
.xx ±0.35	Draw:	WuHao	NingBo KLS ELECTRONIC CO.,L.TD.
.xx ±0.25	Check:	Daniel	
.xxx ±0.15			