

1
RoHS Compliance

6	7	8
REV	SYM	Revision Record
V0	KLS01323	New Version Release
		Appr. Song
		Date 2025-02-27

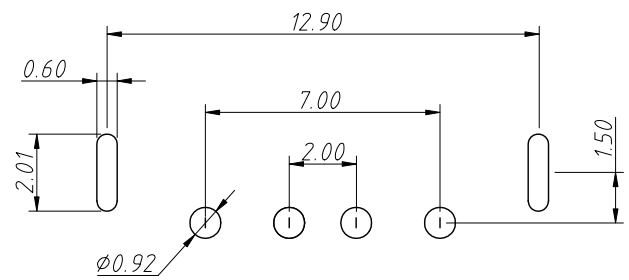
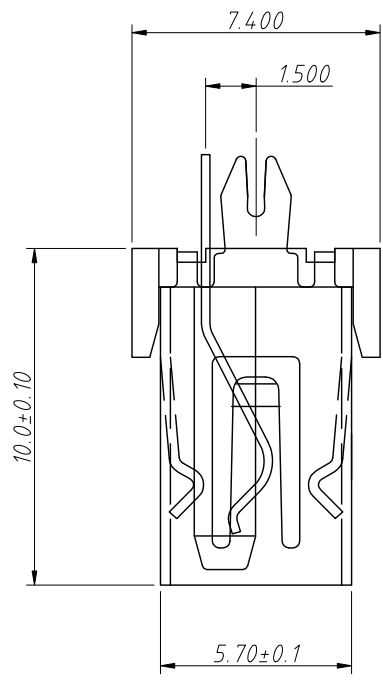
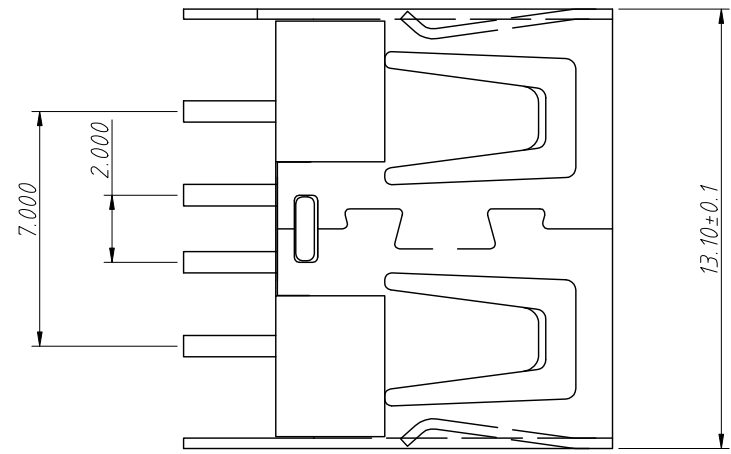
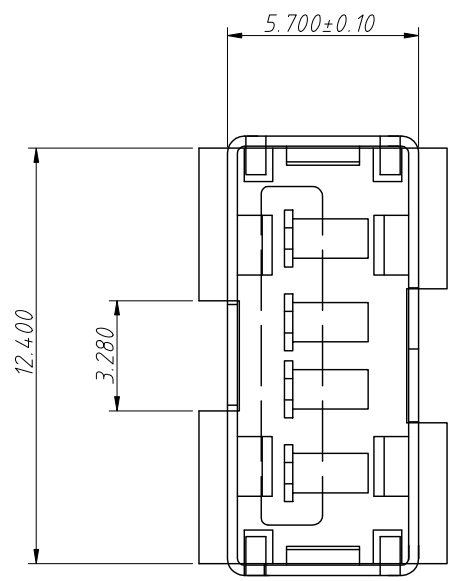

Recommended PCB Layout
Tolerance: ±0.05mm

Notes:

Material:

Housing: High Temperature Thermoplastics (PBT/LCP),
UL 94 V-0, Black/White

Contact: Copper Alloy C2680, Gold Plated on contact area
Tin Plated on solder area

Shell: SPCC, Nickel Plating

Electric:

Current Rating: 1.5A/Contact Terminal

Voltage Rating: 30V DC

Contact Resistance: 30 milliohms Max

Dielectric Withstanding Voltage: 500 V AC AT Sea Level

Insulator Resistance: 1000 MEGA ohms Min

Connector Mate and Unmate Force

Mate Force: 3.75kgf (Max)

Unmate Force: 1.02kgf (Min)

Terminal Retention: 1.2kgf (Min)

Order Information

L-KLS1-1805A-B

RoHS

Insulator Color:

B=Black W=White

ANGLE TOLERANCE	PROJECTION	Description:	USB 2.0 Connector	
±3°				
GENERAL TOLERANCE	UNITS	mm	KLS P/N:	L-KLS1-1805A-X
.x ±0.30	SHEET SIZE	A4		
.xx ±0.20	Draw:	Song	2025-02-27	
.xxx ±0.10	Check:	Daniel	2025-02-27	

NingBo KLS ELECTRONIC CO.,LTD.