

1
RoHS Compliance

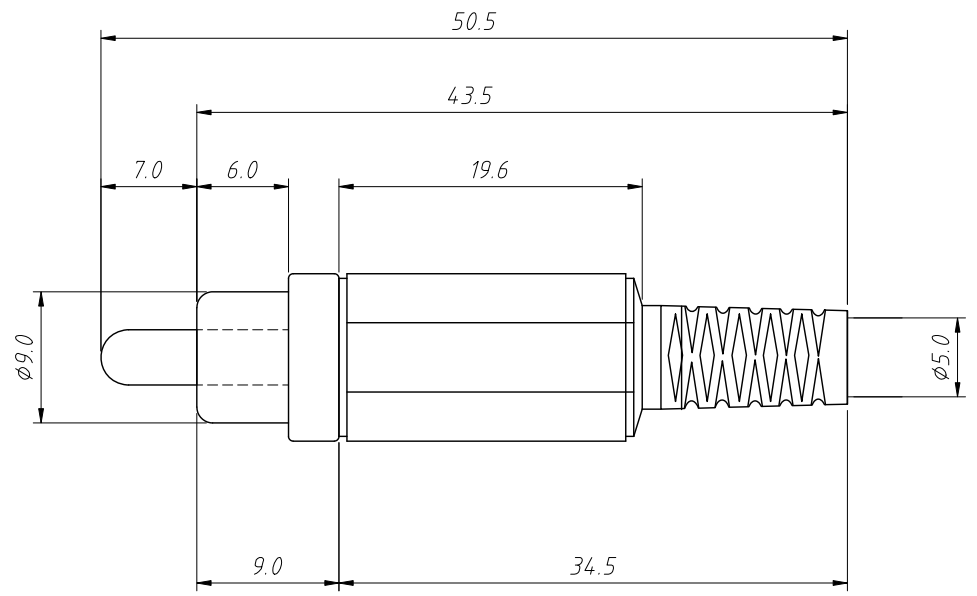

Description:
 Gender: Male
 Signal Lines: Mono
 Shielding: Unshielded
 Color - Contact: Silver
 Packaging: Bulk
 Contact Material: Brass
 Housing Color: Black, Blue, Red, Green, Yellow, White.....
 Housing Material: Thermoplastic
 Cable Diam: 5.0mm Max.
 Operating Temperature: -20°C ~ 85°C

Order Information:
 L-KLS1-RCA-PM01-N-B
 L: RoHS
 Part No.
 Contacts:
 N=Nickel Plated
 G=Gold Plated
 Housing Color:
 B-Black L-Blue R-Red
 G-Green Y-Yellow W-White

ANGLE TOLERANCE	PROJECTION	Description:	
$\pm 3^\circ$		RCA Phono Plug Connector	
GENERAL TOLERANCE	UNITS	mm	KLS P/N:
x.x ± 0.30	SHEET SIZE	A4	L-KLS1-RCA-PM01-X-X
x.xx ± 0.20	Draw:	Song	2025-02-25
x.xxx ± 0.10	Check:	Daniel	2025-02-25



NingBo KLS ELECTRONIC CO.,L TD.