

1 RoHS Compliance

REV	SYM	Revision Record	Appr.	Date
V0	KLS12006	New Version Release	Song	2025-03-03

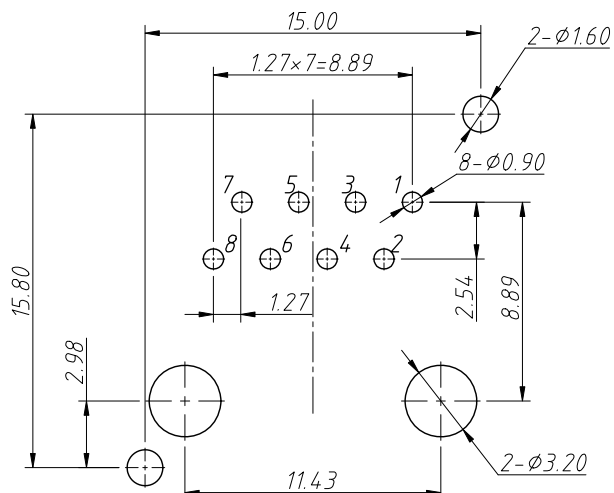

Recommended PCB Layout

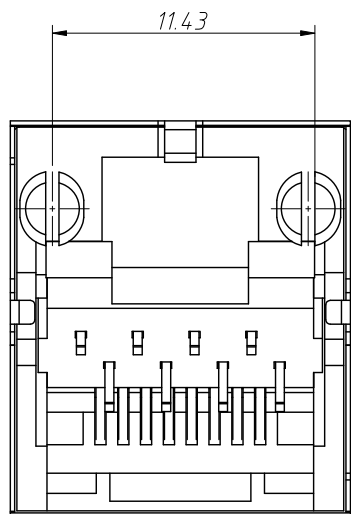
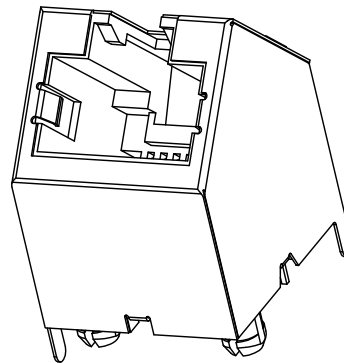

Material:
 Housing:PBT, UL 94V-0,White
 Contact:C5191(QSn6.5-0.1)Phosphor Bronze
 T=0.35mm,Gold Plating On Contact Area
 Tails Plating Tin Over Nickel
 Shield:H65Y Brass Nickel Plated,T=0.20mm

Electrical:
 Current Rating:1.5A
 Voltage Rating:125VAC
 Contact Resistance:30MΩ Max.
 Insulation Resistance:500MΩ Min @500VDC
 Withstanding Voltage:

1000VAC 50Hz or 60Hz 1min

Mating/Unmating Force:2.2KG.F Max

Retention Strength:

3.0KG.F Min Between Jack And Plug

Operating Life:600 cycles min

Storage TEMP.:

-40°C ~ +85°C Relative Humidity:<70%

Operation TEMP.: -40°C ~ +85°C

Order Information

L-KLS12-162-8P8C-W-01

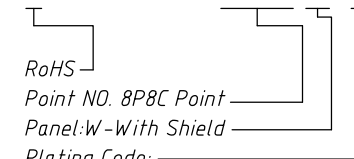

01=6u" Gold Plating 02=3u"Gold Plating
 03=6u" Gold Plating 04=15u"Gold Plating
 05=30u"Gold Plating

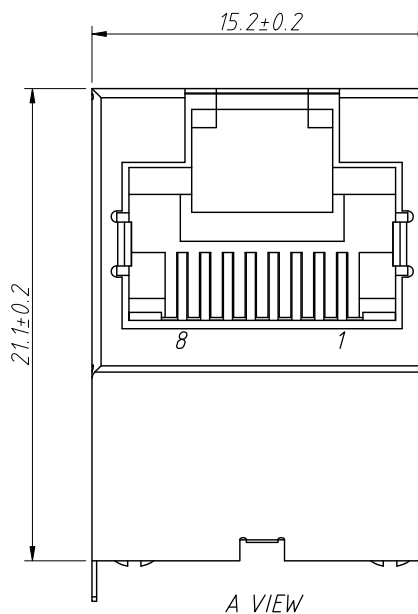
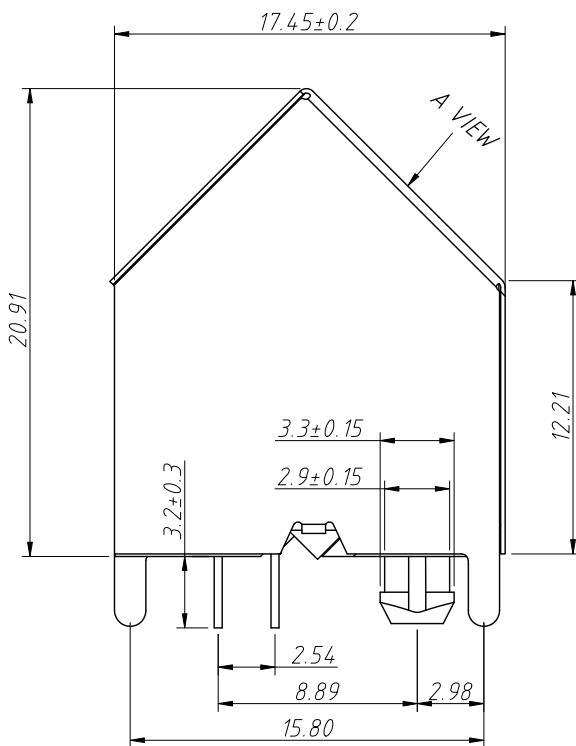
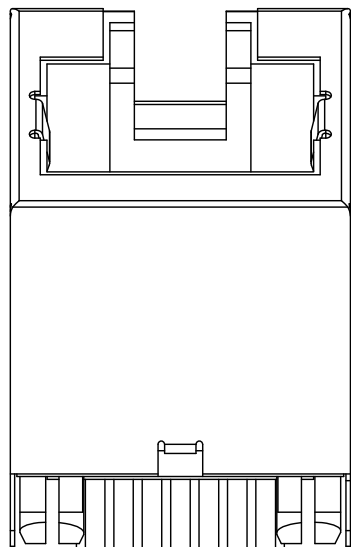

ANGLE TOLERANCE	PROJECTION	Description:	RJ45-8P8C Jack 45 DEG
±3°			
GENERAL TOLERANCE	UNITS	mm	KLS P/N:
.x ±0.25	SHEET SIZE	A4	L-KLS12-162-8P8C-W-XX
.xx ±0.20	Draw:	Song	2025-03-03
.xxx ±0.10	Check:	Daniel	2025-03-03



NingBo KLS ELECTRONIC CO.,L TD.