

1 RoHS Compliance

|     |          |                     |       |            |
|-----|----------|---------------------|-------|------------|
| 7   |          | 8                   |       |            |
| REV | SYM      | Revision Record     | Appr. | Date       |
| V0  | KLS15032 | New Version Release | Song  | 2025-01-07 |

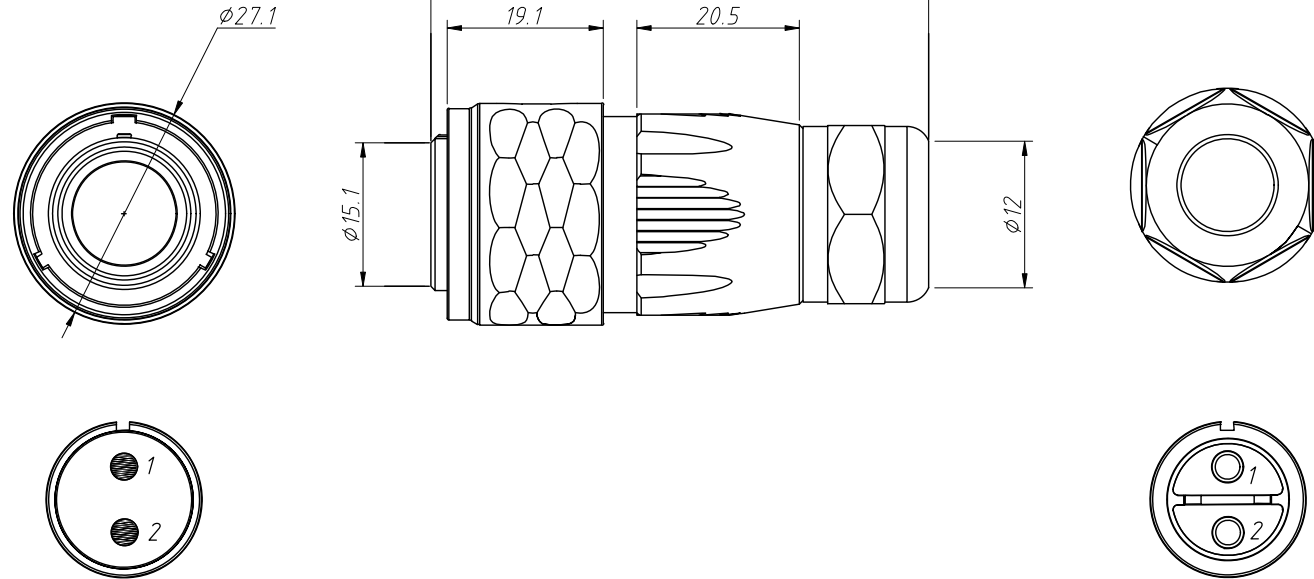

Material:  
Shell: Zinc Alloy, Chrome Plated  
Contact: Brass, Gold Plated

Electrical:  
Coupling: Push-Pull Self-Locking  
Termination: Solder  
Cable Outer Diameter: 5 ~ 12mm  
IP Rating: IP68  
Temperature: -25°C ~ +80°C

Order Information  
L-KLS15-282-M20-XX F1-A

RoHS \_\_\_\_\_  
Pos No. \_\_\_\_\_  
Thread Specification: M20 \_\_\_\_\_  
No. of Pins (02 ~ 12) \_\_\_\_\_  
Type Ordering \_\_\_\_\_  
Materials: A=Metal \_\_\_\_\_

|                                      |           |           |           |         |         |         |         |
|--------------------------------------|-----------|-----------|-----------|---------|---------|---------|---------|
| Number Of CONTACT                    | 02        | 03        | 04        | 05      | 07      | 09      | 12      |
| Male Contact Face View               |           |           |           |         |         |         |         |
| Rated Current (A)                    | 20A       | 20A       | 20A       | 10A     | 10A     | 5A      | 5A      |
| Contact Diameter                     | φ2.7×2    | φ2.7×3    | φ2.7×4    | φ1.8×5  | φ1.8×7  | φ1.0×9  | φ1.0×12 |
| Rated Voltage (AC.V)                 | 500V      | 500V      | 500V      | 250V    | 250V    | 250V    | 250V    |
| Test Voltage (AC.V) 1Min             | 1500V     | 1500V     | 1500V     | 1500V   | 1500V   | 1500V   | 1500V   |
| Contact Resistance mΩ                | 1         | 1         | 1         | 2.5     | 2.5     | 5       | 5       |
| Wire Size Soler mm <sup>2</sup> /AWG | ≤2.5/13.6 | ≤2.5/13.6 | ≤2.5/13.6 | ≤1.5/15 | ≤1.5/15 | ≤1.0/18 | ≤1.0/18 |

|                   |            |              |                                     |            |
|-------------------|------------|--------------|-------------------------------------|------------|
| ANGLE TOLERANCE   | PROJECTION | Description: | IP68 Waterproof Circular Connectors |            |
| ±3°               |            |              |                                     |            |
| GENERAL TOLERANCE | UNITS      | mm           | KLS P/N: L-KLS15-282-M20-XXF1-A     |            |
| x. ±0.20          | SHEET SIZE | A4           | NingBo KLS ELECTRONIC CO.,L.TD.     |            |
| x.x ±0.10         | Draw:      | Song         |                                     | 2025-01-07 |
| x.xx ±0.05        | Check:     | Daniel       |                                     | 2025-01-07 |