

1 RoHS Compliance

6	7	8		
REV	SYM	Revision Record	Appr.	Date
V0	KLS02006	New Version Release	Jenny	2024-09-07

Electrical Characteristics	UL	IEC
Rated Voltage	600V	1000V
Rated Current	55A	76A
Withstand Voltage	2200V / 1 min	8.0KV
Wire Range	6~20 AWG	0.5~16mm ²

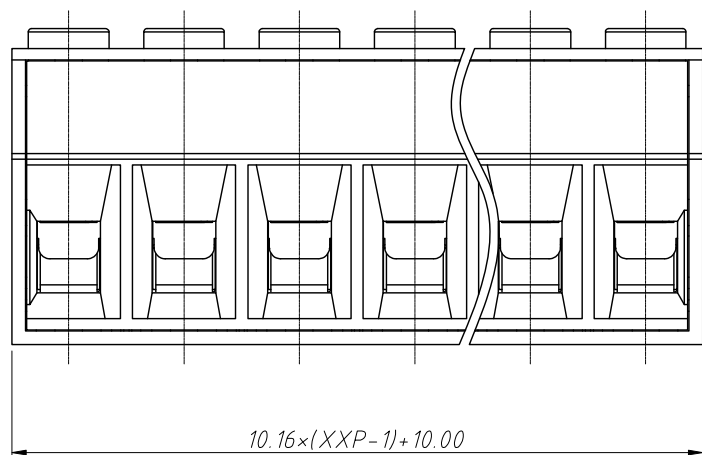
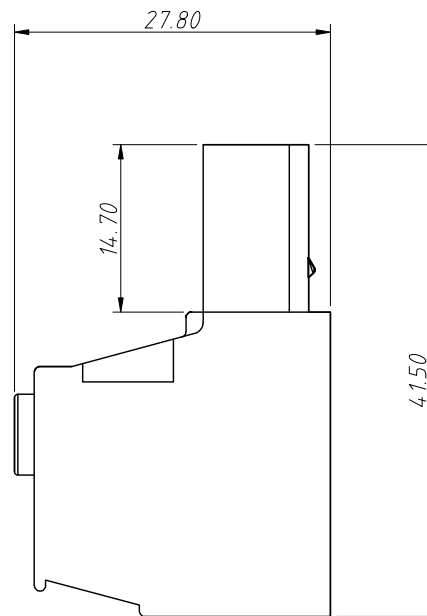
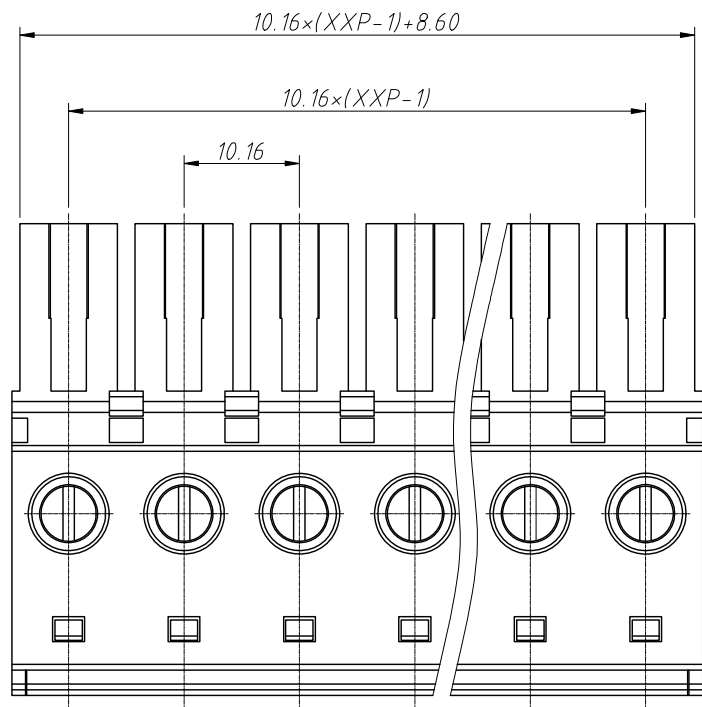

Order Information

L-KLS2-KKF-10.16-XXP-4 X

RoHS
Terminal Block
Pitch: 10.16mm
No.: Of (02~18) Pin
Color:
1=Gray 2=Blue 3=Black
4=Green 5=Orange 6=Red
7=Transp 8=Yellow 9=White
Screw: SC=Slot/Cross
S-Slot Screw C-Cross Screw

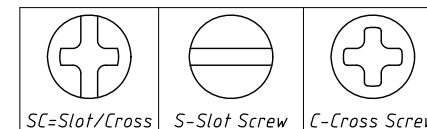

Material and other:

Housing: PA66, UL 94V-0

Cover: PA66, UL 94V-0

Clamp: Copper alloy, Sn Plated

Cage: Copper alloy, Ni Plated

Screw: Steel, M4/Zn Plated

Screw Torque: 1.2Nm max

Stripping Length: 13-14mm

Operating temperature: -40°C ~ +105°C

ANGLE TOLERANCE	PROJECTION	Description:		
±3°		Pitch 10.16mm Pluggable Terminal Block, Plug		
GENERAL TOLERANCE	UNITS	mm	KLS P/N:	L-KLS2-KKF-10.16-XXP-4X
0~30	±0.50	SHEET SIZE	A4	
30~60	±0.75	Draw:	Jenny	2024-09-07
60~90	±1.00	Check:	Daniel	2024-09-07



NingBo KLS ELECTRONIC CO.,L TD.