

1
RoHS Compliance

REV	SYM	Revision Record	Appr.	Date
V0	KLS02006	New Version Release	WuHao	2024-11-01

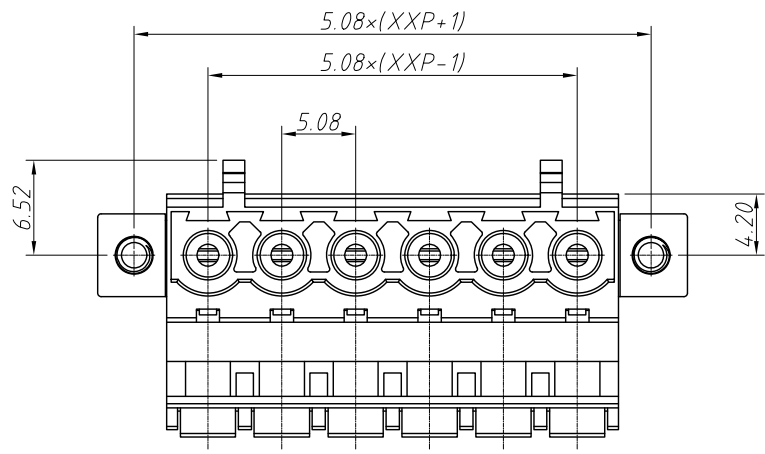

Electrical Characteristics	UL	IEC
Rated Voltage	300V	250V
Rated Current	10A	12A
Withstand Voltage	1600V/1min	4.0 KV
Wire Range	28~12 AWG	0.2~2.5 mm ²

Material and other:
 Housing/Cover:PA66, UL 94 V-0
 Spring:Stainless Steel
 Clamp:Copper Alloy,Sn Plated
 Button:POM,UL 94-HB
 Screw:Steel,M2.5,Zn Plated
 Stripping Length:8~9mm
 Operating Temperature:-40°C~+105°C

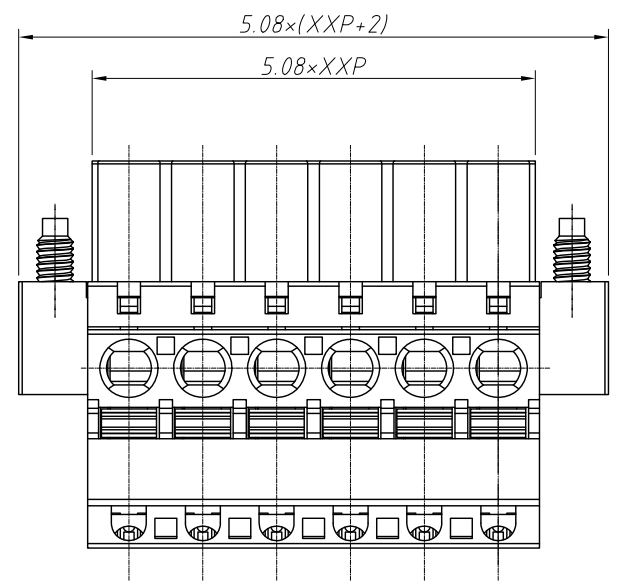
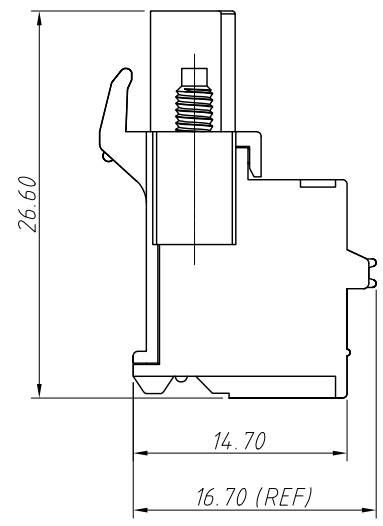

Order Information
L-KLS2-EDKGM-5.08-XXP-X

RoHS
 Terminal Block
 Pitch:5.08mm
 No.:Of (02~24) Pin
 Color:1=Gray 2=Blue 3=Black
 4=Green 5=Orange 6=Red
 7=Transp 8=Yellow 9=White

ANGLE TOLERANCE	PROJECTION	Description:
±3°		Pitch 5.08mm Terminal Block
GENERAL TOLERANCE	UNITS	mm
0~30 ±0.50	SHEET SIZE	A4
30~60 ±0.75	Draw:	WuHao 2024-11-01
60~90 ±1.00	Check:	Daniel 2024-11-01
KLS P/N:		L-KLS2-EDKGM-5.08-XXP-X
KLS ELECTRONIC		NingBo KLS ELECTRONIC CO.,L TD.