

RoHS Compliance

REV	SYM	Revision Record	Appr.	Date
V0	KLS02006	New Version Release	Jenny	2024-08-20

Electrical Characteristics	UL	IEC
Rated Voltage	300V	450V
Rated Current	15A	17.5A
Withstand Voltage	2000V / 1 min	---
Wire Range	14 ~ 28 AWG	1.5mm <sup>2</sup>

Material and other:  
 Housing:PA66, UL94V-0  
 Clamp:Copper alloy,Ni Plated  
 Cage:Steel,Zn Plated  
 Screw:Steel,M2.5/Zn Plated  
 Slide Block:Steel,Zn Plated  
 Screw Torque:0.4Nm max  
 Stripping Length:7-8mm  
 Temp. Range:-40°C ~ +105°C  
 Contact resistance:20mΩ MAX  
 Insulation resistance:500MΩ/DC500V

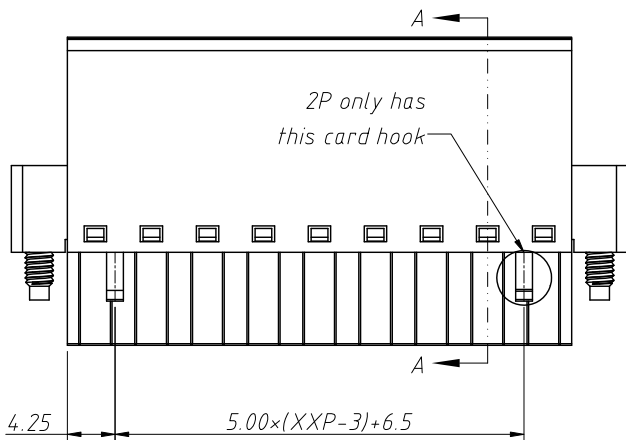
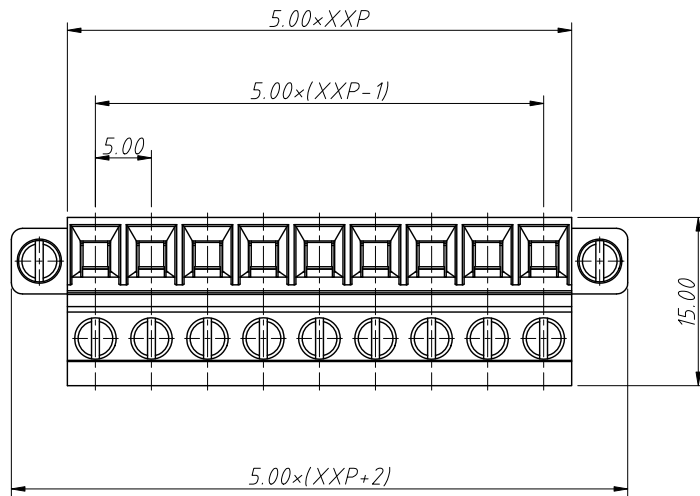

SECTION:A-A

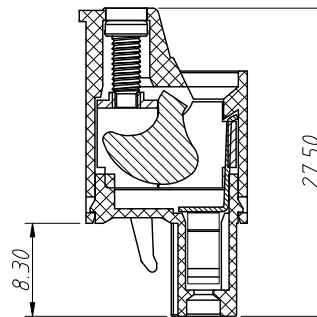

Order Information

L-KLS2-EDKCM-5.00-XXP-4 X

RoHS  
 Terminal Block  
 Pitch:5.00mm  
 No.:Of (02~24) Pin  
 Color:  
 1=Gray    2=Blue    3=Black  
 4=Green    5=Orange    6=Red  
 7=Transp    8=Yellow    9=White  
 Screw:SC=Slot/Cross  
 S-Slot Screw    C-Cross Screw

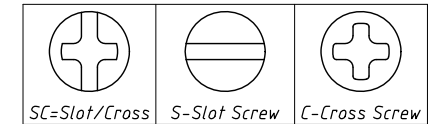

ANGLE TOLERANCE	PROJECTION	Description:
±3°		Pitch 5.00mm Pluggable Terminal Block,Plug
GENERAL TOLERANCE	UNITS	KLS P/N:
0 ~ 30 ±0.50	mm	L-KLS2-EDKCM-5.00-XXP-4X
30 ~ 60 ±0.75	SHEET SIZE	
60 ~ 90 ±1.00	A4	
	Draw:	Jenny 2024-08-20
	Check:	Daniel 2024-08-20



NingBo KLS ELECTRONIC CO.,L TD.

1  
RoHS Compliance

2  
Material and other:  
Housing: PA66, UL94V-0  
Clamp: Phosphor Bronze, Ni Plated  
Cage: Steel, Zn Plated  
Screw/Torque: Steel, M2.5, Zn Plated/0.4N.m  
Slide Block: Steel, Zn Plated  
Contact resistance: 20mΩ MAX  
Insulation resistance: 500MΩ/DC500V  
Stripping Length: 7~8mm  
Temp. Range: -40°C ~ +105°C

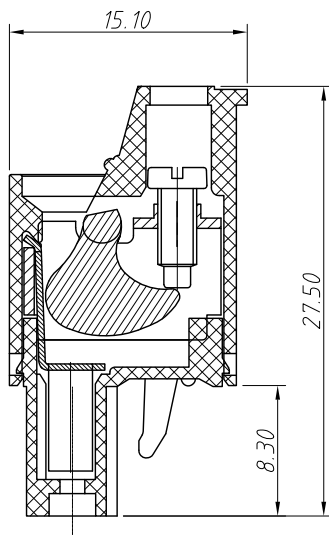
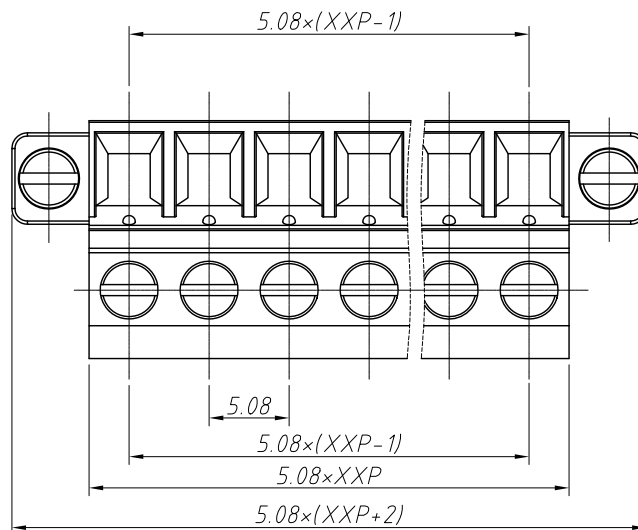

SECTION A-A

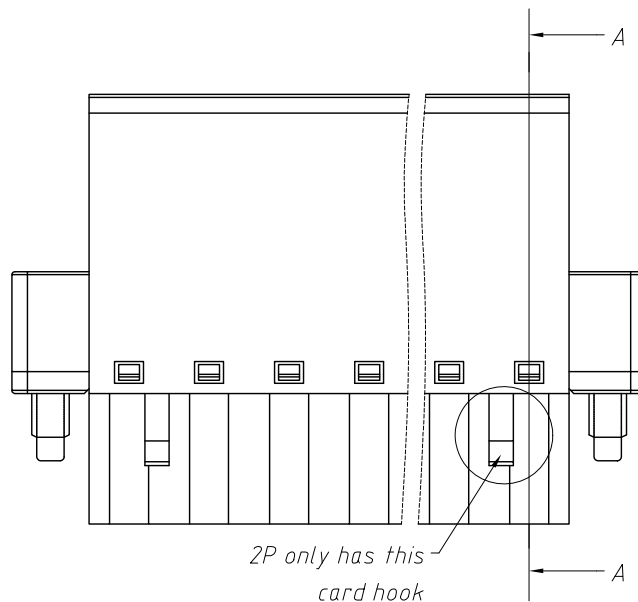

REV	SYM	Revision Record	Appr.	Date
V0	KLS02006	New Version Release	WuHao	2024-11-01

Electrical Characteristics	UL	IEC
Rated Voltage	300V	450V
Rated Current	15A	17.5A
Withstand Voltage	AC2000V/1 min	---
Wire Range	28~14 AWG	1.5mm <sup>2</sup>

Order Information

L-KLS2-EDKCM-5.08-XXP-X X

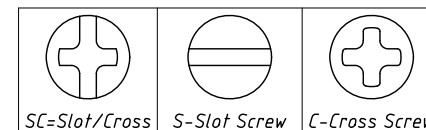
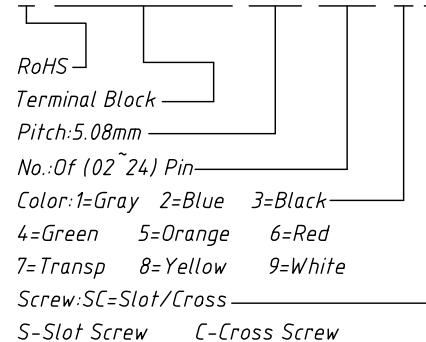

ANGLE TOLERANCE	PROJECTION	Description:
±3°		Pitch 5.08mm Terminal Block
GENERAL TOLERANCE	UNITS	mm
0~30 ±0.50	SHEET SIZE	A4
30~60 ±0.75	Draw:	WuHao 2024-11-01
60~90 ±1.00	Check:	Daniel 2024-11-01
KLS P/N:		L-KLS2-EDKCM-5.08-XXP-XX
KLS ELECTRONIC		NingBo KLS ELECTRONIC CO.,L TD.