

REV	SYM	Revision Record	Appr.	Date
V0	KLS02006	New Version Release	Song	2023-11-24
V1	KLS02006	Technology Improvement	WuHao	2024-10-23

Electrical Characteristics	UL	IEC
Rated Voltage	300V	250V
Rated Current	8A	8A
Withstand Voltage	AC2000V/1min	---
Wire Range	16~24AWG	1.0mm ²

Material
Housing: PA66, UL94V-0
Shrapnel: Stainless steel
Clamp: Copper alloy, Ni plated

Electrical
Contact resistance: 20mΩ
Insulation resistance: 500MΩ/DC500V
Temp. Range: -40°C ~ +105°C
Strip Length: 9~10mm

Order Information
L-KLS2-FMC-3.50-XXP-X

RoHS
Terminal Block
Pitch: 3.50mm
No.: of 02~24 Pole
Color:

1=Gray 2=Blue 3=Black
4=Green 5=Orange 6=Red
7=Transp 8=Yellow 9=White

GENERAL TOLERANCE	ANGLE TOLERANCE	Description:
X. ±0.60	X. ±5°	Pluggable Terminal Block 3.5 mm
.X ±0.38	.X ±3°	
.XX ±0.25	.XX ±2°	
Draw by 2023-04-18	PROJECTION	KLS P/N: L-KLS2-FMC-3.50-XXP-X
Check by 2023-04-18	UNITS mm	NingBo KLS ELECTRONIC CO.,L TD.
SCALE	SHEET SIZE A4	

1
RoHS Compliance

6	7	8
REV	SYM	Revision Record
V0	KLS02006	New Version Release
		Appr.
		Jenny
		Date
		2024-08-20

Electrical Characteristics	UL	IEC
Rated Voltage	300V	250V
Rated Current	8A	7A
Withstand Voltage	2000V / 1min	---
Wire Range	16~24 AWG	1.0mm ²

B

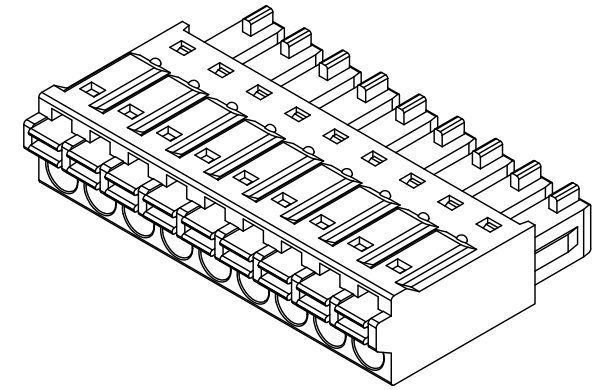
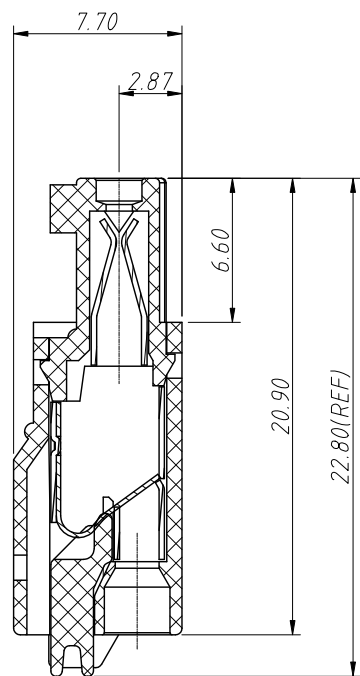
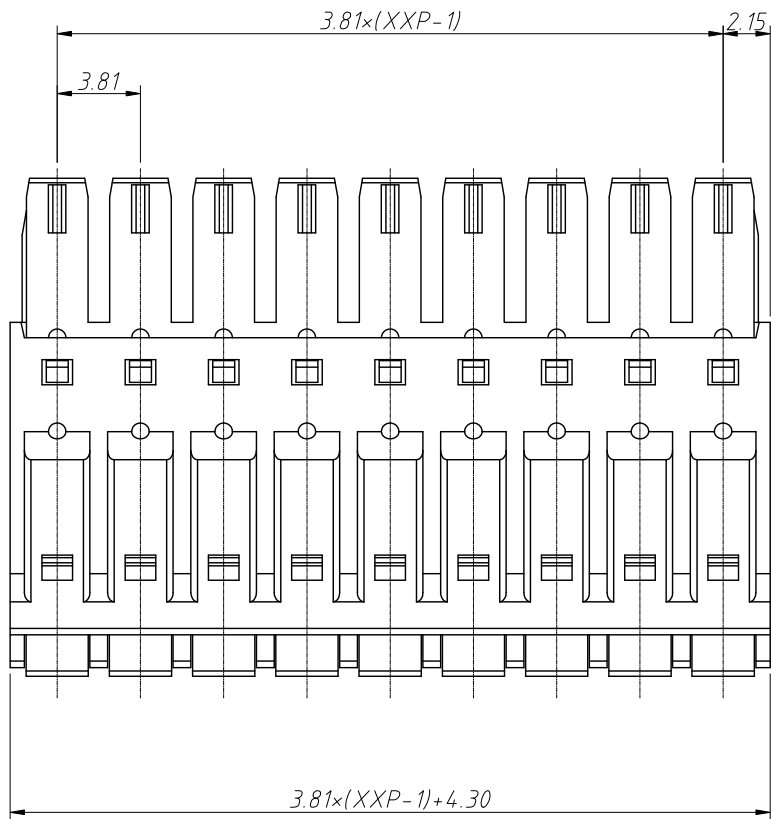

E

Order Information

L-KLS2-FMC-3.81-XXP-4

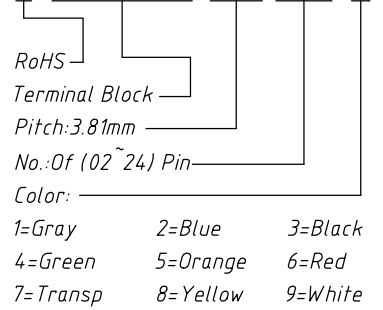

Material and other:
 Housing:PA66, UL 94V-0
 Clamp:Copper alloy,Sn Plated
 Shrapnel:Stainless steel
 Stripping Length:9~10mm
 Temp. Range:-40°C ~ +105°C
 Contact resistance:20mΩ MAX
 Insulation resistance:500MΩ/DC500V

F

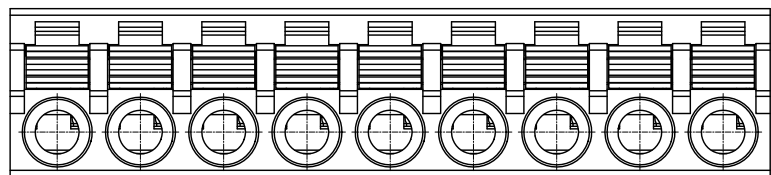

ANGLE TOLERANCE	PROJECTION	Description:
±3°		Pitch 3.81mm Pluggable Terminal Block,Plug
GENERAL TOLERANCE	UNITS	mm
0~30	±0.50	
30~60	±0.75	
60~90	±1.00	
SHEET SIZE	A4	
Draw:	Jenny	2024-09-04
Check:	Daniel	2024-09-04
KLS ELECTRONIC		NingBo KLS ELECTRONIC CO.,L TD.

H