

1  
RoHS Compliance

REV	SYM	Revision Record	Appr.	Date
V0	KLS02006	New Version Release	WuHao	2024-11-06

Electrical Characteristics	UL	IEC
Rated Voltage	150V	80V
Rated Current	10A	10A
Withstand Voltage	1300V/1 min	2.5 KV

Material and other:  
 Housing:PA66, UL 94 V-0  
 Pin Header:Copper Alloy,Sn Plated  
 Operating temperature:-40°C ~ +105°C

Order Information  
 L-KLS2-EDVHD-3.50-XXP-X

RoHS  
 Terminal Block  
 Pitch:3.50mm  
 No.:Of (04~48) Pin  
 Color:

1=Gray    2=Blue    3=Black  
 4=Green    5=Orange    6=Red  
 7=Transp    8=Yellow    9=White

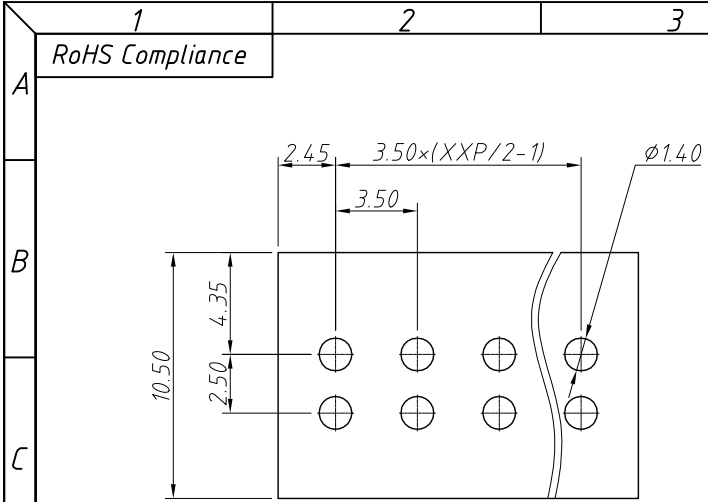

Recommended PCB Layout

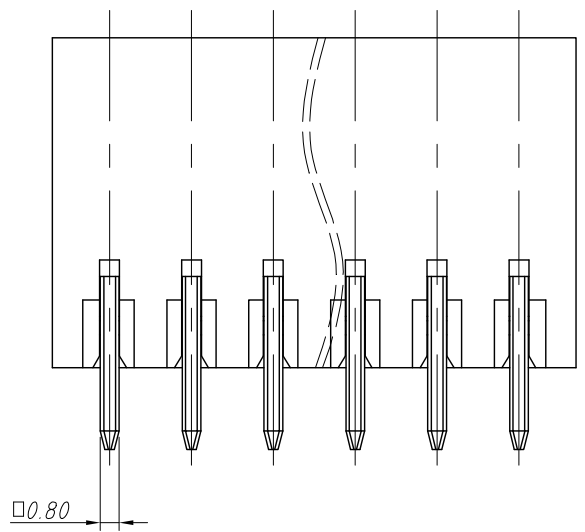
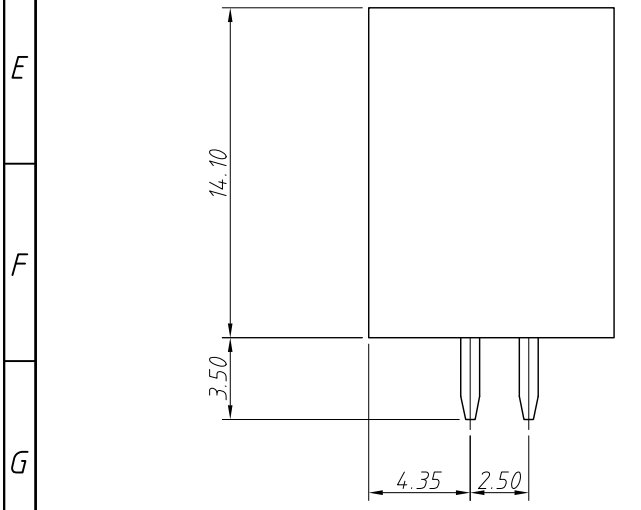
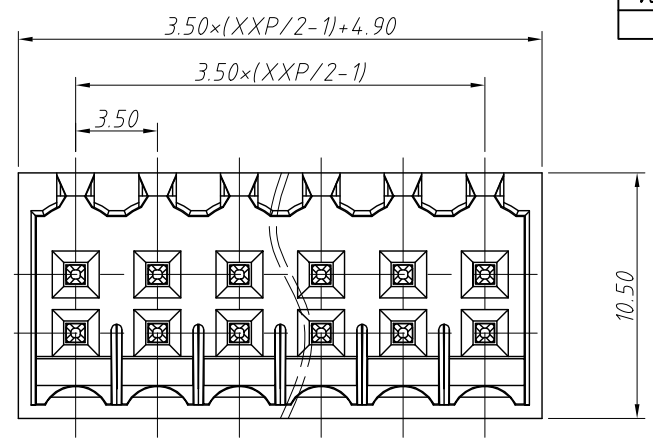

ANGLE TOLERANCE	PROJECTION	Description:
±3°		Pitch 3.50mm Terminal Block
GENERAL TOLERANCE	UNITS	mm
0~30 ±0.50	SHEET SIZE	A4
30~60 ±0.75	Draw:	WuHao 2024-11-06
60~90 ±1.00	Check:	Daniel 2024-11-06
		NingBo KLS ELECTRONIC CO.,L TD.