

1 RoHS Compliance

REV	SYM	Revision Record	Appr.	Date
V0	KLS02006	New Version Release	Jenny	2024-07-29
V1	KLS02006	Technology Improvement	WuHao	2024-10-24

Electrical Characteristics	UL	IEC
Rated Voltage	150V	80V
Rated Current	7A	10A
Withstand Voltage	1300V/1 min	2.5 KV

Material
 Housing: PA66, UL 94 V-0
 Pin header: Copper alloy, Sn plated

Electrical
 Operating temperature: -40°C ~ +105°C

Order Information:
 L-KLS2-GHSR-3.50-XXP-X

L: RoHS
 Terminal Block
 Pitch: 3.50mm
 No. of (04 ~ 48) pins
 Color:
 1=Gray 2=Blue 3=Black
 4=Green 5=Orange 6=Red
 7=Transp 8=Yellow 9=White

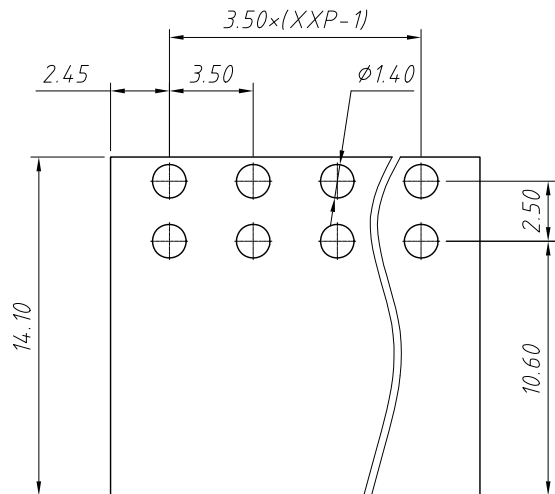

Recommended PCB Layout

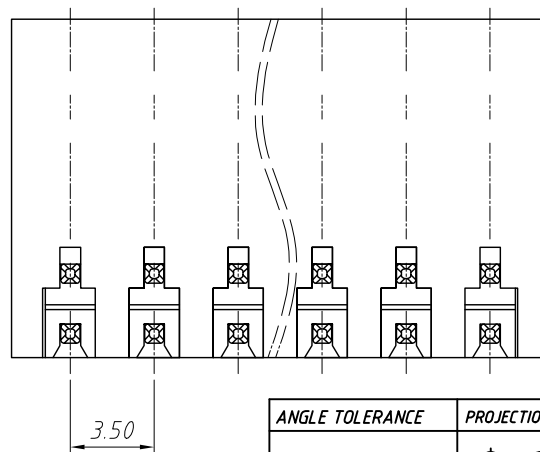
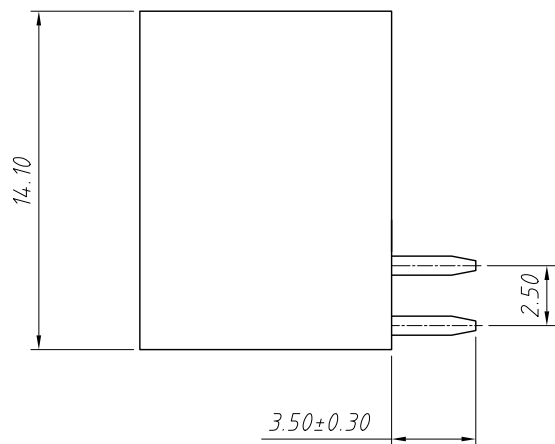
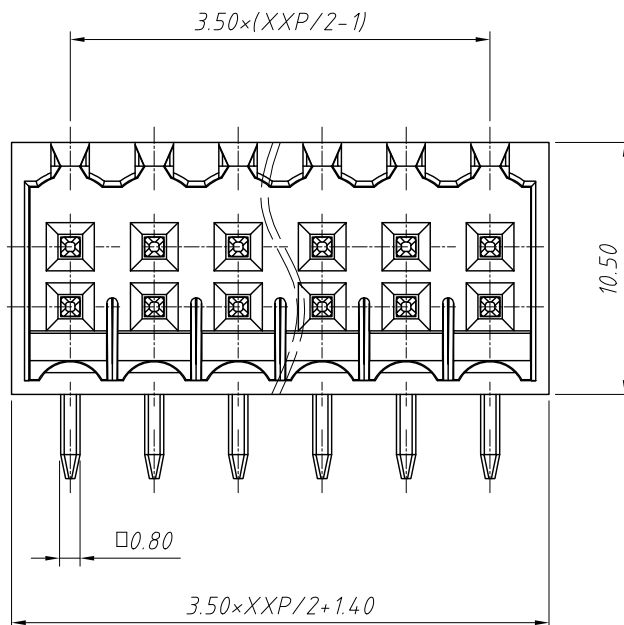

ANGLE TOLERANCE	PROJECTION	Description:
±3°		Terminal Block 3.50mm
GENERAL TOLERANCE	UNITS	mm
x.x ±0.30	SHEET SIZE	A4
x.xx ±0.20	Draw:	WuHao 2024-10-24
x.xxx ±0.10	Check:	Daniel 2024-10-24



NingBo KLS ELECTRONIC CO.,L TD.