

1  
RoHS Compliance

7		8		
REV	SYM	Revision Record	Appr.	Date
V0	KLS02006	New Version Release	Song	2024-09-07

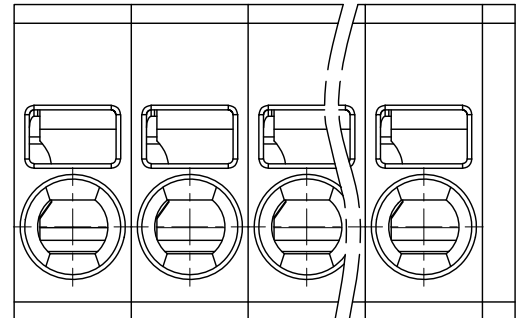
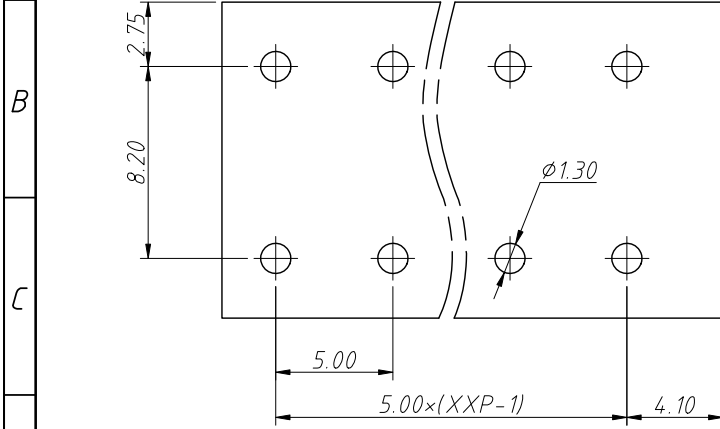

Electrical Characteristics	UL	IEC
Rated Voltage	300V	250V
Rated Current	20A	24A
Withstand Voltage	1600V/1 min	4.0KV
Wire Range	24 ~ 12AWG	0.2 ~ 4.0mm <sup>2</sup> / 0.2 ~ 2.5mm <sup>2</sup>

Material and other:  
 Housing: PA66, UL 94V-0  
 Pin Header: Copsy Alloy, Sn Plated  
 Stripping Length: 9 ~ 10mm  
 Operating Temperature: -40°C ~ +105°C

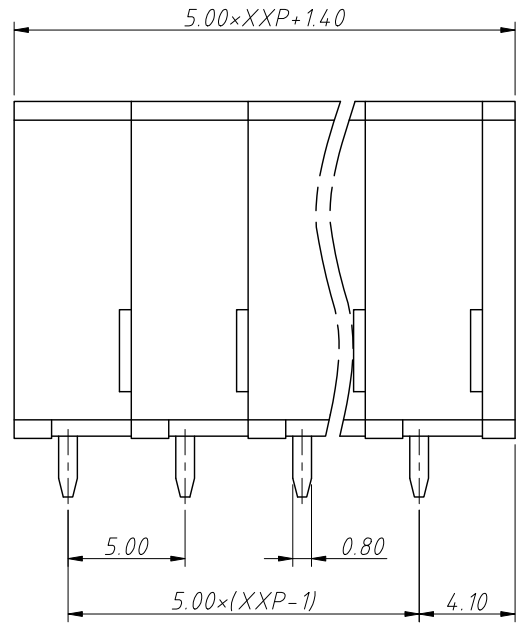
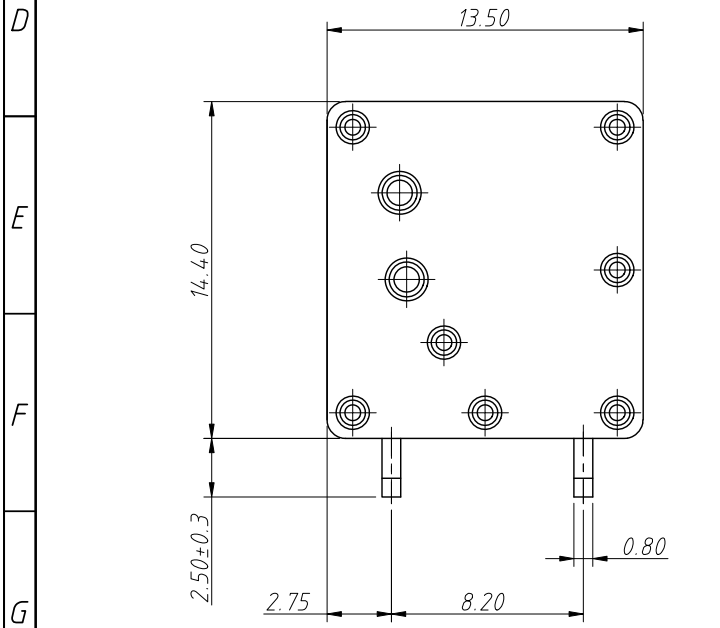

Order Information  
 L-KLS2-262V-5.00-XXP-X

RoHS  
 Terminal Block  
 Pitch: 5.00mm  
 No.: Of (01 ~ 30) Pins  
 Color: 1=Gray 2=Blue 3=Black  
 4=Green 5=Orange 6=Red  
 7=Transp 8=Yellow 9=White

ANGLE TOLERANCE	PROJECTION	Description:		
±3°		5.00mm Spring Terminal Blocks		
GENERAL TOLERANCE	UNITS	mm	KLS P/N:	
0 ~ 30	±0.50	SHEET SIZE	L-KLS2-262V-5.00-XXP-X	
30 ~ 60	±0.75	Draw:	Song	2024-09-07
60 ~ 90	±1.00	Check:	Daniel	2024-09-07

