

1 RoHS Compliance

REV	SYM	Revision Record	Appr.	Date
V0	KLS02006	New Version Release	Song	2024-09-02

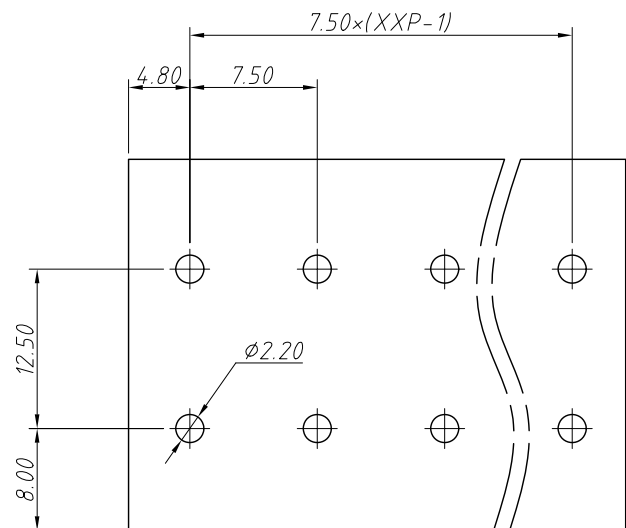

Recommended PCB Layout

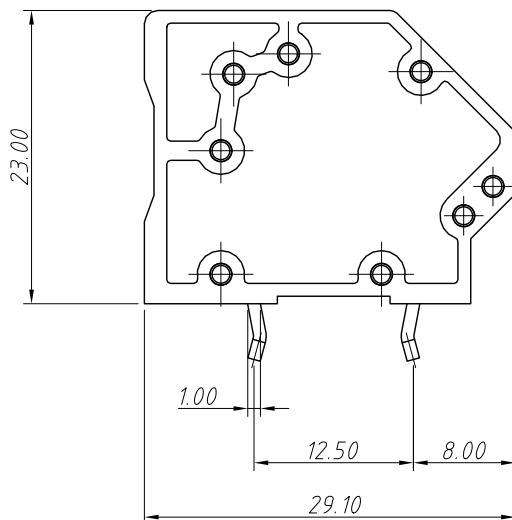
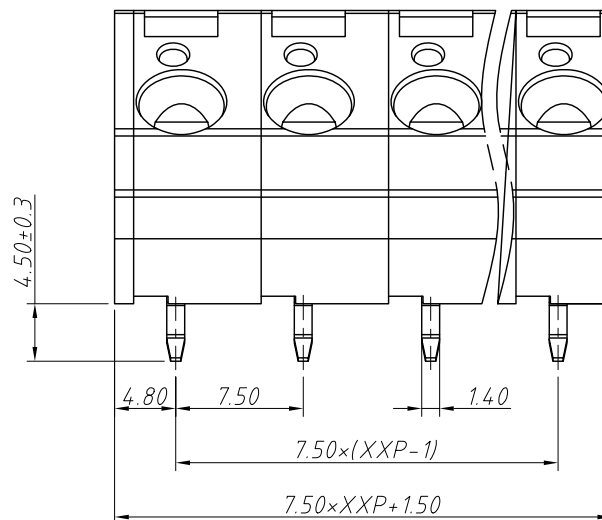
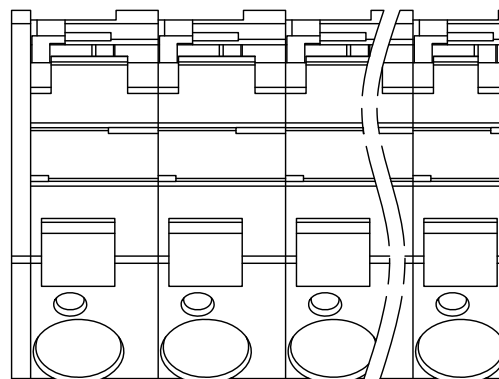

Electrical Characteristics	UL	IEC
Rated Voltage	300V	500V
Rated Current	30A	32A
Withstand Voltage	1600V/1 min	6.0KV
Wire Range	24~10AWG	0.2~6.0mm ²

Material and other:
 Housing:PA, UL94V-0
 Pin Header:Coppo Alloy,Sn Plated
 Stripping Length:10mm
 Operating Temperature:-40°C~+105°C

Order Information
 L-KLS2-261-7.50-XXP-X

ANGLE TOLERANCE	PROJECTION	Description:
±3°		7.50mm Spring Terminal Blocks
GENERAL TOLERANCE	UNITS	mm
0~30 ±0.50	SHEET SIZE	A4
30~60 ±0.75	Draw:	Song
60~90 ±1.00	Check:	Daniel
KLS P/N:		L-KLS2-261-7.50-XXP-X

NingBo KLS ELECTRONIC CO.,L TD.