

RoHS Compliance

REV	SYM	Revision Record	Appr.	Date
V0	KLS02006	New Version Release	Song	2024-08-22

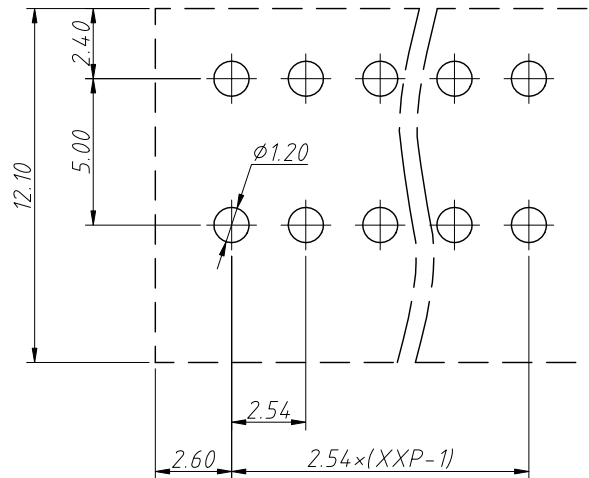

Recommended PCB Layout

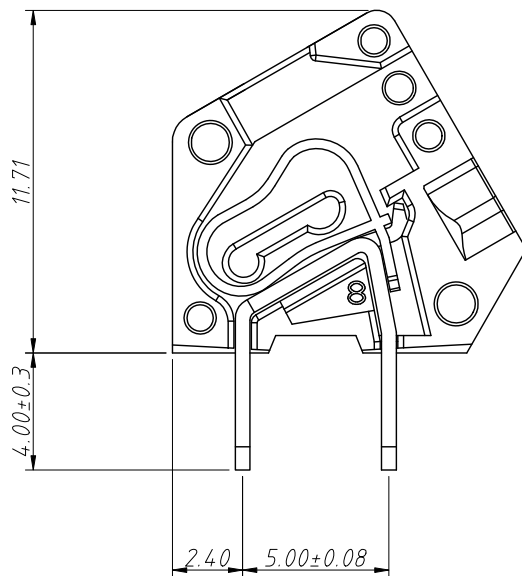
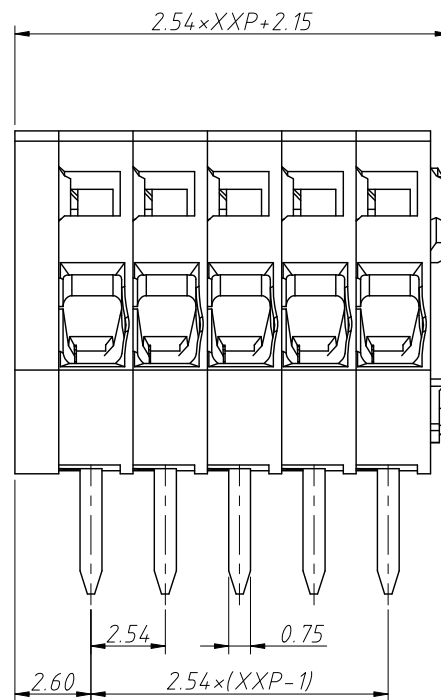
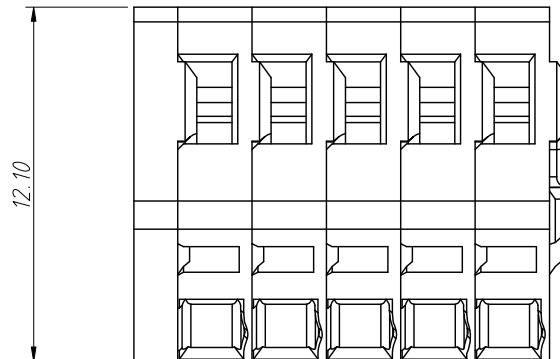

Electrical Characteristics	UL	IEC
Rated Voltage	150V	63V
Rated Current	4A	6A
Withstand Voltage	1300V/1min	2.5KV
Wire Range	28~20AWG	0.2~0.5mm ²

Material and other:

Housing:PA, UL 94 V-0

Pin HeaderCoppoly Alloy,Sn Plated

Stripping Length:5~6mm

Operating Temperature:-40°C~+105°C

Order Information

L-KLS2-206B-2.54-XXP-X

- RoHS
- Terminal Block
- Pitch:2.54mm
- No.:Of Pins(01~30)
- Color:1=Gray 2=Blue 3=Black
- 4=Green 5=Orange 6=Red
- 7=Transp 8=Yellow 9=White

ANGLE TOLERANCE	PROJECTION	Description:	2.54mm Spring Terminal Blocks	
±3°				
GENERAL TOLERANCE	UNITS	mm	KLS P/N:	L-KLS2-206B-2.54-XXP-X
0~30 ±0.50	SHEET SIZE	A4		
30~60 ±0.75	Draw:	Song	2024-08-22	NingBo KLS ELECTRONIC CO.,LTD.
60~90 ±1.00	Check:	Daniel	2024-08-22	