

1 RoHS Compliance

REV	SYM	Revision Record	Appr.	Date
V0	KLS02006	New Version Release	Song	2024-08-28

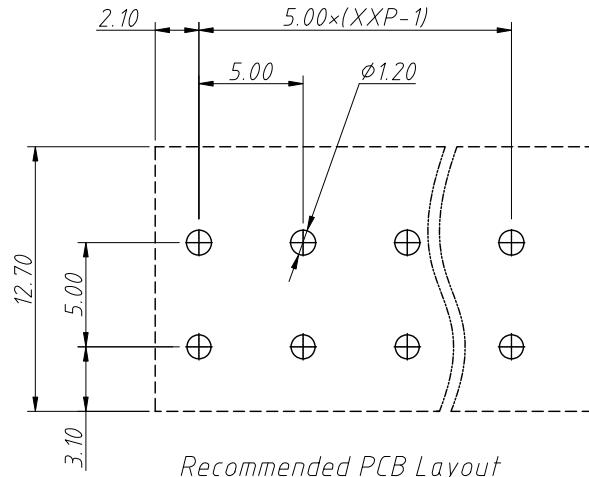

Recommended PCB Layout

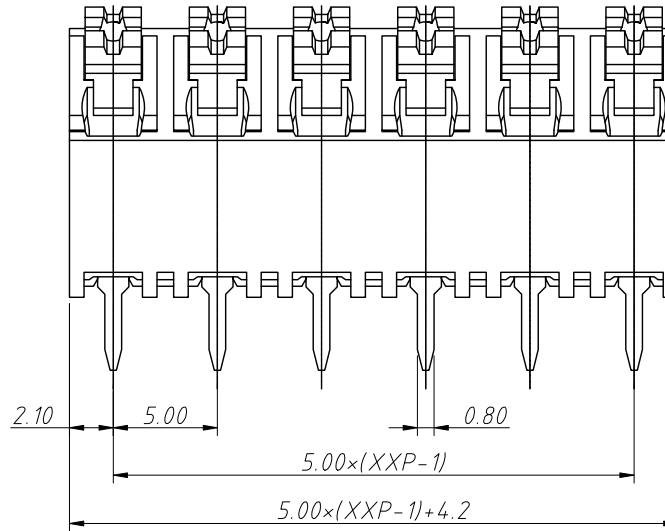
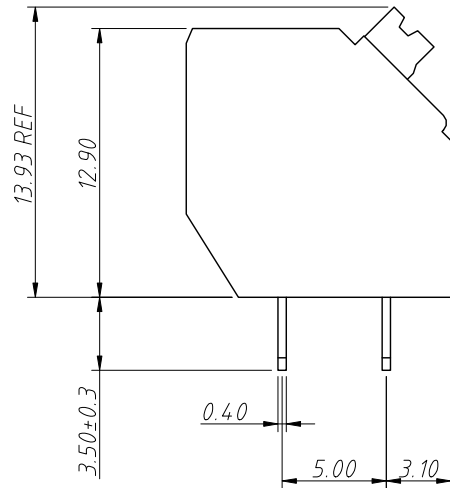
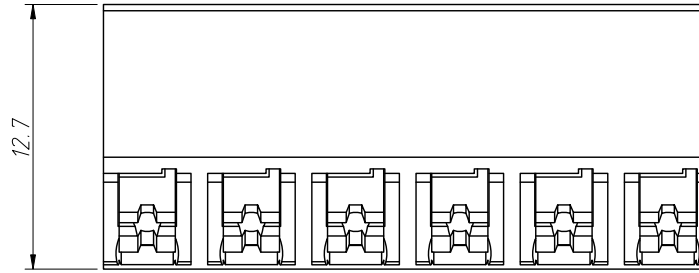

Electrical Characteristics	UL	IEC
Rated Voltage	300V	250V
Rated Current	10A	17.5A
Withstand Voltage	1600V / 1min	4.0KV
Wire Range	24 ~ 16 AWG	0.2 ~ 1.5mm ²

Material and other:

Housing:LCP, UL94V-0

Pin:Copper Alloy,Sn Plated

Stripping Length:7~8mm

Operating Temperature:-40°C ~ +130°C

Soldering Temperature:285°C /10S

Order Information

L-KLS2-212S-5.00-XXP-X

RoHS

Terminal Block

Pitch:5.00mm

No.:Of (02~24) Pins

Color:

- 1=Gray 2=Blue 3=Black
- 4=Green 5=Orange 6=Red
- 7=Transp 8=Yellow 9=White

ANGLE TOLERANCE	PROJECTION	Description:	5.00mm Spring Terminal Block		
±3°					
GENERAL TOLERANCE	UNITS	mm	KLS P/N:	L-KLS2-212S-5.00-XXP-X	
0~30 ±0.50	SHEET SIZE	A4			
30~60 ±0.75	Draw:	Song	2024-08-28	NingBo KLS ELECTRONIC CO.,LTD.	
60~90 ±1.00	Check:	Daniel	2024-08-28		