

1  
RoHS Compliance

7		8	
REV	SYM	Revision Record	Appr.
V0	KLS02006	New Version Release	Song
		Date	2024-08-19

Electrical Characteristics	UL	IEC
Rated Voltage	300V	250V
Rated Current	15A	12A
Withstand Voltage	1600V / 1min	4.0KV

Material and other:  
 Housing:LCP, UL94V-0  
 Pin:Copper Alloy,Sn Plated  
 Operating Temperature:-40°C ~ +130°C

Order Information  
**L-KLS2-THREDVC-5.00-XXP-X**

RoHS  
 Terminal Block  
 Pitch:5.00mm  
 No.:Of (02~24) Pins  
 Color:

1=Gray	2=Blue	3=Black
4=Green	5=Orange	6=Red
7=Transp	8=Yellow	9=White

A  
B  
C  
D  
E  
F  
G  
H

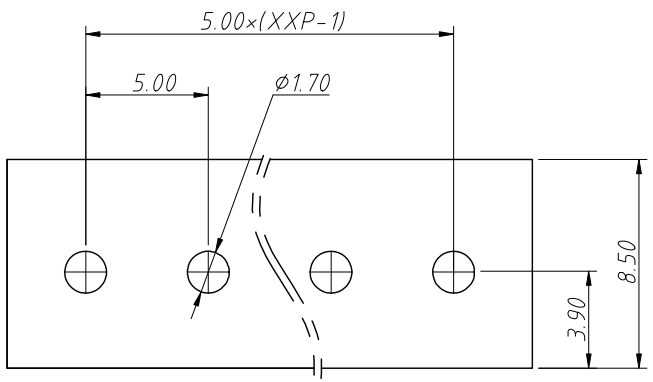

Recommended PCB Layout

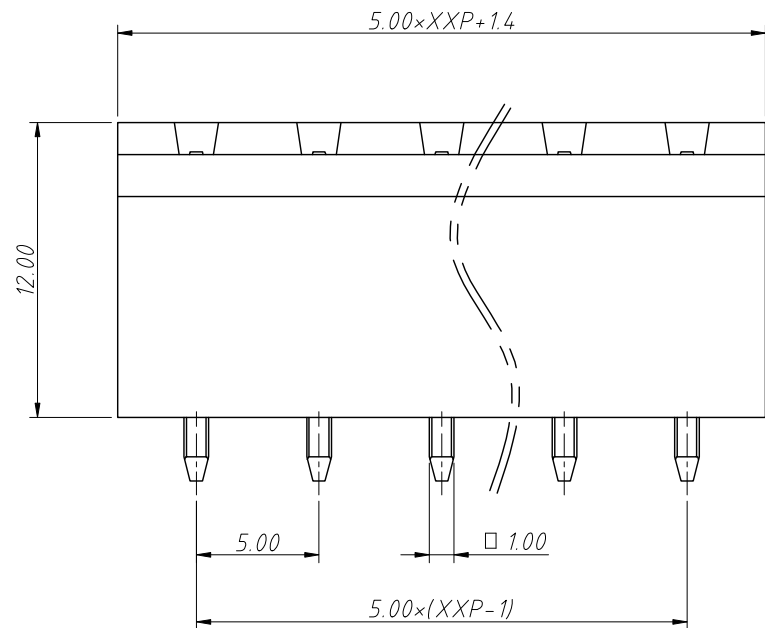
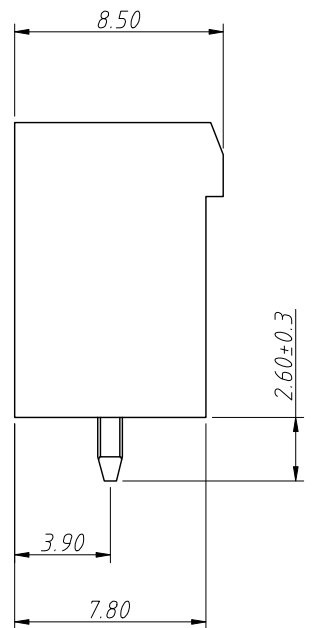
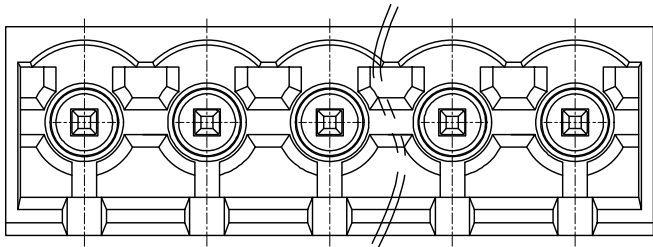

ANGLE TOLERANCE	PROJECTION	Description:	
±3°		Pitch 5.00mm Pluggable Terminal Block ,Socket	
GENERAL TOLERANCE	UNITS	mm	KLS P/N:
0~30	±0.50	SHEET SIZE	A4
30~60	±0.75	Draw:	Song 2024-08-19
60~90	±1.00	Check:	Daniel 2024-08-19

**KLS** NingBo KLS ELECTRONIC CO.,L TD.

1  
RoHS Compliance

7		8	
REV	SYM	Revision Record	Appr.
V0	KLS02006	New Version Release	Song
			Date
			2024-08-19

Electrical Characteristics	UL	IEC
Rated Voltage	300V	250V
Rated Current	15A	12A
Withstand Voltage	1600V / 1min	4.0KV

Material and other:  
Housing: LCP, UL94V-0  
Pin: Copper Alloy, Sn Plated  
Operating Temperature: -40°C ~ +130°C  
Soldering Temperature: 285°C / 10S

Order Information  
L-KLS2-THREDVC-5.08-XXP-X

RoHS  
Terminal Block  
Pitch: 5.08mm  
No.: Of (02 ~ 24) Pins  
Color:

1=Gray	2=Blue	3=Black
4=Green	5=Orange	6=Red
7=Transp	8=Yellow	9=White

A  
B  
C  
D  
E  
F  
G  
H

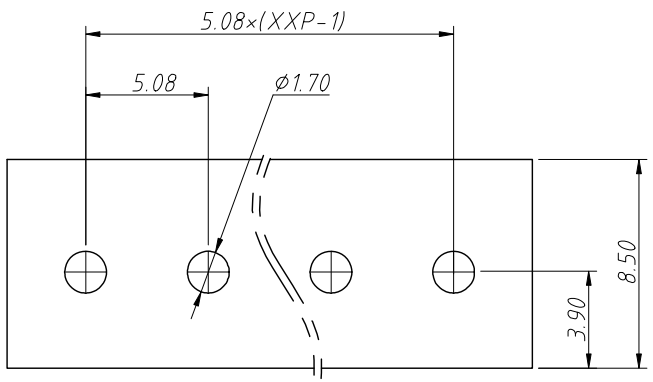

Recommended PCB Layout

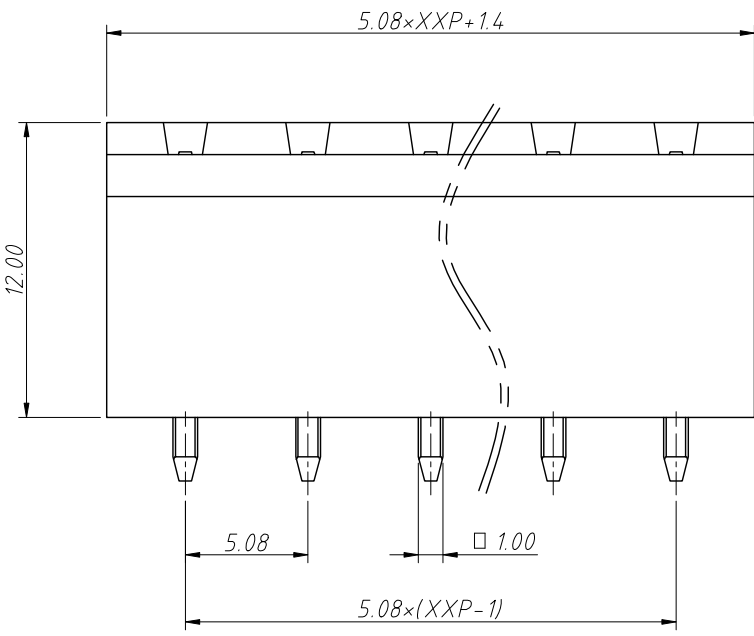
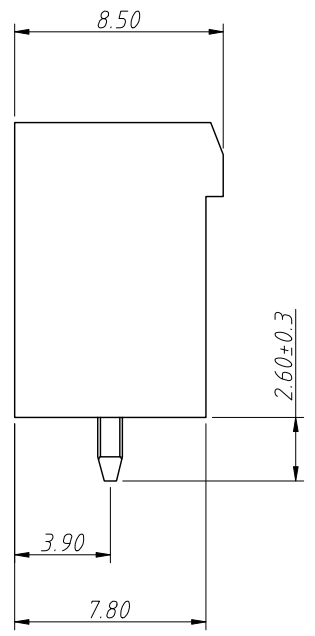
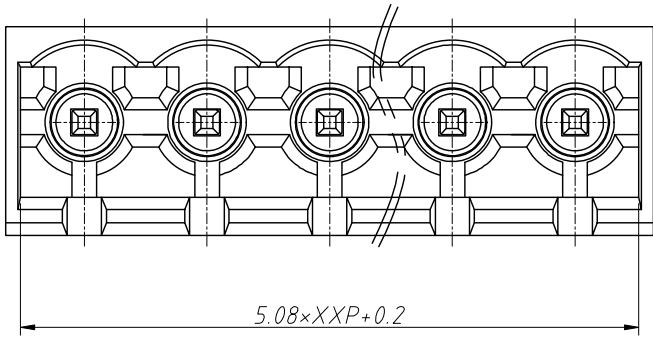

ANGLE TOLERANCE	PROJECTION	Description:	
±3°		Pitch 5.08mm Pluggable Terminal Block ,Socket	
GENERAL TOLERANCE	UNITS	mm	KLS P/N:
0 ~ 30	±0.50	SHEET SIZE	A4
30 ~ 60	±0.75	Draw:	Song 2024-08-19
60 ~ 90	±1.00	Check:	Daniel 2024-08-19
		NingBo KLS ELECTRONIC CO.,L TD.	