

RoHS Compliance

REV	SYM	Revision Record	Appr.	Date
V0	KLS07018	New Version Release	Jenny	2024-07-26
V1.0	⚠	Delete the schematic diagram of the flat handle	Song	2025-01-10

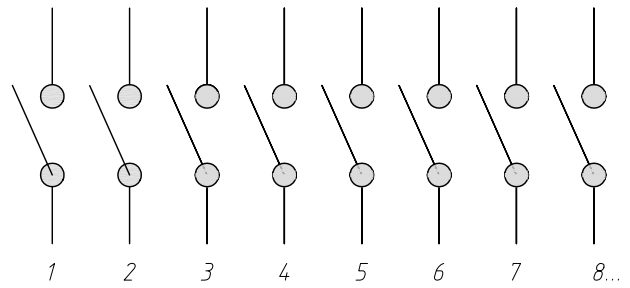
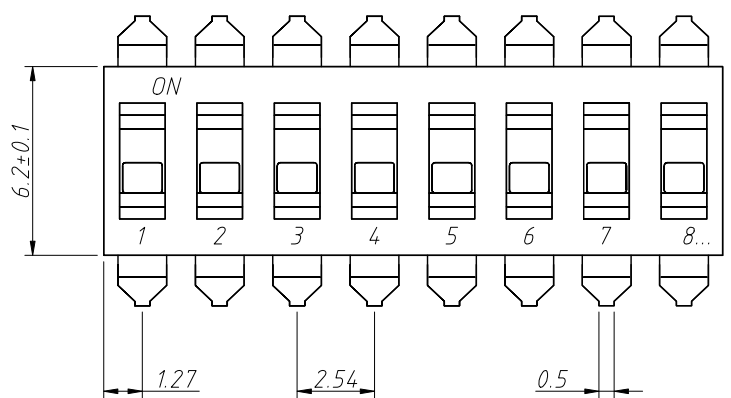
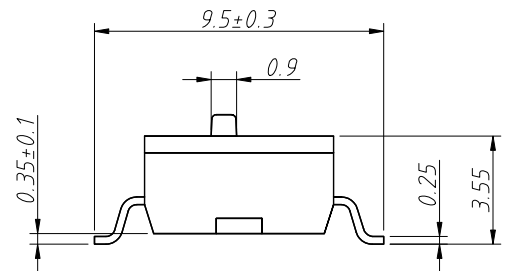
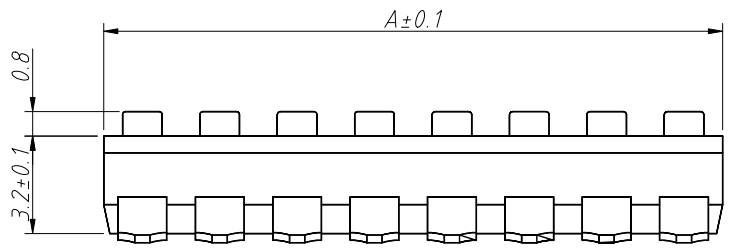

Schematic

No. of Pin	A
01	2.54
02	5.08
03	7.62
04	10.16
05	12.70
06	15.24
07	17.78
08	20.32
09	22.86
10	25.40
12	30.48

Material:
 Cover:PPS,UL 94V-0 ; Housing:PPS,UL 94V-0
 Actuator:PA46,UL 94V-0
 Contacts:Beryllium Copper,Gold over Nickel Plated
 Terminals:Brass,Gold over Nickel Plated

Electrical Characteristics:
 Current/voltage rating:
 Non-switching:100mA@50VDC ; Switching:25mA @ 24 VDC
 Insulation resistance:100M Ω @ 250VDC
 Contact resistance:50m Ω max
 Dielectric strength:500VAC /1 min
 Operating life:500gf max ; Electrical life:2000 cycles
 Operating temperature:-20°C to 85°C (no ice)

Order Information:
 L-KLS7- KL- XX- N - 0 0

L: RoHS
 KL
 Type Dip Switch
 No. of 01~12Pin
 Color:N-Black
 0:Non-sealed 1=with sealed
 Packaging:0=Tube 1=Tape

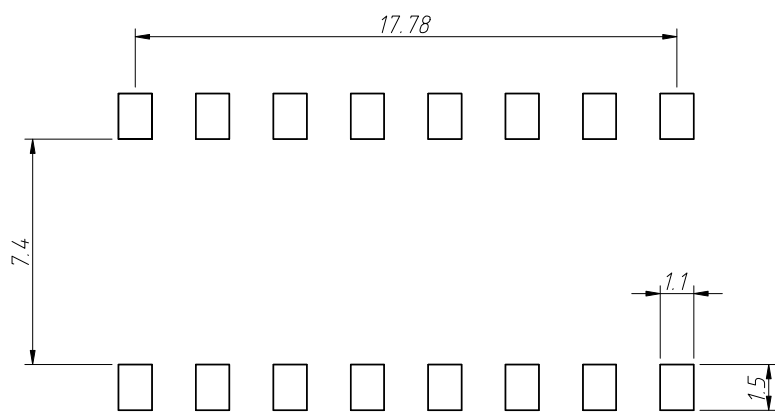

Recommended PCB Layout

ANGLE TOLERANCE	PROJECTION	Description:	2.54mm End stackable SMD type	
$\pm 3^\circ$				
GENERAL TOLERANCE	UNITS	mm	KLS P/N:	L-KLS7-KL-XX-N-XX
x.x ± 0.30	SHEET SIZE	A4		
x.xx ± 0.20	Draw:	Jenny	2024-07-26	NingBo KLS ELECTRONIC CO.,L TD.
x.xxx ± 0.10	Check:	Daniel	2024-07-26	