

1 RoHS Compliance

REV	SYM	Revision Record	Appr.	Date
V0	KLS02006	New Version Release	WuHao	2024-09-19

Electrical Characteristics	UL	IEC
Rated Voltage	600V	800V
Rated Current	30A	41A
Withstand Voltage	2200V / 1min	8.0KV
Wire Range	10~24 AWG	0.2-6.0mm ² / 0.2-4.0mm ²

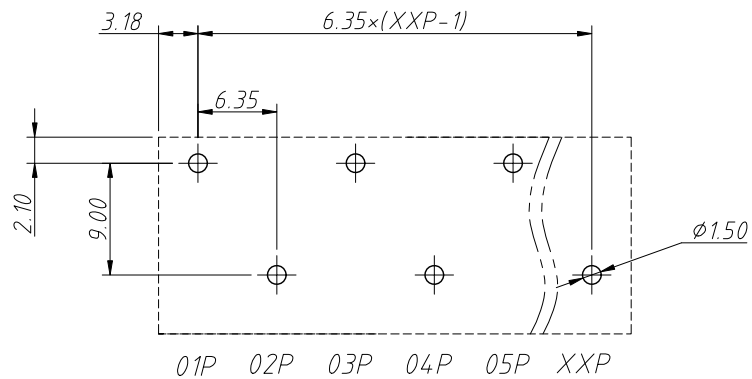

01P 02P 03P 04P 05P XXP
Recommended PCB Layout

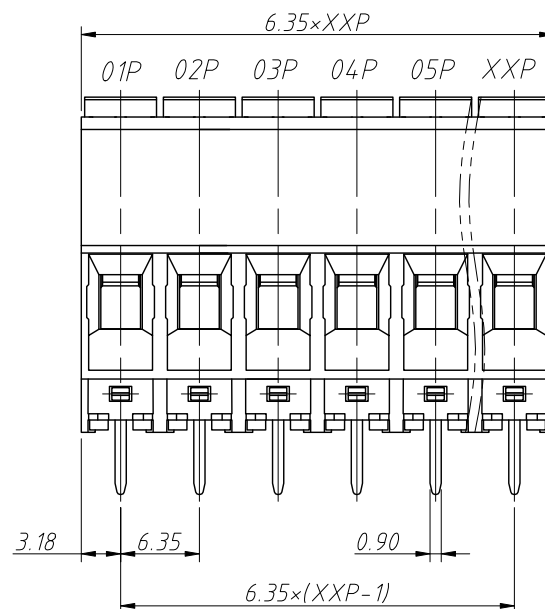
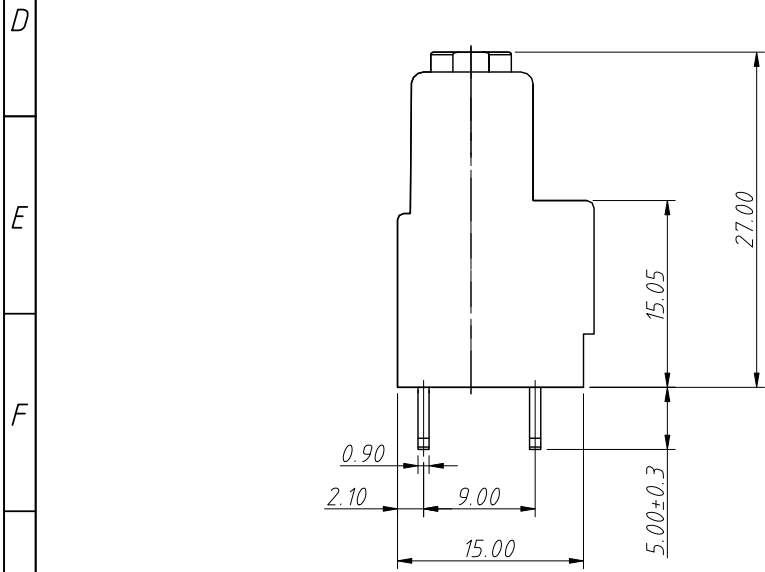
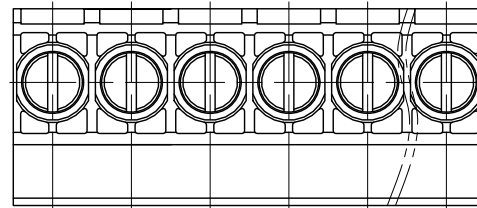

Order Information

L-KLS2-137-6.35-XXP-X X

RoHS
Terminal Block
Pitch:6.35mm
No.:Of (02~18) Pin
Color:
1=Gray 2=Blue 3=Black
4=Green 5=Orange 6=Red
7=Transp 8=Yellow 9=White
Screw:SC=Slot/Cross

S-Slot Screw C-Cross Screw

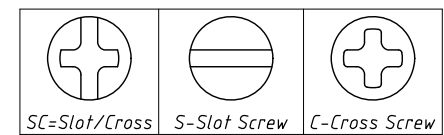

Material and other:
Housing+Cover:PA66,UL94V-0
Pin header:Copper Alloy,Sn Plated Cage:Copper Alloy,Ni Plated
Screw/Torque:Steel,M3 Zn Plated/0.5N.m Max.
Steip Length:8mm
Operating temperatur:-40°C ~ +105°C Soldering Temperature:+260°C/5 S

ANGLE TOLERANCE	PROJECTION	Description:
$\pm 3^\circ$		Pitch 6.35mm Screw fixation Terminal Block
GENERAL TOLERANCE	UNITS	mm
0~30	± 0.50	SHEET SIZE
30~60	± 0.75	A4
60~90	± 1.00	Draw: WuHao 2024-09-19
	Check: Daniel 2024-09-19	

