

1 RoHS Compliance

REV	SYM	Revision Record	Appr.	Date
V0	KLS02006	New Version Release	WuHao	2024-09-18

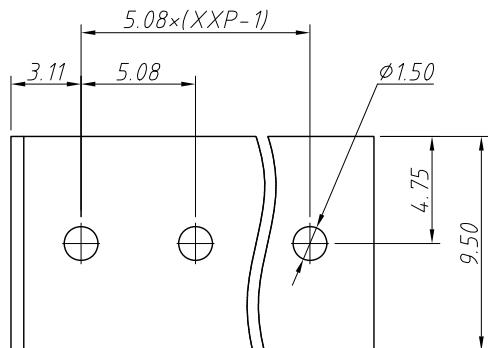

Recommended PCB Layout

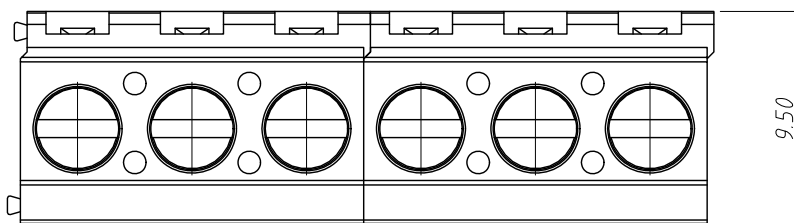

Electrical Characteristics	UL	IEC
Rated Voltage	300V	250V
Rated Current	20A	24A
Withstand Voltage	1600V / 1 min	4.0KV
Wire Range	12~30 AWG	0.2-2.5mm ²

Material and other:

Housing:PA66,UL 94 V-0
 Pin header:Copper Alloy,Sn Plated
 Cage:Copper Alloy,Ni Plated
 Screw/Torque:Steel,M3.0 Zn Plated/0.5N.m Max.
 Stripping Length:6~7mm
 Operating temperatur:-40°C ~ +105°C

Order Information

L-KLS2-129S-5.08-XXP-X X

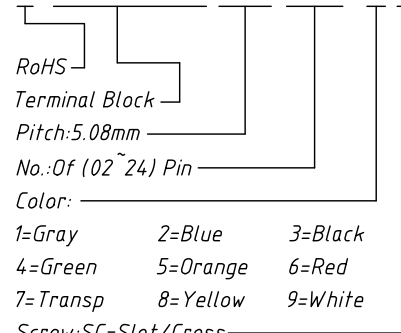

- 1=Gray 2=Blue 3=Black
- 4=Green 5=Orange 6=Red
- 7=Transp 8=Yellow 9=White

Screw:SC=Slot/Cross
 S-Slot Screw C-Cross Screw

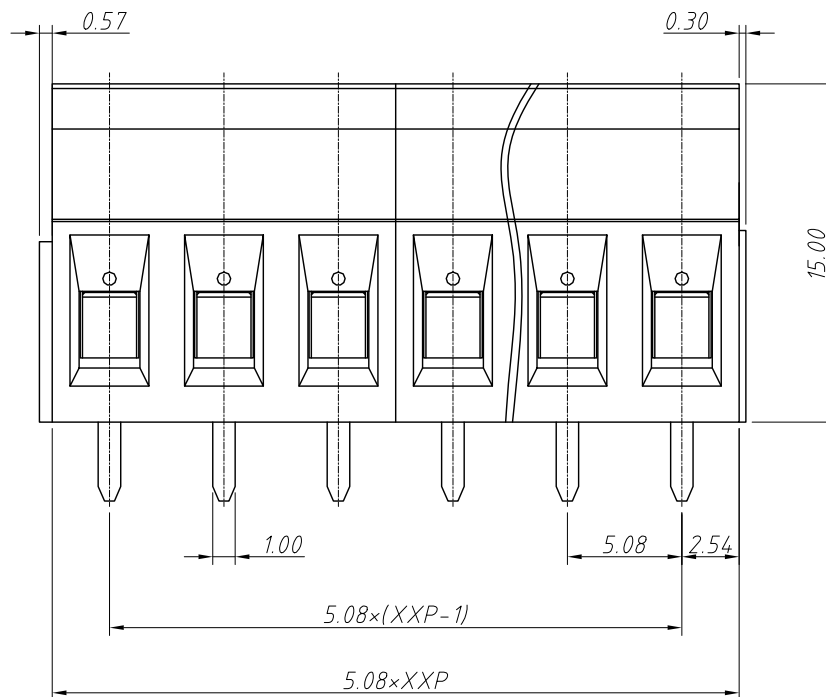
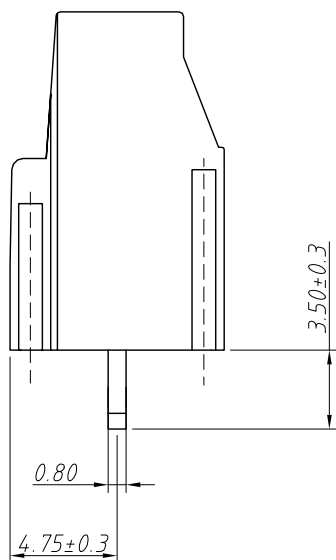
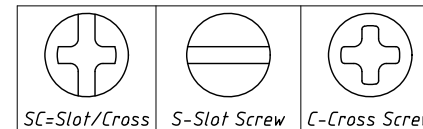

ANGLE TOLERANCE	PROJECTION	Description:
±3°		Pitch 5.08mm Screw fixation Terminal Block
GENERAL TOLERANCE	UNITS	mm
0~30	±0.50	
30~60	±0.75	
60~90	±1.00	
SHEET SIZE	A4	
Draw:	WuHao	2024-09-18
Check:	Daniel	2024-09-18
KLS electronic		NingBo KLS ELECTRONIC CO.,L TD.