

1
RoHS Compliance

REV	SYM	Revision Record	Appr.	Date
V0	KLS02006	New Version Release	Song	2023-09-13
V1	KLS02006	Technology Improvement	WuHao	2024-10-23

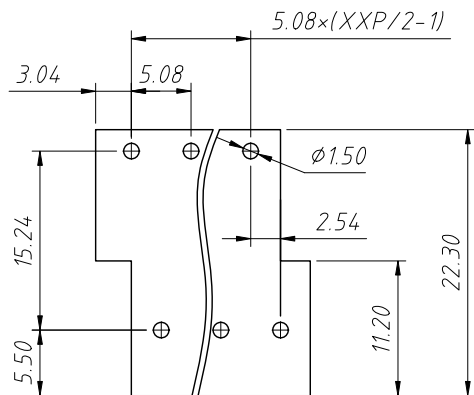

Recommended PCB Layout

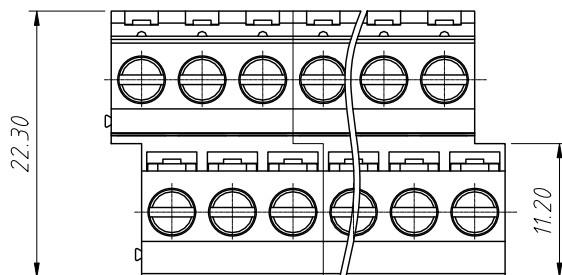

Electrical Characteristics	UL	IEC
Rated Voltage	300V	250V
Rated Current	20A	20A
Withstand Voltage	1600V/1 min	4.0 KV
Wire Range	12~26 AWG	0.5~2.5mm ²

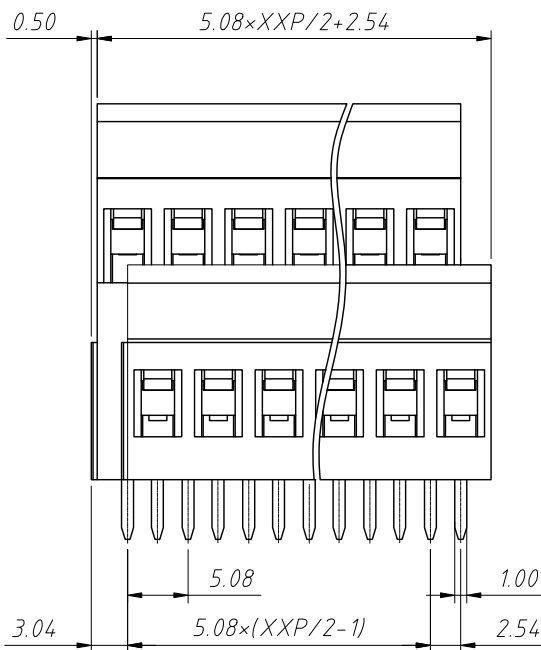
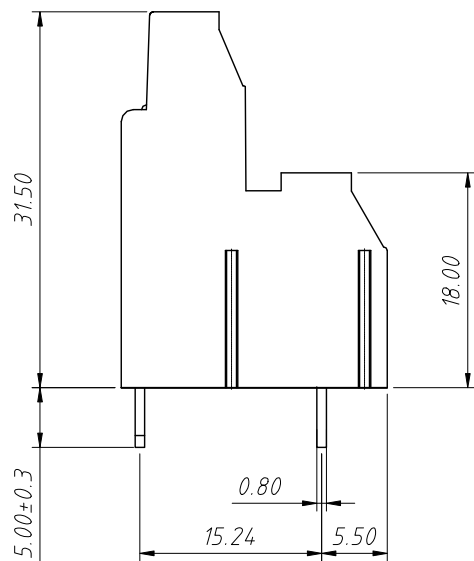

Order Information

L-KLS2-132A-5.08-XXP-X X

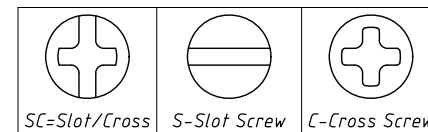
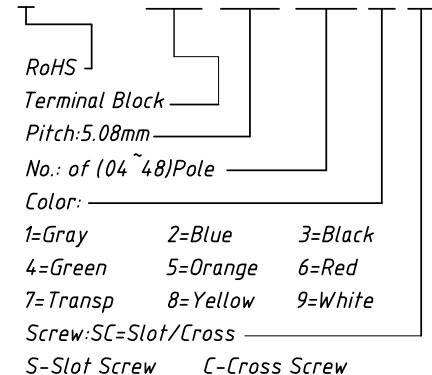

Material And Other:

Insulation: PA66, UL 94 V-0

Contactoe: Copper Alloy, Sn Plated

Stripping Length: 6~7mm Screw/Torque: M3/0.5N.m

Operating Temperature: -40°C ~ +105°C Soldering Temperature: 260°C/5S

ANGLE TOLERANCE	PROJECTION	Description:
±3°		5.08mm Screw fixed terminal blocks
GENERAL TOLERANCE	UNITS	mm
x.x ±0.30	SHEET SIZE	A4
x.xx ±0.20	Draw:	WuHao 2024-10-23
x.xxx ±0.10	Check:	Daniel 2024-10-23



NingBo KLS ELECTRONIC CO.,L TD.