

1  
RoHS Compliance

6		7		8	
REV	SYM	Revision Record	Appr.	Date	
V0	KLS02006	New Version Release	WuHao	2024-11-12	

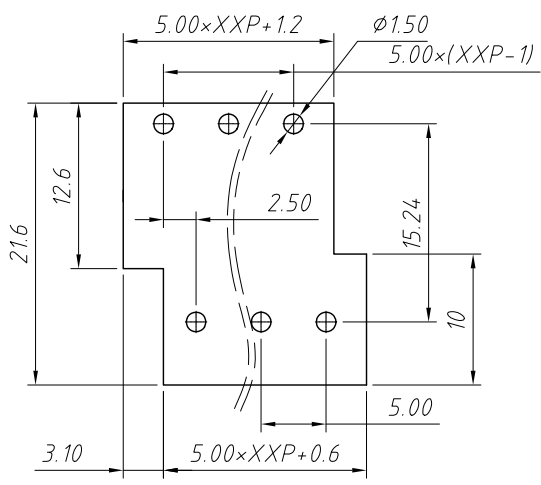

Recommended PCB Layout

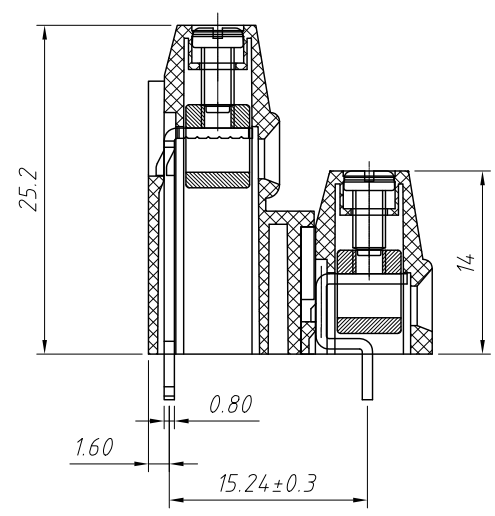
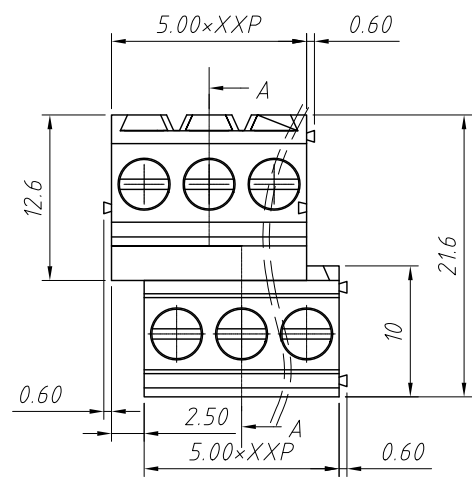

SECTION A-A

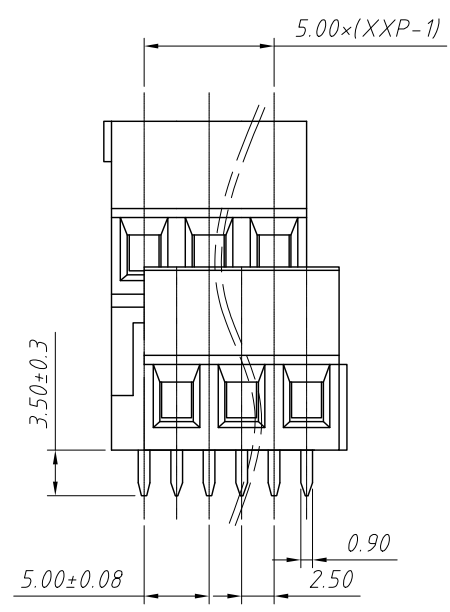

Electrical Characteristics	UL	IEC
Rated Voltage	300V	250V
Rated Current	15A	18A
Withstand Voltage	AC2000V/1min	---
Wire Range	30~12 AWG	2.5mm <sup>2</sup>

Material  
 Housing:PA66,UL94V-0 Pin Header:Brass,0.8t,Tin plated  
 Cage:Brass,Ni Plated Steip Length:6~7mm  
 Screw/Torque:Steel,M2.5,Zn Plated/0.4N.m Max  
 Temp.Range:-40°C ~ +105°C Soldering:+250°C,For 5 Sec  
 Contact resistance:20mΩ MAX  
 Insulation resistance:500MΩ/DC500V

Order Information

L-KLS2-1281A-5.00-XXP-X X 01

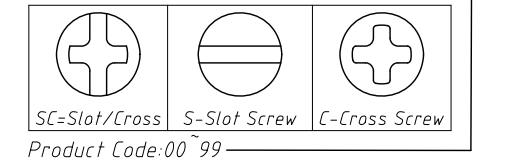
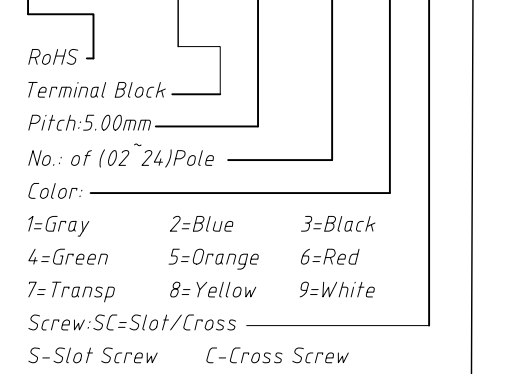

ANGLE TOLERANCE	PROJECTION	Description:			
±3°		Pitch 5.00mm Terminal Blocks			
GENERAL TOLERANCE	UNITS	mm	KLS P/N:	L-KLS2-1281A-5.00-XXP-XX01	
x.x ±0.30	SHEET SIZE	A4			
x.xx ±0.20	Draw:	WuHao	2024-11-12	NingBo KLS ELECTRONIC CO.,L TD.	
x.xxx ±0.10	Check:	Daniel	2024-11-12		

1 RoHS Compliance

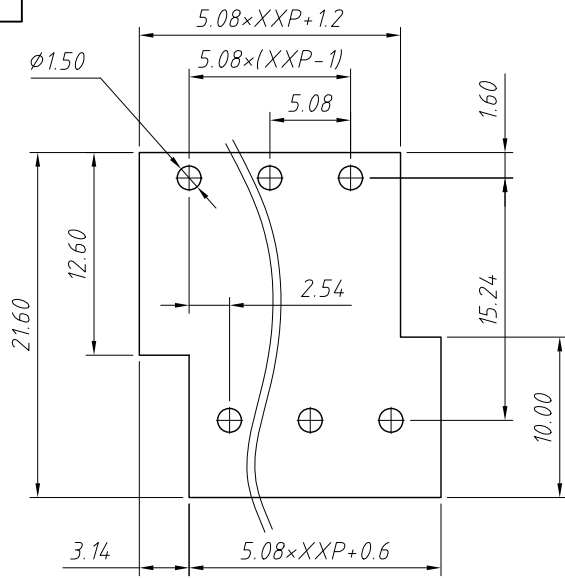

Recommended PCB Layout

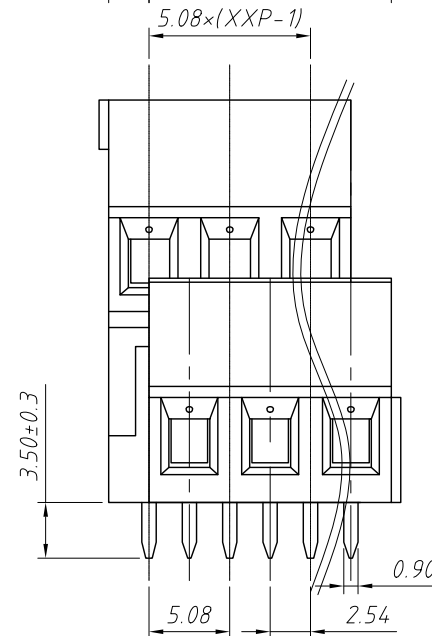
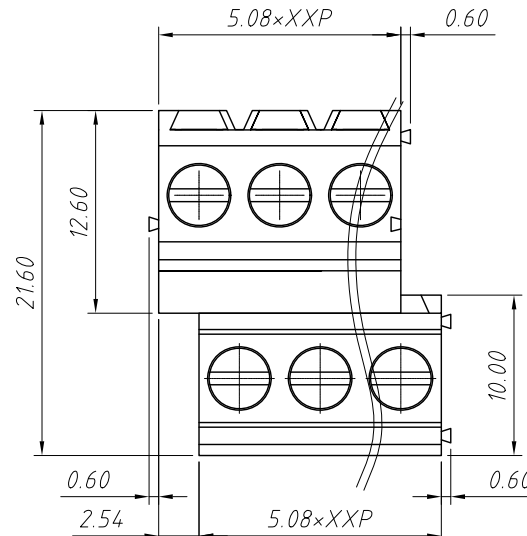
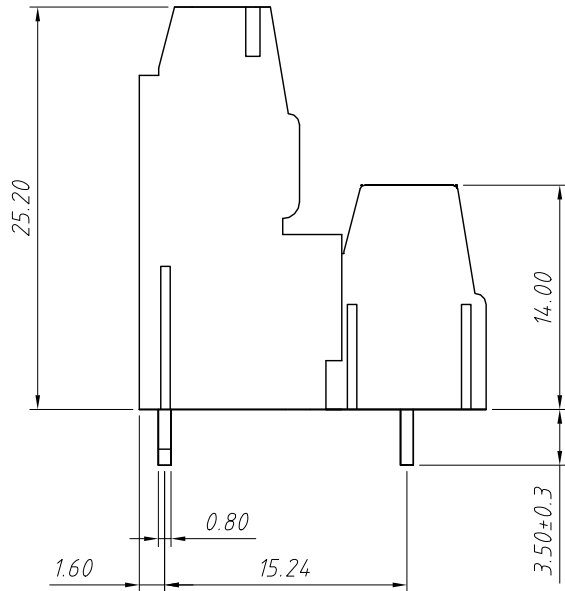

REV	SYM	Revision Record	Appr.	Date
V0	KLS02006	New Version Release	WuHao	2024-11-12

Electrical Characteristics	UL	IEC
Rated Voltage	300V	250V
Rated Current	15A	24A
Withstand Voltage	1600V/1 min	4.0 KV
Wire Range	30~14 AWG	0.5~2.5mm <sup>2</sup>

Material

Housing:PA66,UL94V-0

Pin Header:Copper Alloy,Sn plated

Steip Length:6~7 mm

Screw/Torque:M2.5/0.4N.m Max

Operating Temperature:-40°C ~ +105°C

Soldering Temperature:+260°C,For 5 Sec

Order Information

L-KLS2-128IA-5.08-XXP-X X 01

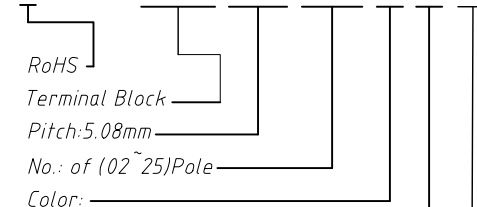

Color: 1=Gray 2=Blue 3=Black

4=Green 5=Orange 6=Red

7=Transp 8=Yellow 9=White

Screw:SC=Slot/Cross

S-Slot Screw C-Cross Screw

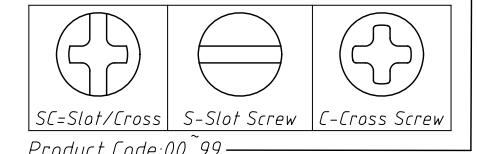

ANGLE TOLERANCE	PROJECTION	Description:
±3°		Pitch 5.08mm Terminal Blocks
GENERAL TOLERANCE	UNITS	mm
x.x ±0.30	SHEET SIZE	A4
x.xx ±0.20	Draw:	WuHao 2024-11-12
x.xxx ±0.10	Check:	Daniel 2024-11-12
KLS ELECTRONIC		NingBo KLS ELECTRONIC CO.,L TD.