

1 RoHS Compliance

6	7	8
REV	SYM	Revision Record
V0	KLS02006	New Version Release
		Appr.
		WuHao
		Date
		2024-09-23

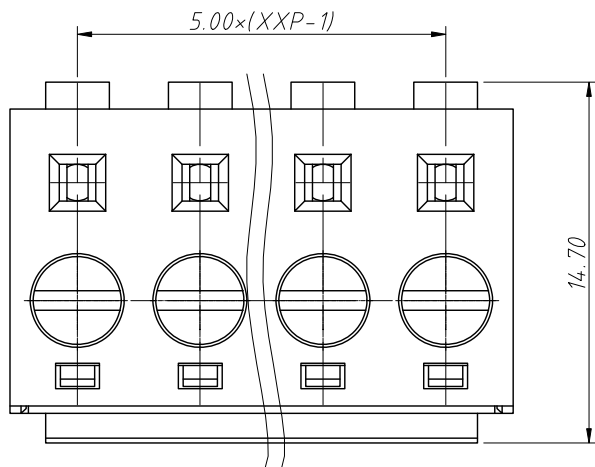

Material and other:
 Housing:PA66,UL94V-0
 Cage/Clamp:Copperalloy,Ni Plated
 Screw/Torque:Steel,M2.5 Zn Plated /0.4N.m Max.
 Contact resistance:20mΩ
 Insulation resistance:500MΩ/DC500V
 Steip Length:6mm
 Temp.Range:-40°C ~ +105°C

Electrical Characteristics	UL	IEC
Rated Voltage	300V	250V
Rated Current	12A	13.5A
Withstand Voltage	AC2000V / 1min	---
Wire Range	14 ~ 22 AWG	1.5mm ²

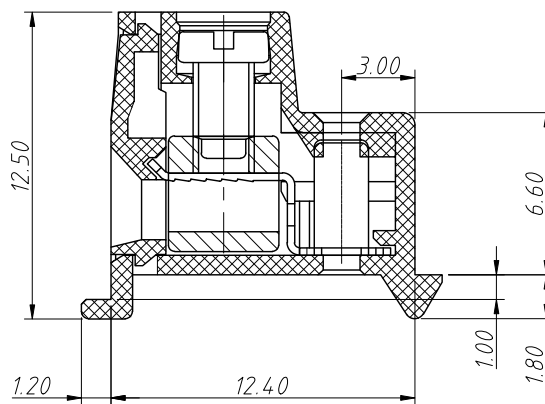
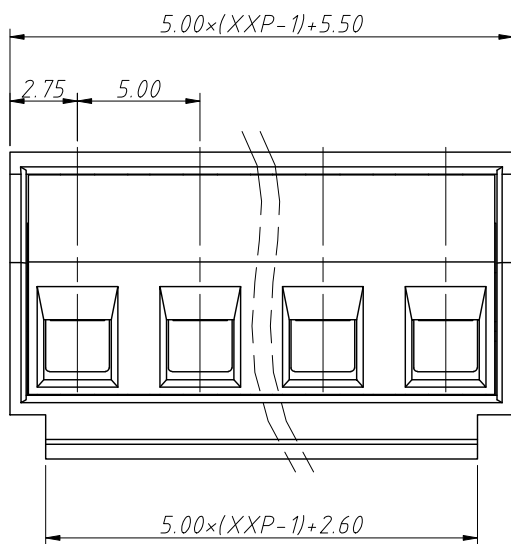

Order Information

L-KLS2-331K-5.00-XXP-X X

RoHS
 Terminal Block
 Pitch:5.00mm
 No.:Of (02~24) Pin
 Color:
 1=Gray 2=Blue 3=Black
 4=Green 5=Orange 6=Red
 7=Transp 8=Yellow 9=White
 Screw:SC=Slot/Cross
 S-Slot Screw C-Cross Screw

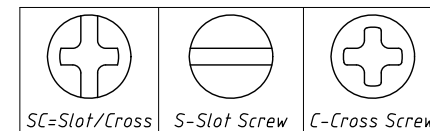

ANGLE TOLERANCE	PROJECTION	Description:
±3°		Pitch 5.00mm Screw fixation Terminal Block
GENERAL TOLERANCE	UNITS	mm
0 ~ 30	±0.50	KLS P/N:
	SHEET SIZE	A4
30 ~ 60	±0.75	Draw:
	Draw:	WuHao 2024-09-23
60 ~ 90	±1.00	Check:
	Check:	Daniel 2024-09-23



NingBo KLS ELECTRONIC CO.,LTD.