

1  
RoHS Compliance

6		7		8	
REV	SYM	Revision Record		Appr.	Date
V0	KLS02006	New Version Release		Song	2024-09-09

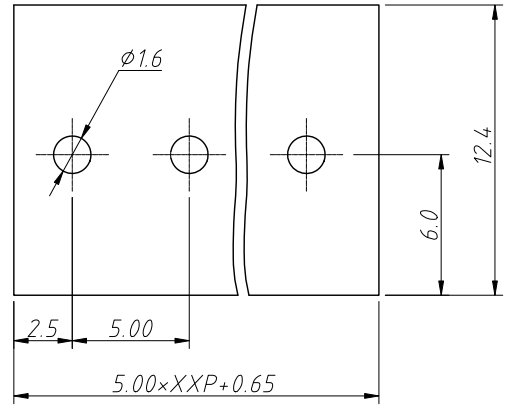

Recommended PCB Layout

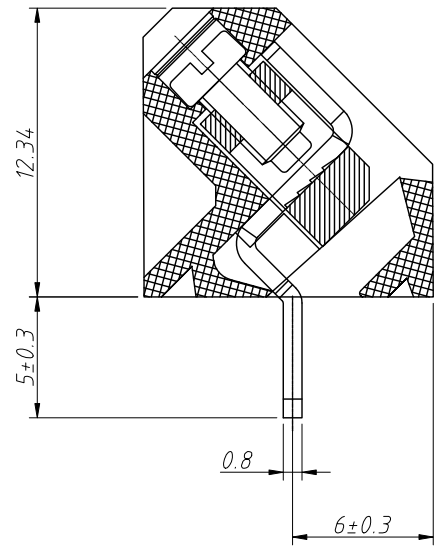
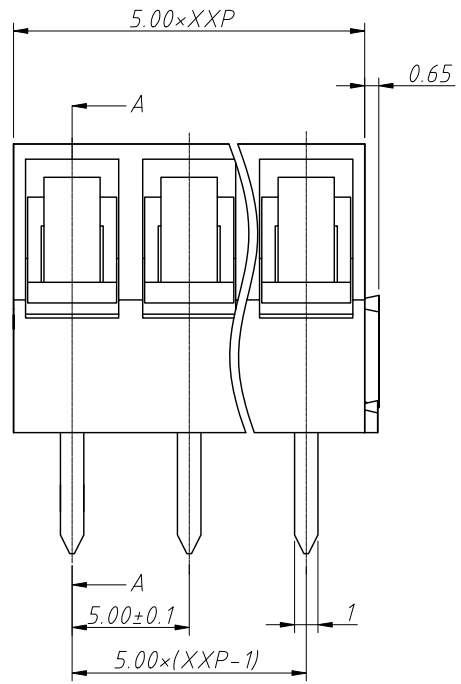
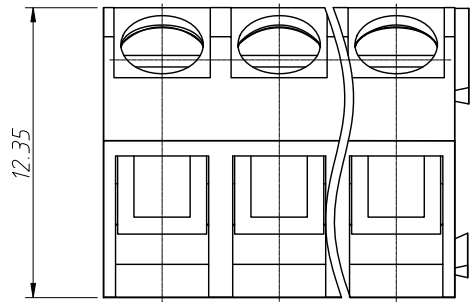

Electrical Characteristics	UL	IEC
Rated Voltage	300V	250V
Rated Current	15A	18A
Withstand Voltage	AC2000V/1 min	---
Wire Range	22~14 AWG	1.5mm <sup>2</sup>

Material and other:  
 Housing:PA66, UL94V-0  
 Screw/Torque:Steel,M2.5/Zn Plated/0.4N.m  
 Pin:Brass,Tin Plated  
 Cage:Brass,Ni Plated  
 Contact Resistance:20mΩ Max  
 Insulation Resistance:500MΩ/DC500V Min  
 Stripping Length:4.5~5mm  
 Temp. Range:-40°C ~ +105°C  
 MAX Soldering:250°C For 5S

Order Information  
 L-KLS2-102-5.00-XXP-X X

RoHS  
 Terminal Block  
 Pitch:5.00mm  
 No.:Of (02~24) Pin  
 Color:1=Gray 2=Blue 3=Black  
 4=Green 5=Orange 6=Red  
 7=Transp 8=Yellow 9=White  
 Screw:SC=Slot/Cross  
 S-Slot Screw C-Cross Screw

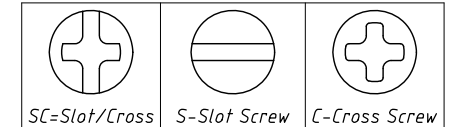

ANGLE TOLERANCE	PROJECTION	Description:			
±3°		Pitch 5.00mm Screw Fixation Terminal Block			
GENERAL TOLERANCE	UNITS	mm	KLS P/N:	L-KLS2-102-5.00-XXP-XX	
0~30	±0.50	SHEET SIZE	A4		
30~60	±0.75	Draw:	Song	2024-09-09	
60~90	±1.00	Check:	Daniel	2024-09-09	

NingBo KLS ELECTRONIC CO.,LTD.