

1
RoHS Compliance

6		7		8	
REV	SYM	Revision Record	Appr.	Date	
V0	KLS02006	New Version Release	WuHao	2024-11-11	

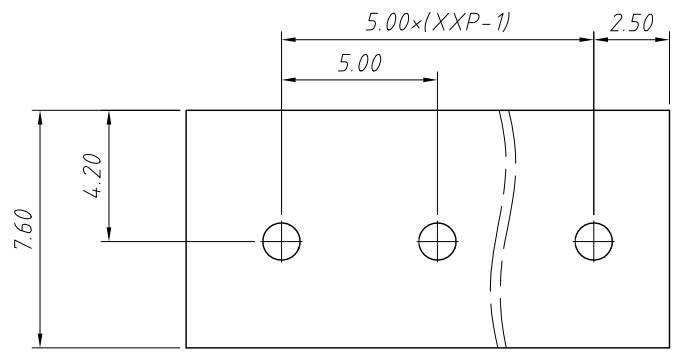

Recommended PCB Layout

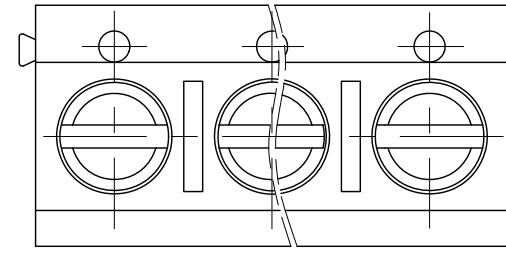

Electrical Characteristics	UL	IEC
Rated Voltage	250V	250V
Rated Current	16A	17.5A
Withstand Voltage	1500V/1 min	4.0 KV
Wire Range	22~14 AWG	0.5~1.5mm ²

Material
 Housing:PA66,UL 94V-0
 Pin Header:Copper Alloy,Sn plated
 Screw/Torque:M2.5/0.4N.m Max
 Operating Temperature:-40°C ~ +105°C
 Steip Length:5~6 mm

Order Information
 L-KLS2-301-5.00-XXP-X X

RoHS
 Terminal Block
 Pitch:5.00mm
 No.: of (02~24)Pole
 Color:
 1=Gray 2=Blue 3=Black
 4=Green 5=Orange 6=Red
 7=Transp 8=Yellow 9=White
 Screw:SC=Slot/Cross
 S-Slot Screw C-Cross Screw

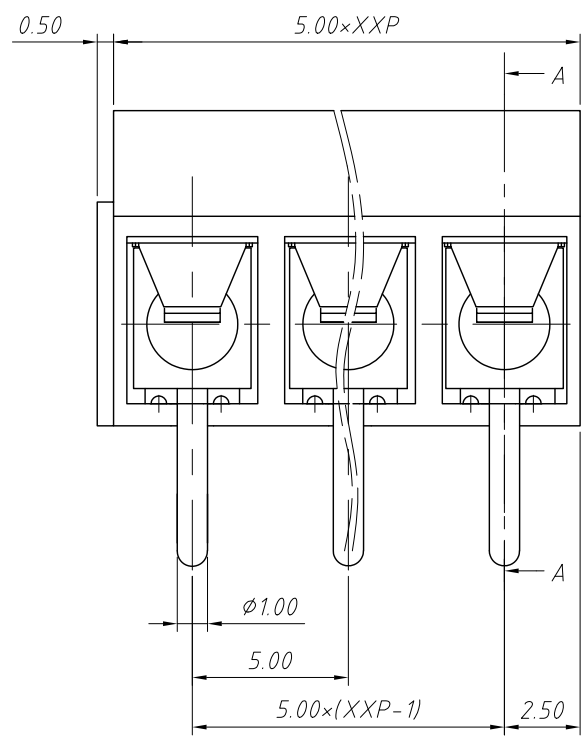
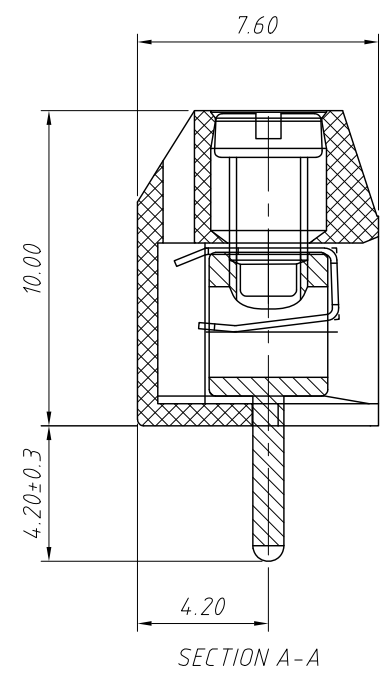
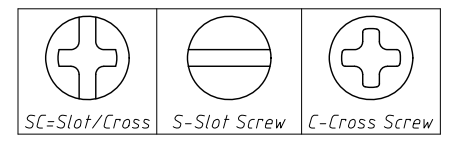

ANGLE TOLERANCE	PROJECTION	Description:	
±3°		Pitch 5.00mm Terminal Blocks	
GENERAL TOLERANCE	UNITS	mm	KLS P/N:
x.x ±0.30	SHEET SIZE	A4	L-KLS2-301-5.00-XXP-XX
x.xx ±0.20	Draw:	WuHao	2024-11-11
x.xxx ±0.10	Check:	Daniel	2024-11-11

