

Recommended PCB Layout

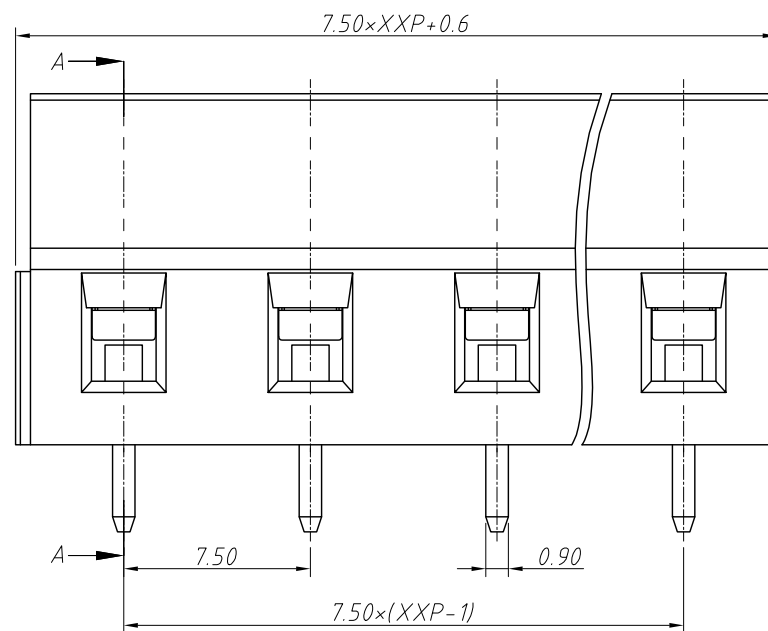
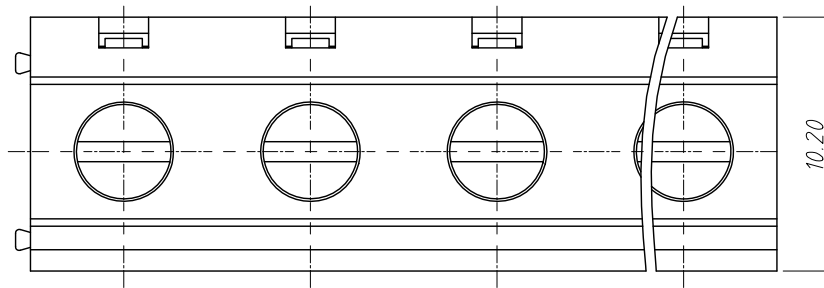
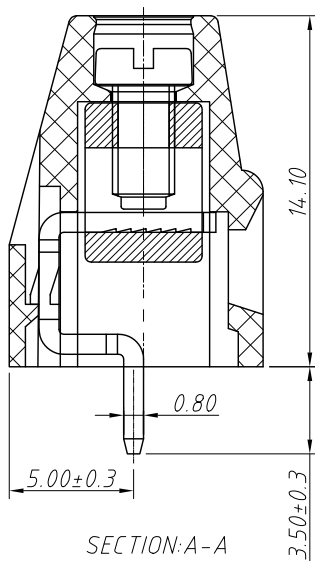

REV	SYM	Revision Record	Appr.	Date
V0	KLS02006	New Version Release	WuHao	2024-09-18

Electrical Characteristics	UL	IEC
Rated Voltage	300V	450V
Rated Current	16A	20A
Withstand Voltage	AC2000V/1min	---
Wire Range	12~22 AWG	2.5mm <sup>2</sup>

Order Information

L-KLS2-128-7.50-XXP-X X

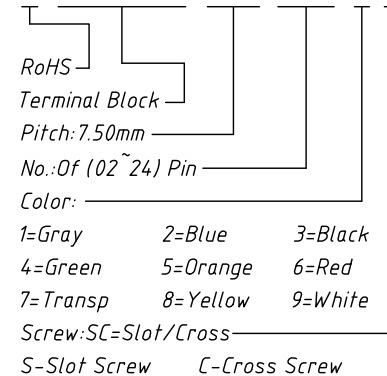

Material and other:

Housing:PA66, UL 94V-0

Pin header:Copper Alloy,Sn Plated Cage:Copper Alloy,Ni Plated

Screw/Torque:M2.5 Zn Plated /0.4N.m Max.

Contact resistance:20mΩ

Insulation resistance:500MΩ/DC500V

Steip Length:6-7mm

Temp.Range:-40°C ~ +105°C Max Soldering:+250°C,for 5 Sec

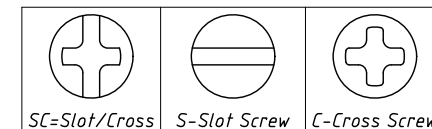

ANGLE TOLERANCE	PROJECTION	Description:
±3°		Pitch 7.50mm Screw fixation Terminal Block
GENERAL TOLERANCE	UNITS	mm
0~30 ±0.50	SHEET SIZE	A4
30~60 ±0.75	Draw:	WuHao 2024-09-18
60~90 ±1.00	Check:	Daniel 2024-09-18



NingBo KLS ELECTRONIC CO.,L TD.