

1 RoHS Compliance

6	7	8		
REV	SYM	Revision Record	Appr.	Date
V0	KLS01140	New Version Release	WuHao	2024-12-12

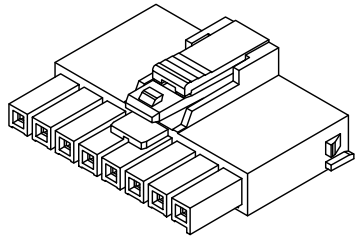

A-TPA Type A KEY,Black

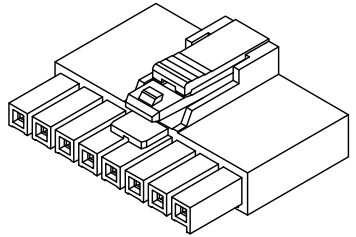
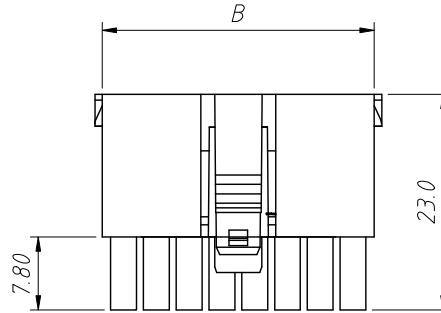

C-Standard A KEY,Black

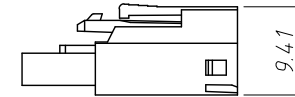
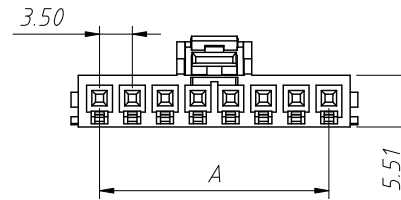
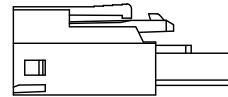

Material:  
Housing:PA66,UL 94 V-0

Electrical Characteristics:  
Voltage rating:400V AC,DC  
Current rating:14A AC,DC  
Withstanding voltage:1800V AC minute  
Insulation resistance:1000M $\Omega$  Min.  
Contact resistance:10m $\Omega$  Max.  
After environmental testing:30m $\Omega$  Max.  
Temperature range:-40 $^{\circ}$ C ~ +105 $^{\circ}$ C

Order Information:

L-KLS1-XL2-3.50-1 $\times$ XX-H-A

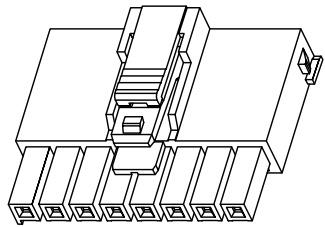
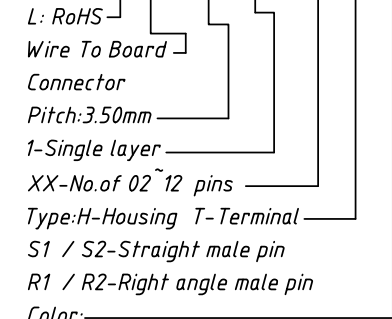

B-TPA Type B KEY,Natural

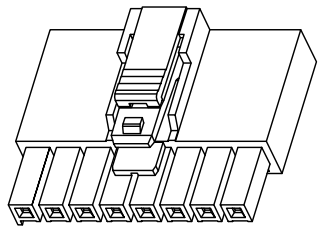

D-Standard B KEY,Natural

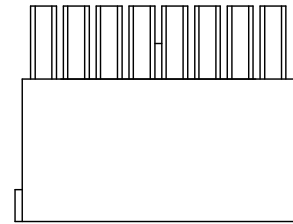

Pin	Dimensions(mm)	
	A	B
02	3.50	8.00
03	7.00	11.50
04	10.50	15.00
05	14.00	18.50
06	17.50	22.00
07	21.00	25.50
08	24.50	29.00
12	38.50	43.00

ANGLE TOLERANCE	PROJECTION	Description:	3.50mm Pitch Ultra-Fit 172256	
$\pm 3^{\circ}$			172258 Wire To Board Connector	
GENERAL TOLERANCE	UNITS	mm	KLS P/N: L-KLS1-XL2-3.50-1 $\times$ XX-H-A	
x.x $\pm 0.30$	SHEET SIZE	A4	NingBo KLS ELECTRONIC CO.,L TD.	
x.xx $\pm 0.20$	Draw:	WuHao		2024-12-12
x.xxx $\pm 0.10$	Check:	Daniel		2024-12-12

1 RoHS Compliance

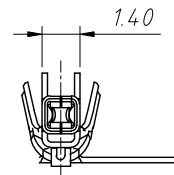
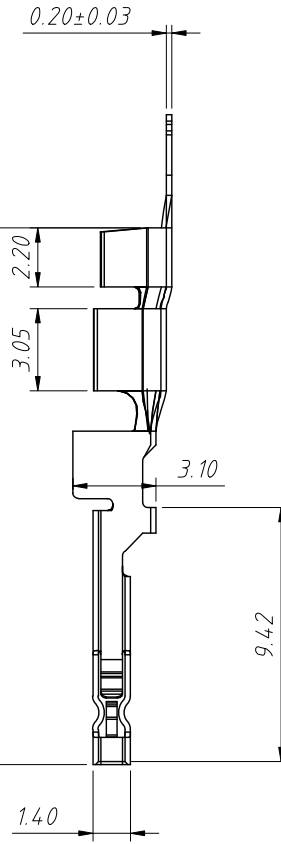
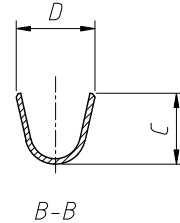
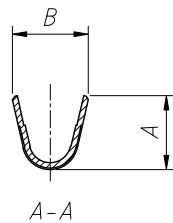
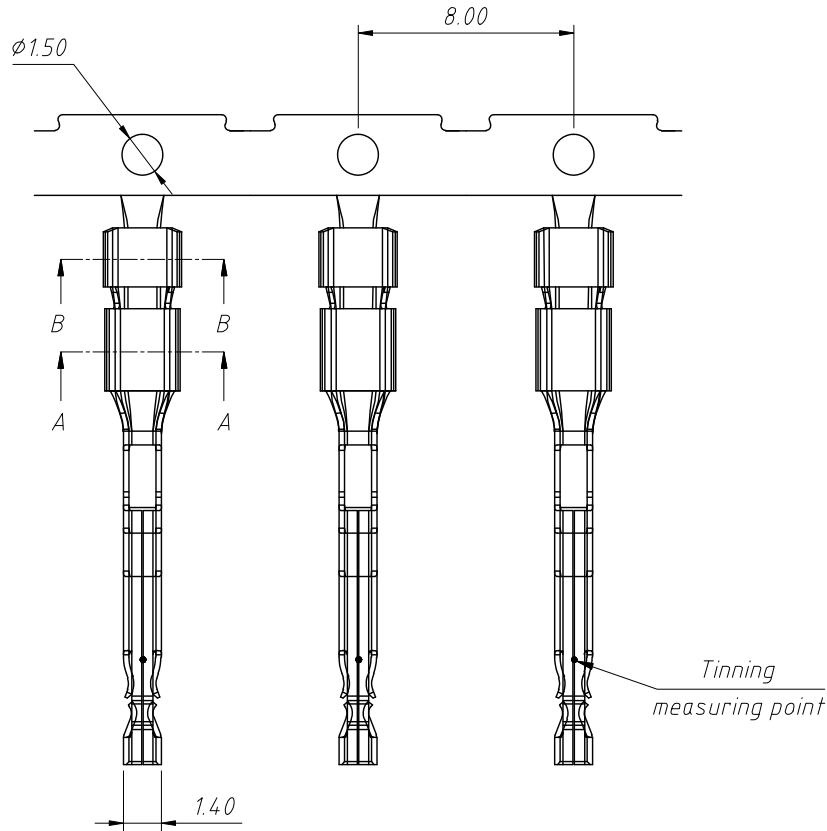

**Material:**  
 Terminal: High Conductivity Copper  
 Plating style: Contact Gold Flash or All Gold plating  
 Applicable Wire Range: AWG#16 ~ #22

**Electrical Characteristics:**  
 Voltage rating: 400V AC, DC  
 Current rating: 14A AC, DC  
 Withstanding voltage: 1800V AC minute  
 Insulation resistance: 1000MΩ Min.  
 Contact resistance: 10mΩ Max.  
 After environmental testing: 30mΩ Max.  
 Temperature range: -40°C ~ +105°C

**Order Information:**  
 L-KLS1-XL2-3.50-T-X-X

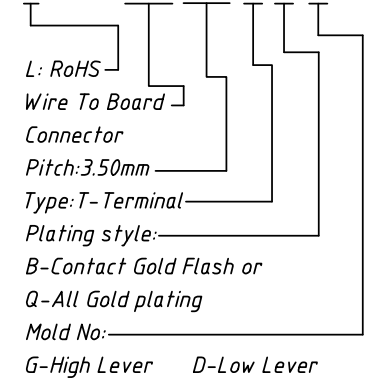

Ordering Information

Part No.	Wire range	A	B	C	D
3.50-T-X-D	#20-#22	2.20	2.20	2.10	2.33
3.50-T-X-G	#16-#18	2.80	2.80	2.63	2.90

ANGLE TOLERANCE	PROJECTION	Description:
±3°		3.50mm Pitch Ultra-Fit 172256 172258 Wire To Board Connector
GENERAL TOLERANCE	UNITS	mm
x.x ±0.30	SHEET SIZE	A4
x.xx ±0.20	Draw:	Daniel 2020-11-11
x.xxx ±0.10	Check:	Daniel 2020-11-11



NingBo KLS ELECTRONIC CO.,LTD.

1 RoHS Compliance

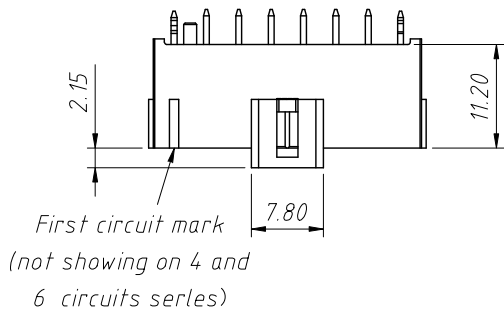

Pin	Dimensions(mm)	
	A	B
02	3.50	8.00
03	7.00	11.50
04	10.50	15.00
05	14.00	18.50
06	17.50	22.00
07	21.00	25.50
08	24.50	29.00
12	38.50	43.00

Material:

Housing:LCP,UL 94V-0

Contact:Copper Alloy With Tin;  
Au or Brass

Electrical Characteristics:

Voltage rating:400V AC,DC

Current rating:14A AC,DC

Withstanding voltage:1800V AC minute

Insulation resistance:1000M $\Omega$  Min.

Contact resistance:10m $\Omega$  Max.

After environmental testing:30m $\Omega$  Max.

Temperature range:-40 $^{\circ}$ C ~ +105 $^{\circ}$ C

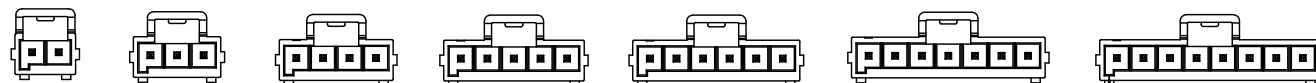
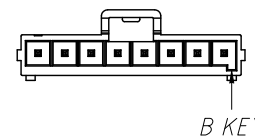
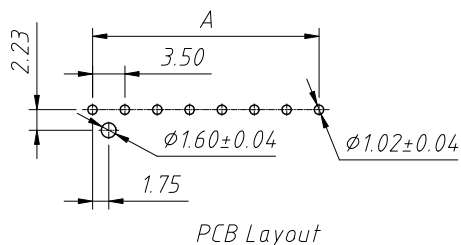
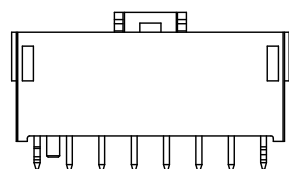
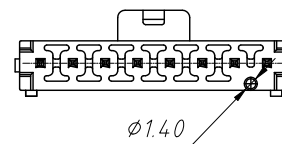
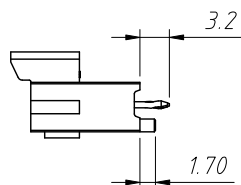
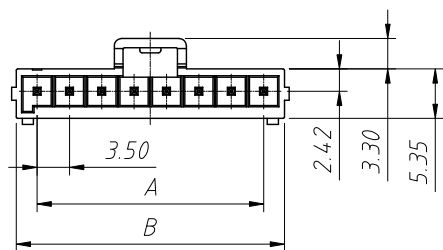

A KEY

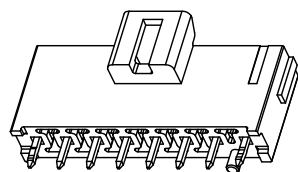

Order Information:

L-KLS1-XL2-3.50-1 $\times$ XX-S1-B

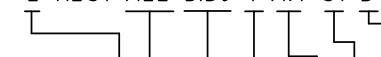

L: RoHS

Wire To Board

Connector

Pitch:3.50mm

1-Single layer

XX-No. of 02 ~ 12 pins

Type:H-Housing T-Terminal

S1 / S2-Straight male pin

R1 / R2-Right angle male pin

Color:

A-KEY A,Black

B-KEY B,Natural

ANGLE TOLERANCE	PROJECTION	Description:	3.50mm Pitch Ultra-Fit 172256
$\pm 3^{\circ}$			172258 Wire To Board Connector
GENERAL TOLERANCE	UNITS	mm	KLS P/N:
x.x $\pm 0.30$	SHEET SIZE	A4	L-KLS1-XL2-3.50-1 $\times$ XX-S1-B
x.xx $\pm 0.20$	Draw:	Daniel	2020-11-11
x.xxx $\pm 0.10$	Check:	Daniel	2020-11-11



NingBo KLS ELECTRONIC CO.,L TD.

1 RoHS Compliance

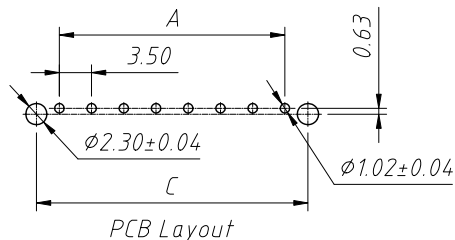
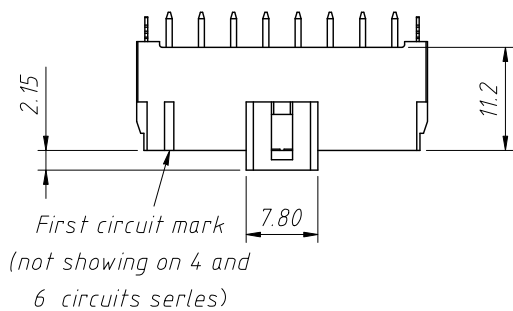

Material:  
Housing:LCP,UL94V-0  
Contact:Copper Alloy With Tin/Au

Electrical Characteristics:  
Voltage rating:400V AC,DC  
Current rating:14A AC,DC  
Withstanding voltage:1800V AC minute  
Insulation resistance:1000M $\Omega$  Min.  
Contact resistance:10m $\Omega$  Max.  
After environmental testing:30m $\Omega$  Max.  
Temperature range:-40°C ~ +105°C

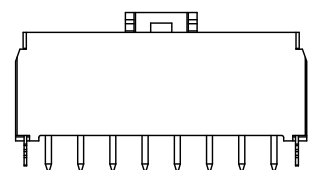
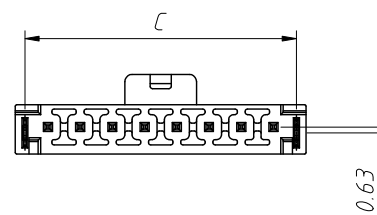
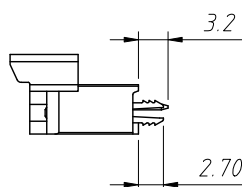
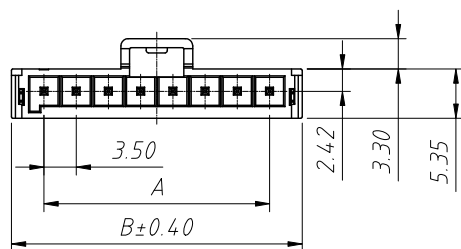

Pin	Dimensions(mm)		
	A	B	C
02	3.50	10.60	8.50
03	7.00	14.10	12.00
04	10.50	17.60	15.50
05	14.00	21.10	19.00
07	21.00	28.10	16.00
08	24.50	31.60	29.50
12	38.50	45.60	43.50

Order Information:  
L-KLS1-XL2-3.50-1×XX-S2-B

L: RoHS  
Wire To Board  
Connector  
Pitch:3.50mm  
1-Single layer  
XX-No.of 02 ~ 12 pins  
Type:H-Housing T-Terminal  
S1 / S2-Straight male pin  
R1 / R2-Right angle male pin  
Color:  
A-KEY A,Black B-KEY B,Natural

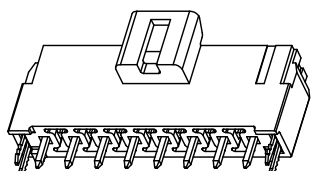
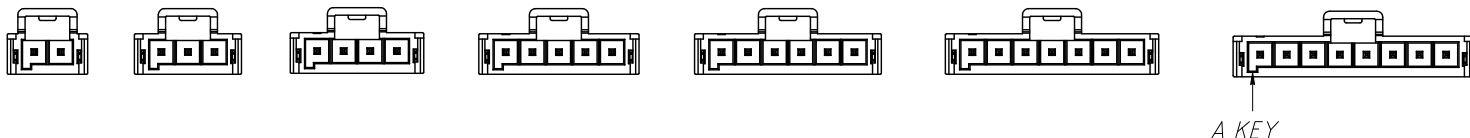

ANGLE TOLERANCE	PROJECTION	Description:
$\pm 3^\circ$		3.50mm Pitch Ultra-Fit 172256 172258 Wire To Board Connector
GENERAL TOLERANCE	UNITS	mm
x.x $\pm 0.30$	SHEET SIZE	A4
x.xx $\pm 0.20$	Draw:	Daniel 2020-11-11
x.xxx $\pm 0.10$	Check:	Daniel 2020-11-11

**KLS** NingBo KLS ELECTRONIC CO.,L TD.

1 RoHS Compliance

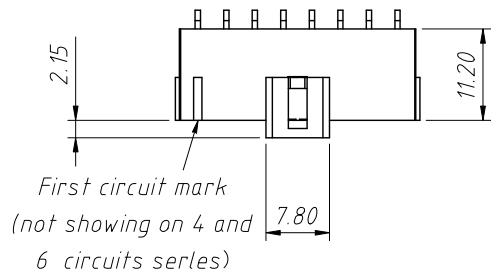

Pin	Dimensions(mm)		
	A	B	C
02	3.50	8.00	---
03	7.00	11.50	---
04	10.50	15.00	7.00
05	14.00	18.50	10.50
06	17.50	22.00	14.00
07	21.00	25.50	17.50
08	24.50	29.00	21.00
12	38.50	43.00	34.00

Material:

Housing:LCP,UL94V-0

Contact:Copper Alloy With Tin/Au

Electrical Characteristics:

Voltage rating:400V AC,DC

Current rating:14A AC,DC

Withstanding voltage:1800V AC minute

Insulation resistance:1000M $\Omega$  Min.

Contact resistance:10m $\Omega$  Max.

After environmental testing:30m $\Omega$  Max.

Temperature range:-40 $^{\circ}$ C ~ +105 $^{\circ}$ C

Order Information:

L-KLS1-XL2-3.50-1 $\times$ XX-R1-B

L: RoHS

Wire To Board

Connector

Pitch:3.50mm

1-Single layer

XX-No. of 02~12 pins

Type:H-Housing T-Terminal

S1 / S2-Straight male pin

R1 / R2-Right angle male pin

Color:

A-KEY A,Black

B-KEY B,Natural

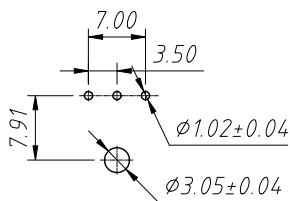
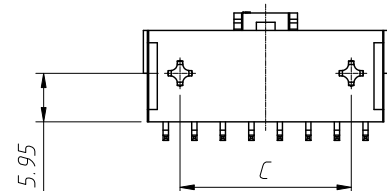
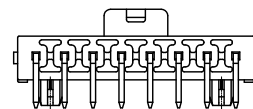
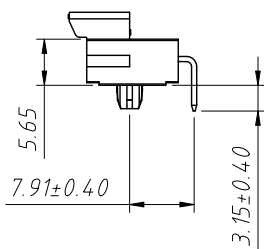
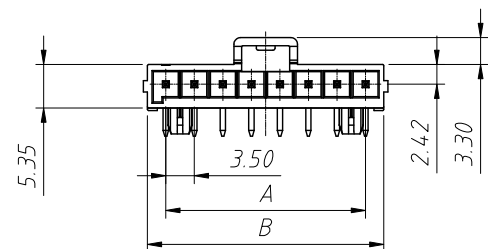

PCB Layout  
(2-3 Pin)

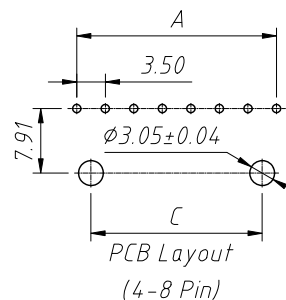

PCB Layout  
(4-8 Pin)

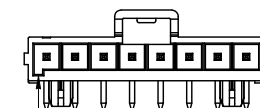
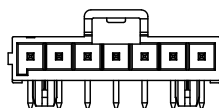
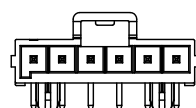
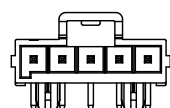
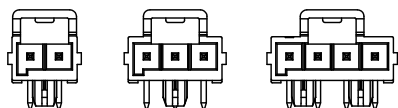

A KEY

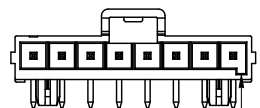
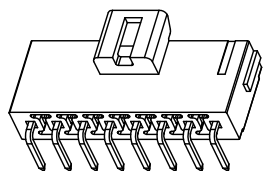

B KEY

ANGLE TOLERANCE	PROJECTION	Description:	3.50mm Pitch Ultra-Fit 172256
$\pm 3^{\circ}$			172258 Wire To Board Connector
GENERAL TOLERANCE	UNITS	mm	KLS P/N:
x.x $\pm 0.30$	SHEET SIZE	A4	L-KLS1-XL2-3.50-1 $\times$ XX-R1-B
x.xx $\pm 0.20$	Draw:	Daniel	2020-11-11
x.xxx $\pm 0.10$	Check:	Daniel	2020-11-11



NingBo KLS ELECTRONIC CO.,LTD.

1 RoHS Compliance

KEYING OPTION A

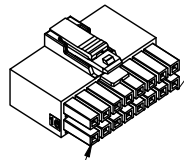

LAST CIRCUIT

C-Standard A KEY,Black

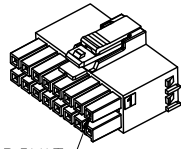

FIRST CIRCUIT

A-TPA Type A KEY,Black

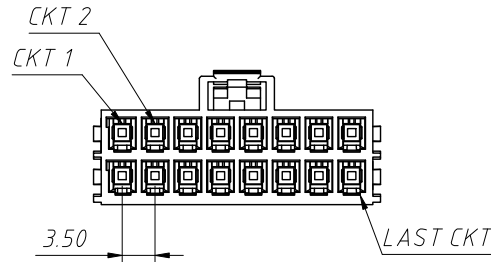

Material:  
Housing:PA66,UL 94V-0

Electrical Characteristics:  
Voltage rating:400V AC,DC  
Current rating:14A AC,DC  
Withstanding voltage:1800V AC minute  
Insulation resistance:1000M $\Omega$  Min.  
Contact resistance:10m $\Omega$  Max.  
After environmental testing:30m $\Omega$  Max.  
Temperature range:-40 $^{\circ}$ C ~ +105 $^{\circ}$ C

KEYING OPTION B

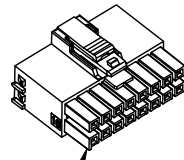

LAST CIRCUIT

B-TPA Type B KEY,Natural

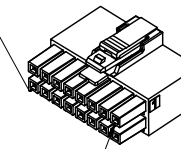

FIRST CIRCUIT

D-Standard B KEY,Natural

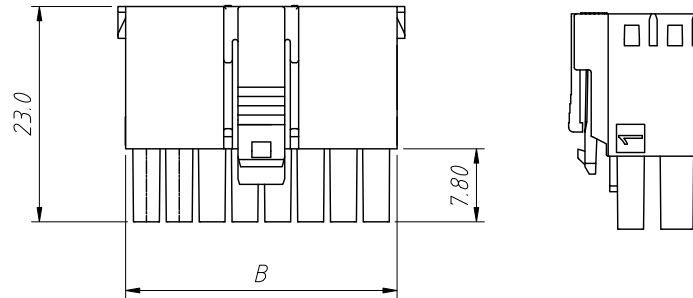

Order Information:  
L-KLS1-XL2-3.50-2 $\times$ XX-H-B

L: RoHS  
Wire To Board  
Connector  
Pitch:3.50mm  
2-Doubles layer  
XX-No. of 04 ~ 24 pins  
Type:H-Housing T-Terminal  
S1 / S2-Straight male pin  
R1 / R2-Right angle male pin  
Color:  
A-TPA Type A KEY,Black  
B-TPA Type B KEY,Natural  
C-Standard A KEY,Black  
D-Standard B KEY,Natural

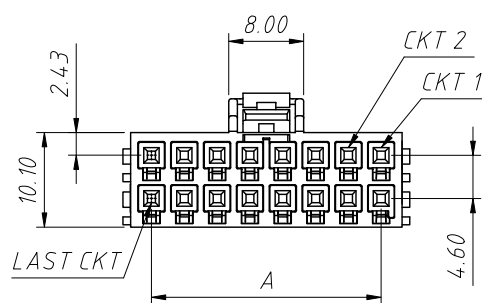
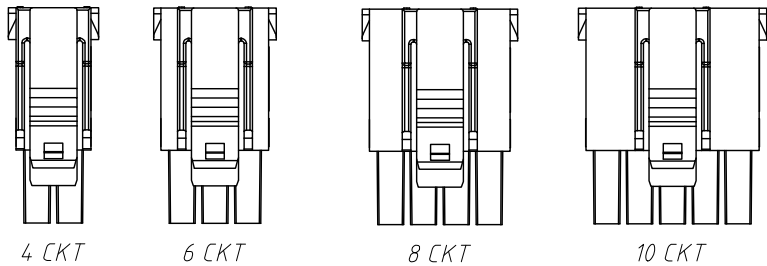

Pin	Dimensions(mm)	
	A	B
2 $\times$ 02	3.50	8.00
2 $\times$ 03	7.00	11.50
2 $\times$ 04	10.50	15.00
2 $\times$ 05	14.00	18.50
2 $\times$ 06	17.50	22.00
2 $\times$ 07	21.00	25.50
2 $\times$ 08	24.50	29.00
2 $\times$ 12	38.50	43.00

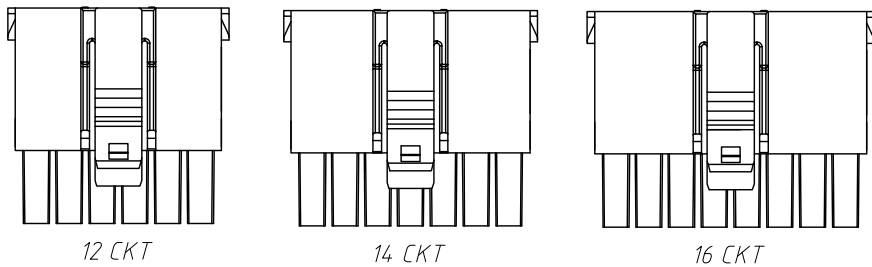

ANGLE TOLERANCE	PROJECTION	Description:	3.50mm Pitch Ultra-Fit 172256
$\pm 3^{\circ}$			172258 Wire To Board Connector
GENERAL TOLERANCE	UNITS	mm	KLS P/N: L-KLS1-XL2-3.50-2 $\times$ XX-H-B
x.x $\pm 0.30$	SHEET SIZE	A4	NingBo KLS ELECTRONIC CO.,L TD.
x.xx $\pm 0.20$	Draw:	Daniel	
x.xxx $\pm 0.10$	Check:	Daniel	

1  
RoHS Compliance

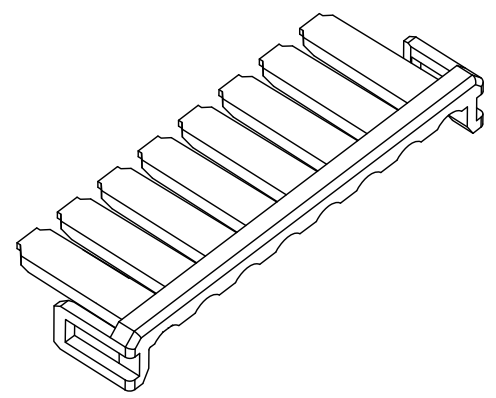
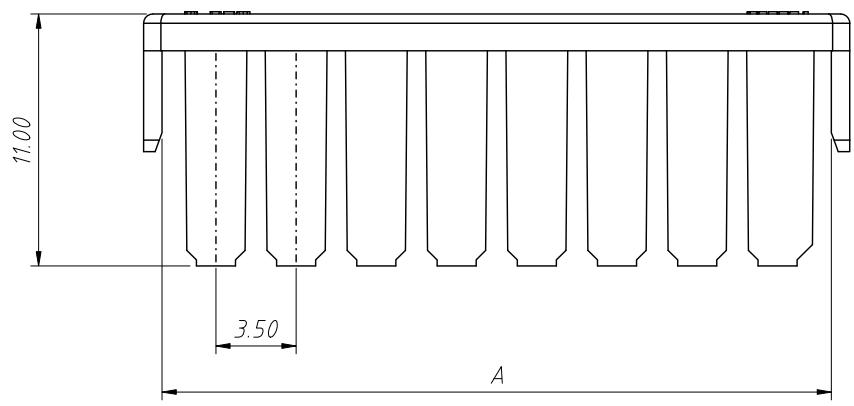

Material:  
Housing:PA66,UL 94 V-0

Electrical Characteristics:  
Voltage rating:400V AC,DC  
Current rating:14A AC,DC  
Withstanding voltage:1800V AC minute  
Insulation resistance:1000M $\Omega$  Min.  
Contact resistance:10m $\Omega$  Max.  
After environmental testing:30m $\Omega$  Max.  
Temperature range:-40 $^{\circ}$ C ~ +105 $^{\circ}$ C

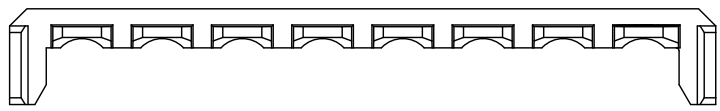

Order Information:

L-KLS1-XL2-3.50-S-XX-B

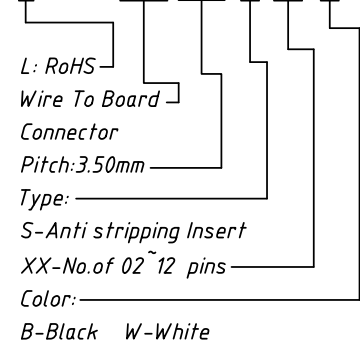

Pin	Dimensions(mm)
	A
02	8.20
03	11.70
04	15.20
05	18.70
06	22.20
07	25.70
08	29.20
12	43.20

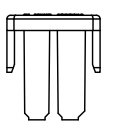

02 P

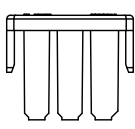

03 P

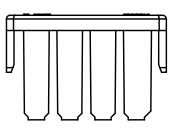

04 P

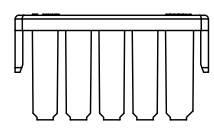

05 P

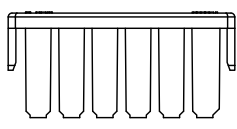

06 P

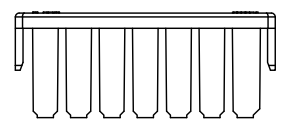

07 P

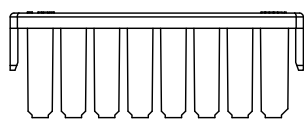

08 P

ANGLE TOLERANCE	PROJECTION	Description:	3.50mm Pitch Ultra-Fit 172256
$\pm 3^{\circ}$			172258 Wire To Board Connector
GENERAL TOLERANCE	UNITS	mm	KLS P/N: L-KLS1-XL2-3.50-S-XX-B
x.x $\pm 0.30$	SHEET SIZE	A4	NingBo KLS ELECTRONIC CO.,L TD.
x.xx $\pm 0.20$	Draw:	Daniel 2020-11-11	
x.xxx $\pm 0.10$	Check:	Daniel 2020-11-11	

1 RoHS Compliance

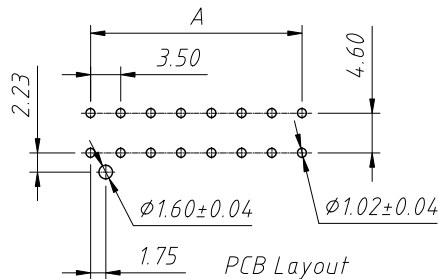
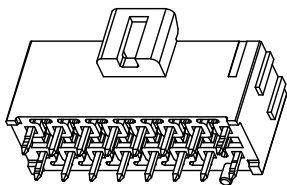
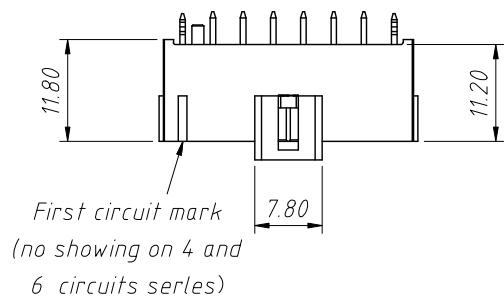

Material:  
Housing:LCP,UL94V-0  
Contact:Copper Alloy With Tin;  
Au or Brass

Electrical Characteristics:  
Voltage rating:400V AC,DC  
Current rating:14A AC,DC  
Withstanding voltage:1800V AC minute  
Insulation resistance:1000M $\Omega$  Min.  
Contact resistance:10m $\Omega$  Max.  
After environmental testing:30m $\Omega$  Max.  
Temperature range:-40 $^{\circ}$ C ~ +105 $^{\circ}$ C

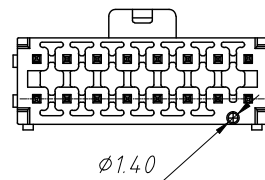
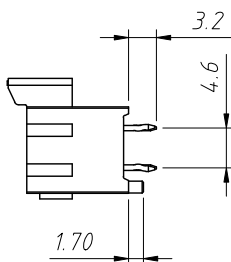
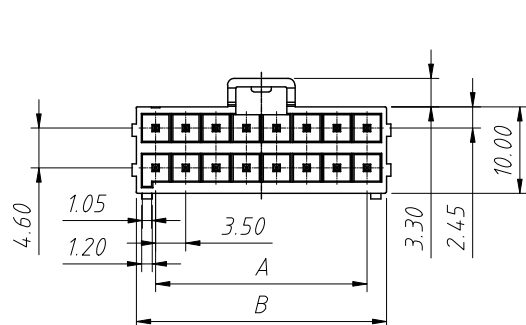

Order Information:

L-KLS1-XL2-3.50-2 $\times$ XX-S1-B

L: RoHS  
Wire To Board  
Connector  
Pitch:3.50mm  
2-Double layer  
XX-No.of 04 ~ 24 pins  
Type:H-Housing T-Terminal  
S1 / S2-Straight male pin  
R1 / R2-Right angle male pin  
Color:  
A-KEY A,Black B-KEY B,Natural

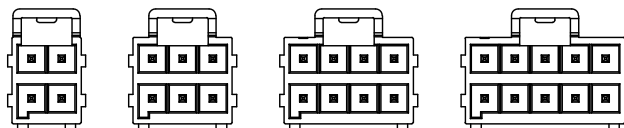
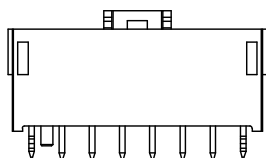

Pin	Dimensions(mm)	
	A	B
2 $\times$ 02	3.50	8.00
2 $\times$ 03	7.00	11.50
2 $\times$ 04	10.50	15.00
2 $\times$ 05	14.00	18.50
2 $\times$ 06	17.50	22.00
2 $\times$ 07	21.00	25.50
2 $\times$ 08	24.50	29.00
2 $\times$ 12	38.50	43.00

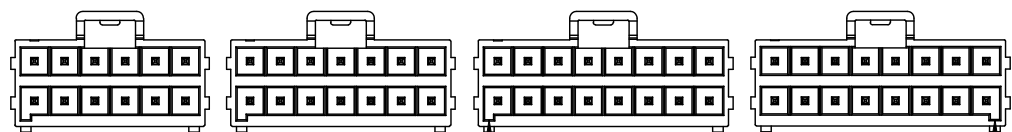

A KEY

B KEY

ANGLE TOLERANCE	PROJECTION	Description:	3.50mm Pitch Ultra-Fit 172256 172258 Wire To Board Connector
$\pm 3^{\circ}$			
GENERAL TOLERANCE	UNITS	mm	KLS P/N:
x.x $\pm 0.30$	SHEET SIZE	A4	L-KLS1-XL2-3.50-2 $\times$ XX-S1-B
x.xx $\pm 0.20$	Draw:	Daniel	2020-11-11
x.xxx $\pm 0.10$	Check:	Daniel	2020-11-11



NingBo KLS ELECTRONIC CO.,L TD.



1 RoHS Compliance

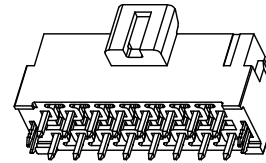
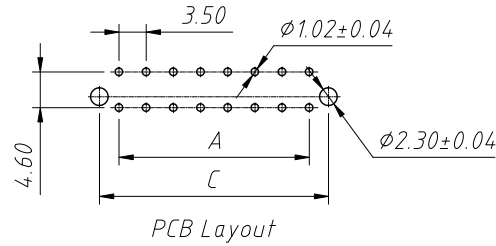
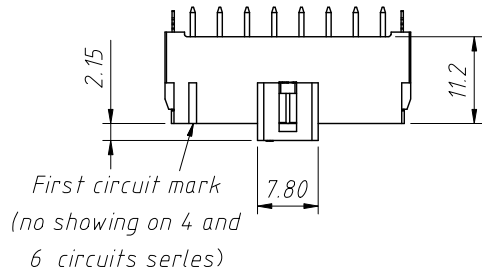

Material:  
Housing:LCP,UL 94V-0  
Contact:Copper Alloy With Tin/Au

Electrical Characteristics:  
Voltage rating:400V AC,DC  
Current rating:14A AC,DC  
Withstanding voltage:1800V AC minute  
Insulation resistance:1000M $\Omega$  Min.  
Contact resistance:10m $\Omega$  Max.  
After environmental testing:30m $\Omega$  Max.  
Temperature range:-40°C ~ +105°C

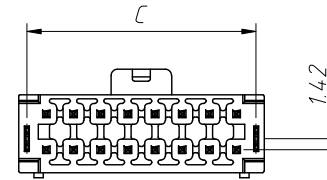
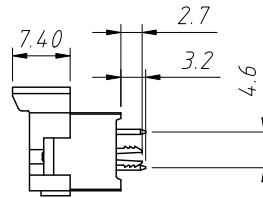
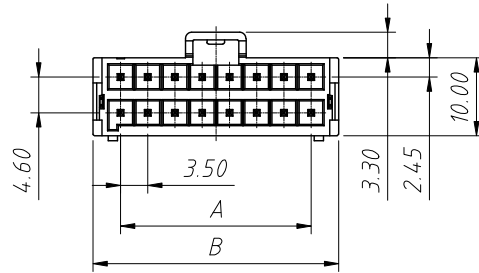

Order Information:

L-KLS1-XL2-3.50-2×XX-S2-B

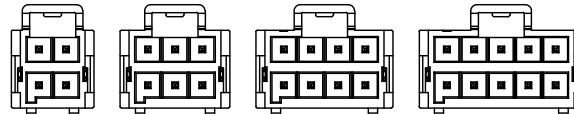
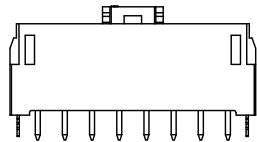
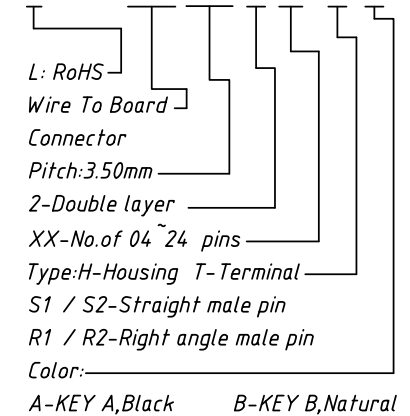

Pin	Dimensions(mm)		
	A	B	C
2×02	3.50	10.60	8.50
2×03	7.00	14.10	12.00
2×04	10.50	17.60	15.50
2×05	14.00	21.10	19.00
2×06	17.50	24.60	22.50
2×07	21.00	28.10	16.00
2×08	24.50	31.60	29.50
2×12	38.50	45.60	43.50

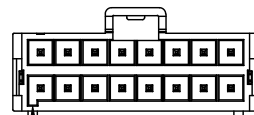
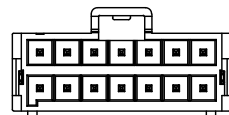
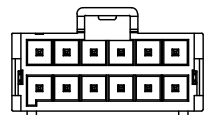
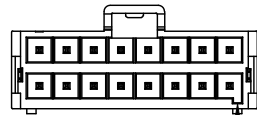

ANGLE TOLERANCE	PROJECTION	Description:
$\pm 3^\circ$		3.50mm Pitch Ultra-Fit 172256 172258 Wire To Board Connector
GENERAL TOLERANCE	UNITS	mm
x.x $\pm 0.30$	SHEET SIZE	A4
x.xx $\pm 0.20$	Draw:	Daniel 2020-11-11
x.xxx $\pm 0.10$	Check:	Daniel 2020-11-11



NingBo KLS ELECTRONIC CO.,L TD.

1 RoHS Compliance

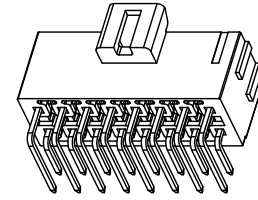
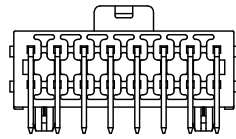
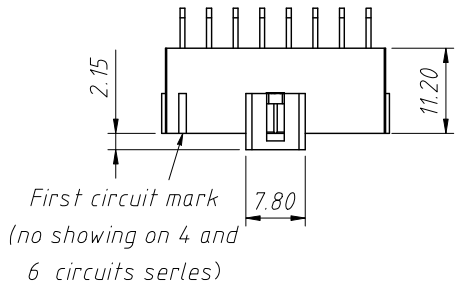

Material:  
Housing:LCP,UL94V-0  
Contact:Copper Alloy With Tin/Au

Electrical Characteristics:  
Voltage rating:400V AC,DC  
Current rating:14A AC,DC  
Withstanding voltage:1800V AC minute  
Insulationresistance:1000M $\Omega$  Min.  
Contact resistance:10m $\Omega$  Max.  
After environmental testing:30m $\Omega$  Max.  
Temperature range:-40 $^{\circ}$ C ~ +105 $^{\circ}$ C

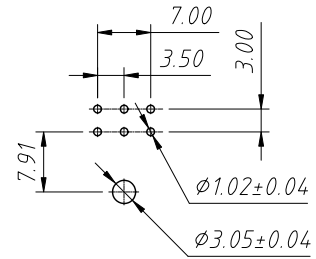
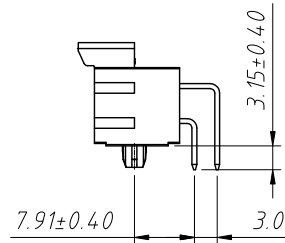
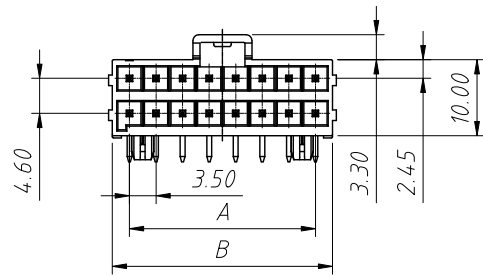

PCB Layout (4-6 Pin)

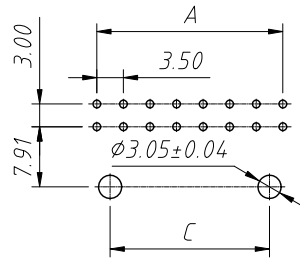
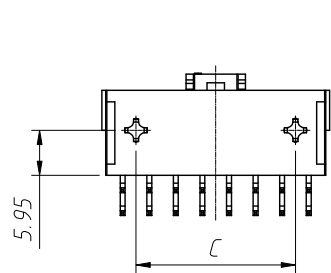

PCB Layout (8-16 Pin)

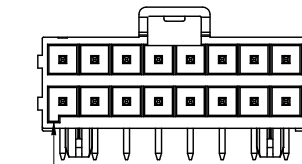
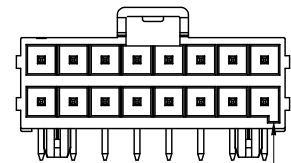

Order Information:  
L-KLS1-XL2-3.50-2×XX-R1-B

L: RoHS  
Wire To Board  
Connector  
Pitch:3.50mm  
2-Double layer  
XX-No.of 04~24 pins  
Type:H-Housing T-Terminal  
S1 / S2-Straight male pin  
R1 / R2-Right angle male pin  
Color:  
A-KEY A,Black B-KEY B,Natural

Pin	Dimensions(mm)		
	A	B	C
2×02	3.50	8.00	---
2×03	7.00	11.50	---
2×04	10.50	15.00	7.00
2×05	14.00	18.50	10.50
2×06	17.50	22.00	14.00
2×07	21.00	25.50	17.50
2×08	24.50	29.00	21.00
2×12	38.50	43.00	34.00

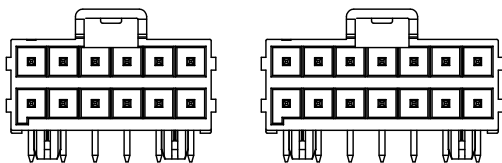
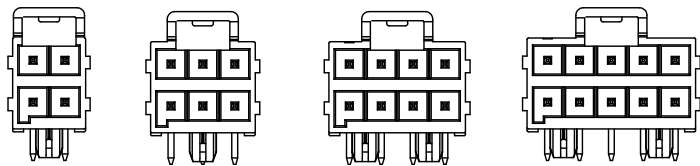

ANGLE TOLERANCE	PROJECTION	Description:	3.50mm Pitch Ultra-Fit 172256 172258 Wire To Board Connector
$\pm 3^{\circ}$			
GENERAL TOLERANCE	UNITS	mm	KLS P/N: L-KLS1-XL2-3.50-2×XX-R1-B
x.x $\pm 0.30$	SHEET SIZE	A4	NingBo KLS ELECTRONIC CO.,L TD.
x.xx $\pm 0.20$	Draw:	Daniel 2020-11-11	
x.xxx $\pm 0.10$	Check:	Daniel 2020-11-11	