

RoHS Compliance

REV	SYM	Revision Record	Appr.	Date
V0	KLS02006	New Version Release	Song	2024-08-28

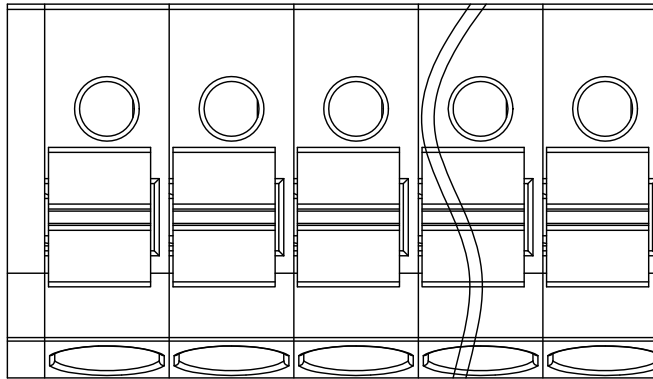
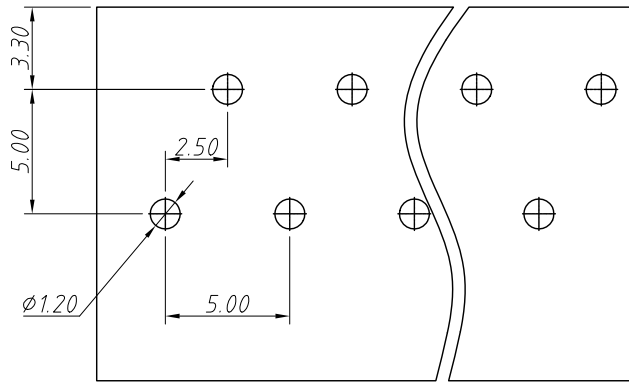

Electrical Characteristics	UL	IEC
Rated Voltage	300V	250V
Rated Current	12A	16A
Withstand Voltage	AC2000V/1 min	---
Wire Range	20~12AWG	2.5mm <sup>2</sup>

Material and other:

Housing:PA66,UL 94V-0

Pin Header:Coppo Alloy,Sn Plated

Wire Guard:Stainless Steel

Contact Resistance:20mΩ Max

Insulation Resistance:500MΩ/DC500V Min

Stripping Length:10~11mm

Temp. Range:-40°C ~ +105°C

Order Information

L-KLS2-237-5.00-XXP-X

RoHS  
Terminal Block  
Pitch:5.00mm  
No.:Of (01 XX) Pins  
Color:1=Gray 2=Blue 3=Black  
4=Green 5=Orange 6=Red  
7=Transp 8=Yellow 9=White

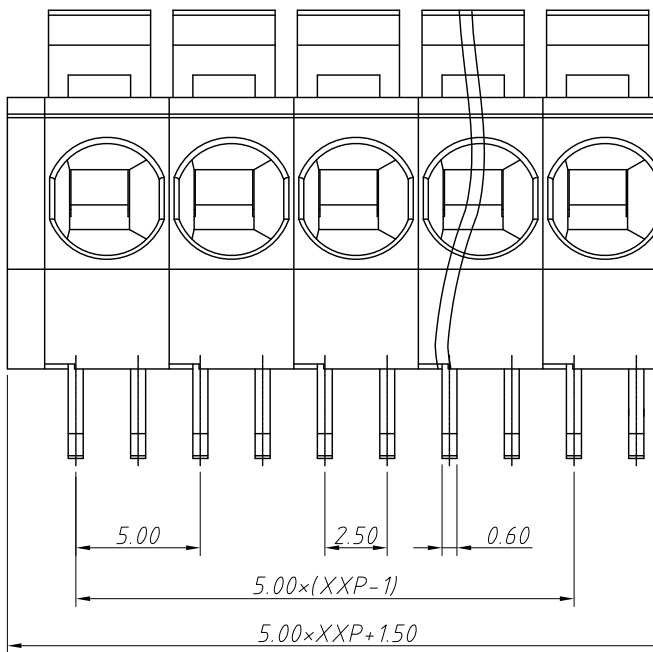
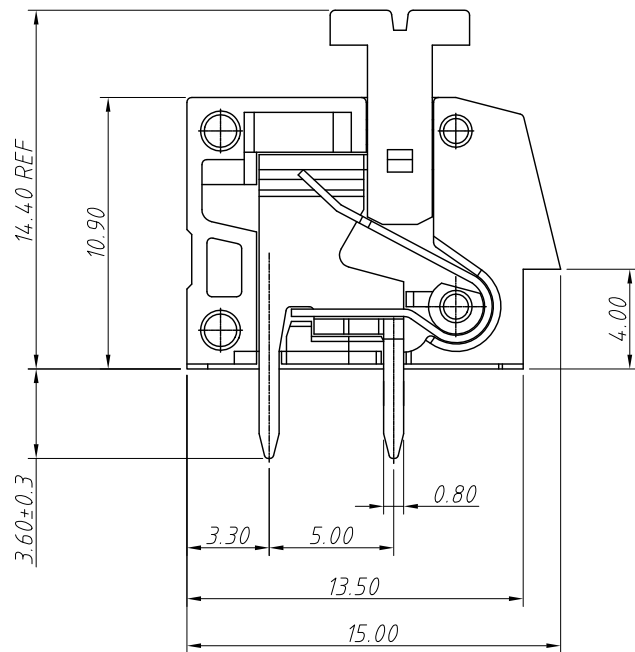

ANGLE TOLERANCE	PROJECTION	Description:		
±3°		5.00mm Spring Terminal Blocks		
GENERAL TOLERANCE	UNITS	mm	KLS P/N:	L-KLS2-237-5.00-XXP-X
0~30	±0.50	SHEET SIZE	A4	NingBo KLS ELECTRONIC CO.,L TD.
30~60	±0.75	Draw:	Song 2024-08-28	
60~90	±1.00	Check:	Daniel 2024-08-28	