

1 RoHS Compliance

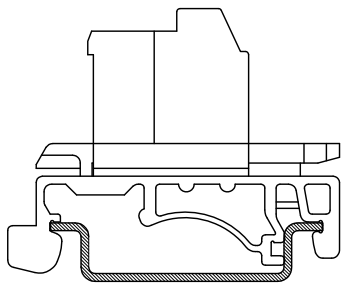
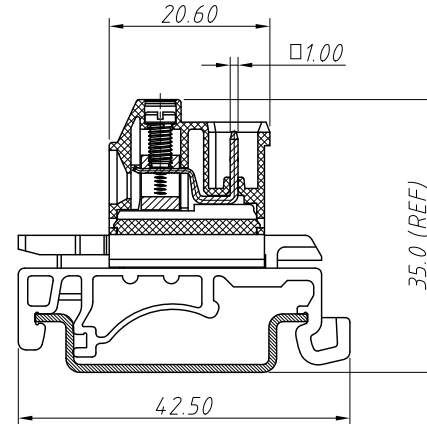
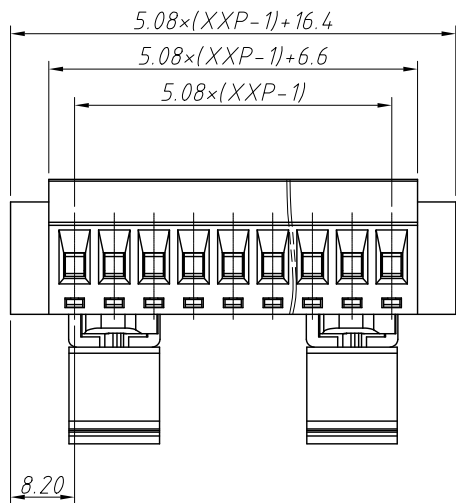
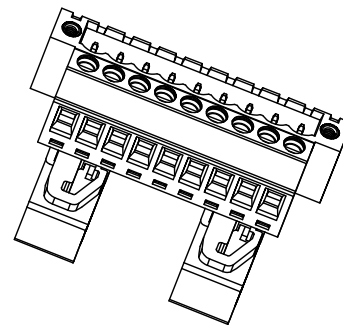
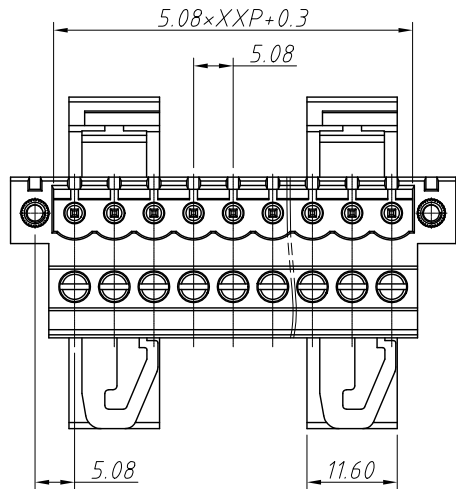

REV	SYM	Revision Record	Appr.	Date
V0	KLS02006	New Version Release	WuHao	2024-11-07

Electrical Characteristics	UL	IEC
Rated Voltage	300V	450V
Rated Current	15A	20A
Withstand Voltage	AC2000V/1 min	---
Wire Range	28~14 AWG	2.5mm <sup>2</sup>

Material and other:  
 Housing: PA66, UL94V-0  
 Pin Header/Cage: Brass, Ni Plated  
 Screw/Torque: Steel, M3, Zn Plated/0.5N.m  
 Nut: Brass  
 Contact resistance: 20mΩ MAX  
 Insulation resistance: 500MΩ/DC500V  
 Stripping Length: 7~8mm  
 Temp. Range: -40°C ~ +105°C

Order Information

L-KLS2-UVKM-5.08-XXP-X X

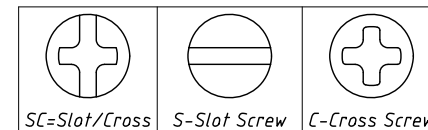
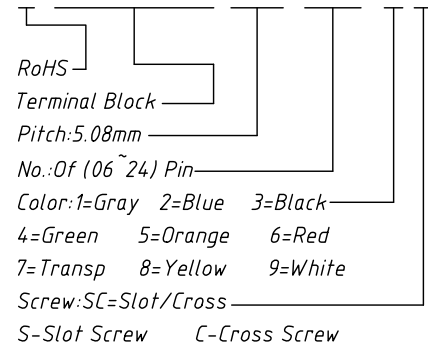

ANGLE TOLERANCE	PROJECTION	Description:
±3°		Pitch 5.08mm Terminal Block
GENERAL TOLERANCE	UNITS	mm
0~30 ±0.50	SHEET SIZE	A4
30~60 ±0.75	Draw:	WuHao 2024-11-07
60~90 ±1.00	Check:	Daniel 2024-11-07
		NingBo KLS ELECTRONIC CO.,L TD.