

1 RoHS Compliance

REV	SYM	Revision Record	Appr.	Date
V0	KLS02006	New Version Release	Song	2024-08-19

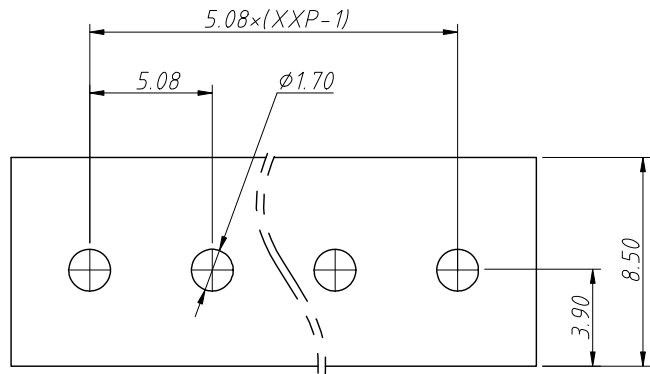

Recommended PCB Layout

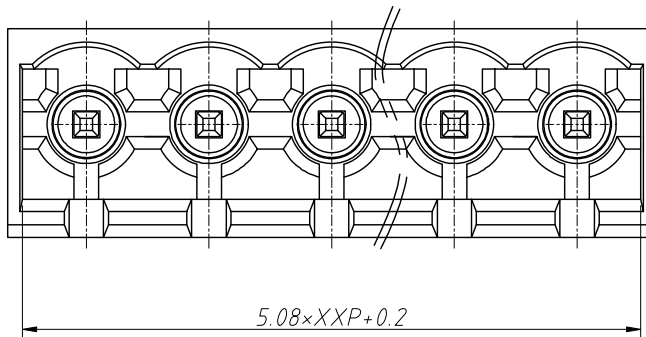

Electrical Characteristics	UL	IEC
Rated Voltage	300V	250V
Rated Current	15A	12A
Withstand Voltage	1600V / 1min	4.0KV

Material and other:
 Housing: LCP, UL94V-0
 Pin: Copper Alloy, Sn Plated
 Operating Temperature: -40°C ~ +130°C
 Soldering Temperature: 285°C / 10S

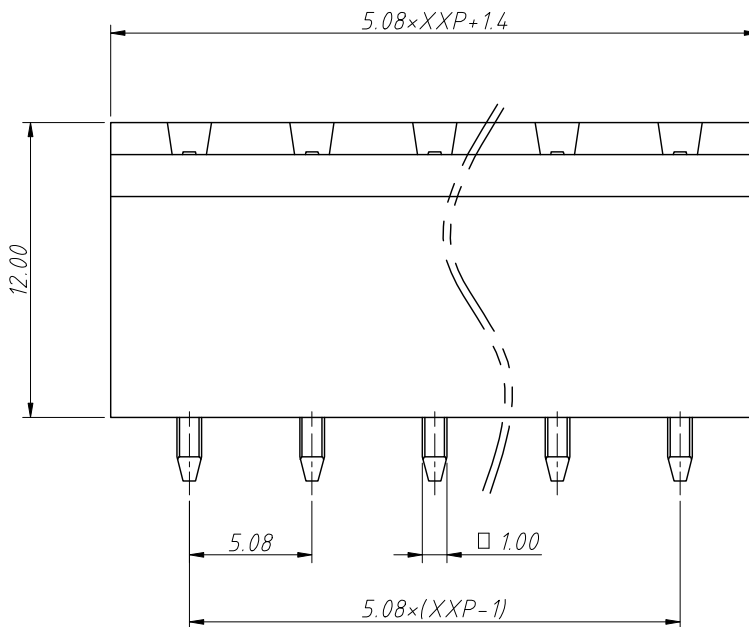
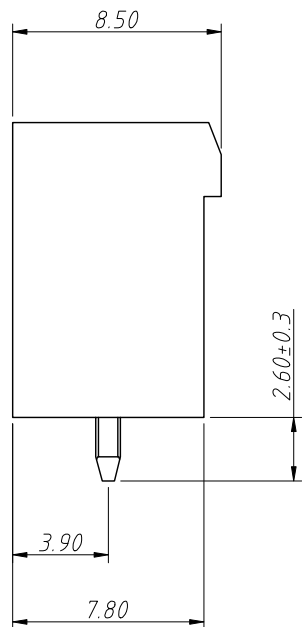

Order Information

L-KLS2-THREDVC-5.08-XXP-X

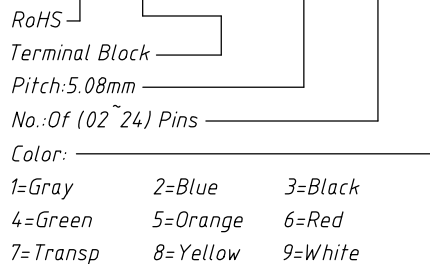

ANGLE TOLERANCE	PROJECTION	Description:
±3°		Pitch 5.08mm Pluggable Terminal Block ,Socket
GENERAL TOLERANCE	UNITS	mm
0~30 ±0.50	SHEET SIZE	A4
30~60 ±0.75	Draw:	Song
60~90 ±1.00	Check:	Daniel
KLS P/N:		L-KLS2-THREDVC-5.08-XXP-X
KLS ELECTRONIC		NingBo KLS ELECTRONIC CO.,L TD.