

SECTION A-A

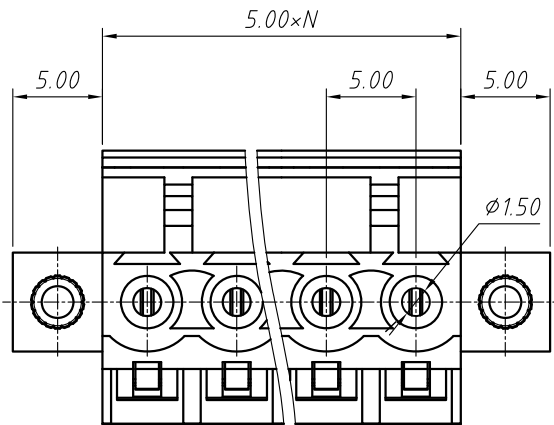

Material
Housing: PA66, UL94V-0
Cage: Brass, Ni plated
Screws: M3.0, Steel, Zn plated
Clamp: Phosphor bronze, Ni plated

Electrical
Rated voltage: 300V
Rated current: 15A
Contact Resistance: 20 mΩ
Insulation resistance: 500MΩ/DC500V
Withstand voltage: AC2000V / 1 min
Wire Range: 28 ~ 14AWG 2.5mm²

Mechanical
Temp. Range: -40 °C ~ +105 °C
Strip length: 7 ~ 8mm
Torque: 0.4m(3.6Lbin)

Order Information

L-KLS2-ELKM-5.00-XXP-4S00

RoHS
 Terminal Block
 Pitch
 No.: of Pole
 Color: 4- Green
 Screw: S-Slot Screw C-Cross Screw
 Product Code: 00 ~ 99

GENERAL TOLERANCE		ANGLE TOLERANCE		Description:	
X. ±0.60		X. ±5°		Pluggable Terminal Block 5.00 MM	
.X ±0.38		.X ±3°		KLS P/N:	KLS2-ELKM-5.00-XXP-4S-00
.XX ±0.25		.XX ±2°			
Draw by	2015-09-01	PROJECTION		NingBo KLS ELECTRONIC CO.,L TD.	
Check by	2015-09-15	UNITS	mm		
SCALE		SHEET SIZE	A4		

1
RoHS Compliance

6		7		8	
REV	SYM	Revision Record		Appr.	Date
V0	KLS02006	New Version Release		WuHao	2024-11-07

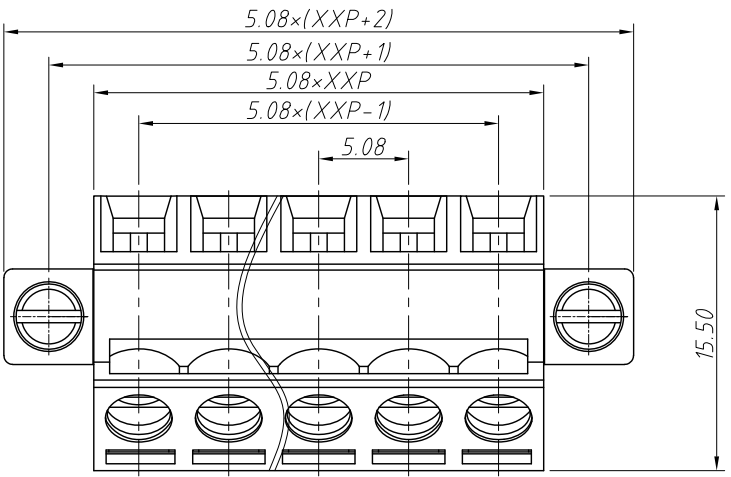

Electrical Characteristics	UL	IEC
Rated Voltage	300V	320V
Rated Current	15A	13.5A
Withstand Voltage	AC2000V/1 min	---
Wire Range	28~14 AWG	2.5mm ²

Material and other:
 Housing:PA66, UL94V-0
 Clamp/Wire Guard:Coppo Alloy,Ni Plated
 Screw/Torque:Steel,M3,Zn Plated/0.51N.m
 Stripping Length:7~8mm
 Temp.Range:-40°C~+105°C

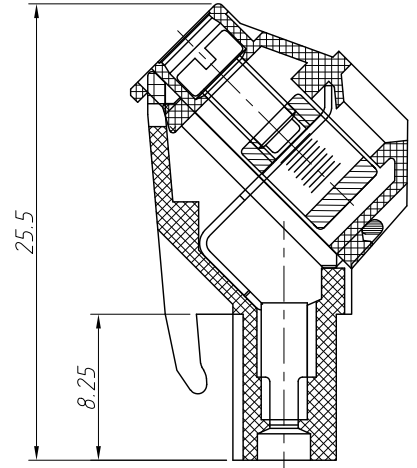
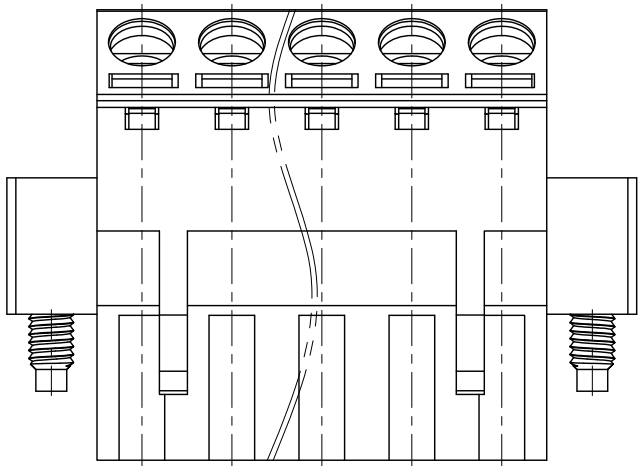

Order Information
 L-KLS2-ELKM-5.08-XXP-XX

RoHS
 Terminal Block
 Pitch:5.08mm
 No.:Of (02~24) Pin
 Color:1=Gray 2=Blue 3=Black
 4=Green 5=Orange 6=Red
 7=Transp 8=Yellow 9=White
 Screw:SC=Slot/Cross
 S-Slot Screw C-Cross Screw

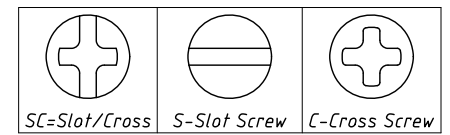

ANGLE TOLERANCE	PROJECTION	Description:			
±3°		Pitch 5.08mm Terminal Block			
GENERAL TOLERANCE	UNITS	mm	KLS P/N:	L-KLS2-ELKM-5.08-XXP-XX	
0~30 ±0.50	SHEET SIZE	A4			
30~60 ±0.75	Draw:	WuHao	2024-11-07	NingBo KLS ELECTRONIC CO.,L TD.	
60~90 ±1.00	Check:	Daniel	2024-11-07		