

1 RoHS Compliance

REV	SYM	Revision Record	Appr.	Date
V0	KLS02006	New Version Release	WuHao	2024-10-28

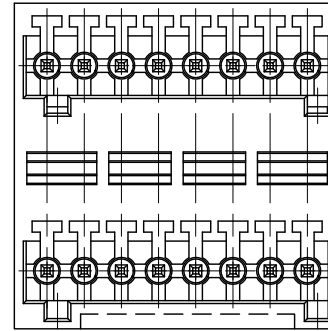
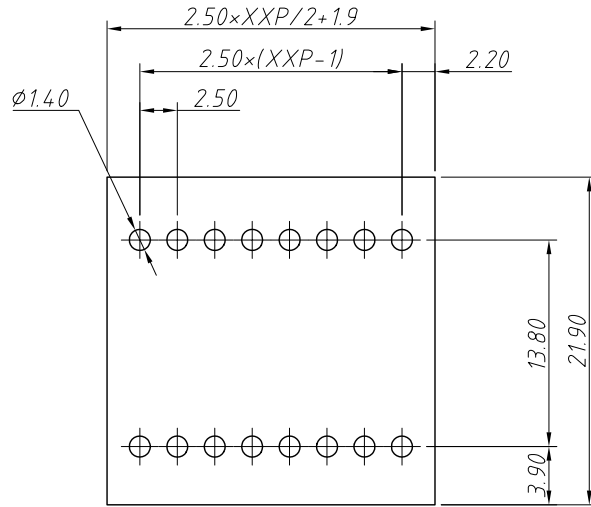

Electrical Characteristics	UL	IEC
Rated Voltage	150V	250V
Rated Current	5A	5A
Withstand Voltage	AC2000V/1 min	---

Material and other:
 Housing:PA66, UL94V-0
 Pin Header:Copper Alloy,Sn Plated
 Contact Resistance:20mΩ Max
 Insulation Resistance:500MΩ/DC500V Min
 Temp. Range:-40°C ~ +105°C
 Soldering:+250°C For 5 Sec Max

Recommended PCB Layout

2P View

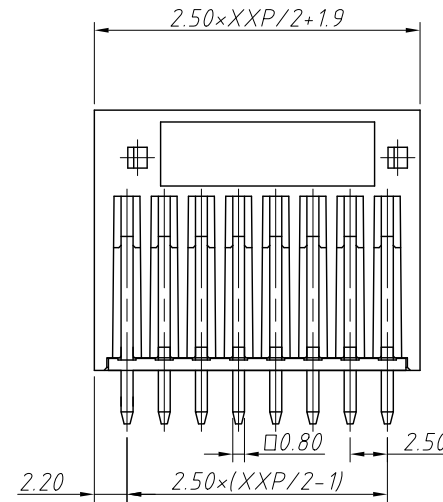
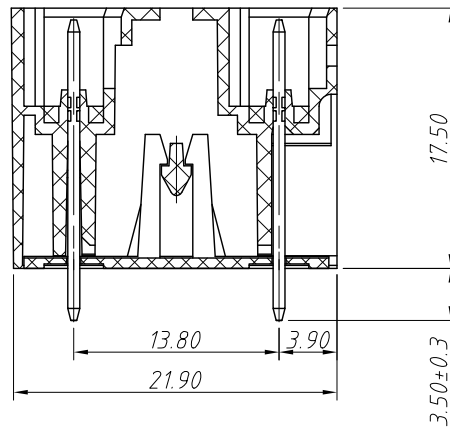
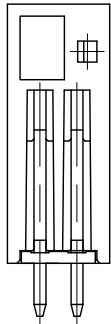

Order Information

L-KLS2-EDAV-2.50-XXP-X

RoHS
 Terminal Block
 Pitch:2.50mm
 No.:Of (04~48) Pin
 Color:
 1=Gray 2=Blue 3=Black
 4=Green 5=Orange 6=Red
 7=Transp 8=Yellow 9=White

ANGLE TOLERANCE	PROJECTION	Description:
±3°		Pitch 2.50mm Terminal Block
GENERAL TOLERANCE	UNITS	mm
0~30	±0.50	SHEET SIZE
30~60	±0.75	Draw:
60~90	±1.00	Check:
		KLS P/N:
		L-KLS2-EDAV-2.50-XXP-X
		WuHao 2024-10-28
		Daniel 2024-10-28



NingBo KLS ELECTRONIC CO.,L TD.