

RoHS Compliance

REV	SYM	Revision Record	Appr.	Date
V0	KLS02006	New Version Release	WuHao	2024-09-25

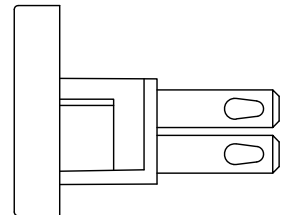
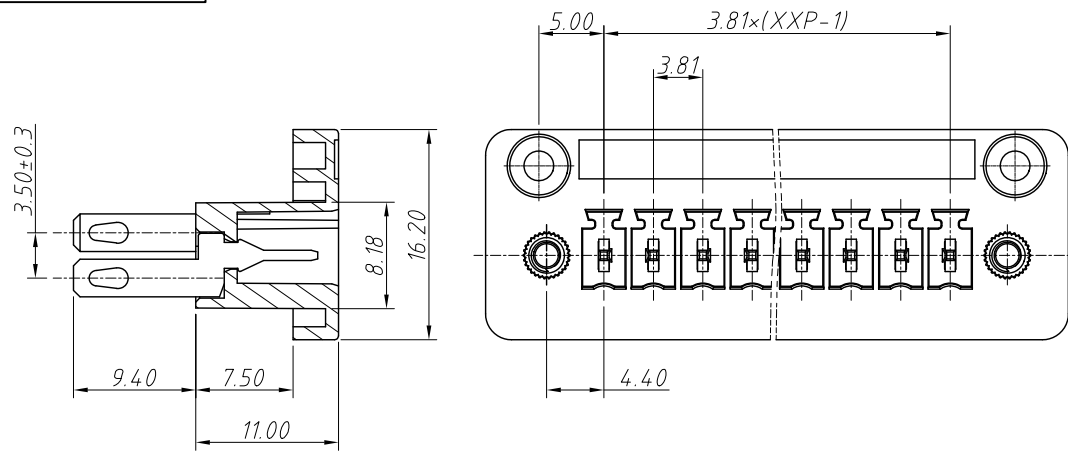

Electrical Characteristics	UL	IEC
Rated Voltage	300V	160V
Rated Current	8A	7A
Withstand Voltage	1600V/1 min	2.5KV

Material and other:
 Housing:PA66,UL 94V-0
 Pin Header:Coppo Alloy,Sn Plated
 Operating Temperature:-40°C ~ +105°C

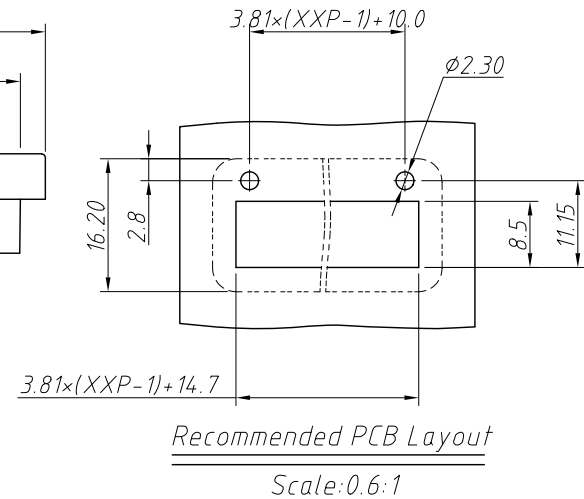
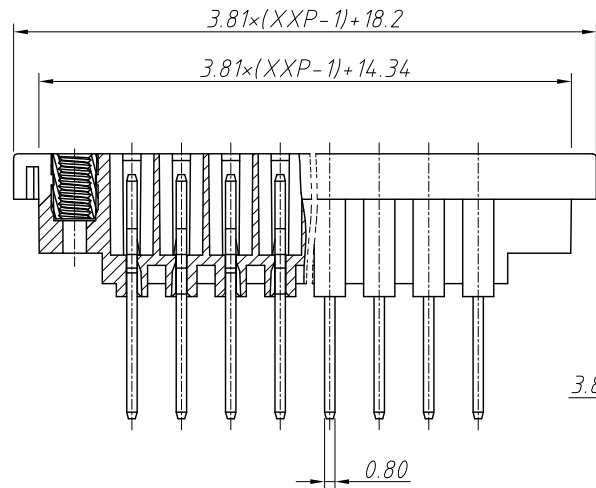

Order Information
L-KLS2-EDGM-3.81-XXP-X

RoHS
 Terminal Block
 Pitch:3.81mm
 No.:Of (02~24) Pin
 Color:

1=Gray	2=Blue	3=Black
4=Green	5=Orange	6=Red
7=Transp	8=Yellow	9=White

The First Wire Position

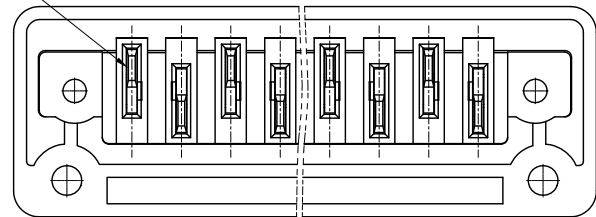
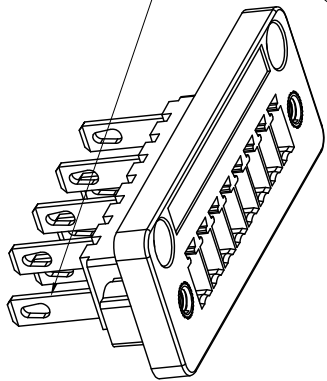

ANGLE TOLERANCE	PROJECTION	Description:
±3°		Pitch 3.81mm Pluggable Terminal Block,Socket
GENERAL TOLERANCE	UNITS	KLS P/N:
0~30 ±0.50	SHEET SIZE	A4
30~60 ±0.75	Draw:	WuHao 2024-09-25
60~90 ±1.00	Check:	Daniel 2024-09-25

L-KLS2-EDGM-3.81-XXP-X

NingBo KLS ELECTRONIC CO.,L TD.