

1 RoHS Compliance

6	7	8		
REV	SYM	Revision Record	Appr.	Date
V0	KLS02006	New Version Release	WuHao	2024-10-31

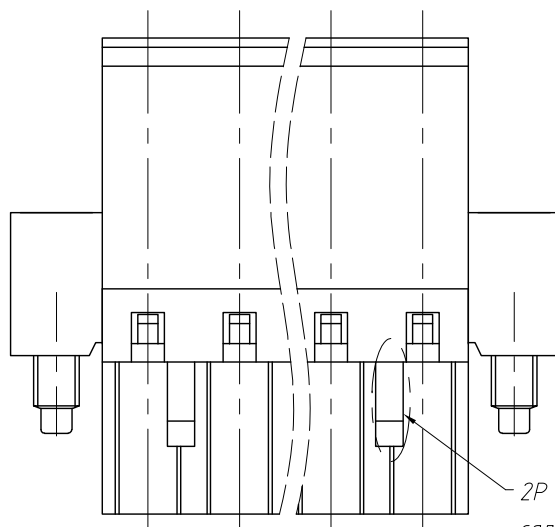

2P only has this card hook

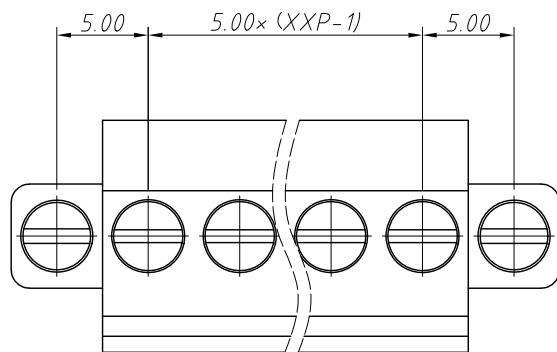
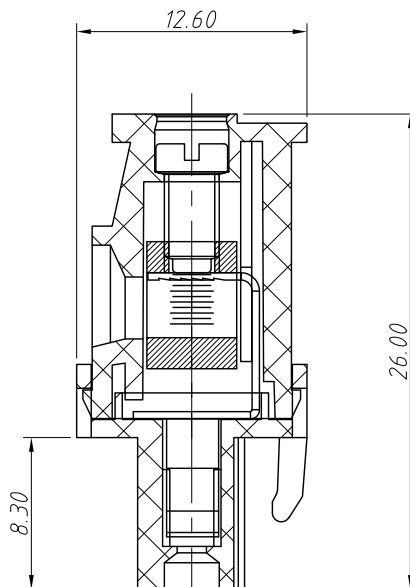
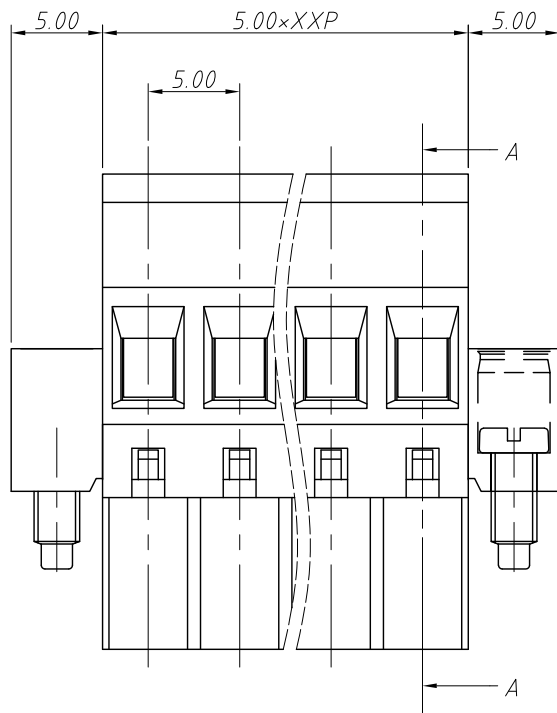

SECTION A-A

Electrical Characteristics	UL	IEC
Rated Voltage	300V	250V
Rated Current	15A	13.5A
Withstand Voltage	2000V/1 min	4.0 KV
Wire Range	28~14 AWG	0.2~2.5mm ²

Material and other:
 Housing: PA66, UL94V-0
 Pin Header: Copper Alloy
 Screw/Torque: M3/0.5N.m
 Stripping Length: 7~8mm
 Operating temperature: -40°C ~ +105°C

Order Information

L-KLS2-EDKBM-5.00-XXP-4 C 01

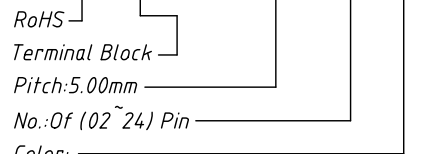

- Color:
- 1=Gray 2=Blue 3=Black
 - 4=Green 5=Orange 6=Red
 - 7=Transp 8=Yellow 9=White

Screw: SC=Slot/Cross
 S-Slot Screw C-Cross Screw

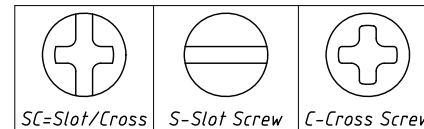

Product Code: 00~99

ANGLE TOLERANCE	PROJECTION	Description:
±3°		Pitch 5.00mm Terminal Block
GENERAL TOLERANCE	UNITS	mm
0~30 ±0.50	SHEET SIZE	A4
30~60 ±0.75	Draw:	WuHao 2024-10-31
60~90 ±1.00	Check:	Daniel 2024-10-31
		NingBo KLS ELECTRONIC CO.,L TD.



1
RoHS Compliance

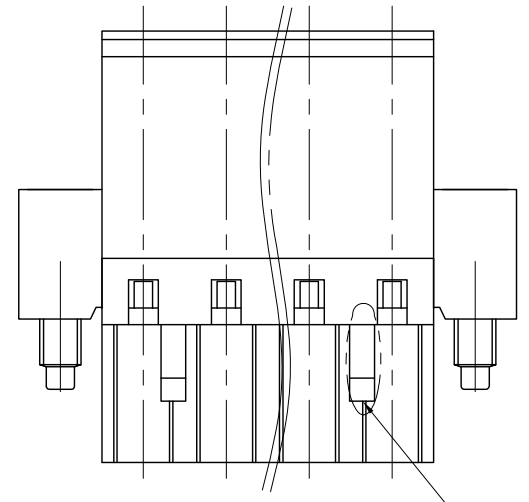
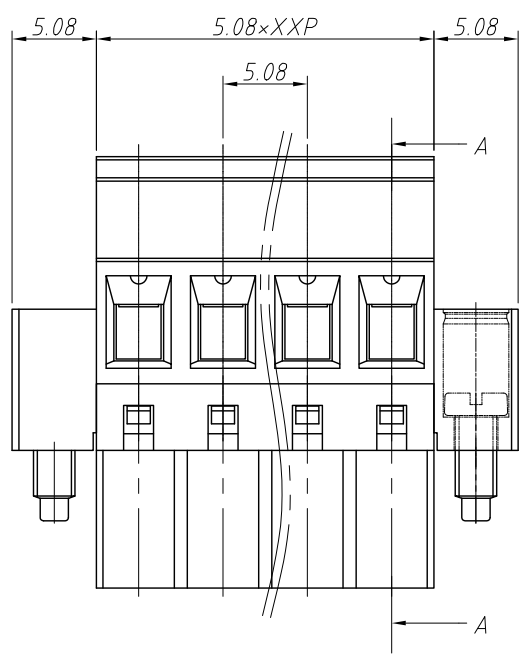
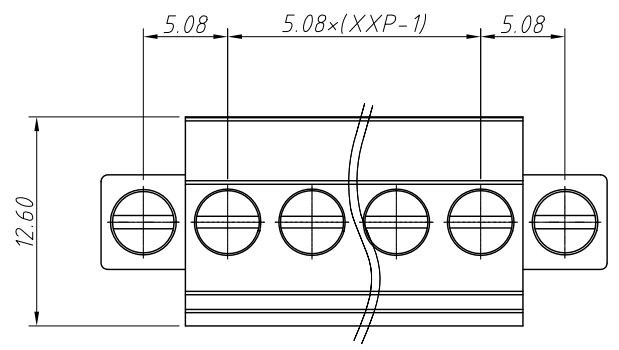

2P only has this card hook

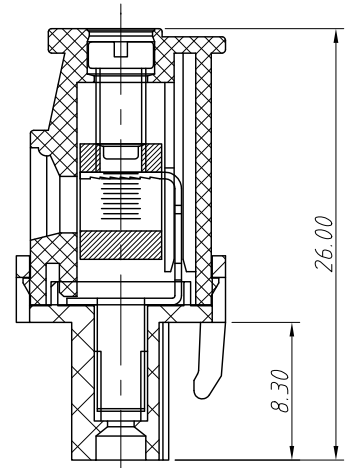

SECTION A-A

6	7	8
REV	SYM	Revision Record
VO	KLS02006	New Version Release
		Appr. WuHao
		Date 2024-10-31

Electrical Characteristics	UL	IEC
Rated Voltage	300V	450V
Rated Current	15A	17.5A
Withstand Voltage	AC2000V/1 min	---
Wire Range	28~14 AWG	1.5mm ²

Material and other:
 Housing:PA66, UL94V-0
 Clamp:Phosphor Bronze,Ni Plated
 Cage:Brass,Ni Plated
 Screw/Torque:Steel,M3,Zn Plated/0.5N.m
 Stripping Length:7~8mm
 Temp.Range:-40°C ~ +105°C
 Soldering:+250°C For 5 Sec
 Order Information

L-KLS2-EDKBM-5.08-XXP-4 C 01

RoHS
 Terminal Block
 Pitch:5.08mm
 No.:Of (02~24) Pin
 Color:
 1=Gray 2=Blue 3=Black
 4=Green 5=Orange 6=Red
 7=Transp 8=Yellow 9=White
 Screw:SC=Slot/Cross
 S-Slot Screw C-Cross Screw

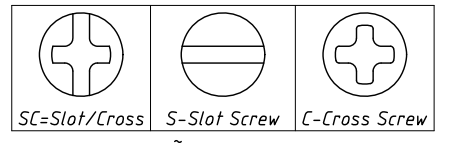

Product Code:00~99

ANGLE TOLERANCE	PROJECTION	Description:
±3°		Pitch 5.08mm Terminal Block
GENERAL TOLERANCE	UNITS	mm
0~30 ±0.50	SHEET SIZE	A4
30~60 ±0.75	Draw:	WuHao 2024-10-31
60~90 ±1.00	Check:	Daniel 2024-10-31
		KLS NingBo KLS ELECTRONIC CO.,L TD.



NingBo KLS ELECTRONIC CO.,L TD.