

1 RoHS Compliance

REV	SYM	Revision Record	Appr.	Date
V0	KLS02006	New Version Release	WuHao	2024-11-01

Electrical Characteristics	UL	IEC
Rated Voltage	300V	320V
Rated Current	15A	12A
Withstand Voltage	1600V/1 min	4.0 KV

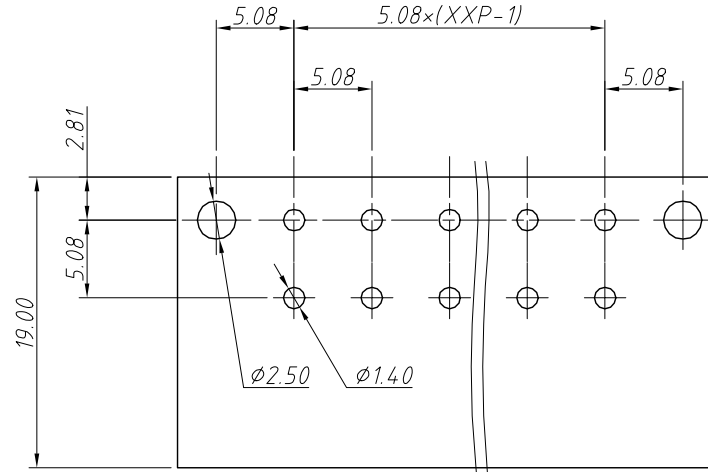
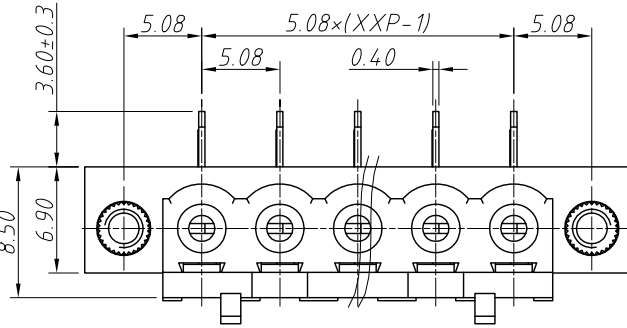

Recommended PCB Layout

Material and other:
 Housing: PA66, UL 94 V-0
 Pin Header: Copper Alloy, Sn Plated
 Operating Temperature: -40°C ~ +105°C
 Soldering Temperature: +260°C/5 S

2P only has this card hook

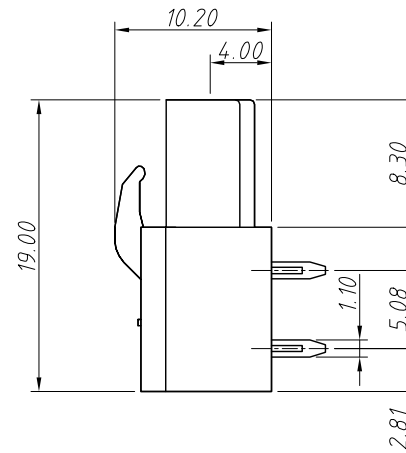
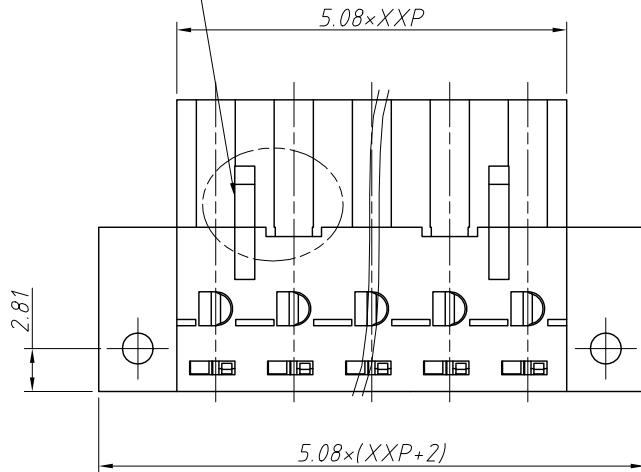

Order Information

L-KLS2-EDKRM-5.08-XXP-X

- RoHS
- Terminal Block
- Pitch: 5.08mm
- No.: Of (02~24) Pin
- Color: 1=Gray 2=Blue 3=Black
- 4=Green 5=Orange 6=Red
- 7=Transp 8=Yellow 9=White

ANGLE TOLERANCE	PROJECTION	Description:
±3°		Pitch 5.08mm Terminal Block
GENERAL TOLERANCE	UNITS	mm
0~30	±0.50	SHEET SIZE
30~60	±0.75	Draw:
60~90	±1.00	Check:
		KLS P/N:
		L-KLS2-EDKRM-5.08-XXP-X
		2024-11-01
		2024-11-01



NingBo KLS ELECTRONIC CO.,LTD.