

1
RoHS Compliance

6		7		8	
REV	SYM	Revision Record		Appr.	Date
V0	KLS02006	New Version Release		WuHao	2024-10-31

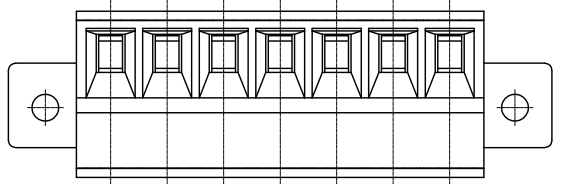

Electrical Characteristics	UL	IEC
Rated Voltage	300V	160V
Rated Current	8A	7A
Withstand Voltage	1600V/1min	2.5KV
Wire Range	28~16 AWG	0.5~1.5mm ²

Material and other:
Housing:PA66, UL94V-0
Pin Header:Copper Alloy,Sn Plated
Screw/Torque:M2/0.2N.m
Stripping Length:6~7mm
Operating Temperature:-40°C~+105°C

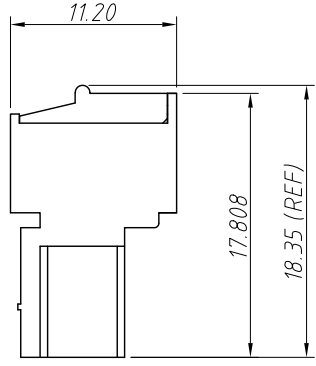
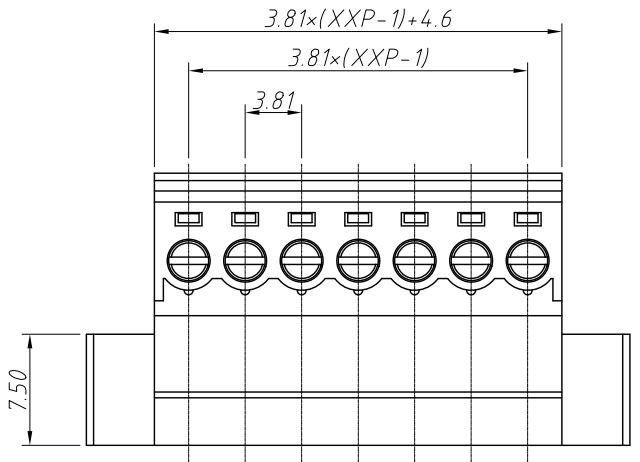
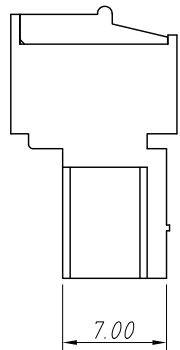

Order Information
L-KLS2-EDGN-3.81-XXP-X X

RoHS
Terminal Block
Pitch:3.81mm
No.:Of (02~24) Pin
Color:1=Gray 2=Blue 3=Black
4=Green 5=Orange 6=Red
7=Transp 8=Yellow 9=White
Screw:SC=Slot/Cross
S-Slot Screw C-Cross Screw

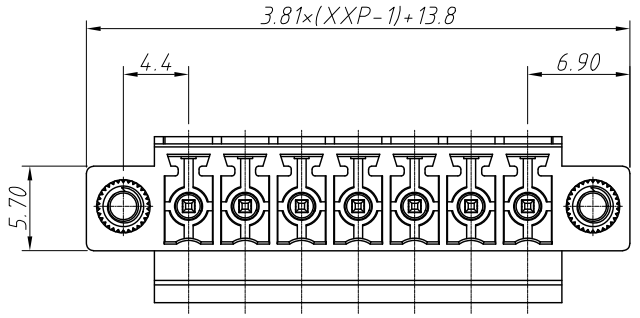
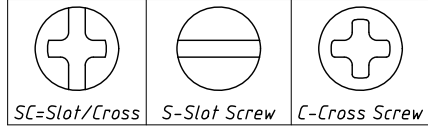

ANGLE TOLERANCE	PROJECTION	Description:			
±3°		Pitch 3.81mm Terminal Block			
GENERAL TOLERANCE	UNITS	mm	KLS P/N:		
0~30 ±0.50	SHEET SIZE	A4	L-KLS2-EDGN-3.81-XXP-XX		
30~60 ±0.75	Draw:	WuHao	2024-10-31	NingBo KLS ELECTRONIC CO.,L TD.	
60~90 ±1.00	Check:	Daniel	2024-10-31		