

1
RoHS Compliance

REV	SYM	Revision Record	Appr.	Date
V0	KLS02006	New Version Release	Jenny	2024-10-30

Electrical	UL	IEC
Rated Voltage	300V	250V
Rated Current	8A	7A
Wire range	28~16AWG	1.5mm ²
Withstand Voltage	AC2000V/1 min	---

Material and other:
 Housing:PA66, UL94V-0
 Clamp/Cage:Copper Alloy,Ni Plated
 Screws/Torque:Steel,M2.0,Zn Plated/0.2Nm
 Contact Resistance:20mΩ Max
 Insulation Resistance:500MΩ/DC500V Min
 Temp. Range:-40°C ~ +105°C

Order Information
 L-KLS2-EDGF-3.81-XXP-X X
 RoHS-
 Terminal Block
 Pitch:3.81mm
 No.:Of (02~24) Pin
 Color:
 1=Gray 2=Blue 3=Black
 4=Green 5=Orange 6=Red
 7=Transp 8=Yellow 9=White
 Screw:SC=Slot/Cross
 S-Slot Screw C-Cross Screw

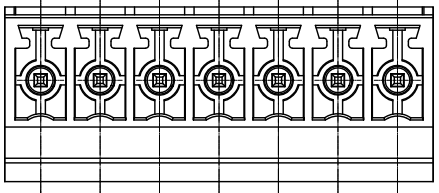
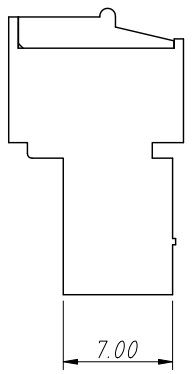
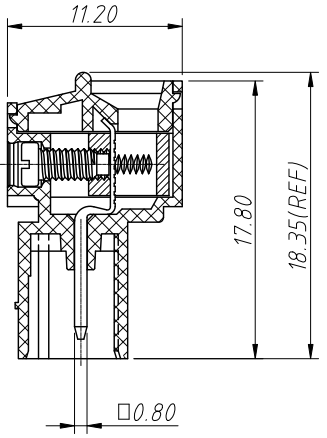
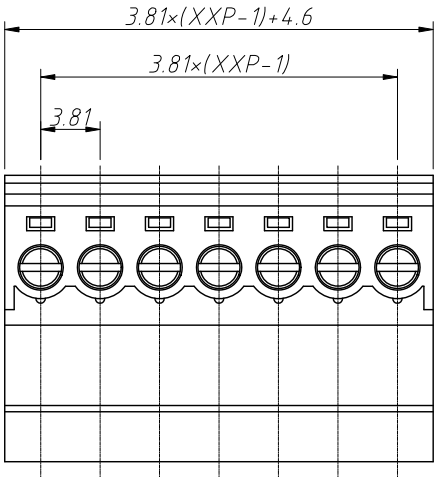
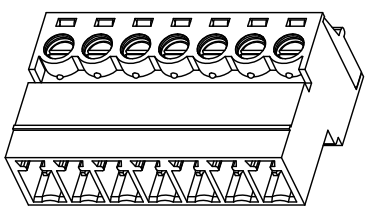
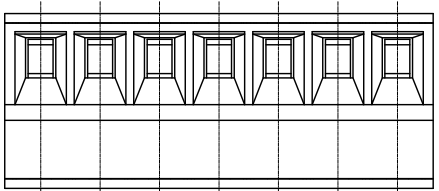
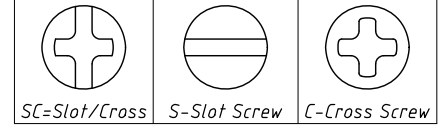

ANGLE TOLERANCE	PROJECTION	Description:
±3°		Pitch 3.81mm Terminal Block
GENERAL TOLERANCE	UNITS	mm
0~30 ±0.50	SHEET SIZE	A4
30~60 ±0.75	Draw:	Jenny 2024-10-30
60~90 ±1.00	Check:	Daniel 2024-10-30

L-KLS2-EDGF-3.81-XXP-XX
 NingBo KLS ELECTRONIC CO.,L TD.