

1
RoHS Compliance

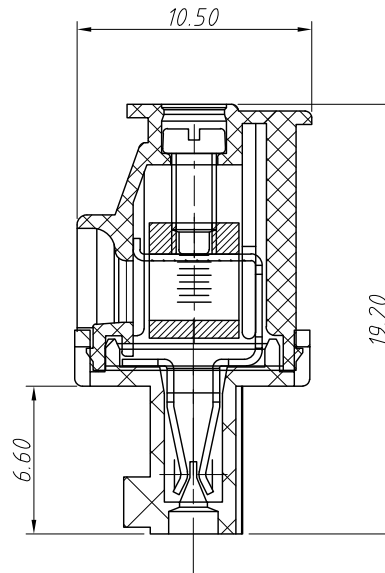
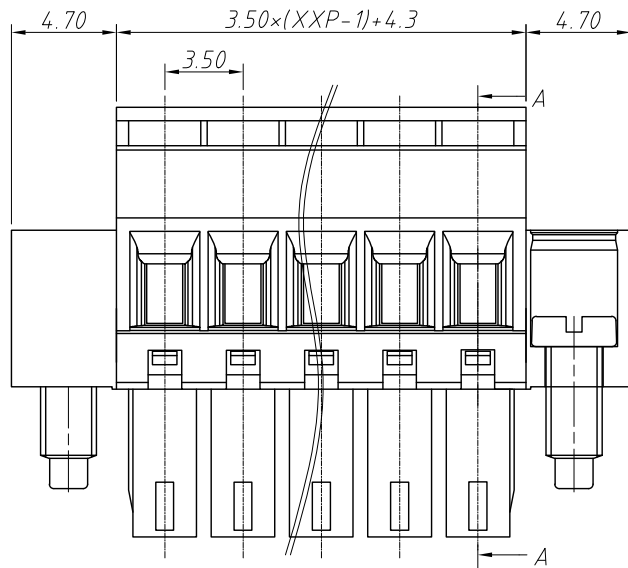
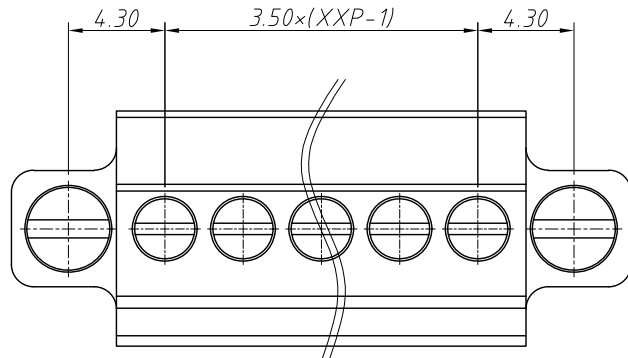

Section: A-A

REV	SYM	Revision Record	Appr.	Date
V0	KLS02006	New Version Release	WuHao	2024-10-29

Electrical Characteristics	UL	IEC
Rated Voltage	300V	250V
Rated Current	8A	7A
Withstand Voltage	AC2000V/1 min	---
Wire Range	28~16 AWG	1.5mm ²

Material and other:

Housing:PA66, UL 94V-0

Clamp/Cage:Copper Alloy,Ni Plated

Screws/Torque:Steel,M2.0,Zn Plated/0.2Nm

Operating temperature:-40°C ~ +105°C

Steip Length:6~7mm

Order Information

L-KLS2-EDCDM-3.50-XXP-XX

RoHS

Terminal Block

Pitch:3.50mm

No.:Of (02~24) Pin

Color:

1=Gray 2=Blue 3=Black

4=Green 5=Orange 6=Red

7=Transp 8=Yellow 9=White

Screw:SC=Slot/Cross

S-Slot Screw C-Cross Screw

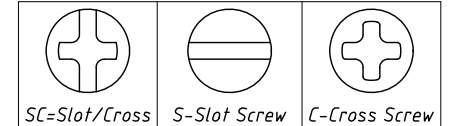

ANGLE TOLERANCE	PROJECTION	Description:
±3°		Pitch 3.50mm Terminal Block
GENERAL TOLERANCE	UNITS	mm
0~30	±0.50	SHEET SIZE
30~60	±0.75	Draw:
60~90	±1.00	Check:
		KLS P/N:
		L-KLS2-EDCDM-3.50-XXP-XX
		WuHao 2024-10-29
		Daniel 2024-10-29



NingBo KLS ELECTRONIC CO.,L TD.

1
RoHS Compliance

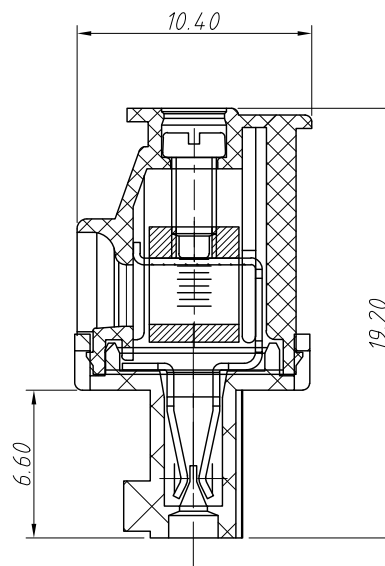
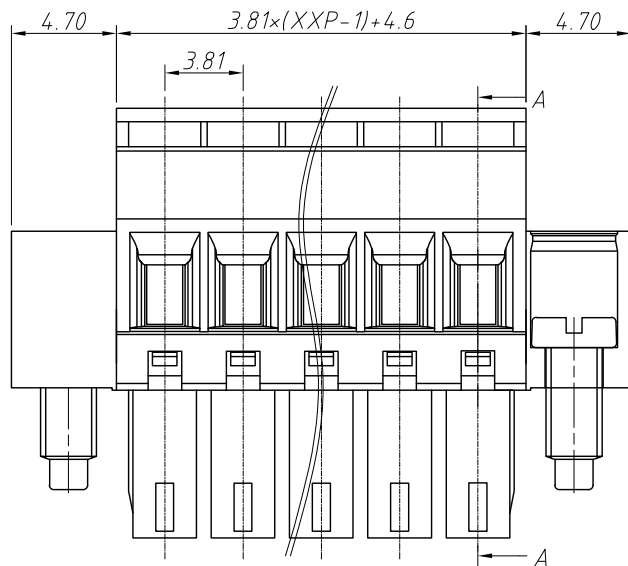
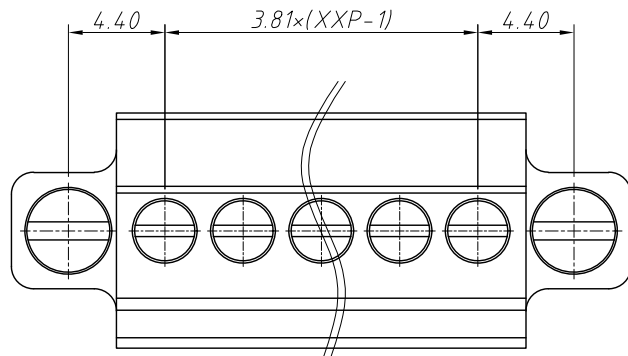

Section: A-A

REV	SYM	Revision Record	Appr.	Date
V0	KLS02006	New Version Release	WuHao	2024-10-29

Electrical Characteristics	UL	IEC
Rated Voltage	300V	250V
Rated Current	8A	7A
Withstand Voltage	AC2000V/1 min	---
Wire Range	28~16 AWG	1.5mm ²

Material and other:
 Housing:PA66, UL 94V-0
 Clamp/Cage:Copper Alloy,Ni Plated
 Screws/Torque:Steel,M2.0,Zn Plated/0.2Nm
 Temp.Range:-40°C ~ +105°C
 Steip Length:6~7mm

Order Information

L-KLS2-EDCDM-3.81-XXP-XX

RoHS
 Terminal Block
 Pitch:3.81mm
 No.:Of (02~24) Pin
 Color:
 1=Gray 2=Blue 3=Black
 4=Green 5=Orange 6=Red
 7=Transp 8=Yellow 9=White
 Screw:SC=Slot/Cross
 S-Slot Screw C-Cross Screw

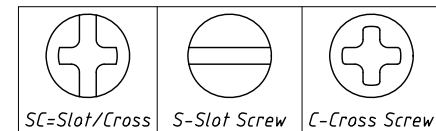

ANGLE TOLERANCE	PROJECTION	Description:
±3°		Pitch 3.81mm Terminal Block
GENERAL TOLERANCE	UNITS	mm
0~30	±0.50	KLS P/N:
30~60	±0.75	L-KLS2-EDCDM-3.81-XXP-XX
60~90	±1.00	Draw: WuHao 2024-10-29
	Check: Daniel 2024-10-29	NingBo KLS ELECTRONIC CO.,L TD.