

Proper Cable

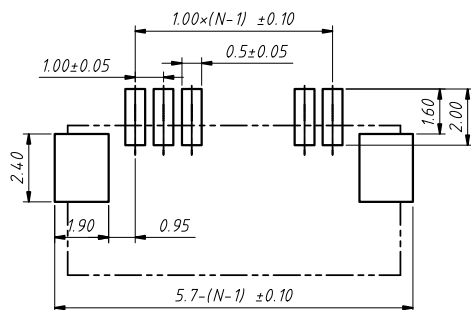
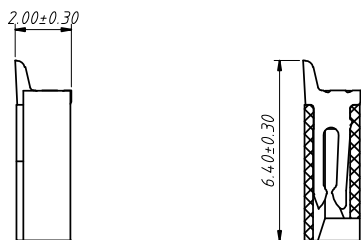
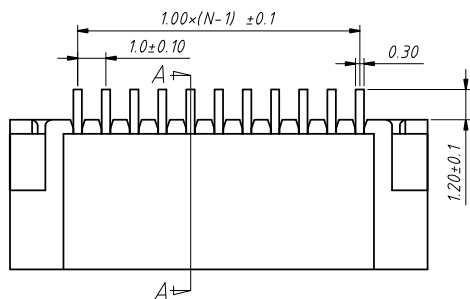

PCB LAYOUT

**Material**  
Housing: LCP, UL94V-0  
Contact: Phosphor Bronze, Tin

**Electrical**  
Voltage rating: 50 V  
Current Rating: 1 A  
Withstanding Voltage: 200 V  
Insulation resistance: 800M $\Omega$ .Min.  
Contact resistance: 40 m $\Omega$ .Max.

**Mechanical**  
Temp. Range: -40 °C ~ + 85 °C

**Order Information**

L-KLS1- 1240G - 2.0- XX -T-R

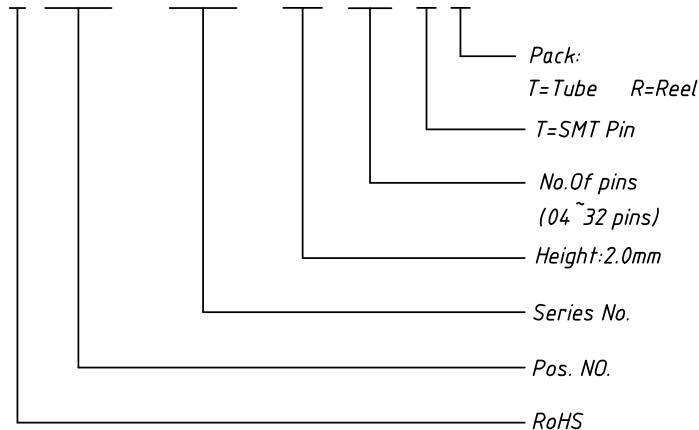

GENERAL TOLERANCE	ANGLE TOLERANCE	PROJECTION		Description:
.X ±0.15	.X ±5°	UNITS	mm	CONN FFC 1.00mm, SMD, Horizontal
.X ±0.03	.X ±3°	SHEET SIZE	A4	
.XX ±0.05	.XX ±2°		KLS P/N:	L-KLS1-1240G-2.0-XX-T-R

Draw by: Date 2018-03-10

Check by: Date 2018-03-10

SCALE SHEET OF



NingBo KLS ELECTRONIC CO.,L TD.