

1 RoHS Compliance

REV	SYM	Revision Record	Appr.	Date
V0	KLS01629	New Version Release	Jenny	2024-07-10

Socket Height (F)	Plug Height (M)	Mating Height (M/H)	Dimensions(mm)		
			J	K	L
2.50	1.00	3.50	3.00	2.60	1.50
3.00		4.00			
3.50		4.50			
4.00		5.00			
5.00	1.50	6.00	3.50	2.60	1.50
6.00		7.00			
7.00		8.00			
8.00		9.00			
9.00	7.00	10.00	10.00	2.54	2.60
4.00		5.50			
5.00		6.50			
6.00		7.50			
7.00	7.50	8.50	10.50	2.54	2.60
8.00		9.50			
9.00		10.50			
5.00		12.00			
6.00	7.50	13.00	10.50	2.54	2.60
7.00		14.00			
8.00		15.00			
9.00		16.00			
5.00	7.50	12.50	10.50	2.54	2.60
6.00		13.50			
7.00		14.50			
8.00		15.50			
9.00	7.50	16.50	10.50	2.54	2.60

Material:

Housing: Thermoplastic High Temp, UL 94V-0, Black  
 Contact: Copper Alloy, Contact Area Gold Flash and Solder Area Tin or Gold Flash Overall Nickel Under Plated

Electrical:

Voltage: 50V AC(rms)/DC  
 Current: 0.5A AC(rms)/DC  
 Contact Resistance: 50mΩ max.  
 Insulation Resistance: 500MΩ min  
 Dielectric Withstanding Voltage: 200V AC/rms  
 Operating Temperature Range: -40°C ~ +85°C

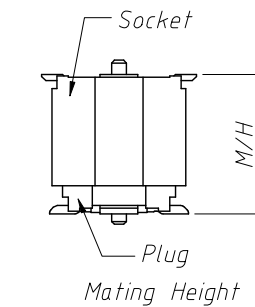
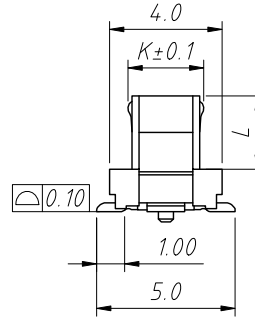

Order Information:

L-KLS1-B1805-XX M XX-T3RB-GF1

- L: RoHS
- Board To Board
- Pitch-0.50mm
- Height-See Table
- Type-M-Male
- XX-No. Of Contact
- T3=SMD With Post
- T=SMD Without Post, Packing: R=Reel
- Color: B-Black W-Natural
- Plating: GF1-1u "Half Gold Tin GF10-10u" Half Gold Tin G1=1u"Gold Sn=Sn Gold

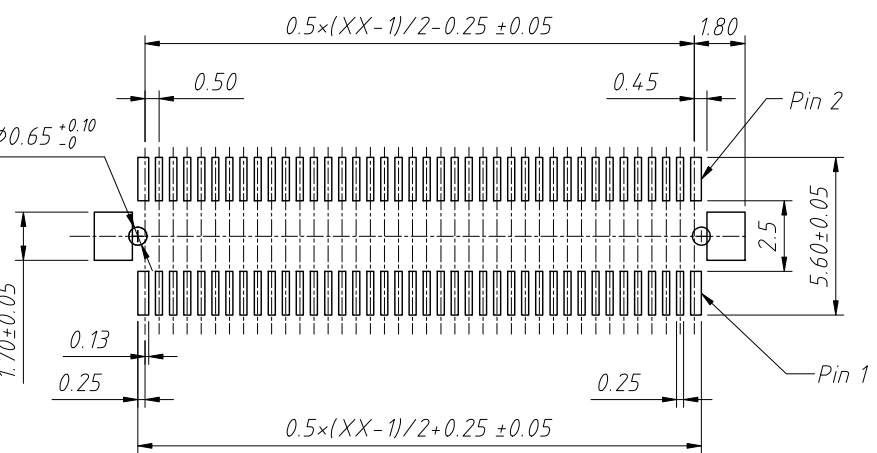
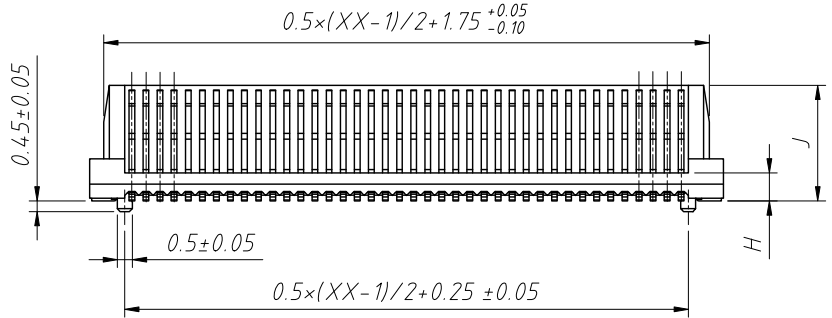
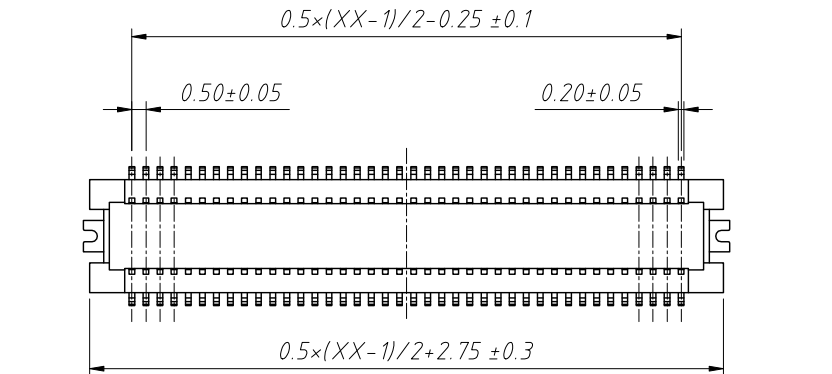

Recommended PCB Layout (Top View)

ANGLE TOLERANCE	PROJECTION	Description:	0.5mm Board To Board Plug	
±3°				
GENERAL TOLERANCE	UNITS	mm	KLS P/N:	L-KLS1-B1805-XXMXX-T3RB-GF1
x.x ±0.30	SHEET SIZE	A4		
x.xx ±0.20	Draw:	Jenny	2024-07-10	NingBo KLS ELECTRONIC CO.,L TD.
x.xxx ±0.10	Check:	Daniel	2024-07-10	

RoHS Compliance

REV	SYM	Revision Record	Appr.	Date
V0	KLS01629	New Version Release	Jenny	2024-07-10

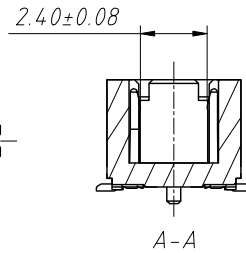
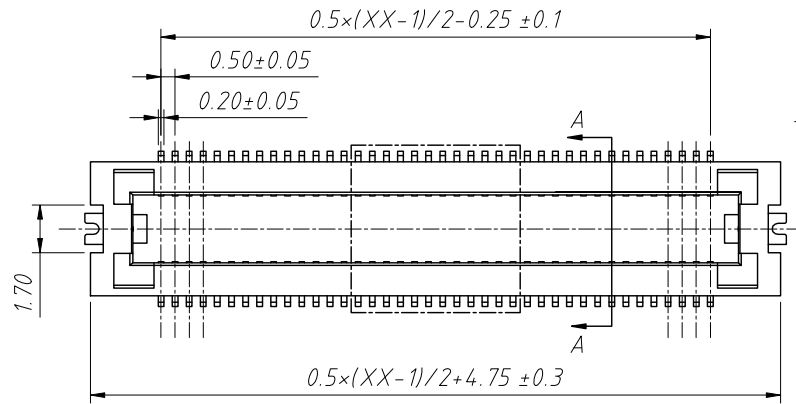

**Material:**  
 Housing: Thermoplastic High Temp, UL 94 V-0, Black  
 Contact: Copper Alloy, Contact Area Gold Flash and Solder Area Tin or Gold Flash Overall  
 Nickel Under Plated

**Electrical:**  
 Voltage: 50V AC(rms)/DC  
 Current: 0.5A AC(rms)/DC  
 Contact Resistance: 50mΩ max.  
 Insulation Resistance: 500MΩ min  
 Dielectric Withstanding Voltage: 200V AC/rms  
 Operating Temperature Range: -40°C ~ +85°C

Socket Height (F)	Plug Height (M)	Mating Height (M/H)	G
2.50	1.00	3.50	2.00
3.00		4.00	2.50
3.50		4.50	3.00
4.00		5.00	
5.00		6.00	
6.00	1.50	7.00	3.50
7.00		8.00	
8.00		9.00	
9.00		10.00	
4.00		5.50	
5.00	6.50		
6.00	7.50		
7.00	8.50		
8.00	9.50		
9.00	10.50		
5.00	7.00	12.00	
6.00		13.00	
7.00		14.00	
8.00		15.00	
9.00		16.00	
5.00	7.50	12.50	
6.00		13.50	
7.00		14.50	
8.00		15.50	
9.00		16.50	

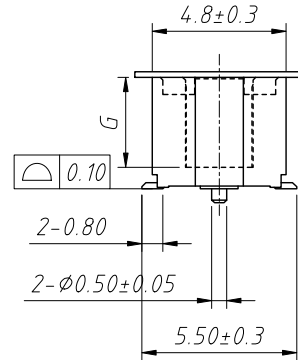
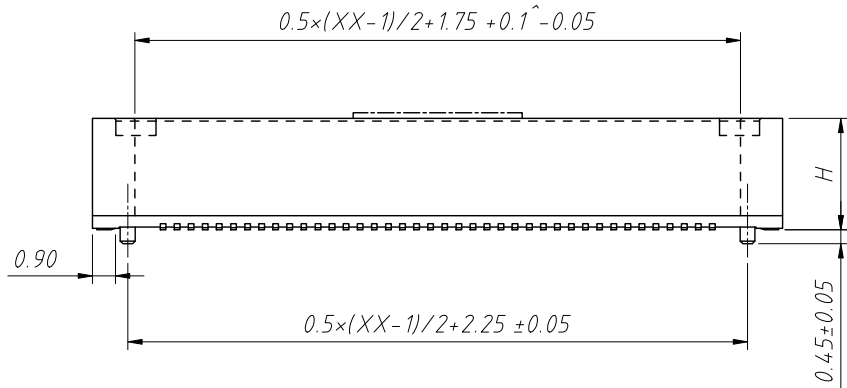

**Order Information:**

L-KLS1-B1805-XX F XX-T3RB-GF1

L:RoHS  
 Board To Board  
 Pitch-0.50mm  
 Height-See Table  
 Type F-Female  
 XX-No. Of Contact  
 T3=SMD With Post  
 T=SMD Without Post, Packing: R=Reel  
 Color: B-Black W-Natural  
 Plating:  
 GF1-1u" Half Gold Tin      G1=1u" Gold  
 GF10-10u" Half Gold Tin      Sn=Sn Gold

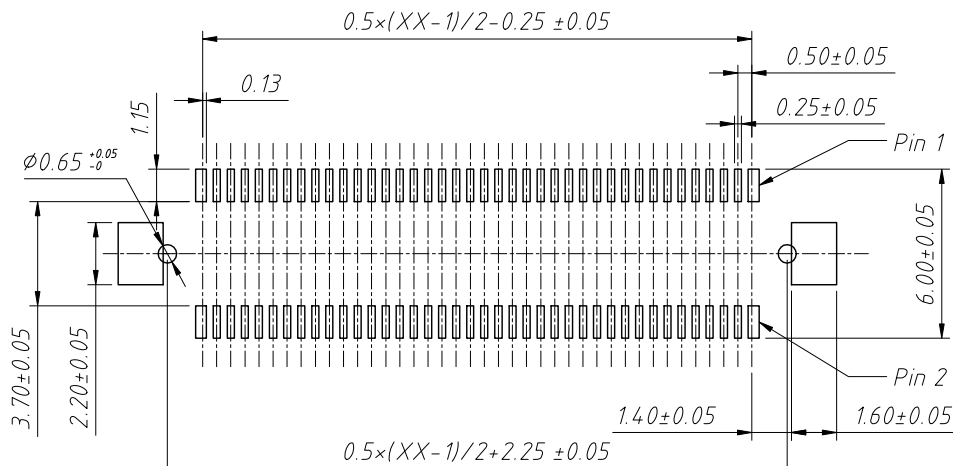
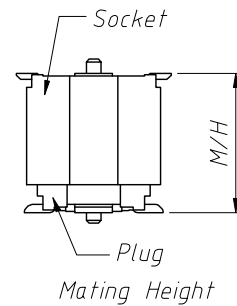

ANGLE TOLERANCE	PROJECTION	Description:
±3°		0.5mm Board To Board Socket
GENERAL TOLERANCE	UNITS	mm
x.x ±0.30	SHEET SIZE	A4
x.xx ±0.20	Draw:	Jenny 2024-07-10
x.xxx ±0.10	Check:	Daniel 2024-07-10

**KLS** NingBo KLS ELECTRONIC CO.,L TD.