

1 RoHS Compliance

REV	SYM	Revision Record	Appr.	Date
V0	KLS01629	New Version Release	Jenny	2024-07-10

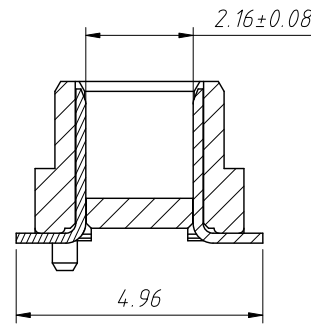
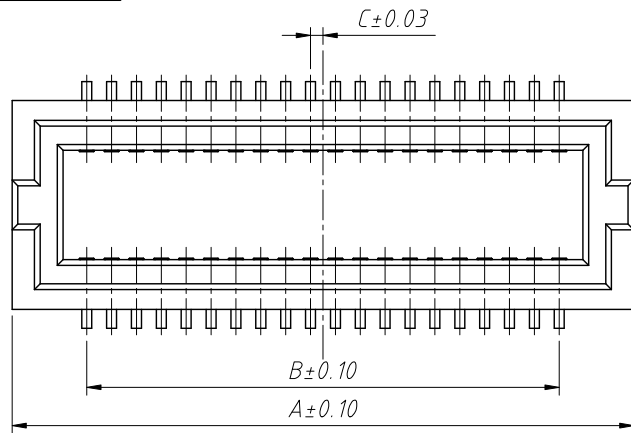

Material:
 Housing: Thermo-Plastic. UL 94 V-0 Nature
 Contact: Phosphor Bronze
 Contact: Solder: Gold flash Underplating;
 50~120u" Nickel overall

Electrical:
 Current Rating: 0.5A
 Withstanding Voltage: 200v ac for 1 min
 Contact Resistance: 60mΩ max (Initial),
 80mΩ max (after)
 Insulation Resistance: 100mΩ min
Environmental:
 Operating Temperature: -55°C to +125°C

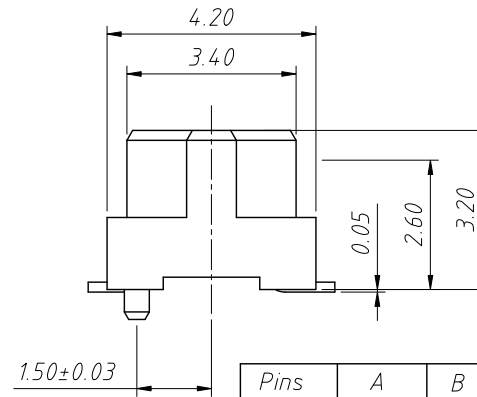
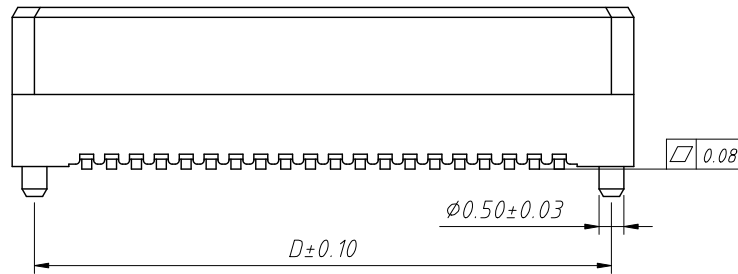

Order Information:
 L-KLS1-B1505-320 M XX-T3RB-FG1

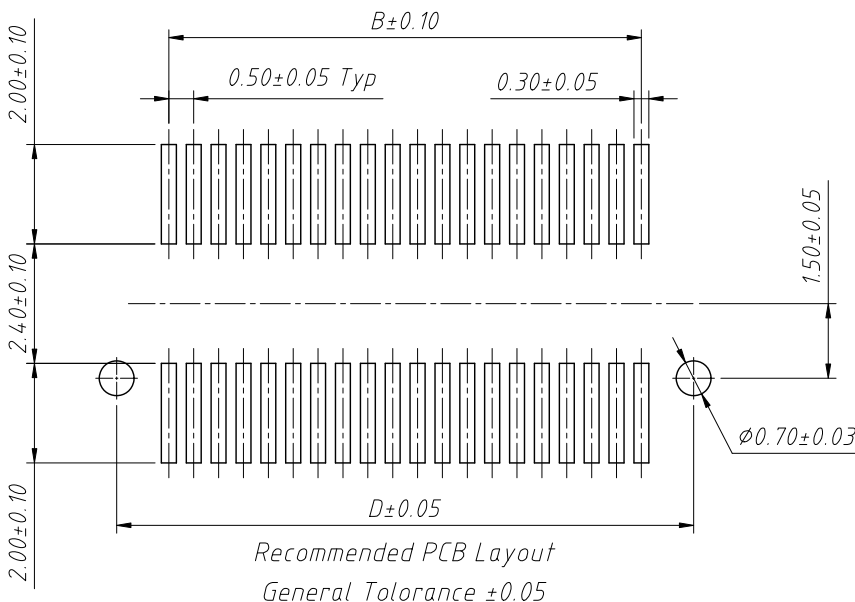
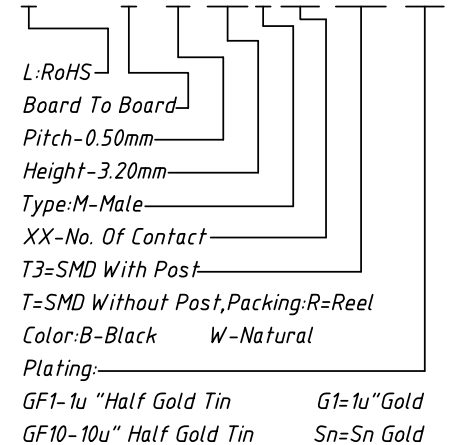

Pins	A	B	C	D
20	7.50	4.50	0.25	6.60
30	10.00	7.00	0.50	9.10
40	12.50	9.50	0.25	11.60
50	15.00	12.00	0.50	14.10
60	17.50	14.50	0.25	16.60
70	20.00	17.00	0.50	19.10
80	22.50	19.50	0.25	21.60
90	25.00	22.00	0.50	24.10
100	27.50	24.50	0.25	26.60
110	30.00	27.00	0.50	29.10
120	32.50	29.50	0.25	31.60

ANGLE TOLERANCE	PROJECTION	Description:
±3°		0.5mm Board To Board Plug
GENERAL TOLERANCE	UNITS	mm
x.x ±0.30	SHEET SIZE	A4
x.xx ±0.20	Draw:	Jenny 2024-07-10
x.xxx ±0.10	Check:	Daniel 2024-07-10

L-KLS1-B1505-320MXX-T3RB-GF1

NingBo KLS ELECTRONIC CO.,LTD.

1 RoHS Compliance

REV	SYM	Revision Record	Appr.	Date
V0	KLS01629	New Version Release	Jenny	2024-07-10

Material:
 Housing: Thermo-Plastic. UL 94 V-0 Nature
 Contact: Phosphor Bronze
 Contact: Solder: Gold flash Underplating;
 50~120u" Nickel overall

Electrical:
 Current Rating: 0.5A
 Withstanding Voltage: 200v ac for 1 min
 Contact Resistance: 60mΩ max (Initial),
 80mΩ max (after)
 Insulation Resistance: 100mΩ min
 Environmental:
 Operating Temperature: -55°C to +125°C

Order Information:

L-KLS1-B1505-410 F XX-T3RB-GF1

L:RoHS
 Board To Board
 Pitch-0.50mm
 Height-4.10mm
 TypeF-Female
 XX-No. Of Contact
 T3=SMD With Post
 T=SMD Without Post, Packing: R=Reel
 Color: B-Black W-Natural
 Plating:
 GF1-1u" Half Gold Tin G1=1u" Gold
 GF10-10u" Half Gold Tin Sn=Sn Gold

0.5mm Board To Board Socket

L-KLS1-B1505-410FXX-T3RB-GF1

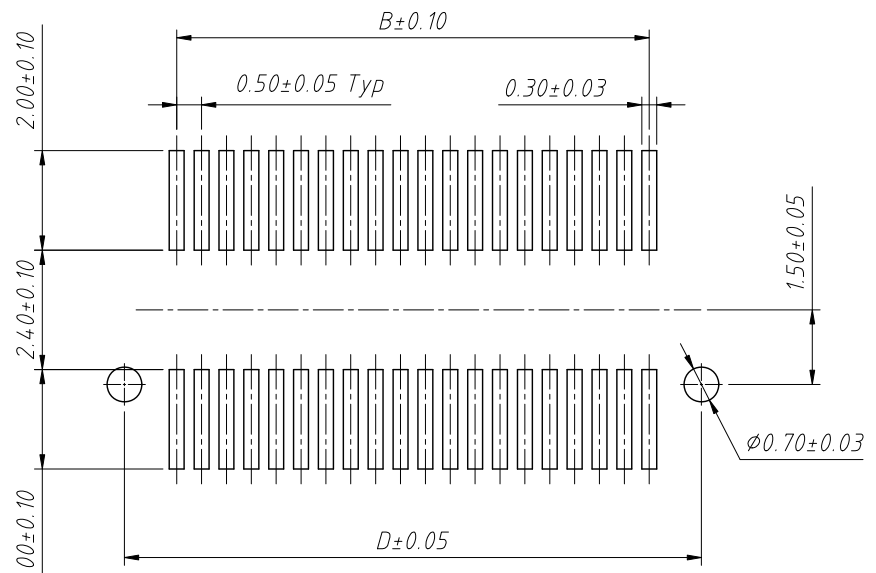
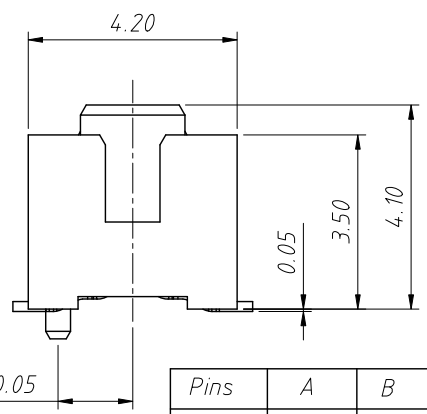
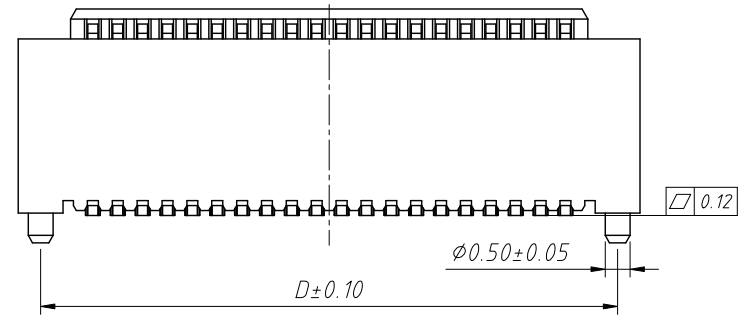
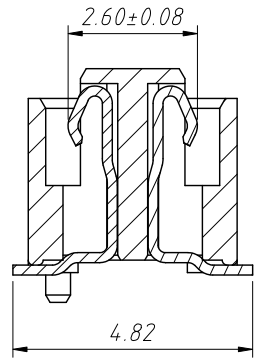
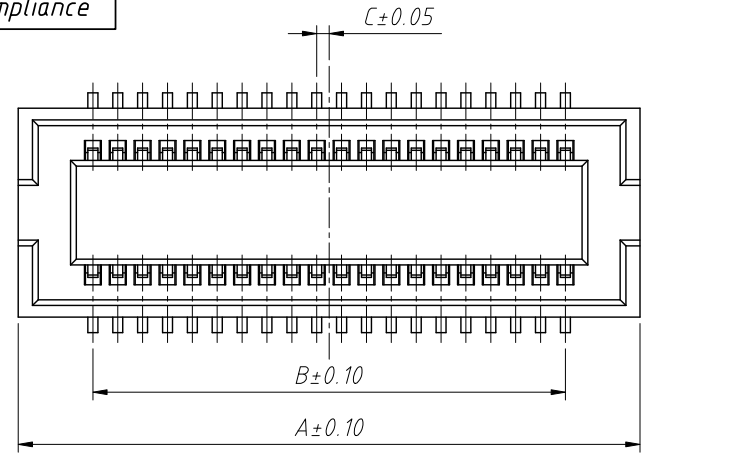
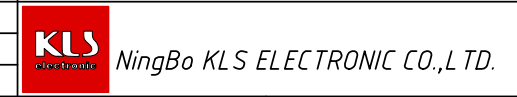

Recommended PCB Layout
 General Tolerance ±0.05

Pins	A	B	C	D
20	7.50	4.50	0.25	6.60
30	10.00	7.00	0.50	9.10
40	12.50	9.50	0.25	11.60
50	15.00	12.00	0.50	14.10
60	17.50	14.50	0.25	16.60
70	20.00	17.00	0.50	19.10
80	22.50	19.50	0.25	21.60
90	25.00	22.00	0.50	24.10
100	27.50	24.50	0.25	26.60
110	30.00	27.00	0.50	29.10
120	32.50	29.50	0.25	31.60

ANGLE TOLERANCE	PROJECTION	Description:	
±3°			
GENERAL TOLERANCE	UNITS	mm	KLS P/N:
x.x ±0.30	SHEET SIZE	A4	
x.xx ±0.20	Draw:	Jenny	2024-07-10
x.xxx ±0.10	Check:	Daniel	2024-07-10