

RoHS Compliance

REV	SYM	Revision Record	Appr.	Date
V0	KLS01629	New Version Release	Jenny	2024-07-10

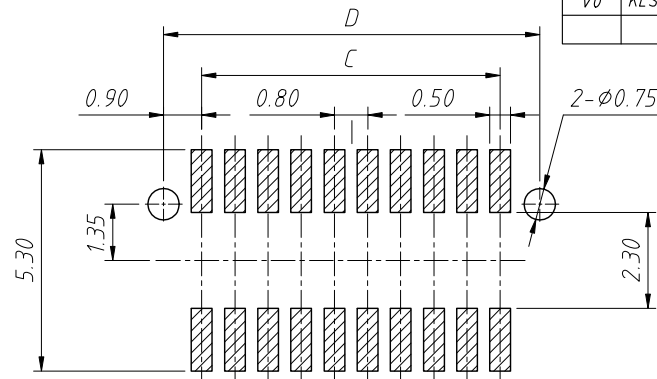
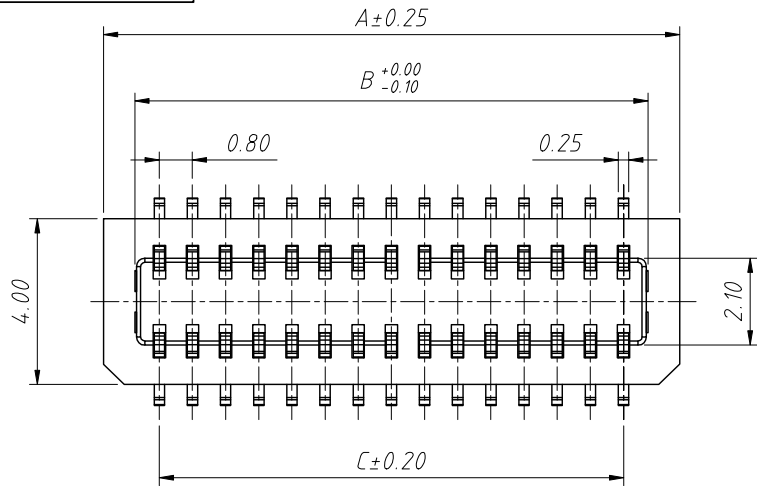

Recommended PCB Layout  
General Tolerance ±0.05

Pins	Dimensions(mm)			
	A	B	C	D
06	4.30	2.80	1.60	3.40
08	5.10	3.60	2.40	4.20
10	5.90	4.40	3.20	5.00
12	6.70	5.20	4.00	5.80
14	7.50	6.00	4.80	6.60
16	8.30	6.80	5.60	7.40
18	9.10	7.60	6.40	8.20
20	9.90	8.40	7.20	9.00
30	13.90	12.40	11.20	13.00
40	17.90	16.40	15.20	17.00
50	21.90	20.40	19.20	21.00

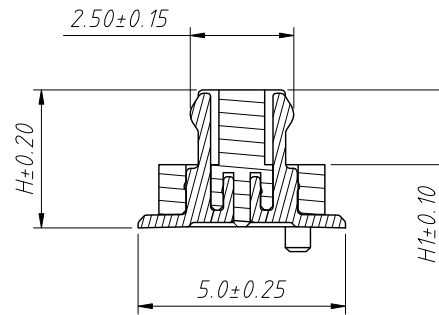
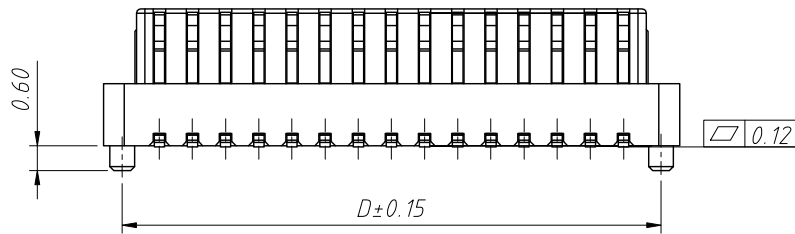

H	H1
2.80	1.80
3.30	
3.80	
4.30	2.30
4.80	
5.30	

Mating Height (M/H)	Plug Height (M)	Socket Height (F)
4.00	2.80	2.90
4.50	3.30	
5.00	3.80	3.40
5.50	4.30	
6.00	4.80	3.90
6.50	5.30	
7.00	5.30	

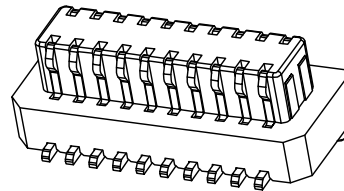
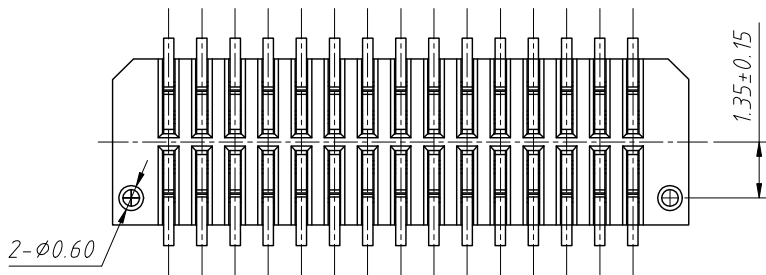

Order Information:

L-KLS1-B1408-XX M XX-T3RB-GF1

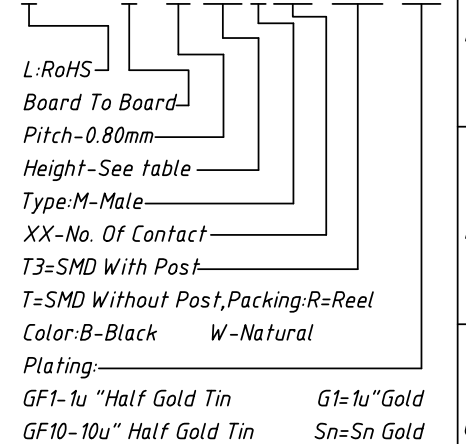

Material:  
Insulator:LCP High Temperature  
Thermoplastic,UL 94V-0  
Terminal:Phosphor Bronze,Gold plating,  
Nickel 50u" min. over all

Electrical:  
Current Rating:0.5Amp  
Dielectric Withstanding:200V AC;  
Insulation resistance:500mΩ min;  
Contact resistance:30mΩ max;  
Operating Temperature:-40°C ~ +105°C

ANGLE TOLERANCE	PROJECTION	Description:
±3°		0.8mm Board To Board Plug
GENERAL TOLERANCE	UNITS	mm
x.x ±0.30	SHEET SIZE	A4
x.xx ±0.20	Draw:	Jenny 2024-07-10
x.xxx ±0.10	Check:	Daniel 2024-07-10



NingBo KLS ELECTRONIC CO.,L TD.

1 RoHS Compliance

REV	SYM	Revision Record	Appr.	Date
V0	KLS01629	New Version Release	Jenny	2024-07-10

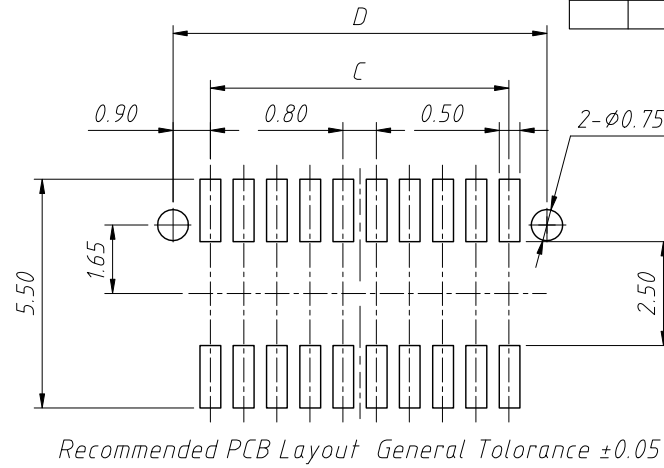
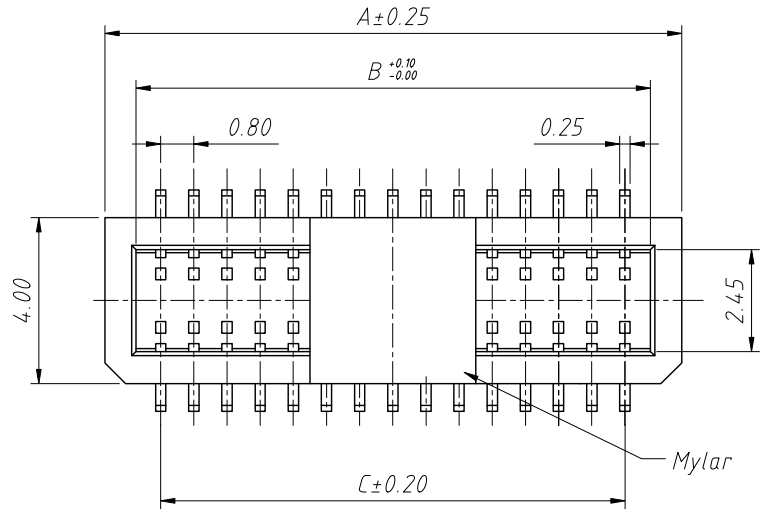

Pins	Dimensions(mm)			
	A	B	C	D
06	4.30	2.80	1.60	3.40
08	5.10	3.60	2.40	4.20
10	5.90	4.40	3.20	5.00
12	6.70	5.20	4.00	5.80
14	7.50	6.00	4.80	6.60
16	8.30	6.80	5.60	7.40
18	9.10	7.60	6.40	8.20
20	9.90	8.40	7.20	9.00
30	13.90	12.40	11.20	13.00
40	17.90	16.40	15.20	17.00
50	21.90	20.40	19.20	21.00

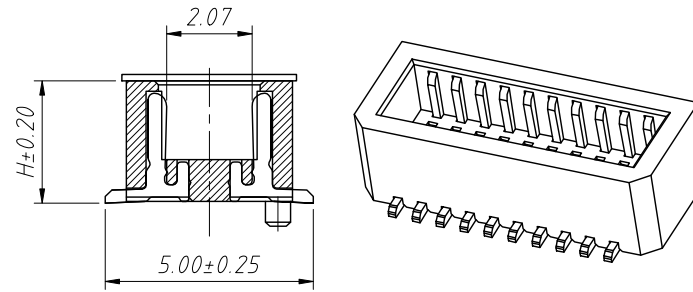
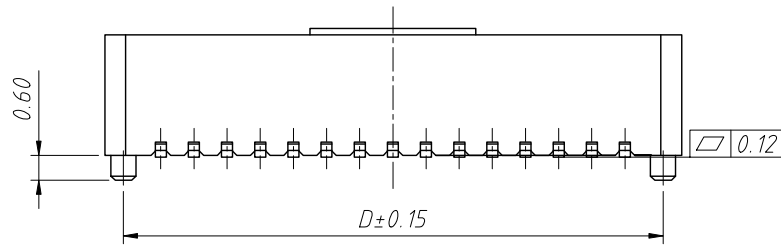

Mating Height (M/H)	Plug Height (M)	Socket Height (F)
4.00	2.80	2.90
4.50	3.30	
5.00	3.80	
5.50	4.30	3.40
6.00	4.80	
6.50	5.30	
7.00	5.30	3.90

Order Information:

L-KLS1-B1408-XX F XX-T3RB-GF1

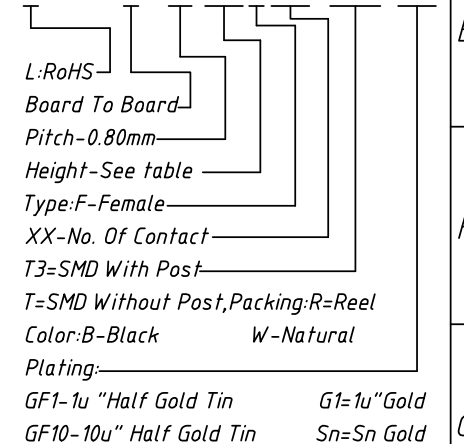

Material:  
 Insulator:LCP High Temperature Thermoplastic,UL94V-0  
 Terminal:Phosphor Bronze,Gold plating, Nickel 50u" min. over all

Electrical:  
 Current Rating:0.5Amp  
 Dielectric Withstanding:200V AC;  
 Insulation resistance:500mΩ min;  
 Contact resistance:30mΩ max;  
 Operating Temperature:-40°C ~ +105°C

ANGLE TOLERANCE	PROJECTION	Description:
±3°		0.8mm Board To Board Socket
GENERAL TOLERANCE	UNITS	mm
x.x ±0.30	SHEET SIZE	A4
x.xx ±0.20	Draw:	Jenny 2024-07-10
x.xxx ±0.10	Check:	Daniel 2024-07-10

L-KLS1-B1408-XXFXX-T3RB-GF1



NingBo KLS ELECTRONIC CO.,L TD.