

RoHS Compliance

REV	SYM	Revision Record	Appr.	Date
V0	KLS01629	New Version Release	Jenny	2024-07-10

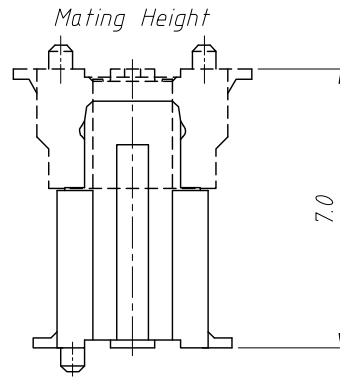
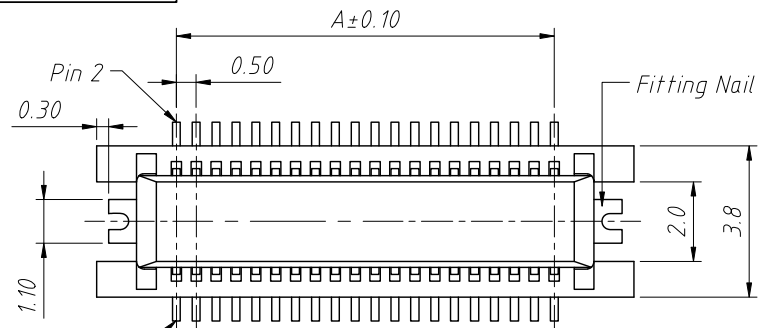

Material:
 Housing: Thermoplastic High Temp, UL 94 V-0
 Contact: Copper Alloy
 Fitting Nail: Copper Alloy
Plated:
 Contact: 50u" Min. Nickel Underplating Over All
 Gold Flash Plating 1~3u" Over All
 Fitting Nail: 50u" Min. Nickel Underplating Over All
 100~200u" Pure Matt Tin Plating Over All

Electrical:
 Current Rating: 0.3A Max
 Contact Resistance: 50mΩ Max
 Insulation Resistance: 100MΩ Min
 Dielectric Withstanding Voltage: 250V AC 1 Minute
 Operating Temperature Range: -40°C ~ +105°C
 Reflow Solder Capable: 260°C

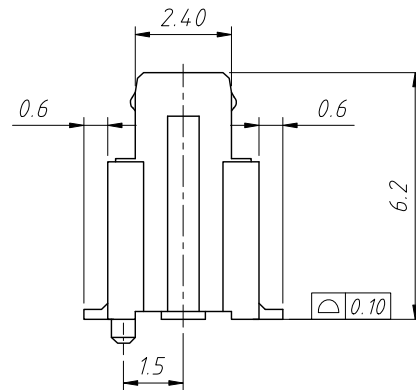
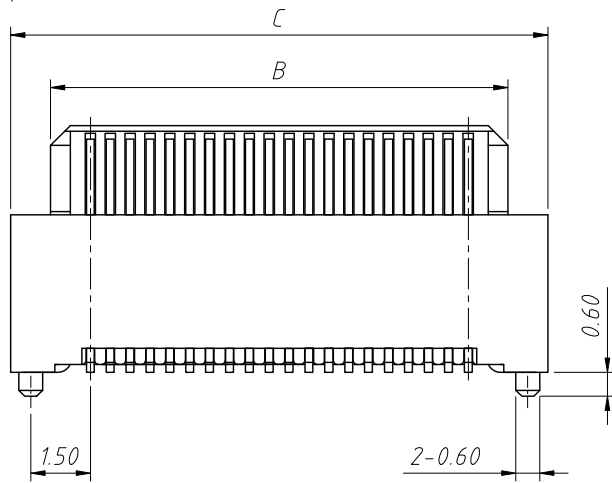

Order Information:

L-KLS1-B1405-620 M XX-T3RB-FG1

- L:RoHS
- Board To Board
- Pitch-0.50mm
- Height-6.20mm
- Type-M-Male
- XX-No. Of Contact
- T3=SMD With Post
- T=SMD Without Post, Packing:R=Reel
- Color:B-Black W-Natural
- Plating:
 - GF1-1u "Half Gold Tin
 - GF10-10u" Half Gold Tin
 - G1=1u" Gold
 - Sn=Sn Gold

Pins	Dimensions(mm)		
	A	B	C
16	3.50	5.50	7.50
20	4.50	6.50	8.50
30	7.00	9.00	11.00
40	9.50	11.50	13.50
50	12.00	14.00	16.00
60	14.50	16.50	18.50
70	17.00	19.00	21.00
80	19.50	21.50	23.50
100	24.50	26.50	28.50
120	29.50	31.50	33.50

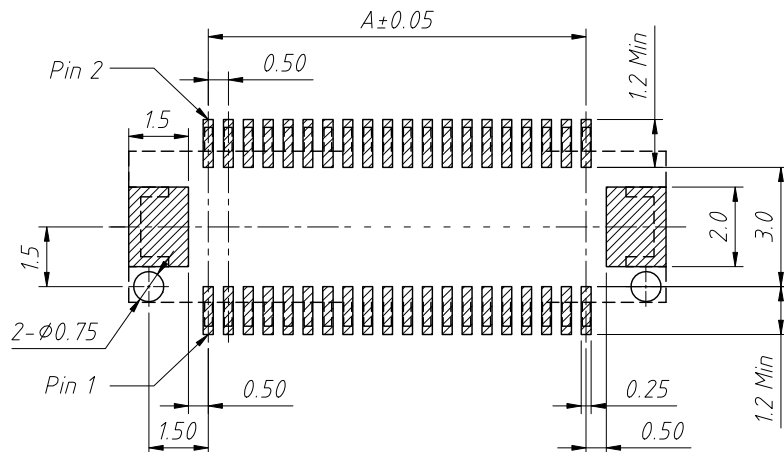

Recommended PCB Layout
 General Tolerance ±0.05

ANGLE TOLERANCE	PROJECTION	Description:		
±3°		0.5mm Board To Board Plug		
GENERAL TOLERANCE	UNITS	mm	KLS P/N:	L-KLS1-B1405-620MXX-T3RB-GF1
x.x ±0.30	SHEET SIZE	A4		
x.xx ±0.20	Draw:	Jenny	2024-07-10	
x.xxx ±0.10	Check:	Daniel	2024-07-10	

KLS NingBo KLS ELECTRONIC CO.,L TD.

RoHS Compliance

REV	SYM	Revision Record	Appr.	Date
V0	KLS01629	New Version Release	Jenny	2024-07-10

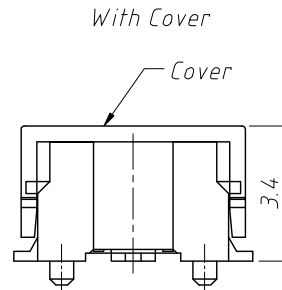
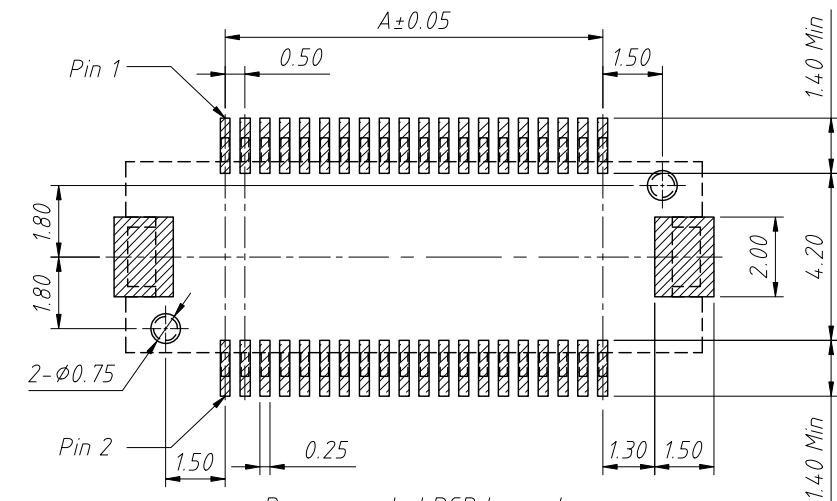
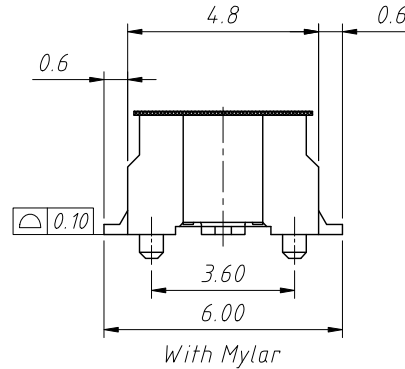
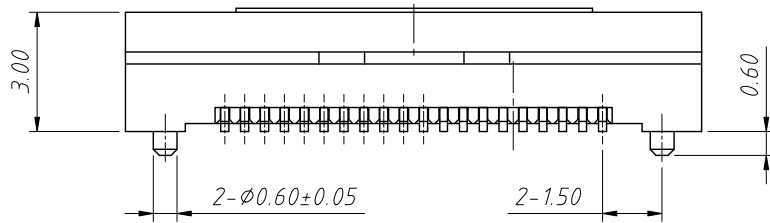
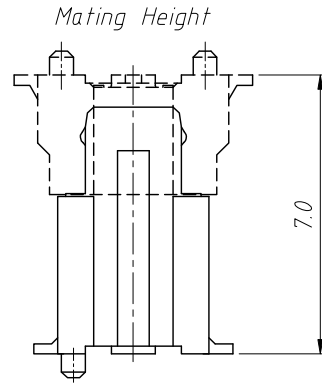
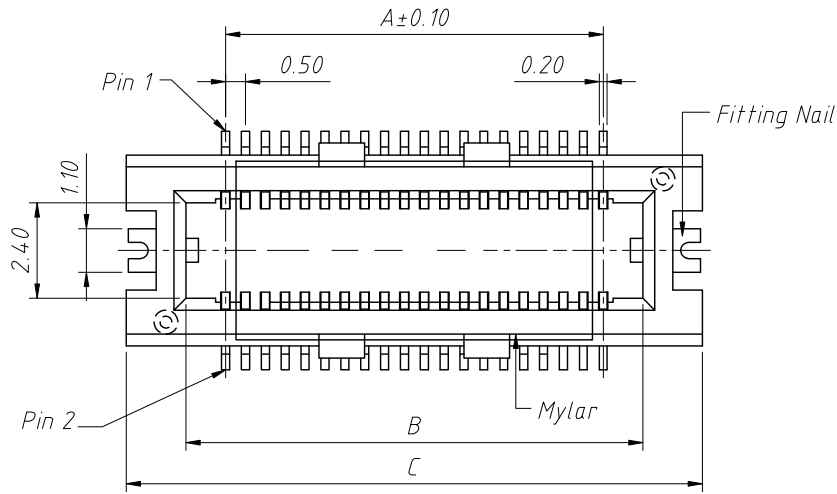

Material:
 Housing: Thermoplastic High Temp, UL 94 V-0
 Contact: Copper Alloy
 Fitting Nail: Copper Alloy
Plated:
 Contact: 50u" Min. Nickel Underplating Over All
 Gold Flash Plating 1~3u" Over All
 Fitting Nail: 50u" Min. Nickel Underplating Over All
 100~200u" Pure Matt Tin Plating Over All
Electrical:
 Current Rating: 0.3A Max
 Contact Resistance: 50mΩ Max
 Insulation Resistance: 100MΩ Min
 Dielectric Withstanding Voltage: 250V AC 1 Minute
 Operating Temperature Range: -40°C ~ +105°C
 Reflow Solder Capable: 260°C

Order Information:

L-KLS1-B1405-300 F XX-T3RB-GF1

- L:RoHS
- Board To Board
- Pitch-0.50mm
- Height-3.0mm
- TypeF-Female
- XX-No. Of Contact
- T3=SMD With Post
- T=SMD Without Post, Packing:R=Reel
- Color:B-Black W-Natural
- Plating:
 - GF1-1u "Half Gold Tin
 - GF10-10u" Half Gold Tin
 - G1=1u" Gold
 - Sn=Sn Gold

Pins	Dimensions(mm)		
	A	B	C
16	3.50	5.50	8.50
20	4.50	6.50	9.50
30	7.00	9.00	12.00
40	9.50	11.50	14.50
50	12.00	14.00	17.00
60	14.50	16.50	19.50
70	17.00	19.00	22.00
80	19.50	21.50	24.50
100	24.50	26.50	29.50
120	29.50	31.50	34.50

Recommended PCB Layout
 General Tolerance ±0.05

ANGLE TOLERANCE	PROJECTION	Description:
±3°		0.5mm Board To Board Socket
GENERAL TOLERANCE	UNITS	mm
x.x ±0.30	SHEET SIZE	A4
x.xx ±0.20	Draw:	Jenny 2024-07-10
x.xxx ±0.10	Check:	Daniel 2024-07-10
KLS ELECTRONIC		NingBo KLS ELECTRONIC CO.,LTD.