

RoHS Compliance

REV	SYM	Revision Record		Appr.	Date
V0	KLS01629	New Version Release		Jenny	2024-07-10

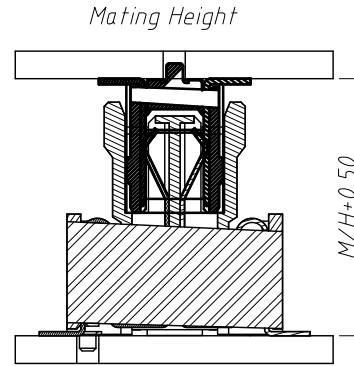
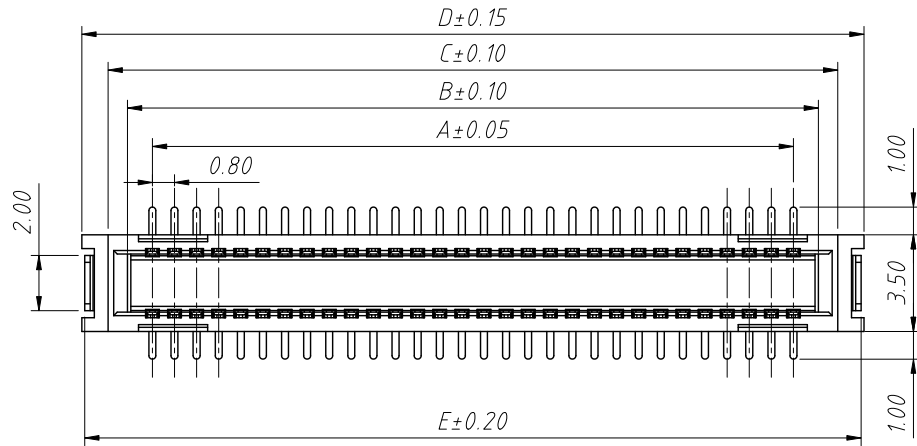

Mating Height (M/H)	Plug Height (H)	Socket Height
9.75	4.80	8.45
12.75	7.80	

Pin	A	B	C	D	E
30	11.2	13.0	14.4	16.3	16.1
40	15.2	17.0	18.4	20.3	20.1
50	19.2	21.0	22.4	24.3	24.1
60	23.2	25.0	26.4	28.3	28.1
70	27.2	29.0	30.4	32.3	32.1
80	31.2	33.0	34.4	36.3	36.1
90	35.2	37.0	38.4	40.3	40.1
100	39.2	41.0	42.4	44.3	44.1
110	43.2	45.0	46.4	48.3	48.1
120	47.2	49.0	50.4	52.3	52.1

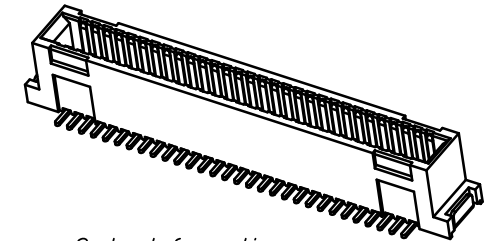

Order Information:

L-KLS1-B1308-780 M XX-T3RB-GF1

- L:RoHS
- Board To Board
- Pitch-0.80mm
- Height-7.80mm
- Type:M-Male
- XX-No. Of Contact
- T3=SMD With Post
- T=SMD Without Post,Packing:R=Reel
- Color:B-Black W-Natural
- Plating:
 - GF1-1u" Half Gold Tin
 - G1=1u" Gold
 - GF10-10u" Half Gold Tin
 - Sn=Sn Gold

Material:

Huosing:High-Temp Thermoplastic,UL 94 V-0,Black

Contact:Phosphor Bronze,1u"Gold On Contact Area,

Gold Flash On Solder,50~120u"Nickel Overall

Electrical:

Current Rating:0.5A

Voltage Rating:50V

Withstanding Voltage:250V

Contact Resistance:100MΩ Max

Insulation Resistance:500MΩ Min

Floating Range±0.5mm In X,Y,Z Directions

Operating Temperature:-40°C TO +105°C

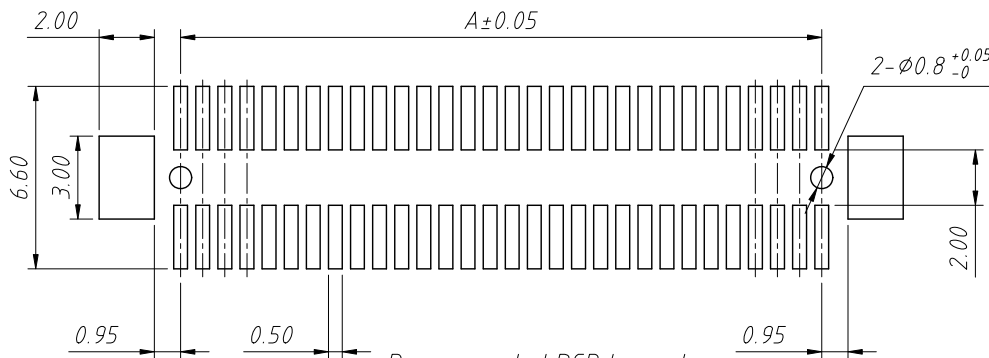
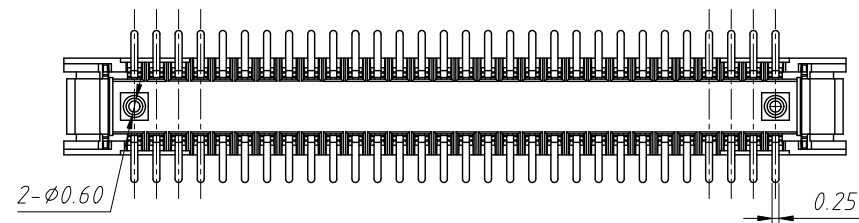
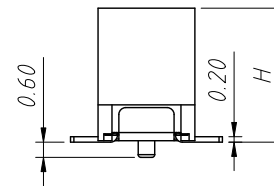
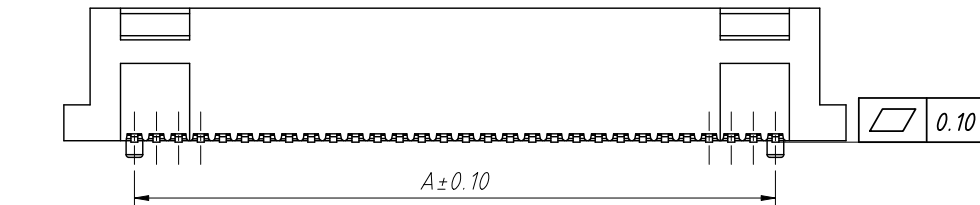

Recommended PCB Layout
General Tolerance ±0.05

ANGLE TOLERANCE	PROJECTION	Description:	
±3°		0.8mm Board To Board Plug	
GENERAL TOLERANCE	UNITS	mm	KLS P/N:
x.x ±0.30	SHEET SIZE	A4	L-KLS1-B1308-780MXX-T3RB-GF1
x.xx ±0.20	Draw:	Jenny	2024-07-10
x.xxx ±0.10	Check:	Daniel	2024-07-10



NingBo KLS ELECTRONIC CO.,L TD.

RoHS Compliance

REV	SYM	Revision Record		Appr.	Date
V0	KLS01629	New Version Release		Jenny	2024-07-10

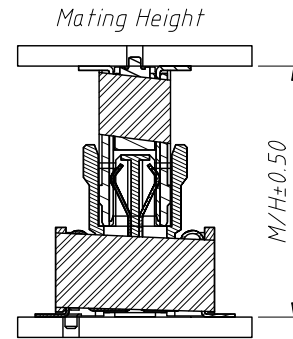
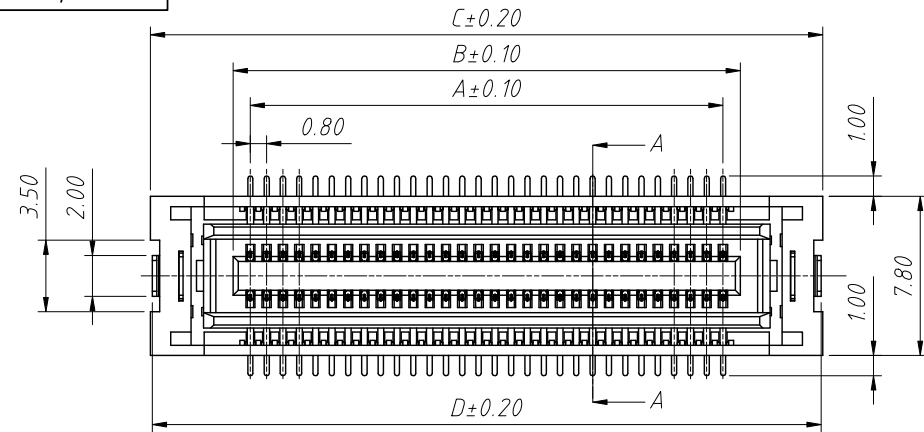

Mating Height (M/H)	Plug Height (H)	Socket Height
9.75	4.80	8.45
12.75	7.80	

Pin	A	B	C	D	E
30	11.2	12.9	21.0	20.8	18.0
40	15.2	16.9	25.0	24.8	22.0
50	19.2	20.9	29.0	28.8	26.0
60	23.2	24.9	33.0	32.8	30.0
70	27.2	28.9	37.0	36.8	34.0
80	31.2	32.9	41.0	40.8	38.0
90	35.2	36.9	45.0	44.8	42.0
100	39.2	40.9	49.0	48.8	46.0
110	43.2	44.9	53.0	52.8	50.0
120	47.2	48.9	57.0	56.8	54.0

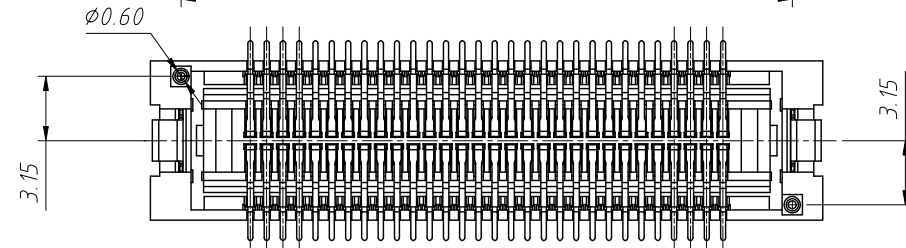
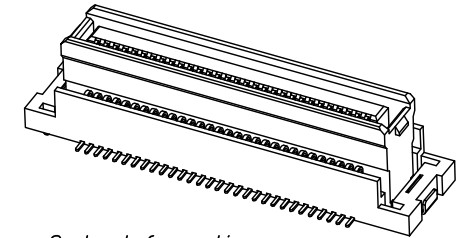
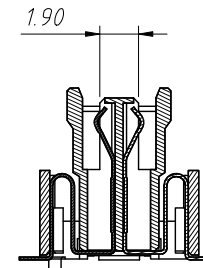
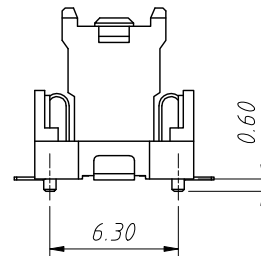
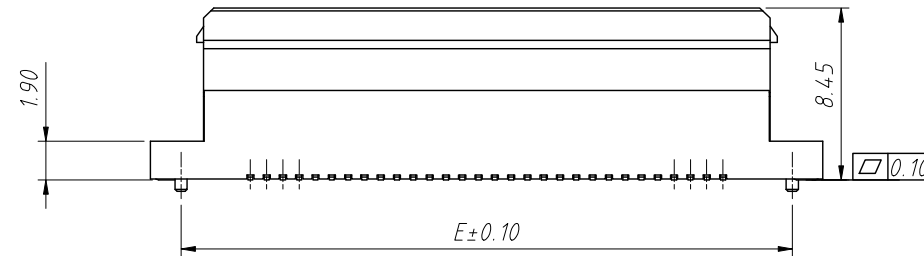

Material:
 Housing: High-Temp Thermoplastic, UL 94V-0, Black
 Contact: Phosphor Bronze, 1u" Gold On Contact Area,
 Gold Flash On Solder, 50~120u" Nickel Overall

Electrical:
 Current Rating: 0.5A
 Voltage Rating: 50V
 Withstanding Voltage: 250V
 Contact Resistance: 100MΩ Max
 Insulation Resistance: 500MΩ Min
 Floating Range ±0.5mm In X, Y, Z Directions
 Operating Temperature: -40°C TO +105°C

Order Information:
L-KLS1-B1308-845 F XX-T3RB-GF1

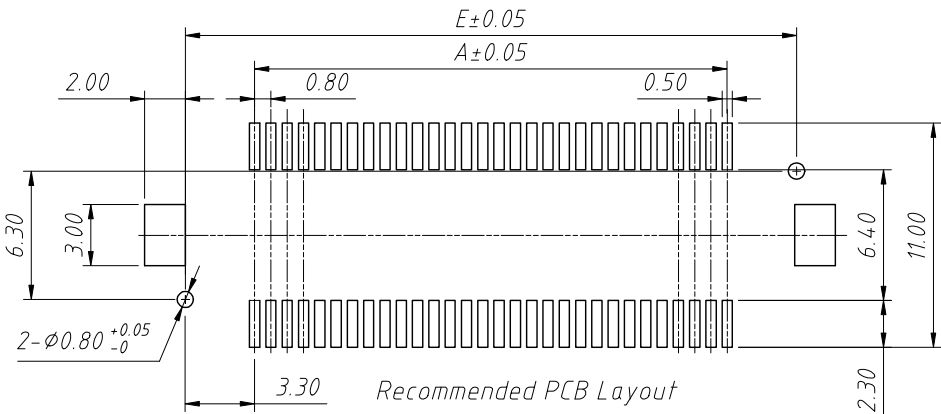
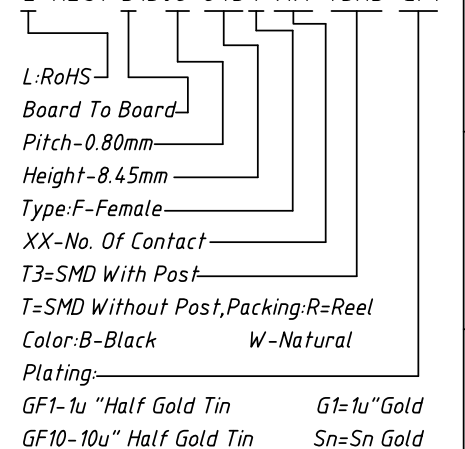

ANGLE TOLERANCE	PROJECTION	Description:	
±3°		0.8mm Board To Board Socket	
GENERAL TOLERANCE	UNITS	mm	KLS P/N:
x.x ±0.30	SHEET SIZE	A4	L-KLS1-B1308-845FXX-T3RB-GF1
x.xx ±0.20	Draw:	Jenny	2024-07-10
x.xxx ±0.10	Check:	Daniel	2024-07-10



NingBo KLS ELECTRONIC CO.,LTD.