

1 RoHS Compliance

REV	SYM	Revision Record	Appr.	Date
V0	KLS33029	New Version Release	Jenny	2024-06-15

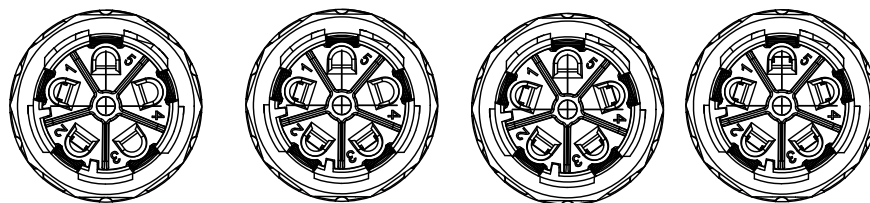
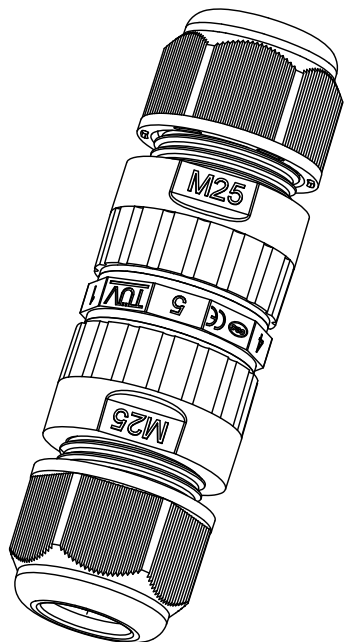

2Pin Connector    3Pin Connector    4Pin Connector    5Pin Connector

Material:  
 Housing: PA66, UL 94 V-0, Black  
 Contact: Copper Alloy, Nickel plated  
 IP rating: IP68  
 Number of poles: 2P/3P/4P/5P

Electrical:  
 Rated current: 16A  
 Rated voltage: AC 450V  
 Withstand voltage: AC 2500V  
 Wire section: 0.5~2.5mm<sup>2</sup>  
 Operating temperature: -40°C~+105°C  
 Certification: CQC/RoHS/CE

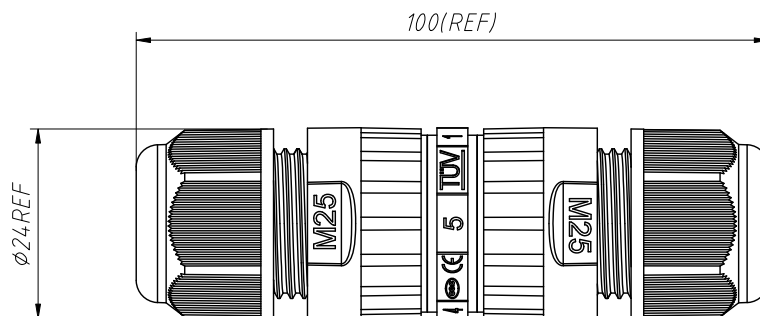
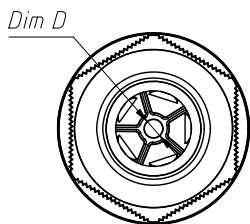
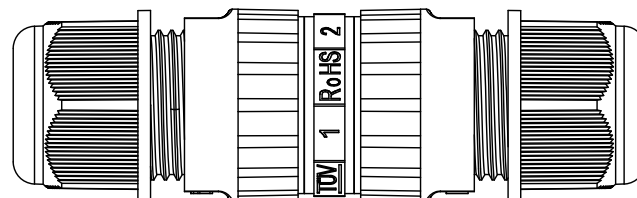

Order Information:  
 L-KLS15-WEC03-M25-XX-X

L: RoHS  
 Waterproof connectors  
 Serial Number  
 M25 Waterproof  
 Circular Connectors  
 Number of poles  
 Line diameter range:  
 A-5~9mm B-9~12mm C-10~14mm

ø14mm	ø10-14mm
ø12mm	ø9-12mm
ø8.5mm	ø5-9mm
Rubbers Diameter D	Outer Cable Diameter

ANGLE TOLERANCE	PROJECTION	Description:	M25 Waterproof Circular Connectors, IP68, Screw Locking Type
±3°			
GENERAL TOLERANCE	UNITS	mm	KLS P/N: L-KLS15-WEC03-M25-XX-X
x. ±0.35	SHEET SIZE	A4	
x.x ±0.20	Draw:	Jenny	2024-06-15
x.xx ±0.10	Check:	Daniel	2024-06-15



NingBo KLS ELECTRONIC CO.,LTD.